

F.A.I. RTE.	SECTION	COUNTY	TOTAL SHEETS	SHEET NO.
80/94	•	COOK	631	178
STA.	TO STA.			
FED. ROAD DIST. NO.	ILLINOIS	FED. AID PROJECT		
• (2425 & 2626) R-2		CONTRACT NO. 62111		

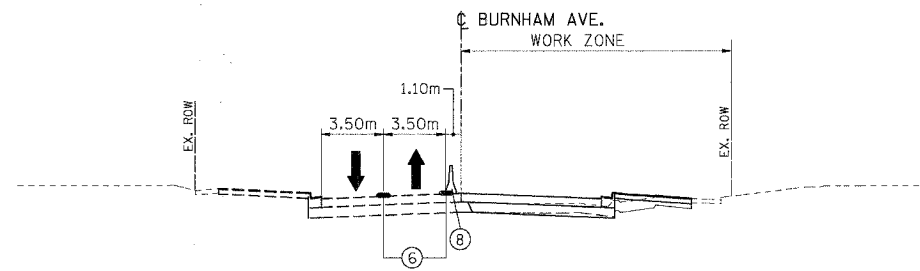

TYPICAL SECTION (STAGE II)
 STA 59+814.300 TO STA 59+971.200
 AND
 STA 60+030.745 TO STA 60+161.000

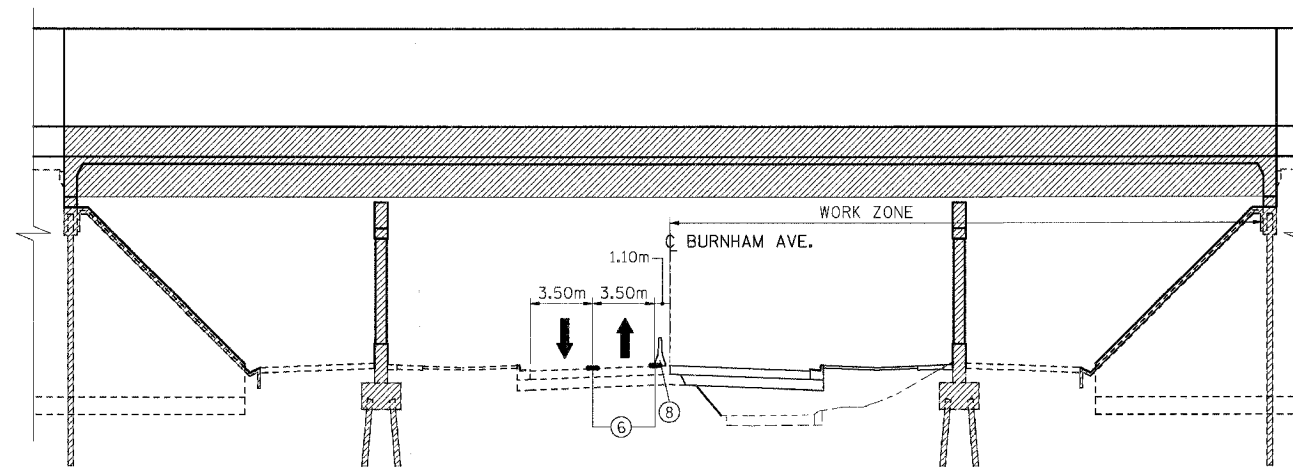

TYPICAL SECTION (STAGE II)
 STA 59+971.200 TO STA 60+030.745

LEGEND

- ① EXISTING PAVEMENT MARKING
- ② EXISTING GROUND LINE
- ③ EXISTING CONCRETE BARRIER
- ④ EXISTING TEMPORARY CONCRETE BARRIER
- ⑤ DRUM OR TYPE II BARRICADES WITH STEADY BURN LIGHTS
- ⑥ TEMPORARY PAVEMENT MARKINGS (SEE PLANS FOR DETAILS AND PAY ITEM)
- ⑦ TEMPORARY PAVEMENT (INTERSTATE)
- ⑧ TEMPORARY CONCRETE BARRIER (SEE PLANS FOR PAY ITEM)
- ⑨ PROPOSED SUBGRADE

↑ TRAFFIC FLOW ARROW

* EXISTING FROM A PREVIOUS STAGE OR CONTRACT
 VAR. - INDICATES THAT THIS DIMENSION VARIES IN THE VICINITY OF THE INDICATED TYPICAL SECTION

\A989002A.DGN, \XW70052A.DGN, \T07002A.DGN, BALZEK1
 P:\9-2005\1012-49 - PLAN DOCUMENT\19755\1012\1012A.DGN, \1012A.DGN
 1, 2, 3, 4, 5, 6, 7, 8, 9, 10, 11, 12, 13, 14, 15, 16, 17, 18, 19, 20, 21, 22, 23, 24, 25, 26, 27, 28, 29, 30, 31, 32, 33, 34, 35, 36, 37, 38, 39, 40, 41, 42, 43, 44, 45, 46, 47, 48, 49, 50, 51, 52, 53, 54, 55, 56, 57, 58, 59, 60, 61, 62, 63

REVISIONS	
NAME	DATE

ILLINOIS DEPARTMENT OF TRANSPORTATION
 F.A.I. ROUTE 80/94 (KINGERY EXPRESSWAY)
 EB & WB INSIDE LANES (MAINLINE) CONSTRUCTION
 COOK COUNTY

**MAINTENANCE OF TRAFFIC
 BURNHAM AVE TYPICAL SECTIONS
 STAGE 2**

SCALE: NONE
 DATE: 8/22/05

DRAWN BY: MK
 CHECKED BY: DH

TENG
 TENG & ASSOCIATES, INC.
 ENGINEERS/ARCHITECTS/PLANNERS
 CHICAGO, ILLINOIS