

F.A.I. RTE.	SECTION	COUNTY	TOTAL SHEETS	SHEET NO.
80/94		COOK	631	350
STA.	TO STA.			
FED. ROAD DIST. NO.	ILLINOIS	FED. AID PROJECT		
• (2425 & 2626) R-2		CONTRACT NO. 62111		

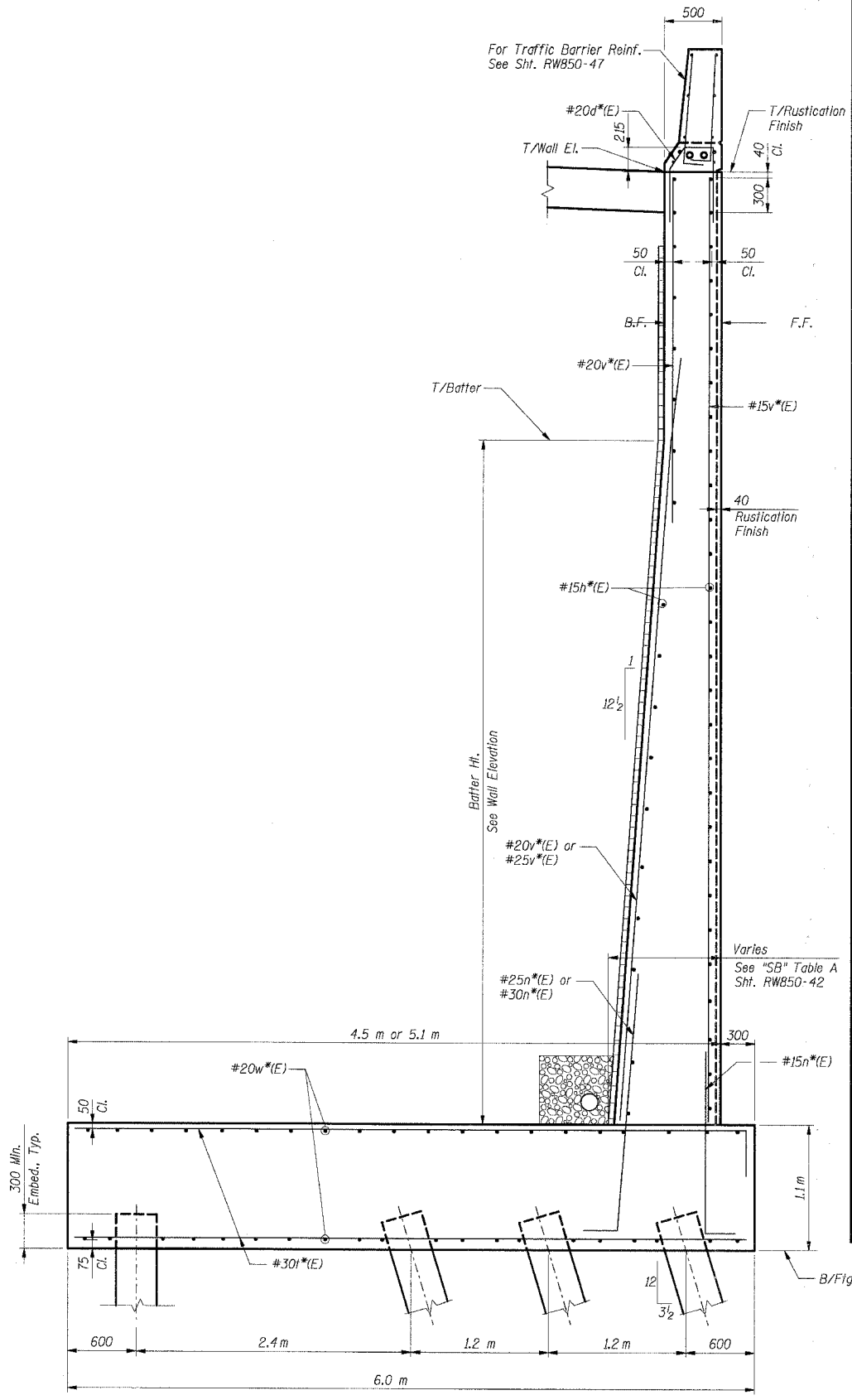

SECTION C-C
Work with Shts. RW850-34 thru RW850-36.

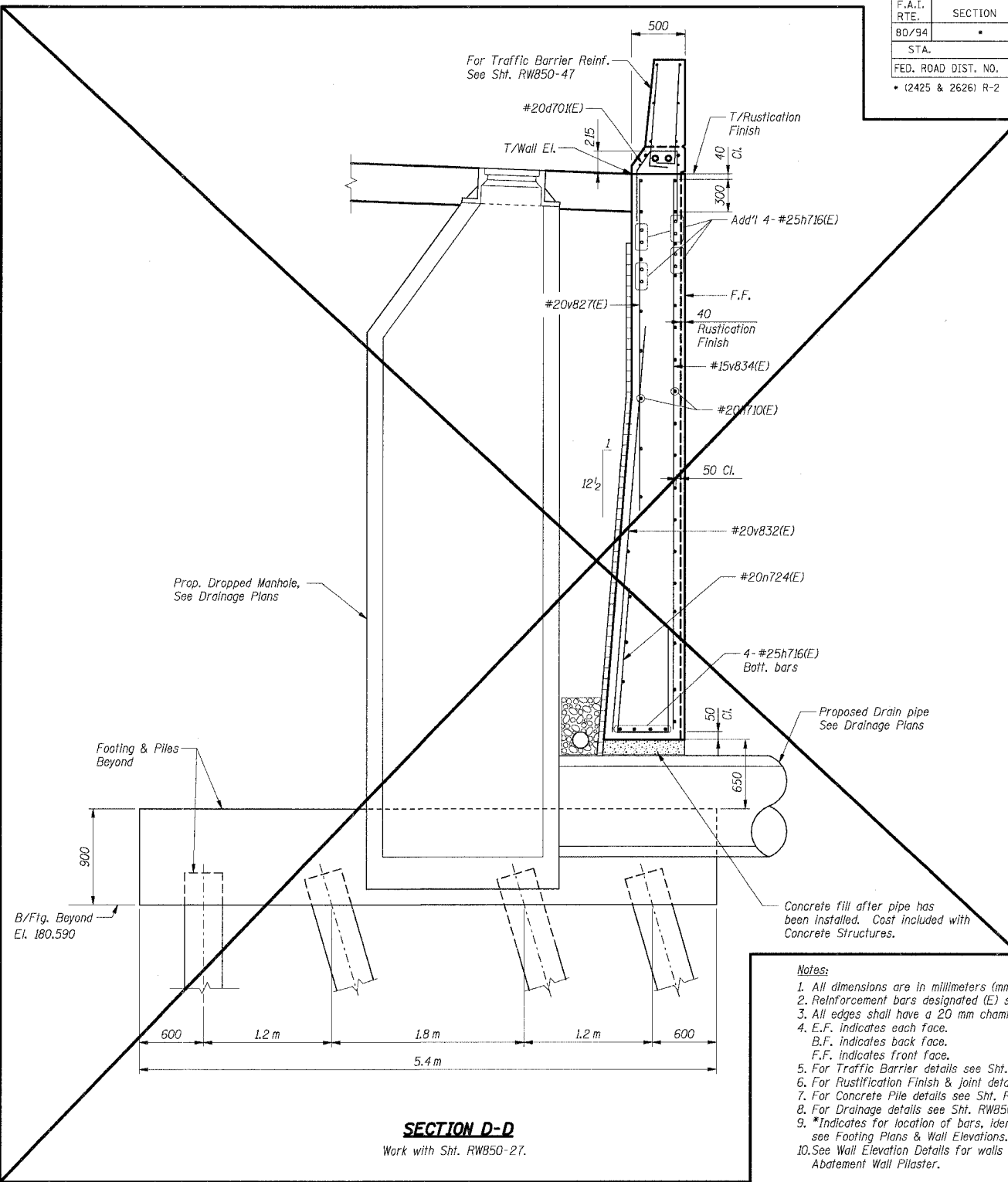

SECTION D-D
Work with Sht. RW850-27.

- Notes:**
- All dimensions are in millimeters (mm) except as noted.
 - Reinforcement bars designated (E) shall be epoxy coated.
 - All edges shall have a 20 mm chamfer unless noted otherwise.
 - E.F. indicates each face.
 - B.F. indicates back face.
 - F.F. indicates front face.
 - For Traffic Barrier details see Sht. RW850-47.
 - For Rustication Finish & joint details see Sht. RW850-49.
 - For Concrete Pile details see Sht. RW850-51.
 - For Drainage details see Sht. RW850-48.
 - *Indicates for location of bars, identification and quantity, see Footing Plans & Wall Elevations.
 - See Wall Elevation Details for walls with Noise Abatement Wall Pilaster.

\AB99601A.DGN
 7-12-2005, 10:24:47
 T:\DOCUMENTS\937575\STRUCT\DRN\RW850-43.DGN
 12 3 4 5 6 7 8 9 10 11 12 13 14 15 16 17 18 19 20 21 22 23 24 25 26 27 28 29 30 31 32 33 34 35 36 37 38 39 40 41 42 43 44 45 46 47 48 49 50 51 52 53 54 55 56 57 58 59 60 61 62 63
 BAJZEKJ

*** 2001-16TR, (2425 & 2626) R-1 AND (2425 & 2626) R-2

ILLINOIS DEPARTMENT OF TRANSPORTATION
 F.A.I. ROUTE 80/94 (KINGERY EXPRESSWAY)
 EB & WB INSIDE LANES (MAINLINE) CONSTRUCTION
 RETAINING WALL - STRUCTURE NO. 016-W850
 SECTIONS ***
 COOK COUNTY

SHT. RW850-43 OF 58

REVISIONS	
NAME	DATE

WALL SECTIONS & DETAILS II

DATE: 7/18/2005
 DRAWN BY: CHECKED BY: MJK
TENG
 TENG & ASSOCIATES, INC.
 ENGINEERS/ARCHITECTS/PLANNERS
 CHICAGO, ILLINOIS