

ALL DIMENSIONS IN METERS EXCEPT PAY ITEMS AND UNLESS NOTED OTHERWISE

|                      |                       |                        |                      |                  |
|----------------------|-----------------------|------------------------|----------------------|------------------|
| F.A.I. RTE.<br>80/94 | SECTION<br>2626.2-R-2 | COUNTY<br>COOK/LAKE    | TOTAL SHEETS<br>1207 | SHEET NO.<br>214 |
| STA.<br>7+400        |                       | TO STA.<br>7+100       |                      |                  |
| FED. ROAD DIST. NO.  | ILLINOIS              | FED. AID PROJECT       |                      |                  |
| CONTRACT NO. 62114   |                       | INDOT DES. NO. 0100987 |                      |                  |

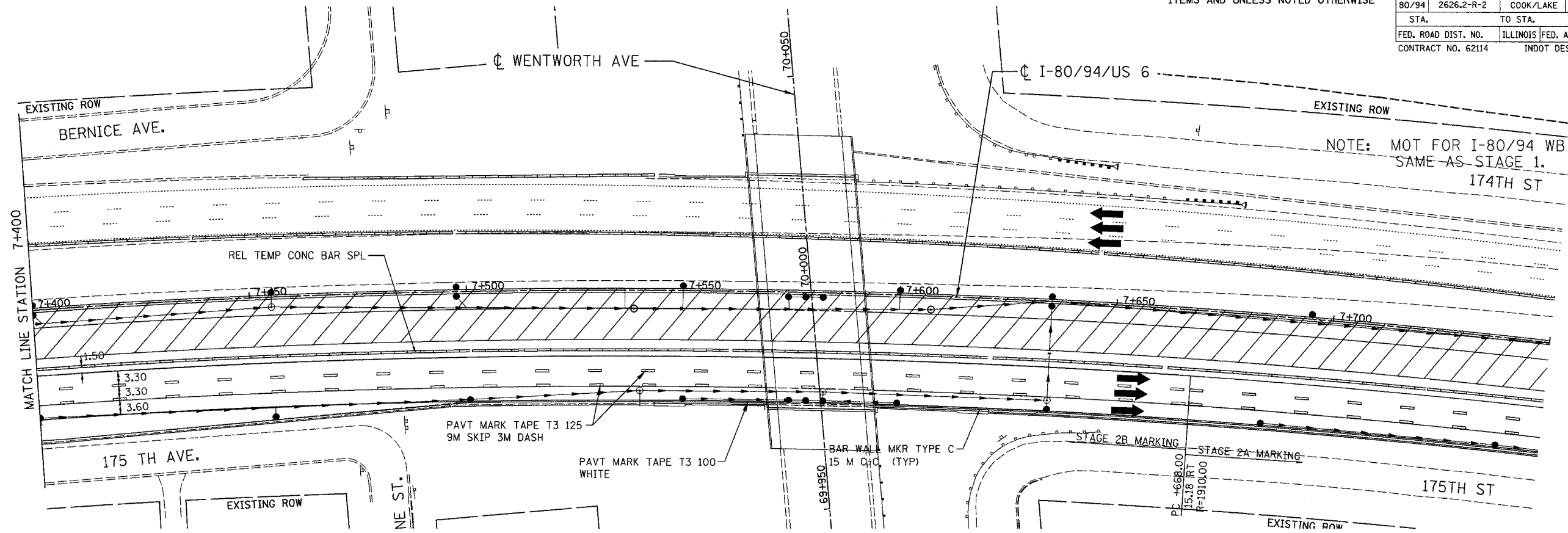

NOTE: MOT FOR I-80/94 WB SAME AS STAGE 1. 174TH ST

MATCH LINE STATION 7+400

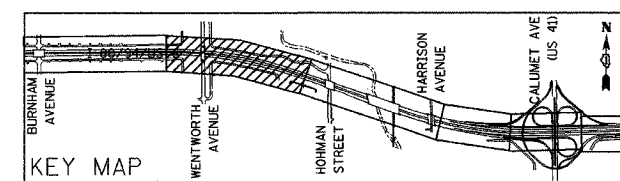

| REVISIONS |      |
|-----------|------|
| NAME      | DATE |
|           |      |
|           |      |
|           |      |

ILLINOIS DEPARTMENT OF TRANSPORTATION  
 I-80/94/US 6  
 KINGERY-BORMAN EXPRESSWAY  
 BURNHAM ROAD TO US 41  
**MAINTENANCE OF TRAFFIC  
 STAGE 2B**  
**STA. 7+400 TO STA. 8+100**

SCALE 1:500 DRAWN BY ACE/CAD  
 DATE 07/05 CHECKED BY TAE

**AMERICAN**  
 CONSULTING ENGINEERS