

F.A.I. RTE.	SECTION	COUNTY	TOTAL SHEETS	SHEET NO.
80/94	2626.2-R-2	COOK/LAKE	1207	215
STA.	TO STA.			
FED. ROAD DIST. NO.	ILLINOIS FED. AID PROJECT			
CONTRACT NO. 62114	INDOT DES. NO. 0100987			

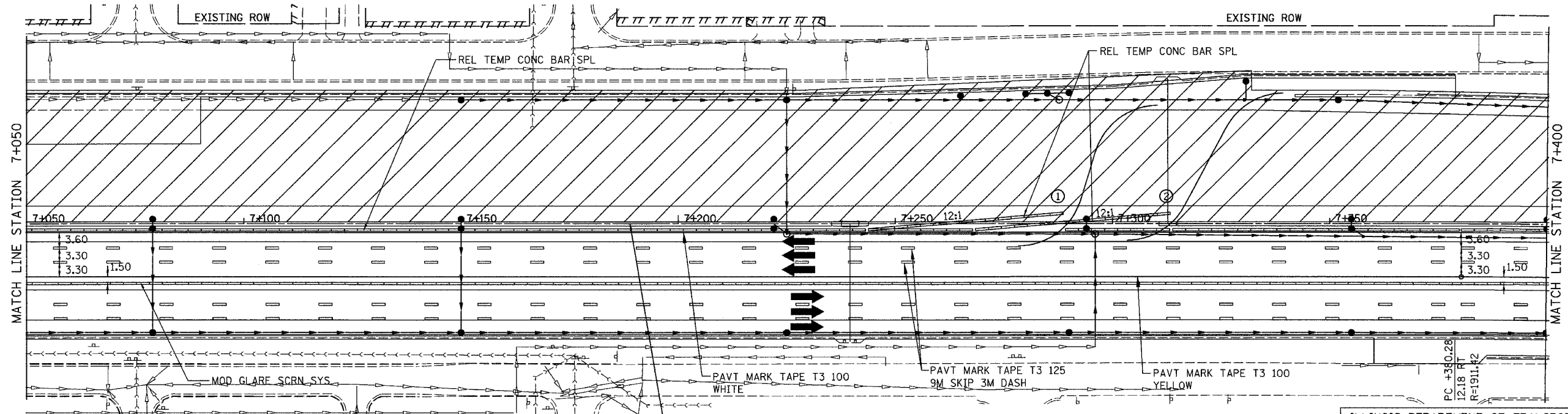

- NOTES:
- ① & ② STAGE CONSTRUCTION TO PROVIDE EMERGENCY ACCESS AT ALL TIMES.
 - FINAL CONSTRUCTION OF CONCRETE MEDIAN BARRIER TO BE COMPLETED AFTER TRAFFIC IN FINAL CONFIGURATION UNDER DAILY LANE CLOSURE OF MEDIAN LANES.

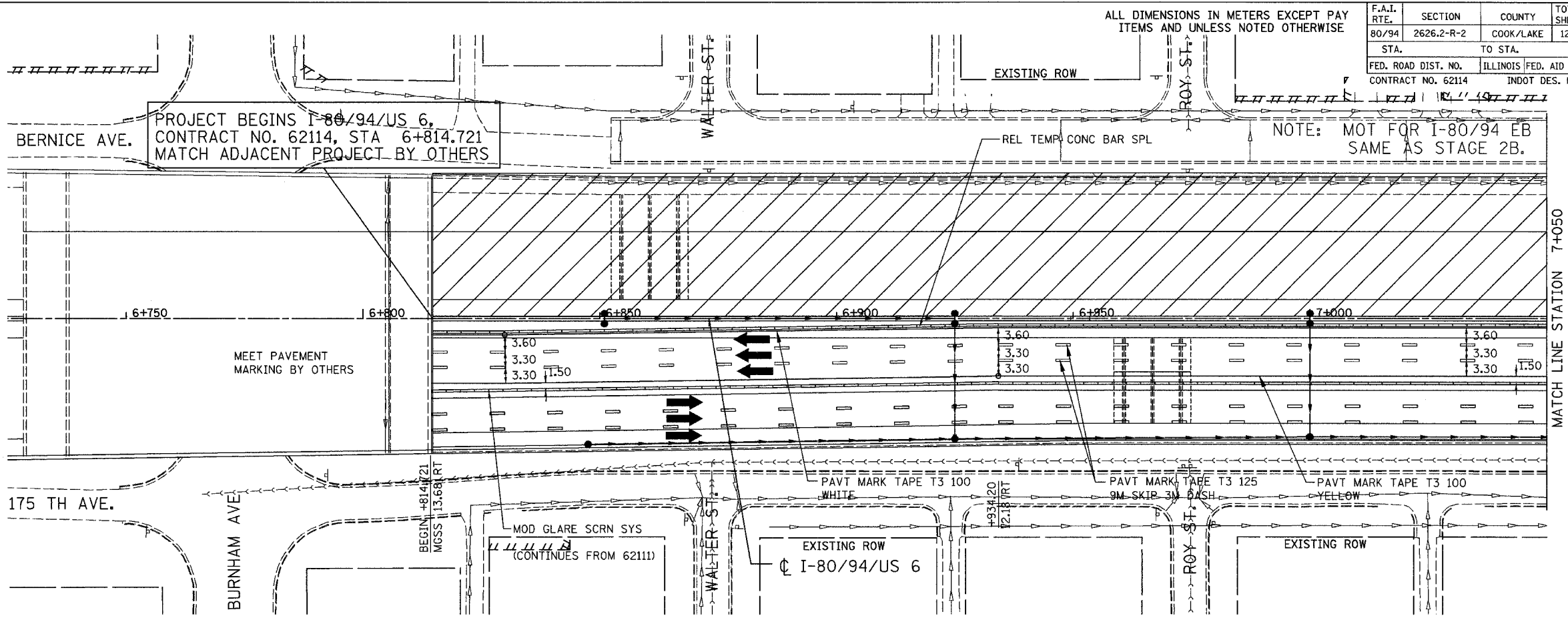
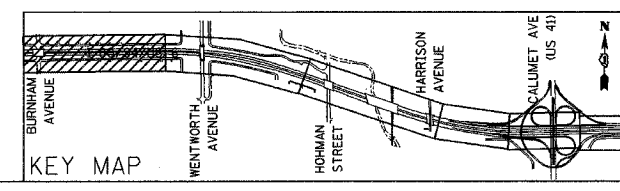

REVISIONS	
NAME	DATE

ILLINOIS DEPARTMENT OF TRANSPORTATION
 I-80/94/US 6
 KINGERY-BORMAN EXPRESSWAY
 BURNHAM ROAD TO US 41
 MAINTENANCE OF TRAFFIC
 STAGE 3
 STA. 6 + 814.721 TO STA. 7 + 400
 SCALE 1:500 DRAWN BY ACE/CAD
 DATE 07/05 CHECKED BY TAE

AMERICAN
 CONSULTING ENGINEERS