

F.A.I. RTE.	SECTION	COUNTY	TOTAL SHEETS	SHEET NO.
80/94	2626.2-R-2	COOK	1207	749
STA.	TO STA.			
FED. ROAD DIST. NO.	ILLINOIS	FED. AID PROJECT		
CONTRACT NO. 62114				

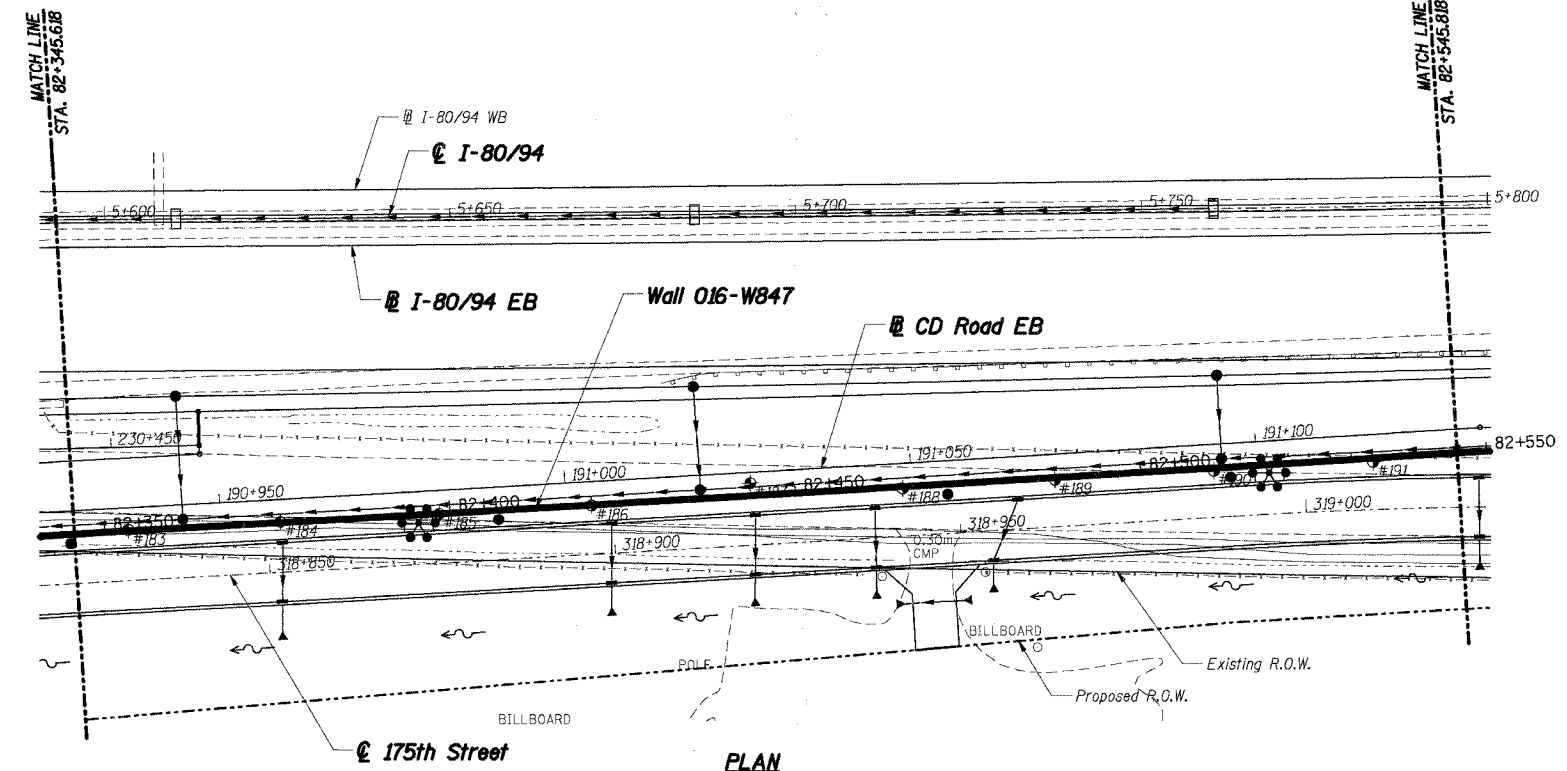

**PLAN**

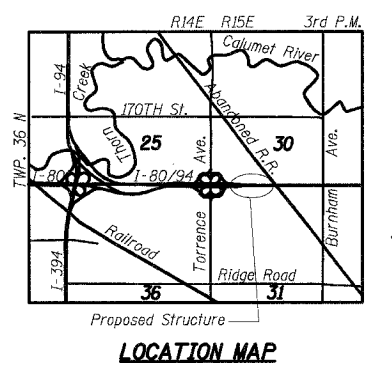

**LOCATION MAP**

**LEGEND**

- \* High Mast Light Tower (By Others, Contract No. 62664)
- Existing Storm Sewer
- Proposed Storm Sewer
- Existing Combined Sewer, See Note 5.
- Proposed Combined Sewer, See Note 5.
- #5 Soil Boring
- Proposed Manhole
- Proposed Manhole
- Proposed Catch Basin
- Proposed Inlet
- ▨ Rip Rap
- ▬ Proposed Retaining Wall
- Proposed Pavement
- W— Existing Water Main, See Notes 5 and 6.
- G— Gas Main, See Note 5.
- T— Telephone, See Note 5.
- Proposed R.O.W.
- Existing R.O.W.

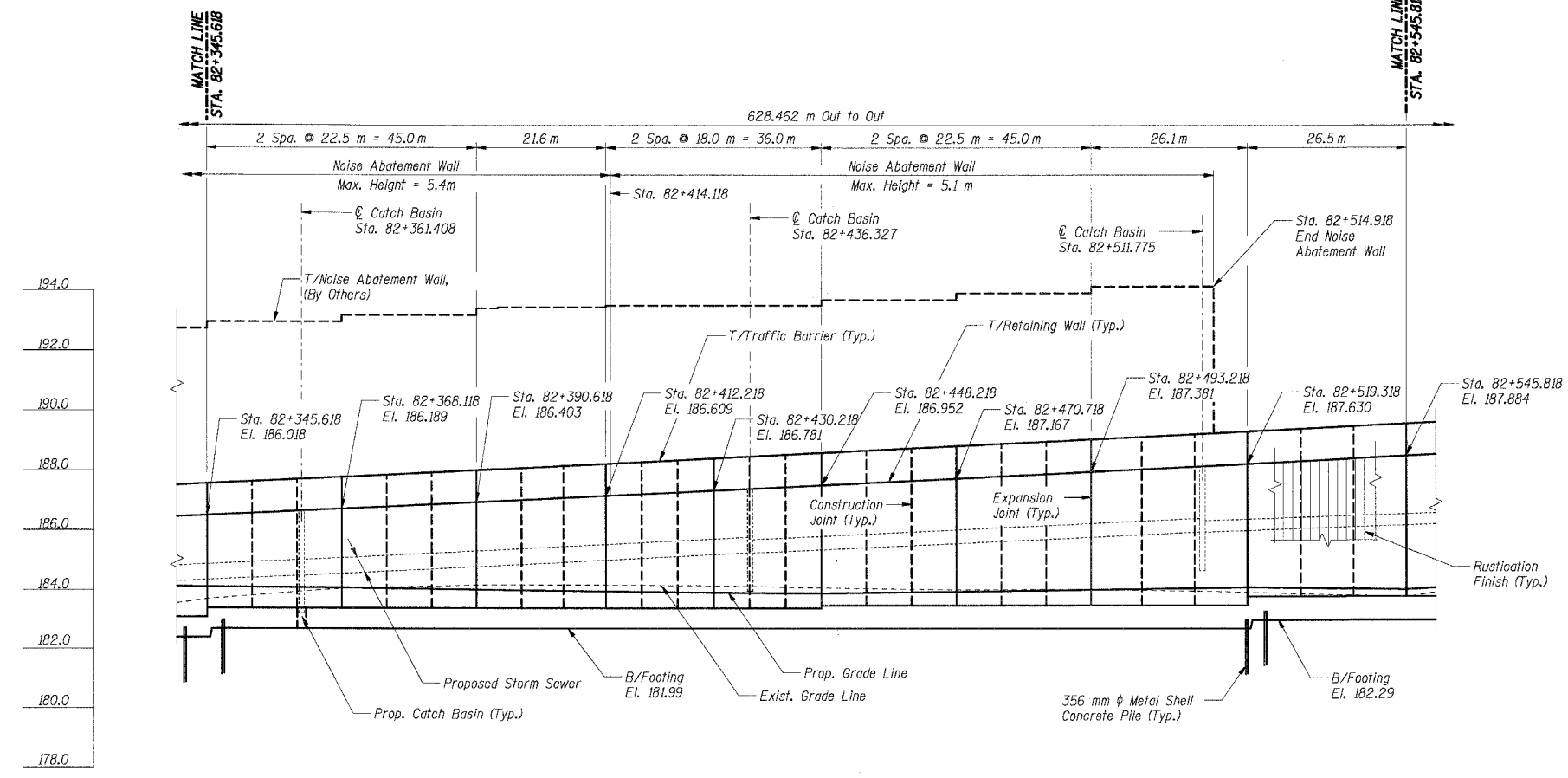

**ELEVATION**

**THIS SHEET FOR INFORMATION ONLY**

**Notes:**

1. All dimensions are measured along front face of retaining wall.
2. Work this sheet with RWB47-1 and RWB47-3.
3. See Sht. RWB47-4 for Index of Sheets.
4. The expansion joints and construction joints are in the traffic barrier and wall stem only, not in footing U.N.O.
5. See Drainage Plans.
6. See Utility Relocation Plans Prepared by Robinson Engineering, Ltd. beginning at Sheet 143A.

**SHT. RWB47-2 OF 54**

REVISIONS	
NAME	DATE

ILLINOIS DEPARTMENT OF TRANSPORTATION  
 F.A.I. ROUTE 80/94 (KINGERY EXPRESSWAY)  
 LOCAL ROADS RECONSTRUCTION  
 RETAINING WALL - STRUCTURE NO. 016-W847  
 SECTIONS 2001-167R AND (2425 & 2626) R-1  
 COOK COUNTY

**GENERAL PLAN & ELEVATION II**

DATE: 3/10/2004  
 DRAWN BY: MS  
 CHECKED BY: BK

**TENG**  
 ENGINEERS/ARCHITECTS/PLANNERS  
 CHICAGO, ILLINOIS

**MORCOM, N.V., INC.**  
 CONSULTING ENGINEERS  
 CHICAGO, ILLINOIS

7-11-2005, 15:53:39  
 T:\DOCUMENT\80750\STRUCT\016\80750\175ST\022A.DGN  
 12 3 4 5 6 7 8 9 10 11 12 13 14 15 16 17 18 19 20 21 22 23 24 25 26 27 28 29 30 31 32 33 34 35 36 37 38 39 40 41 42 43 44 45 46 47 48 49 50 51 52 53 54 55 56 57 58 59 60 61 62 63  
 BAUTZKJ