

F.A.I. RTE.	SECTION	COUNTY	TOTAL SHEETS	SHEET NO.
80/94	2626.2-R-2	COOK	1207	777
STA.	TO STA.			
FED. ROAD DIST. NO.	ILLINOIS	FED. AID PROJECT		
CONTRACT NO. 62114				

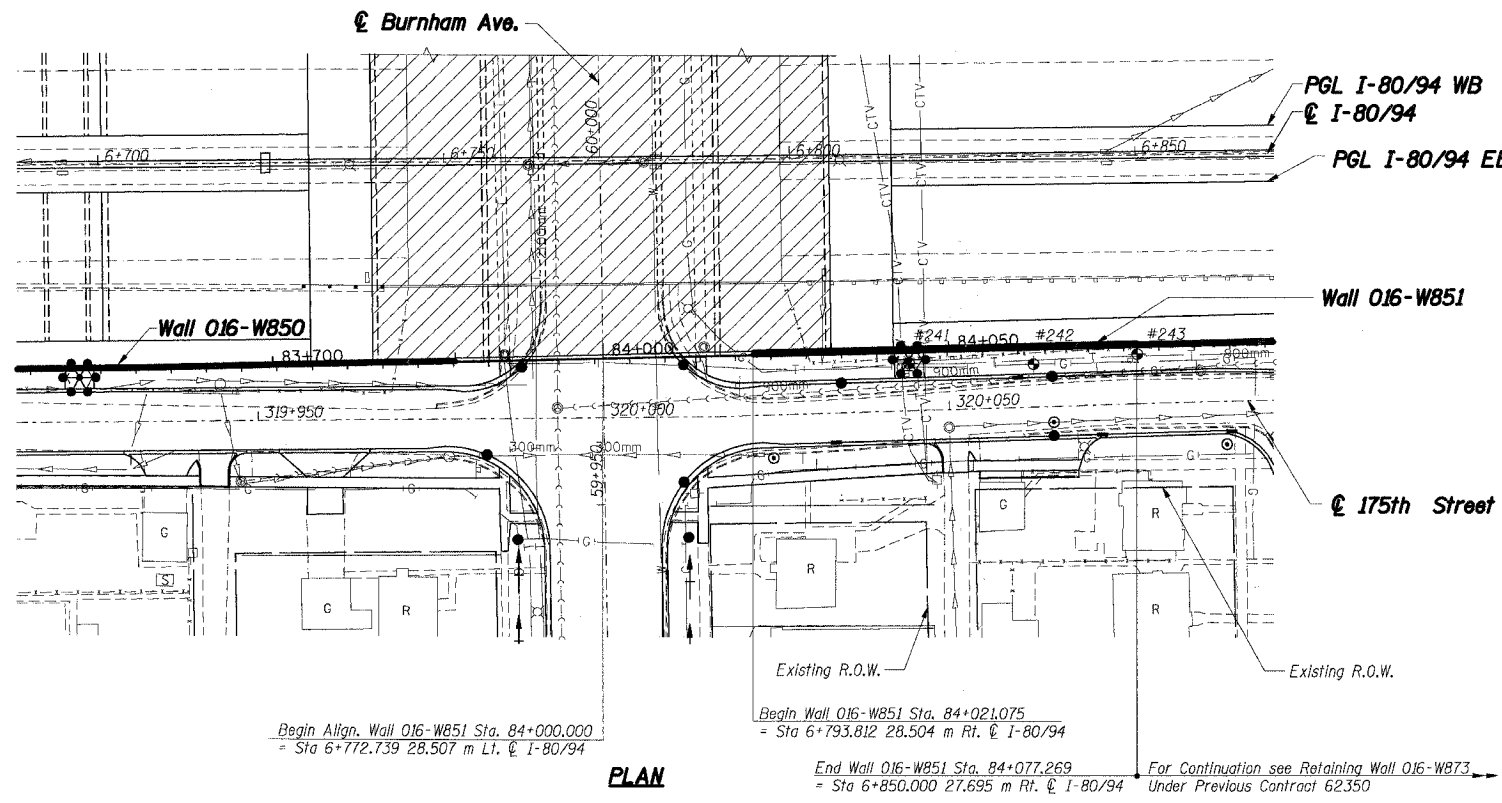

**LEGEND**

- High Mast Light Tower (By others, Contract No. 62664)
- Existing Storm Sewer
- Proposed Storm Sewer
- Existing Combined Sewer, see Drainage Plans
- Soil Boring
- Proposed Manhole
- Proposed Catch Basin
- Proposed Inlet
- Proposed Retaining Wall
- Proposed Pavement
- Existing Water Main
- Existing Telephone
- Existing Gas
- Existing Cable Television
- Proposed R.O.W.
- Existing R.O.W.
- Proposed Bridge Structure S.N. 016-2791

**DESIGN SPECIFICATIONS:**

1996 AASHTO Standard Specifications for Highway Bridges with 1997 thru 2000 and 2002 Interims.

1989 AASHTO Guide Specifications for Structural Design of Sound Barriers with 1992 Interims.

**DESIGN LOADING:**

Noise Abatement Wall:  
Wind Load: 1.7 kPa  
Limits: Sta. 84+032.985 to Sta. 84+077.269  
Design Height: 3.36m measured from Top of Retaining Wall

**DESIGN STRESSES:**

Concrete, f'c: 24 MPa  
Reinforcement, fy: 400 MPa

**BENCHMARK:**

BM "6E" Square cut in northwest corner of the southwest handrail (J-Wall) at the southwest abutment of existing I-80 bridge over Burnham Ave. El. 187.309

**EXISTING STRUCTURE:**

None

**TOTAL BILL OF MATERIAL**

Item	Unit	Total
Structure Excavation	Cu m	1,011
Test Pile Metal Shells	Each	1
Furnishing Metal Pile Shells 356mm	meter	2179.5
Driving and Filling Shells	meter	2179.5
Concrete Structures	Cu m	516.0
Reinforcement Bars, Epoxy Coated	kg	47,490
Protective Coat **	Sq m	488
Rustication Finish	Sq m	365
Geocomposite Wall Drain	Sq m	290
Pipe Underdrains for Structures 150mm	meter	56.5
Noise Abatement Wall Anchor Rod Assembly	Each	13

\*\*Note: See Shf. RW851-11 for limits of Protective Coat.

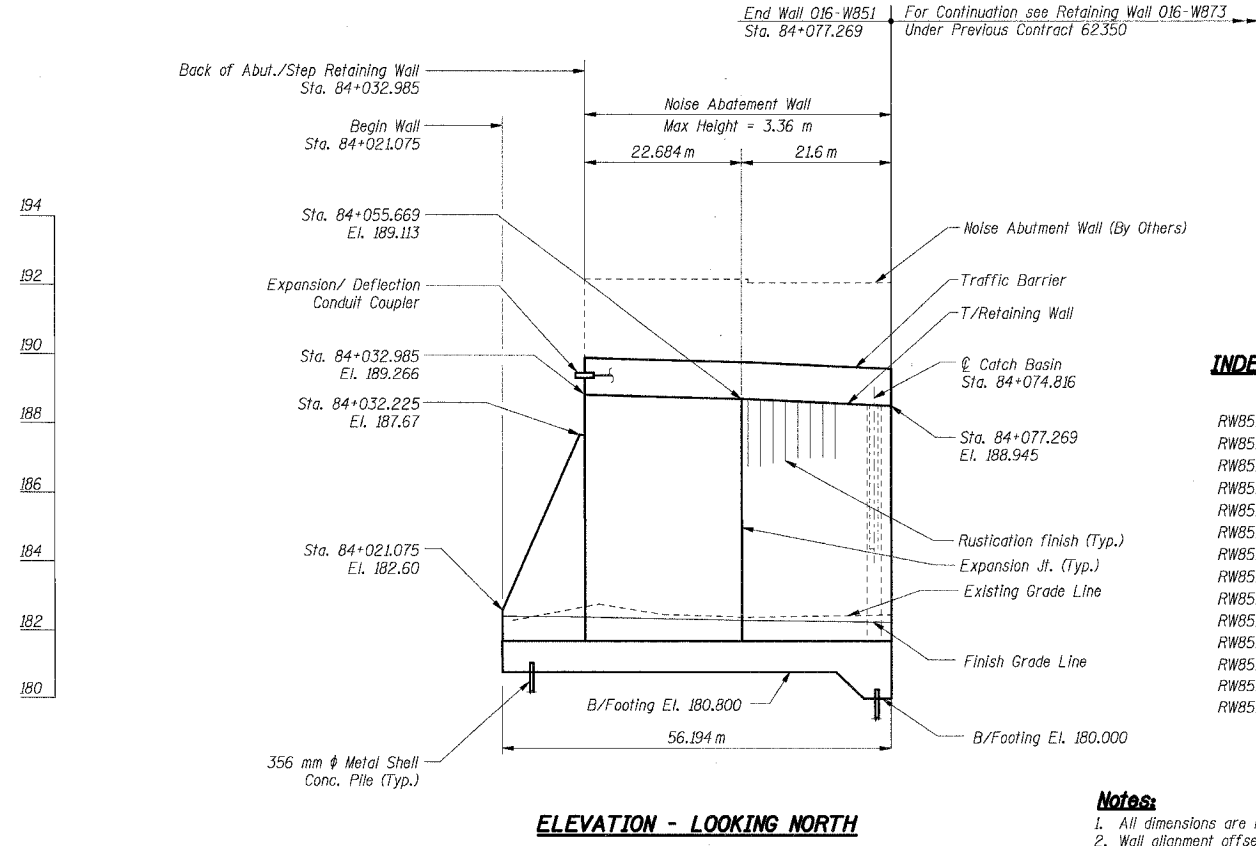
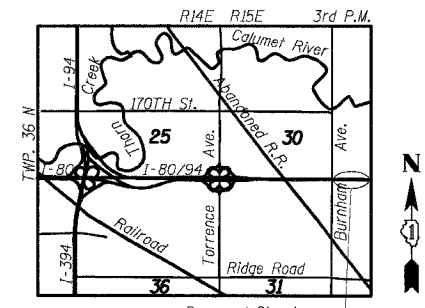

**INDEX OF SHEETS**

- RW851-1 GENERAL PLAN & ELEVATION INDEX OF SHEETS & TOTAL BILL OF MATERIAL
- RW851-2 TYPICAL WALL SECTION & GENERAL NOTES
- RW851-3 FOOTING PLAN & WALL ELEVATION 1
- RW851-4 FOOTING PLAN & WALL ELEVATION 2
- RW851-5 FOOTING PLAN & WALL ELEVATION 3
- RW851-6 TRAFFIC BARRIER ELEVATION
- RW851-7 WALL SECTIONS & DETAILS I
- RW851-8 WALL SECTIONS & DETAILS II
- RW851-9 WALL SECTIONS & DETAILS III
- RW851-10 TRAFFIC BARRIER SECTIONS & DETAILS
- RW851-11 DRAINAGE DETAILS & WALL REINFORCEMENT DETAILS
- RW851-12 RUSTICATION FINISH & JOINT DETAILS
- RW851-13 PILE DETAILS
- RW851-14 BORING LOGS

**Notes:**

1. All dimensions are measured along front face of retaining wall.
2. Wall alignment offsets are referenced to front face of wall.

**SHT. RW851-1 OF 14**

REVISIONS	
NAME	DATE

**THIS SHEET FOR INFORMATION ONLY**

ILLINOIS DEPARTMENT OF TRANSPORTATION  
F.A.I. ROUTE 80/94 (KINGERY EXPRESSWAY)  
EB & WB INSIDE LANES (MAINLINE) CONSTRUCTION  
RETAINING WALL - STRUCTURE NO. 016-W851  
SECTION (2425 & 2626) R-2  
COOK COUNTY

**GENERAL PLAN & ELEVATION INDEX OF SHEETS & TOTAL BILL OF MATERIAL**

DATE: 7/18/2005  
DRAWN BY: LS  
CHECKED BY: MJK  
**TENG**  
TENG & ASSOCIATES, INC.  
ENGINEERS/ARCHITECTS/PLANNERS  
CHICAGO, ILLINOIS

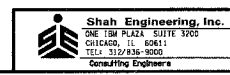

\*\*\*\*\*ref. file name\*\*\*\*\*  
 T:\DOCUMENT\1937501\STRUCT\DRN\RSIB02A.DGN  
 7-18-2005, 15:35:07  
 2, 3, 4, 5, 6, 7, 8, 9, 10, 11, 12, 13, 14, 15, 16, 17, 18, 19, 20, 21, 22, 23, 24, 25, 26, 27, 28, 29, 30, 31, 32, 33, 34, 35, 36, 37, 38, 39, 40, 41, 42, 43, 44, 45, 46, 47, 48, 49, 50, 51, 52, 53, 54, 55, 56, 57, 58, 59, 60, 61, 62, 63