

ROUTE	SECTION	COUNTY	TOTAL SHEETS	SHEET NUMBER
VARIOUS	2005-022LS	VARIOUS	22	8

CONTRACT 62951

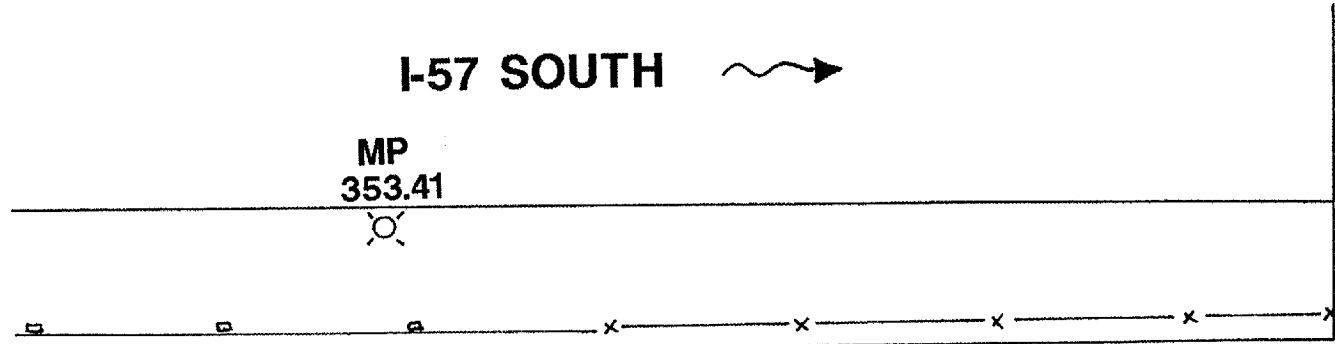

I-57 EXIT RAMP

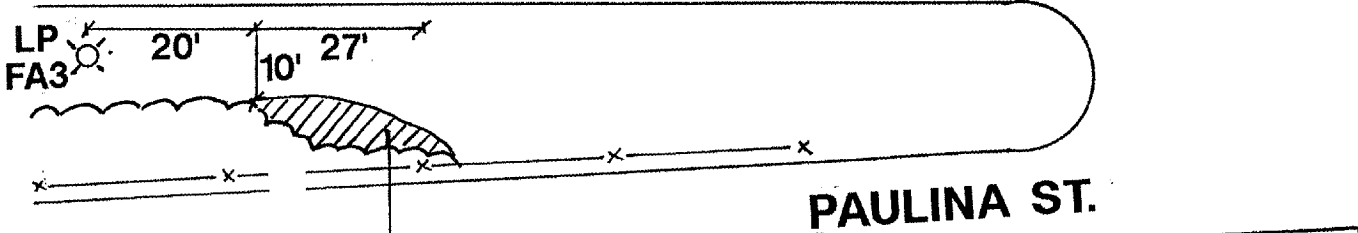

(8) CUTLEAF STAGHORN SUMAC
2'-3' O.C.

127TH ST.

GENERAL LOCATION MAP

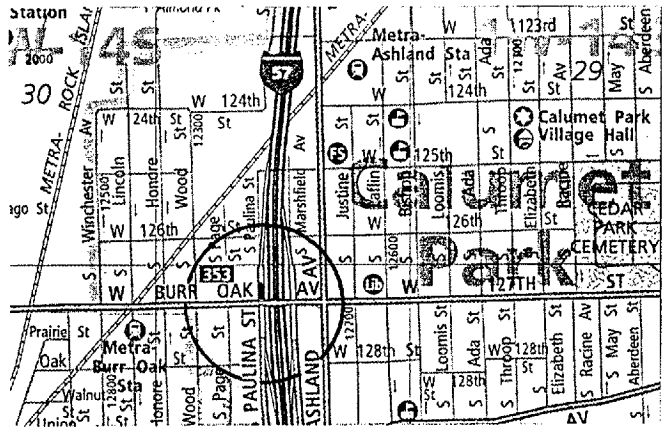

COUNTY: COOK
CLAIM #: 713891

CITY/TOWN: CALUMET PARK

SCHEDULE OF LANDSCAPE ITEMS	
DESCRIPTION	QTY/UNIT
RHUS TYPHINA 'LACINIATA' (CUTLEAF STAGHORN SUMAC)	8 EACH

ILLINOIS DEPARTMENT OF TRANSPORTATION
LANDSCAPE REPAIR LOCATION AND
LAYOUT PLAN