

| ROUTE | SECTION | COUNTY | TOTAL SHEETS | SHEET NUMBER |
|---------|------------|---------|--------------|--------------|
| VARIOUS | 2005-022LS | VARIOUS | 22 | 11 |

CONTRACT 62951

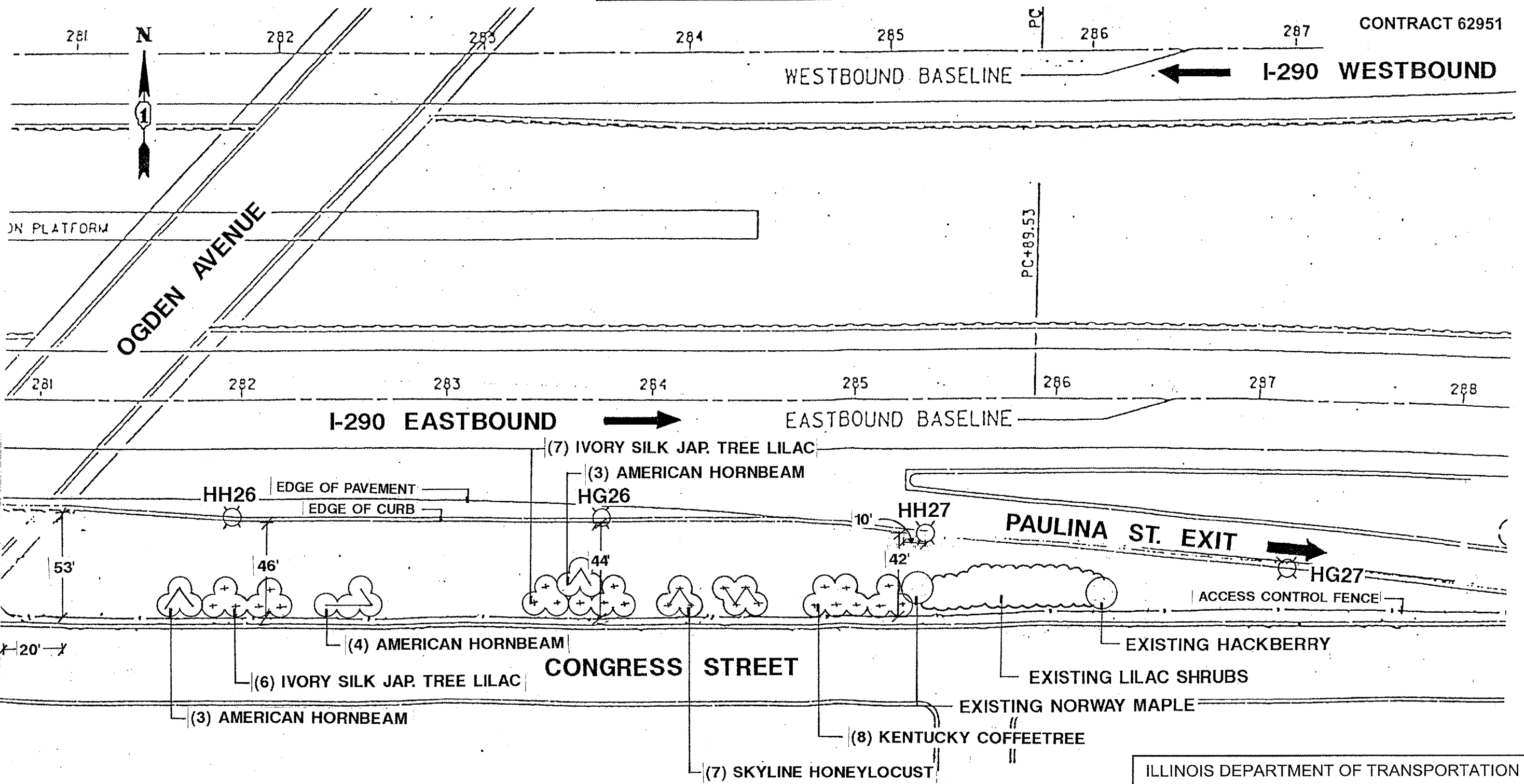

NOTE: PROPOSED LANDSCAPE SHALL BE PLANTED 10' AWAY FROM THE ACCESS CONTROL FENCE.

NOT DRAWN TO SCALE

ILLINOIS DEPARTMENT OF TRANSPORTATION
LANDSCAPE REPAIR LOCATION AND LAYOUT PLAN