

STATE OF ILLINOIS
DEPARTMENT OF TRANSPORTATION

| | | | | |
|------------------------|----------|------------------|--------------|-----------|
| ROUTE NO. | SECTION | COUNTY | TOTAL SHEETS | SHEET NO. |
| | | Will | 6 | 4 |
| SHEET NO. 1 | | | | |
| 2 SHEETS | | | | |
| FED. ROAD DIST. NO. 7 | ILLINOIS | FED. AID PROJECT | | |
| Contract Number: 62967 | | | | |

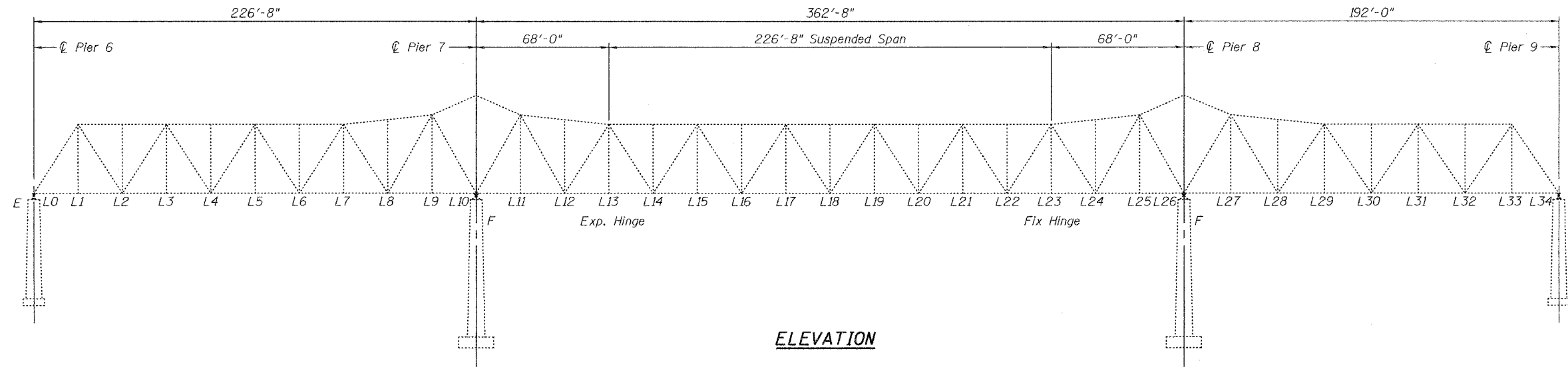

ELEVATION

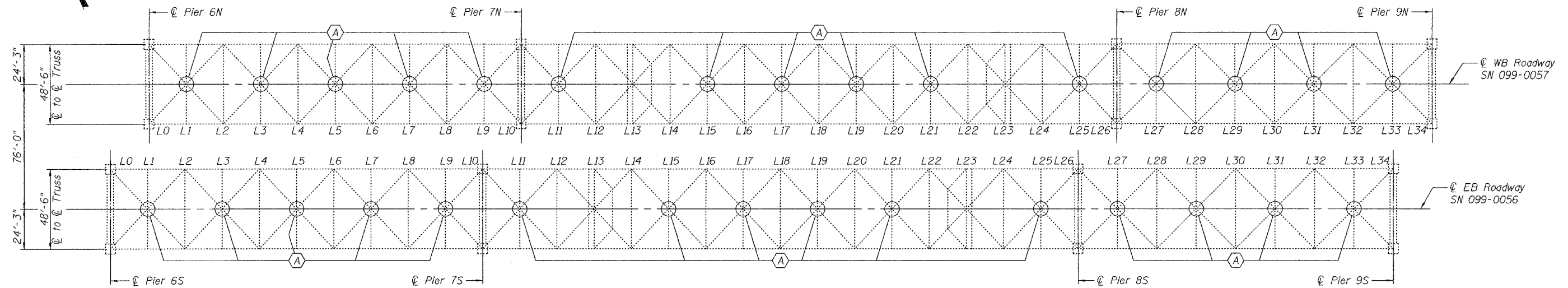

BOTTOM LATERAL BRACING PLAN

GENERAL NOTES

(A) Remove and replace gusset

All structural steel shall conform to AASHTO Classification M-270 Gr. 36, unless otherwise noted.

Fasteners shall be high strength bolts. Bolts 7/8"φ, open holes 15/16"φ, unless otherwise noted.

The Contractor shall grind all cracked welds parallel to the direction of the existing weld and not perpendicular to the weld.

Plan dimensions and details relative to existing structure have been taken from existing plans and are subject to nominal construction variations. It shall be the Contractor's responsibility to verify such dimensions and details in the field and make necessary approved adjustments prior to construction or ordering of materials. Such variations shall not be cause for additional compensation for a change in the scope of the work, however, the Contractor will be paid for the quantity actually furnished at the unit price bid for the work.

Cost of removal and re-installation of all members necessary to complete the work as detailed on the plans and as specified in the Special Provisions shall be included in the cost of Structural Steel Repair.

The existing structural steel coating contains lead. The Contractor should take appropriate precautions to deal with the presence of lead on this project.

Existing structural steel that will be in contact with new structural steel shall be cleaned and painted prior to erection as required by the Special Provision "Cleaning and Painting Contact Surface Areas of Existing Steel Structures".

All structural steel shall be shop painted with the inorganic zinc rich primer per AASHTO M300, Type 1. Cost included with Structural Steel Repair.

TOTAL BILL OF MATERIAL

| ITEM | UNIT | QUANTITY |
|-------------------------|-------|----------|
| Structural Steel Repair | Pound | 18,480 |

| | |
|----------|--------------------|
| DESIGNED | <i>[Signature]</i> |
| CHECKED | VECTOR H. VELTZ |
| DRAWN | <i>[Signature]</i> |
| CHECKED | S.J.B. / VHV |

November 10, 2005
EXAMINED John A. Morris
ENGINEER OF STRUCTURAL SERVICES
PASSED Ralph E. Anderson
ENGINEER OF BRIDGES AND STRUCTURES



Expires: November 30, 2006

PLAN AND ELEVATION
F.A.I. RT. 80 OVER
DES PLAINES RIVER
WILL COUNTY
SN 099-0056 (EB) & 0057 (WB)