

DATE  
 BY  
 SUBMITTED  
 PLOTTED  
 ALIGNED  
 CHECKED  
 FILED  
 NO.

DATE  
 BY  
 PROFILE  
 GRADES  
 CHECKED  
 STRUCTURE  
 NOTATIONS  
 CHKD  
 NO.

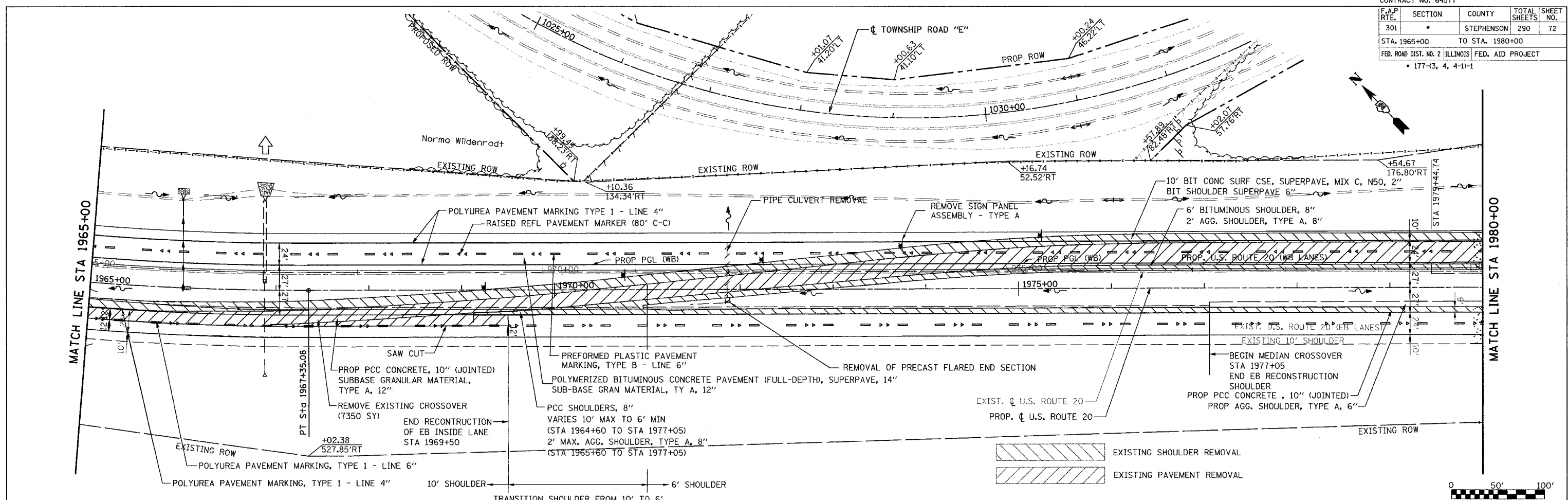

STATION	OUTSIDE LANE CROSS SLOPE	INSIDE LANE CROSS SLOPE	PAV. ELEV.		REMARKS
			OUTSIDE E.O.P. (51.00' LT.)	WB CENTERLINE (39.00' LT.)	
805	1966+63.08	-0.0530	678.07	678.70	END FULL SE
800	1966+75.00	-0.0501	678.35	678.95	
	1967+00.00	-0.0439	778.95	779.47	
795	1967+35.08	-0.0352	779.78	780.21	
	1967+50.00	-0.0316	780.14	780.52	
790	1967+75.00	-0.0254	780.74	781.05	
	1968+00.00	-0.0192	781.33	781.56	
785	1968+17.08	-0.0150	781.74	781.92	POINT C (1.5% SE)
	1968+50.00	-0.0150	782.43	782.61	
780	1968+79.00	-0.0150	783.03	783.21	0% SE
	1969+00.00	-0.0150	783.47	783.65	
775	1969+25.00	-0.0150	783.99	784.17	
	1969+41.08	-0.0150	784.33	784.51	BEGIN (NC)

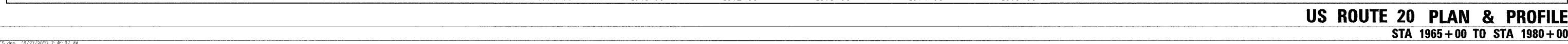

**US ROUTE 20 PLAN & PROFILE**  
 STA 1965+00 TO STA 1980+00