

CONTRACT NO. 64577

F.A.P. RTE.	SECTION	COUNTY	TOTAL SHEETS	SHEET NO.
301		STEPHENSON	290	103
STA. 1780+00		TO STA. 1810+00		
FED. ROAD DIST. NO. 2 ILLINOIS FED. AID PROJECT				

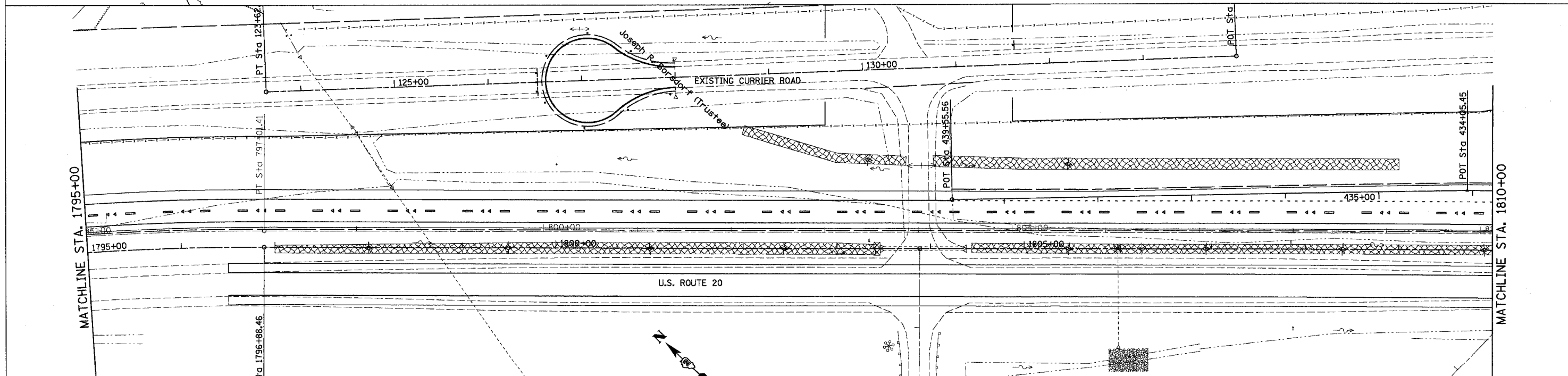
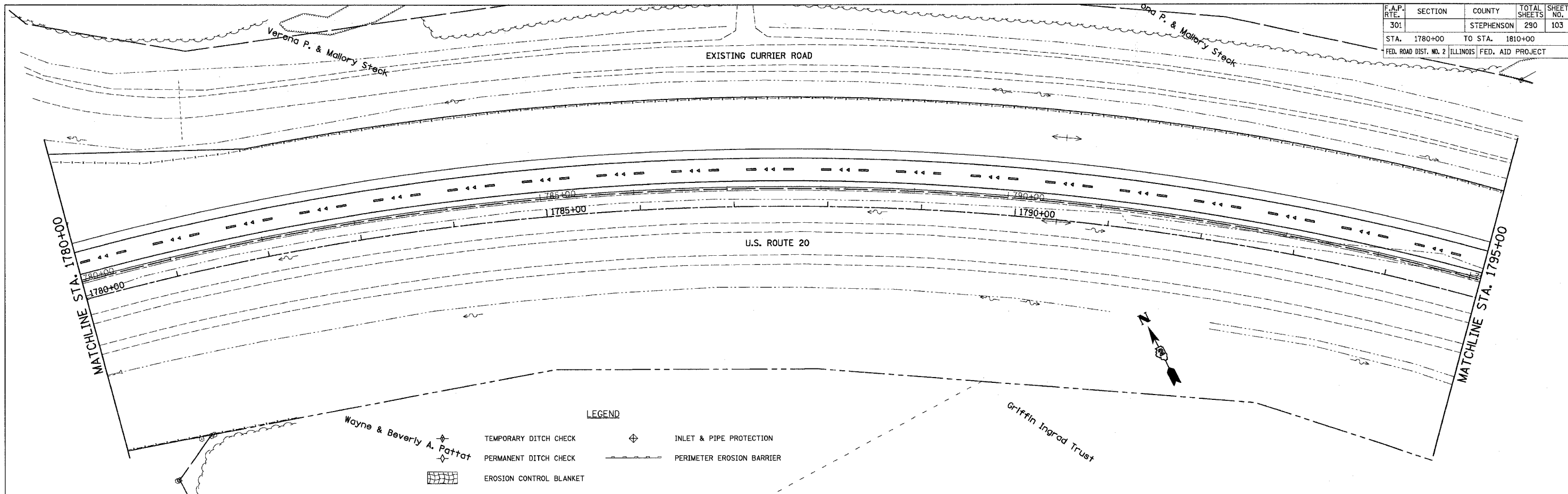

SEE SHEET NO.  
FOR CURRIER ROAD  
CUL-DE-SAC

REVISIONS	
NAME	DATE

ILLINOIS DEPARTMENT OF TRANSPORTATION

EROSION CONTROL  
U.S. ROUTE 20  
STA. 1780+00 TO STA. 1810+00

SCALE: VERT. 1" = 50'  
HORIZ. 1" = 50'  
DATE 7/15/05

DRAWN BY JS  
CHECKED BY JC