

F.A.P. RTE.	SECTION	COUNTY	TOTAL SHEETS	SHEET NO.
301		STEPHENSON	290	111
STA.		TO STA.		
FED. ROAD DIST. NO. 2 ILLINOIS		FED. AID PROJECT		

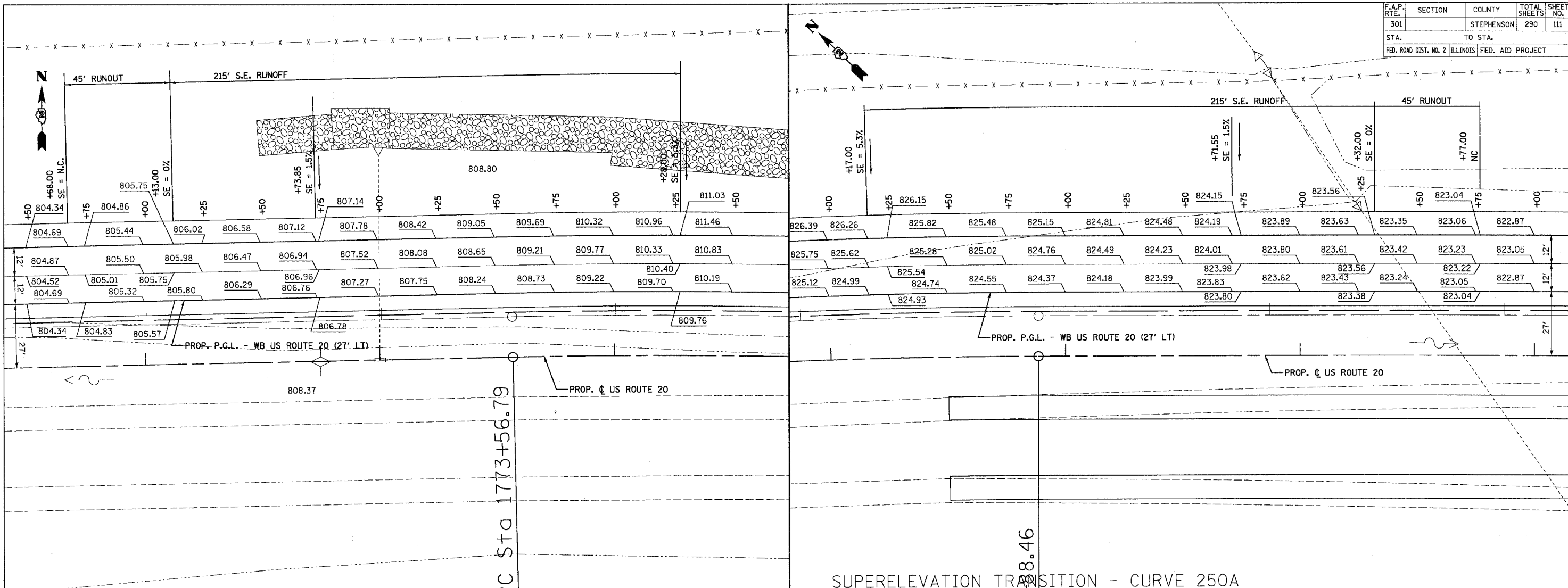

SUPERELEVATION TRANSITION - CURVE 250A

STATION	INSIDE LANE CROSS SLOPE	OUTSIDE LANE CROSS SLOPE	OUTSIDE E.O.P. PAVT. ELEV. 51.00' LT.	WB CENTERLINE PAVT. ELEV. 39.00' LT.	INSIDE E.O.P. (PGL) PAVT. ELEV. 27.00' LT.	REMARKS
1771+50.00	-0.0150	0.0150	804.34	804.52	804.34	
1771+68.00	-0.0150	0.0150	804.69	804.87	804.69	BEGIN (NC)
1771+75.00	-0.0127	0.0150	804.86	805.01	804.83	
1772+00.00	-0.0043	0.0150	805.44	805.50	805.32	
1772+13.00	0.0000	0.0150	805.75	805.75	805.57	0% SE
1772+25.00	0.0030	0.0150	806.02	805.98	805.80	
1772+50.00	0.0091	0.0150	806.58	806.47	806.29	
1772+73.85	0.0150	0.0150	807.12	806.94	806.76	POINT C (1.5% SE)
1772+75.00	0.0153	0.0153	807.14	806.96	806.78	
1773+00.00	0.0214	0.0214	807.78	807.52	807.27	
1773+25.00	0.0276	0.0276	808.42	808.08	807.75	
1773+50.00	0.0338	0.0338	809.05	808.65	808.24	
1773+56.79	0.0354	0.0354	809.22	808.80	808.37	PC (2/3 e)
1773+75.00	0.0399	0.0399	809.69	809.21	808.73	
1774+00.00	0.0461	0.0461	810.32	809.77	809.22	
1774+25.00	0.0523	0.0523	810.96	810.33	809.70	
1774+28.00	0.0530	0.0530	811.03	810.40	809.76	END (FULL SE; SE = e)
1774+50.00	0.0530	0.0530	811.46	810.83	810.19	

SUPERELEVATION TRANSITION - CURVE 250A

STATION	INSIDE LANE CROSS SLOPE	OUTSIDE LANE CROSS SLOPE	OUTSIDE E.O.P. PAVT. ELEV. 51.00' LT.	WB CENTERLINE PAVT. ELEV. 39.00' LT.	INSIDE E.O.P. (PGL) PAVT. ELEV. 27.00' LT.	REMARKS
1796+00.00	0.0530	0.0530	826.39	825.75	825.12	
1796+17.00	0.0530	0.0530	826.26	825.62	824.99	BEGIN (FULL SE; SE = e)
1796+25.00	0.0510	0.0510	826.15	825.54	824.93	
1796+50.00	0.0449	0.0449	825.82	825.28	824.74	
1796+75.00	0.0387	0.0387	825.48	825.02	824.55	
1796+88.46	0.0354	0.0354	825.30	824.88	824.45	PT (2/3 e)
1797+00.00	0.0325	0.0325	825.15	824.76	824.37	
1797+25.00	0.0264	0.0264	824.81	824.49	824.18	
1797+50.00	0.0202	0.0202	824.48	824.23	823.99	
1797+71.15	0.0150	0.0150	824.19	824.01	823.83	POINT C (1.5% SE)
1797+75.00	0.0141	0.0150	824.15	823.98	823.80	
1798+00.00	0.0079	0.0150	823.89	823.80	823.62	
1798+25.00	0.0017	0.0150	823.63	823.61	823.43	
1798+32.00	0.0000	0.0150	823.56	823.56	823.38	0% SE
1798+50.00	-0.0060	0.0150	823.35	823.42	823.24	
1798+75.00	-0.0143	0.0150	823.06	823.23	823.05	
1798+77.00	-0.0150	0.0150	823.04	823.22	823.04	END (NC)
1799+00.00	-0.0150	0.0150	822.87	823.05	822.87	

REVISIONS	
NAME	DATE

ILLINOIS DEPARTMENT OF TRANSPORTATION  
**PAVEMENT ELEVATIONS  
 US ROUTE 20 (WB)  
 SUPERELEVATION TRANSITION**

SCALE: VERT. 1" = 20'  
 HORIZ. 1" = 20'  
 DATE 7/15/05

DRAWN BY MPK  
 CHECKED BY JLC