

P.A. #	SECTION	COUNTY	TOTAL SHEETS	SHEET NO
301		**	290	148
STA.		TO STA.		
FED. ROAD DIST. NO.	ILLINOIS	FED. AID PROJECT		

NOTE: REFER TO CONTRACT NO. 64532 PLANS FOR AS-BUILT CROSS SECTION INFORMATION.

FINAL SURVEY DATE  
 SUBMITTED BY  
 NOTE BOOK NO.  
 TEMPLATE AREAS CHECKED

ORIGINAL SURVEY DATE  
 SUBMITTED BY  
 NOTE BOOK NO.  
 TEMPLATE AREAS CHECKED

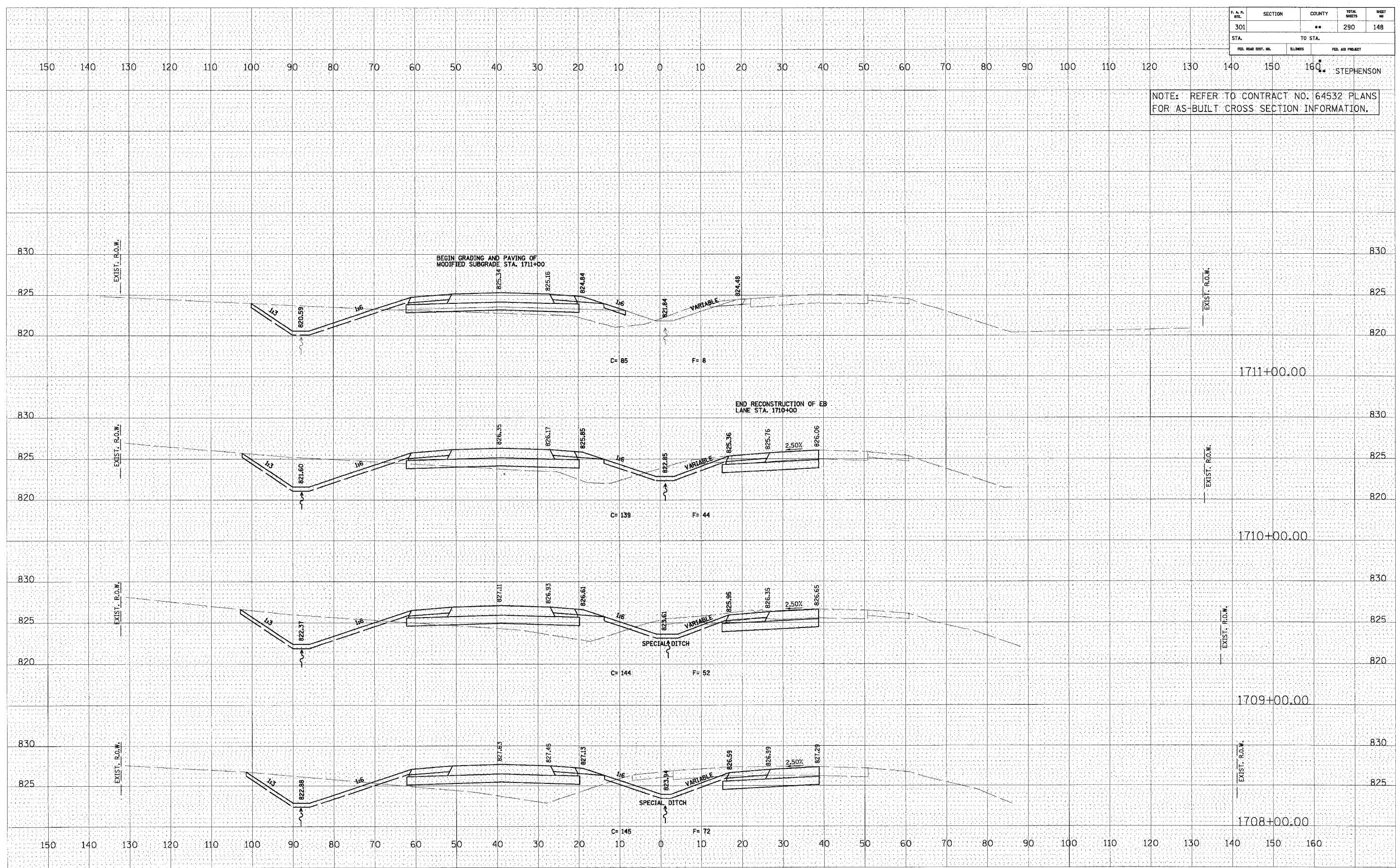

U.S. ROUTE 20