

F. & P. SECTION		COUNTY		TOTAL SHEETS	SHEET NO.
301 177(3,4,4-1)-1		STEPHENS		290	225
STA.		TO STA.			
FED. ROAD DIST. NO. 2	ELIMINATED	FED. AID PROJECT			

FINAL	DATE
BY	
REVISIONS	
SURVEY	
NOTED	
PLOTTED	
TEMPLATE	
AREAS	
CHECKED	
NO.	

ORIGINAL	DATE
BY	
REVISIONS	
SURVEY	
NOTED	
PLOTTED	
TEMPLATE	
AREAS	
CHECKED	
NO.	

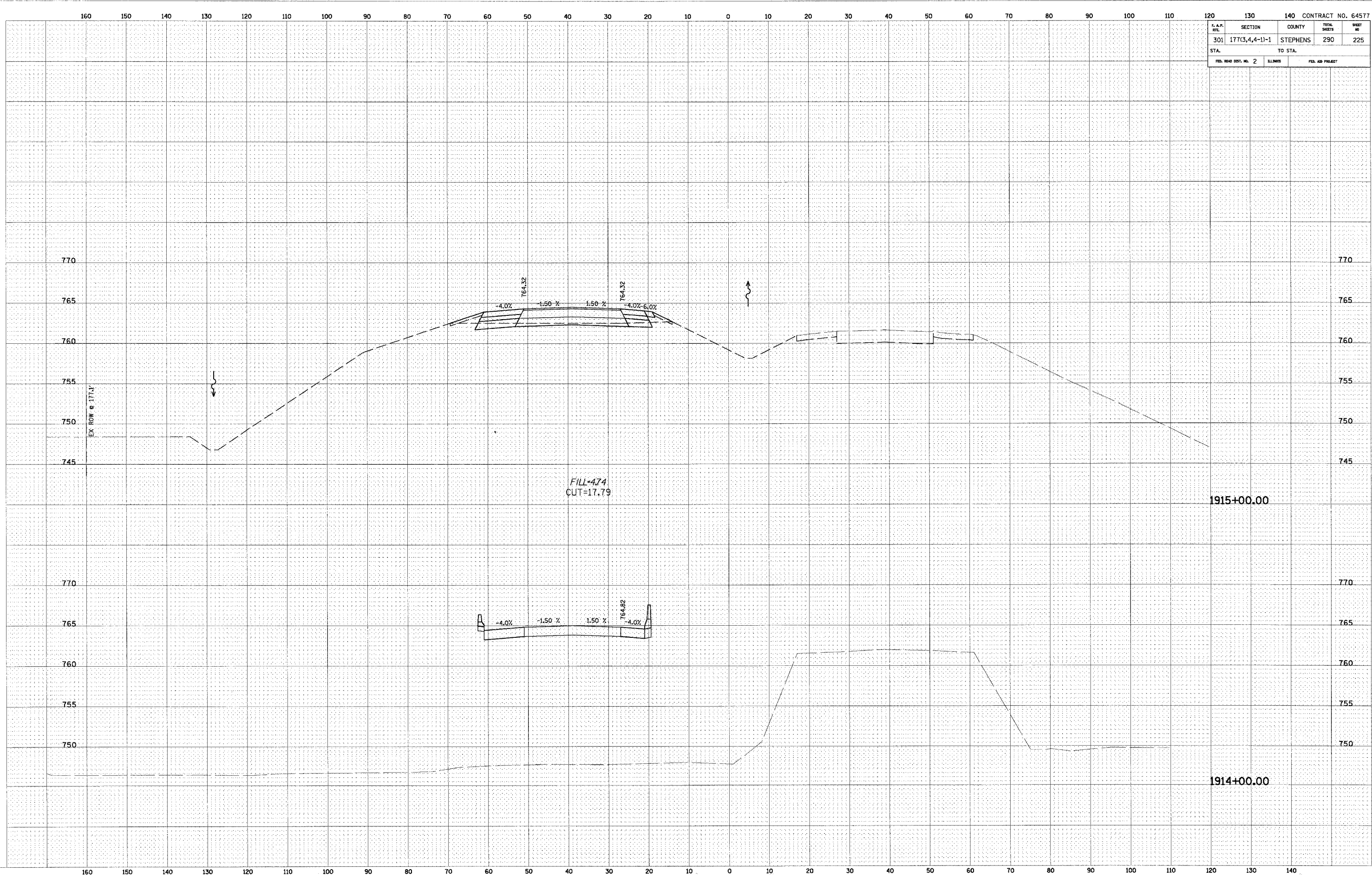

CROSS SECTION - US ROUTE 20