

CONTRACT NO. 64577

F. A. P. NO.	SECTION	COUNTY	TOTAL SHEETS	SHEET NO.
301		**	290	248
STA.		TO STA.		
FED. ROAD DIST. NO.		ILLINOIS		FED. AID PROJECT

NOTE: REFER TO CONTRACT NO. 64532 PLANS FOR AS-BUILT CROSS SECTION INFORMATION.

FINAL SURVEY
 BY: _____ DATE: _____
 REVIEWED BY: _____
 NOTE BOOK NO. _____
 TEMPLATE AREAS CHECKED

ORIGINAL SURVEY
 BY: _____ DATE: _____
 REVIEWED BY: _____
 NOTE BOOK NO. _____
 TEMPLATE AREAS CHECKED

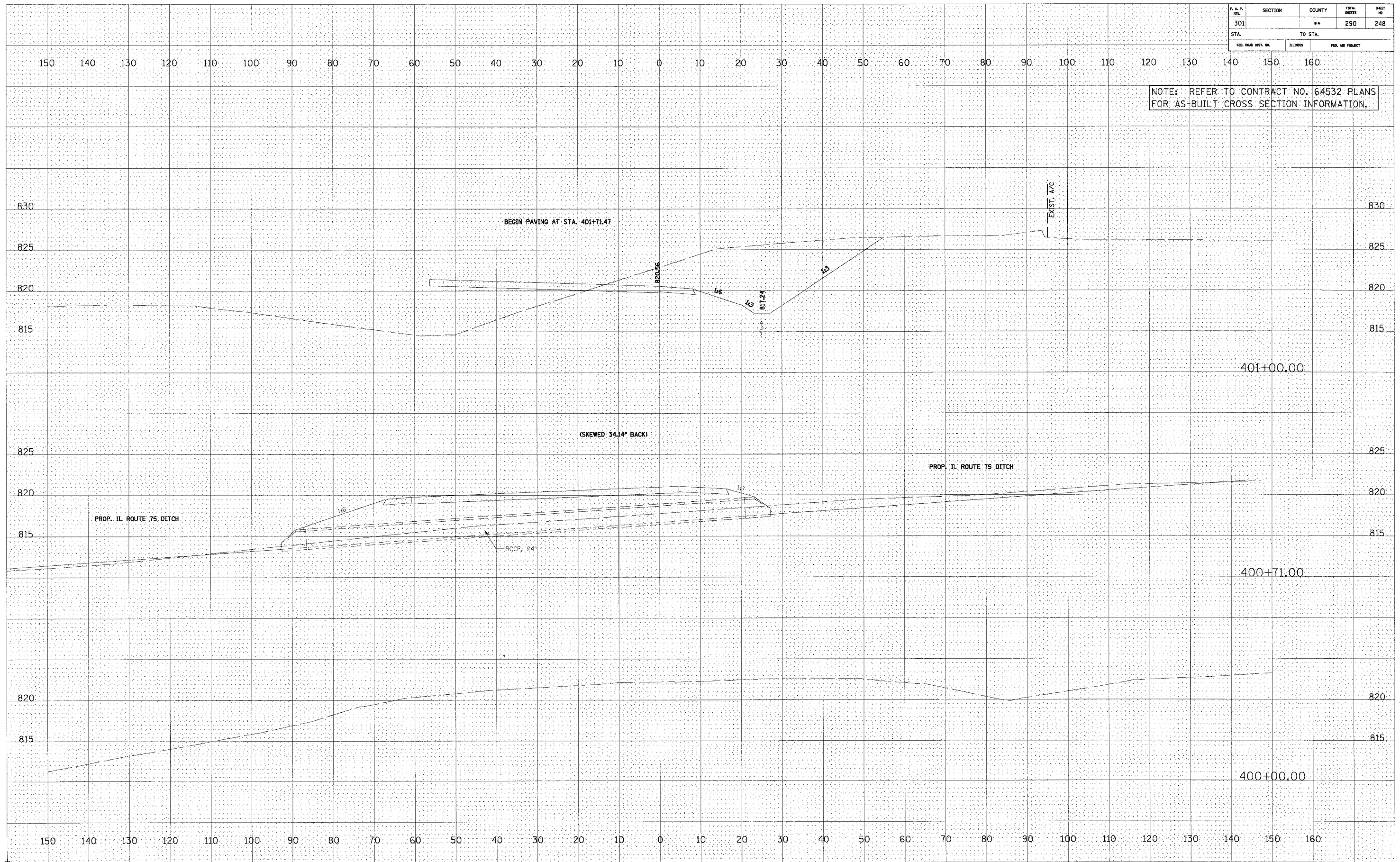

RAMP CA