

F.A.P. RTE.	SECTION	COUNTY	TOTAL SHEETS	SHEET NO.
22	6M & TS	HENRY	257	50
STA.		TO STA.		
FED. ROAD DIST. NO.		ILLINOIS FED. AID PROJECT		

STAGE 3A & 3

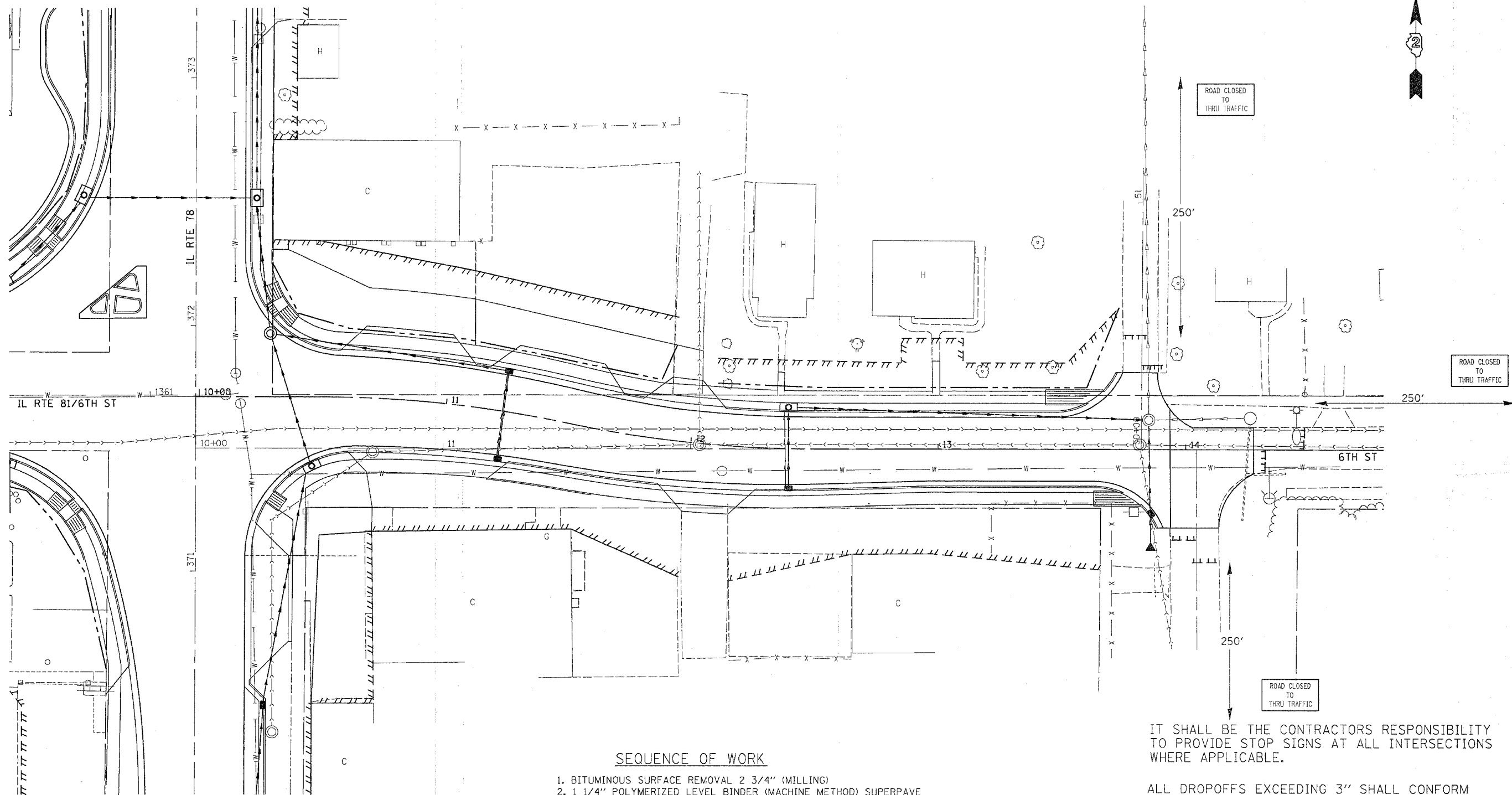

SEQUENCE OF WORK

1. BITUMINOUS SURFACE REMOVAL 2 3/4" (MILLING)
2. 1 1/4" POLYMERIZED LEVEL BINDER (MACHINE METHOD) SUPERPAVE
3. STRIP CRACK CONTROL, IF NECESSARY.
4. 1 1/2" POLYMERIZED BIT. CONCRETE SURFACE COURSE
5. PLACE BITUMINOUS OVERLAYS ON 6TH AND 7TH ST
6. PAVEMENT MARKINGS & RAISED REFLECTIVE PAVEMENT MARKERS

IT SHALL BE THE CONTRACTORS RESPONSIBILITY TO PROVIDE STOP SIGNS AT ALL INTERSECTIONS WHERE APPLICABLE.

ALL DROPOFFS EXCEEDING 3" SHALL CONFORM TO ARTICLE 701.04(b)(1).

TRAFFIC CONTROL LEGEND

- DRUM WITH LIGHT
- TYPE III BARRICADE WITH FLASHERS

REVISIONS	
NAME	DATE

ILLINOIS DEPARTMENT OF TRANSPORTATION

SCALE: VERT. HORIZ. DATE

DRAWN BY CHECKED BY

PLOT DATE = Thu, Oct 27 10:28:24 2005
 FILE NAME = c:\pvc\mch\112185800\112185800.dgn
 PLOT SCALE = 28.80000 "/> IN.
 REFERENCE = *REF*