

| | | | | |
|---------------------|---------------------------|--------|--------------|-----------|
| F.A.I. RTE. | SECTION | COUNTY | TOTAL SHEETS | SHEET NO. |
| 80 | 32-2HBR | GRUNDY | 171 | 32 |
| STA. | TO STA. | | | |
| FED. ROAD DIST. NO. | ILLINOIS FED. AID PROJECT | | | |
| CONTRACT NO. | 66412 | | | |

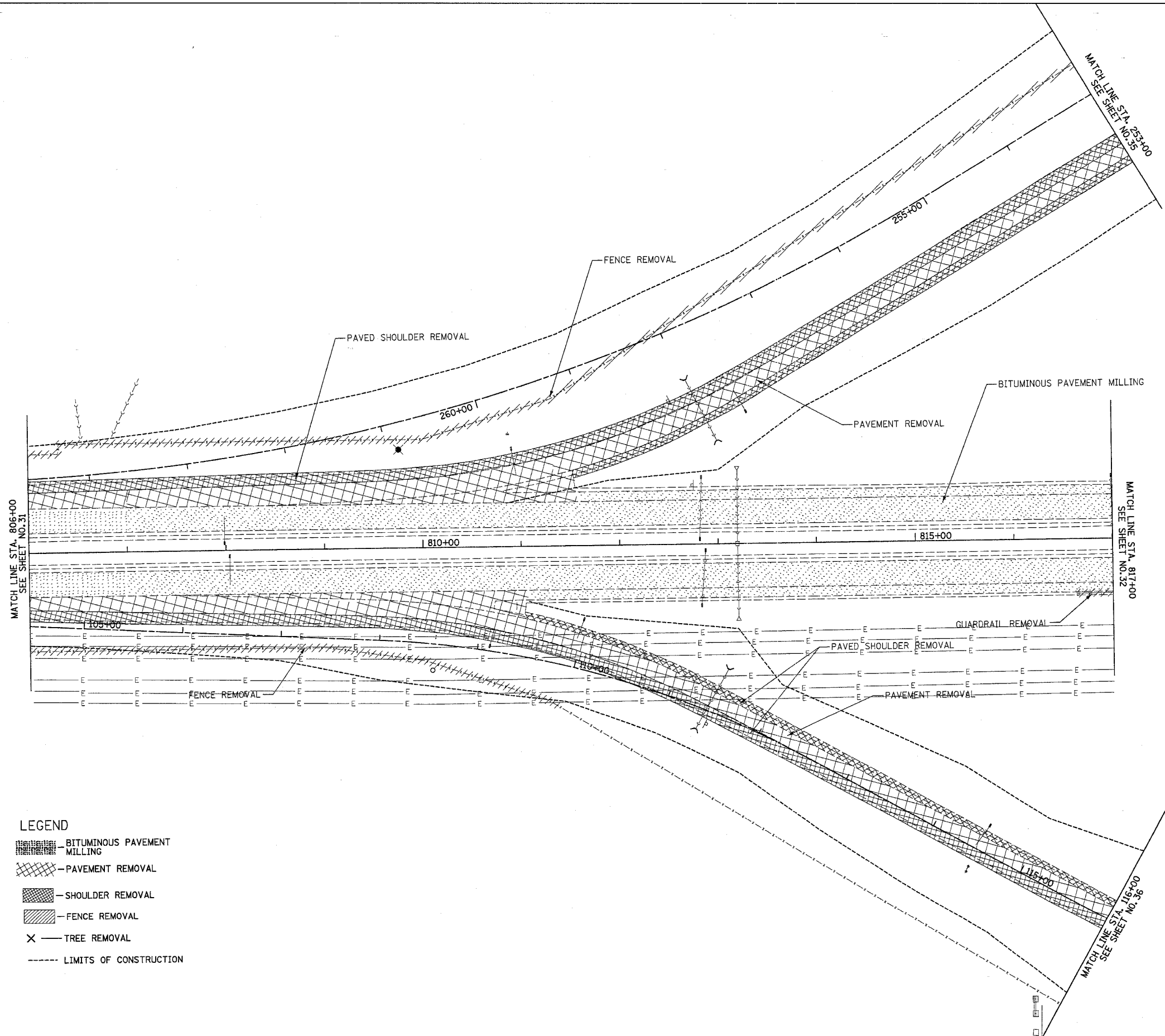

- LEGEND**
- BITUMINOUS PAVEMENT MILLING
 - PAVEMENT REMOVAL
 - SHOULDER REMOVAL
 - FENCE REMOVAL
 - TREE REMOVAL
 - LIMITS OF CONSTRUCTION

| REVISIONS | |
|-----------|------|
| NAME | DATE |
| | |
| | |
| | |
| | |
| | |
| | |
| | |
| | |
| | |
| | |

ILLINOIS DEPARTMENT OF TRANSPORTATION
**I-80 (F.A.I. 80) AT
 SENECA ROAD (F.A.P. 623)
 GRUNDY COUNTY**
 REMOVAL PLAN
 RAMP A, RAMP D
 SCALE: 1" = 50'
 DATE 08/16/04
 DRAWN BY NMR/BJG
 CHECKED BY DJL/JPL