

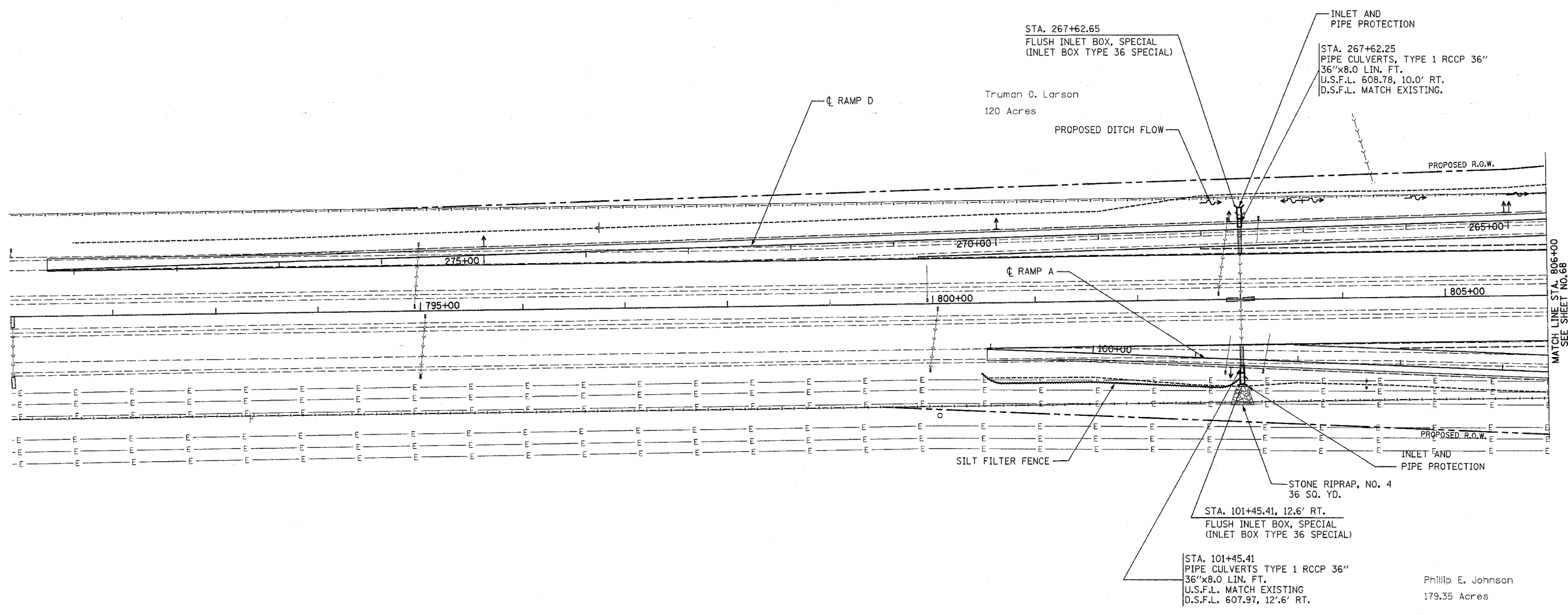

DRAINAGE NOTES

1. PIPE UNDERDRAINS, 4", (MODIFIED) SHALL BE PLACED ALONG ALL RAMP EDGES OF PAVEMENT, AS SHOWN IN THE PROPOSED TYPICAL SECTIONS. CONCRETE HEADWALLS FOR PIPE UNDERDRAINS 4" (SPECIAL) SHALL BE PLACED AT A MAXIMUM SPACING OF 500'.
2. FOR DETAILS OF CONSTRUCTION AT DRAINAGE STRUCTURES, SEE ROADWAY AND DRAINAGE DETAILS SHEETS.
3. FOR PROPOSED CURVE DATA, SEE ROADWAY ALIGNMENT SHEET.

F.A.I. RTE.	SECTION	COUNTY	TOTAL SHEETS	SHEET NO.
80	32-2HBR	GRUNDY	171	67
STA.		TO STA.		
FED. ROAD DIST. NO.		ILLINOIS	FED. AID PROJECT	
CONTRACT NO.		66412		



MATCH LINE STA. 806+00
SEE SHEET NO. 68

REVISIONS	
NAME	DATE

ILLINOIS DEPARTMENT OF TRANSPORTATION
**I-80 (F.A.I. 80) AT
 SENECA ROAD (F.A.P. 623)
 GRUNDY COUNTY**
 EROSION CONTROL AND DRAINAGE PLAN
 RAMP A, RAMP D
 SCALE: 1" = 50'
 DATE 08/16/04
 DRAWN BY NMR/BJG
 CHECKED BY DJL/JPL