

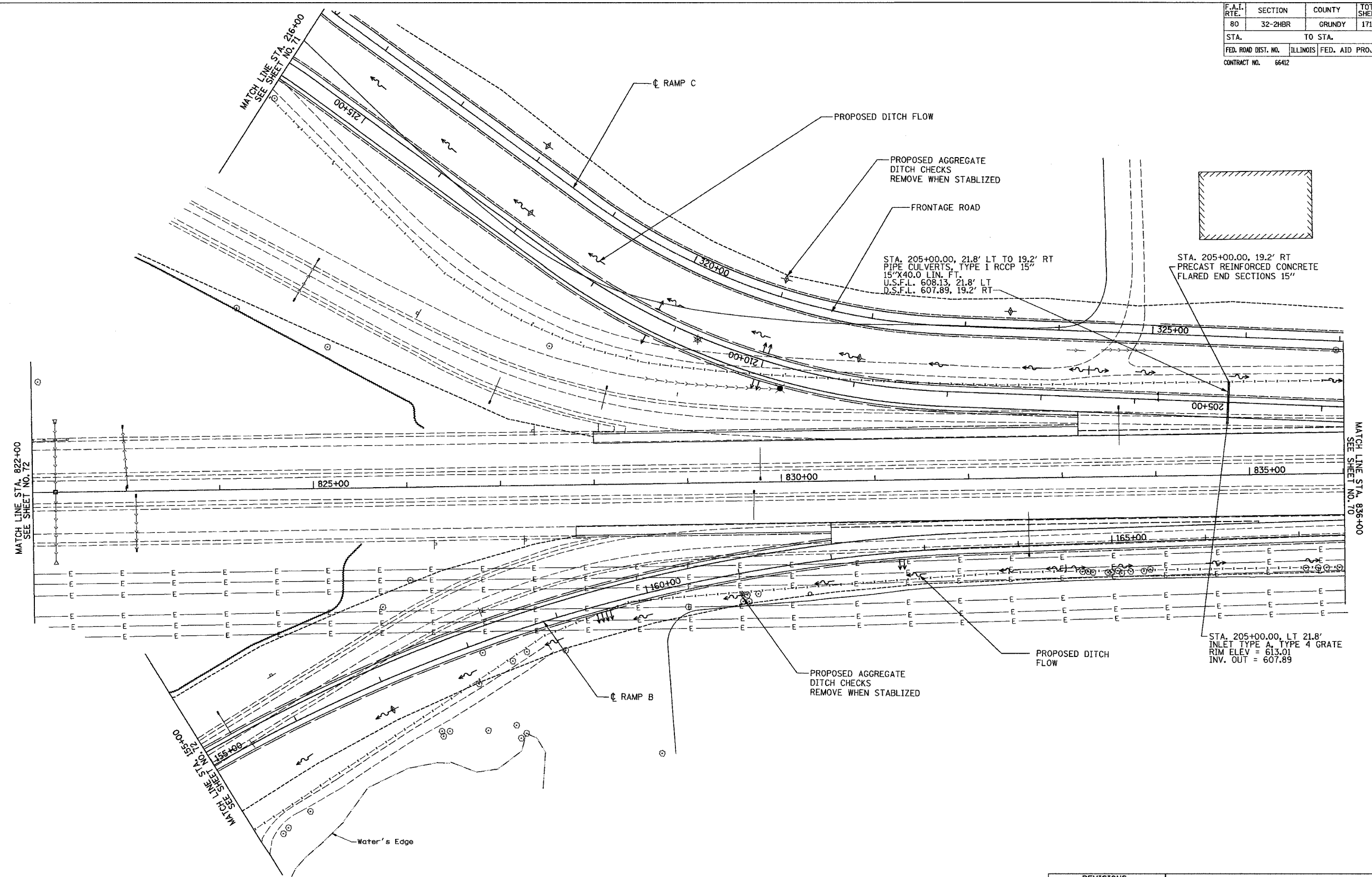

F.A.I. RTE.	SECTION	COUNTY	TOTAL SHEETS	SHEET NO.
80	32-2HBR	GRUNDY	171	69
STA.	TO STA.			
FED. ROAD DIST. NO.	ILLINOIS	FED. AID PROJECT		
CONTRACT NO. 66412				

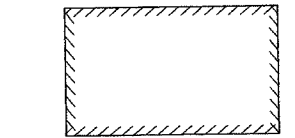

STA. 205+00.00, 21.8' LT TO 19.2' RT  
 PIPE CULVERTS, TYPE I RCCP 15"  
 15"X40.0 LIN. FT.  
 U.S.F.L. 608.13, 21.8' LT  
 D.S.F.L. 607.89, 19.2' RT



STA. 205+00.00, 19.2' RT  
 PRECAST REINFORCED CONCRETE  
 FLARED END SECTIONS 15"

STA. 205+00.00, LT 21.8'  
 INLET TYPE A, TYPE 4 GRATE  
 RIM ELEV = 613.01  
 INV. OUT = 607.89

REVISIONS	
NAME	DATE

ILLINOIS DEPARTMENT OF TRANSPORTATION  
**I-80 (F.A.I. 80) AT  
 SENECA ROAD (F.A.P. 623)  
 GRUNDY COUNTY**  
 EROSION CONTROL AND DRAINAGE PLAN  
 RAMP B, RAMP C  
 SCALE: 1" = 50'  
 DATE 08/16/04  
 DRAWN BY NMR/BJG  
 CHECKED BY DJL/JPL