

F.A.P.	SECTION	COUNTY	TOTAL SHEETS	SHEET NO.
623	32-2 HBR	GRUNDY	171	99
STA.		TO STA.		
FED. ROAD DIST. NO.	ILLINOIS	FED. AID PROJECT		
CONTRACT NO. 66412				
SHEET S6 OF S20				

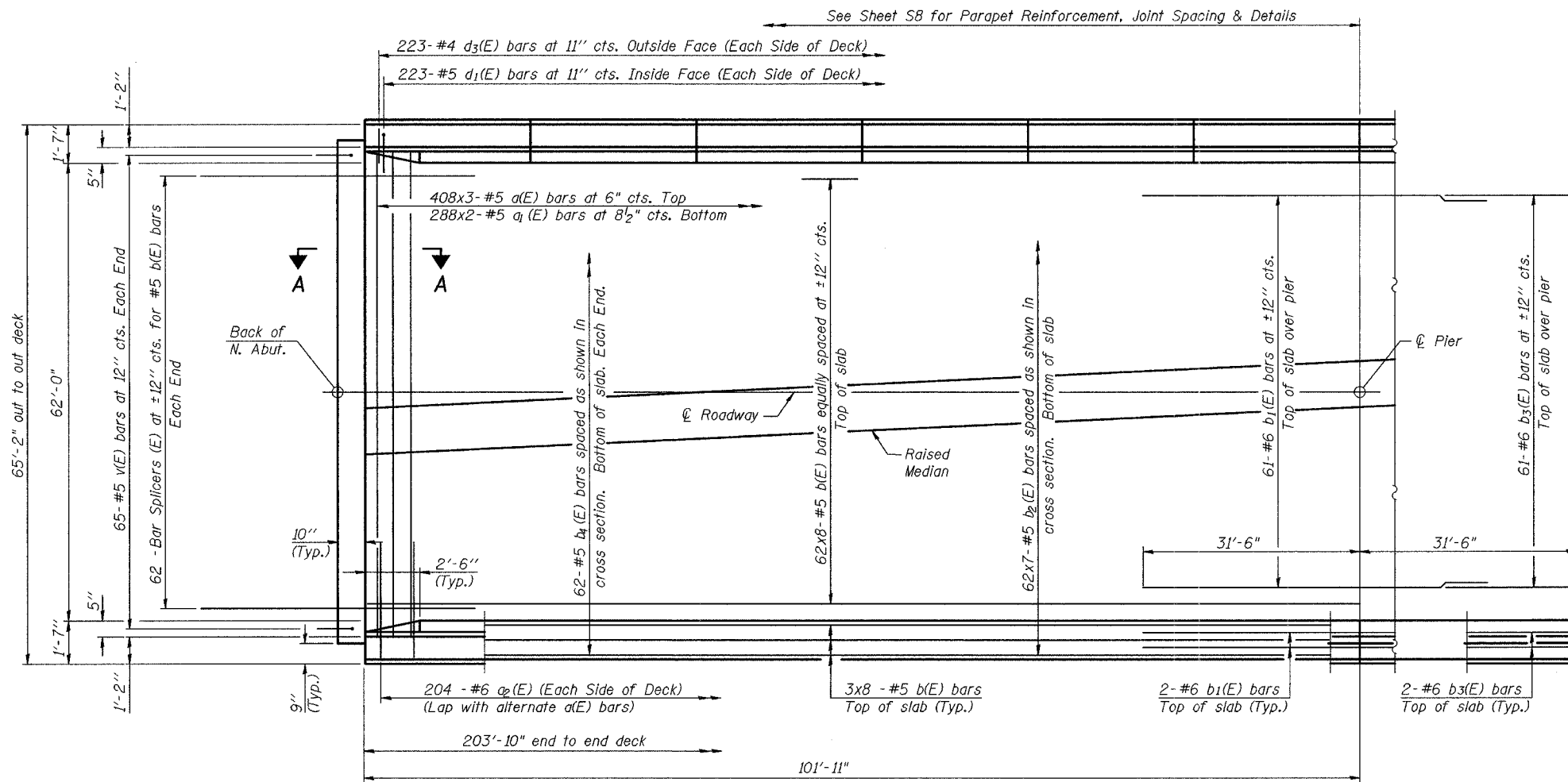

PLAN

Note: Symmetric about Pier except where noted otherwise

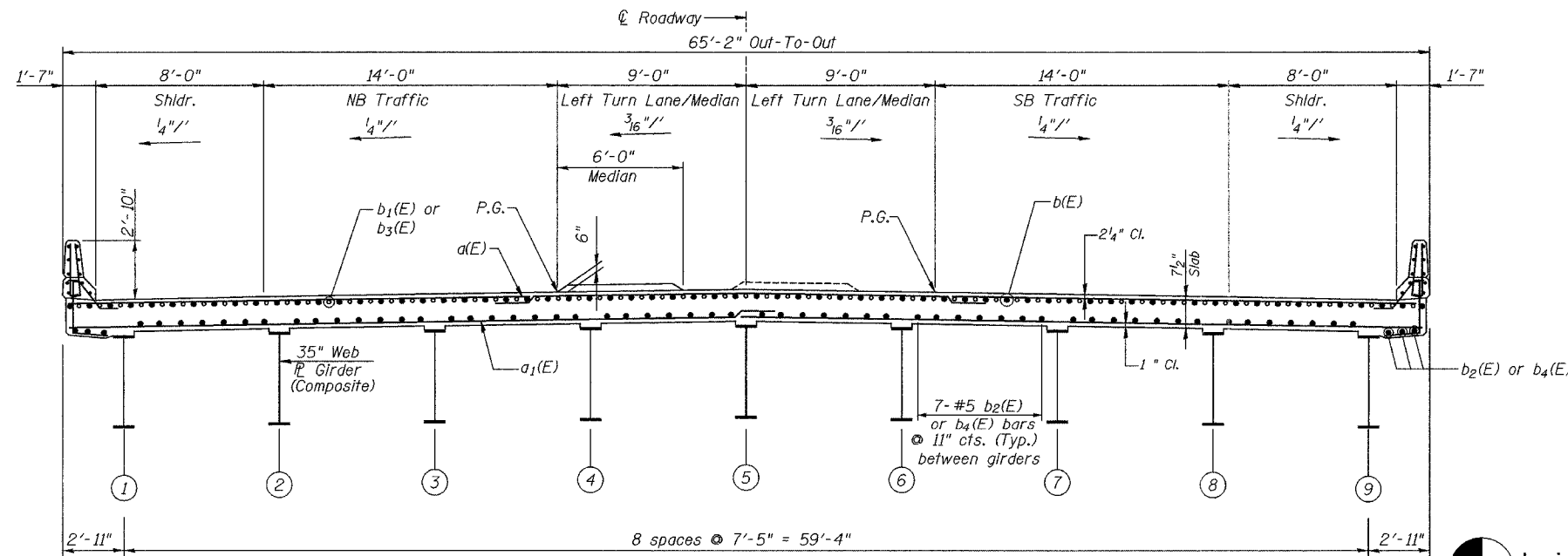

TYPICAL CROSS SECTION
(Looking Upstation)

Notes:
See Sheets S7 and S8 of S20 for Superstructure Details and Bill of Material.
Reinforcement bars designated (E) shall be epoxy coated.
Bars indicated thus 20 x 3-#5 etc. indicates 20 lines of bars with 3 lengths per line.
See Sheets S7 and S8 of S20 for parapet reinforcement.
See Sheet S7 of S20 for Section A-A.
See Sheet S7 of S20 for Median Detail.

MIN. BAR LAP

- #4 bar = 1'-8"
- #5 bar = 2'-2"
- #6 bar = 2'-9"

REVISIONS	NAME	DATE

ILLINOIS DEPARTMENT OF TRANSPORTATION
SENECA ROAD
OVER F.A.I. 80
F.A.P. 623 SEC. 32-2 HBR GRUNDY CO.
STRUCTURE No. 032-0114
STATION 19+49.99
SUPERSTRUCTURE

Louis Berger & Associates, Inc.
1001 Elm Street, Suite 300
Manchester, NH 03101

SCALE: NONE
DATE: OCTOBER, 2005
DRAWN BY: NJH
CHECKED BY: JLG