

STATE OF ILLINOIS
DEPARTMENT OF TRANSPORTATION

ROUTE NO.	SECTION	COUNTY	TOTAL SHEETS	SHEET NO.
FAP 315		McLEAN	44	22
STA.	TO STA.			
FED. ROAD DIST. NO.	ILLINOIS	FED. AID PROJECT-		
*102X-BR-2	DWG. NO. 10	OF 17		

CONTRACT NO. 66584

*Epoxy grout bars in 8" min. depth drilled holes according to section 584 of the Standard Specifications.

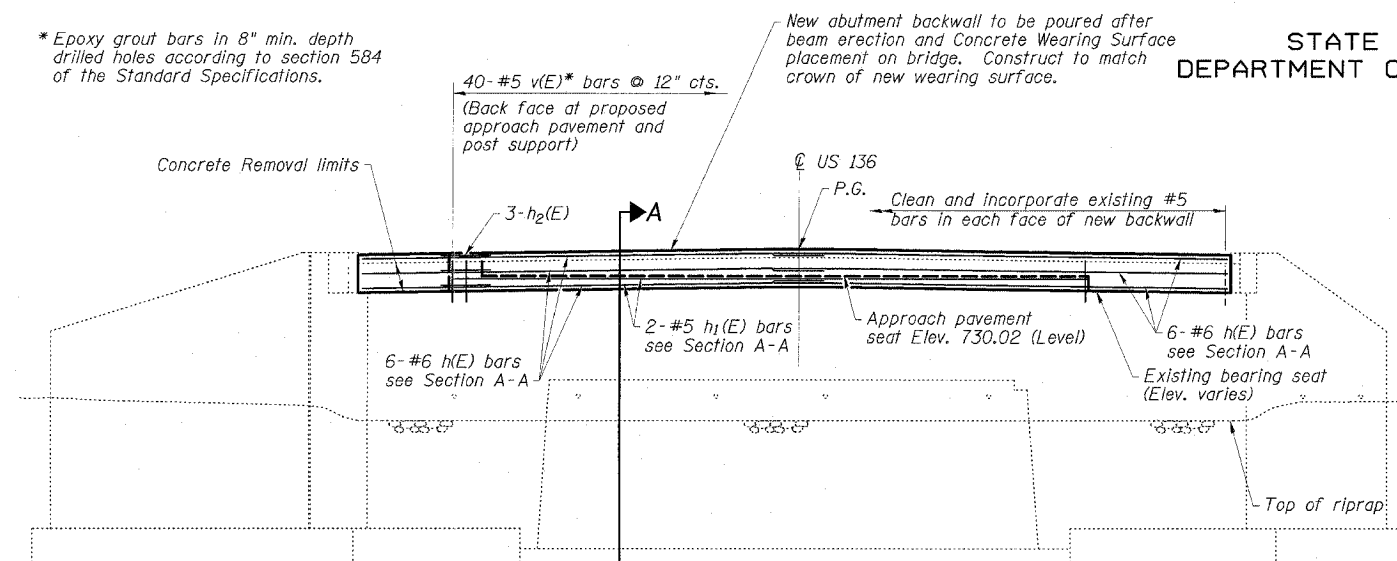

ELEVATION
Backwall Repairs

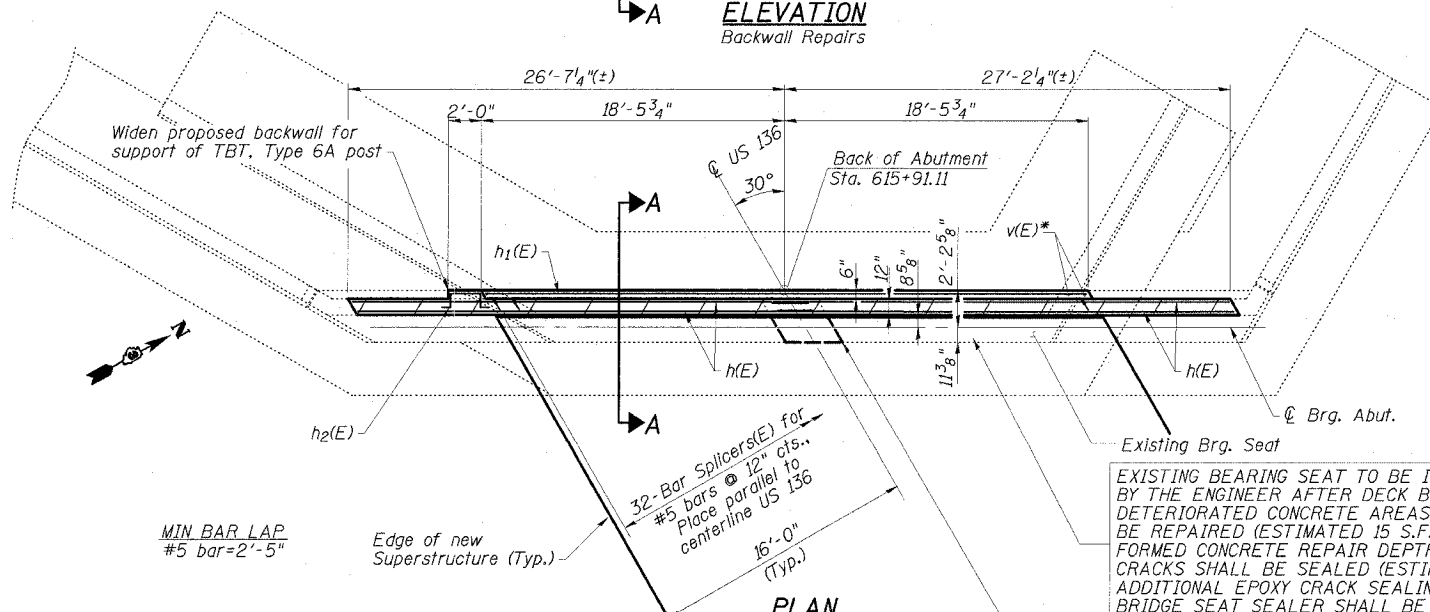

PLAN

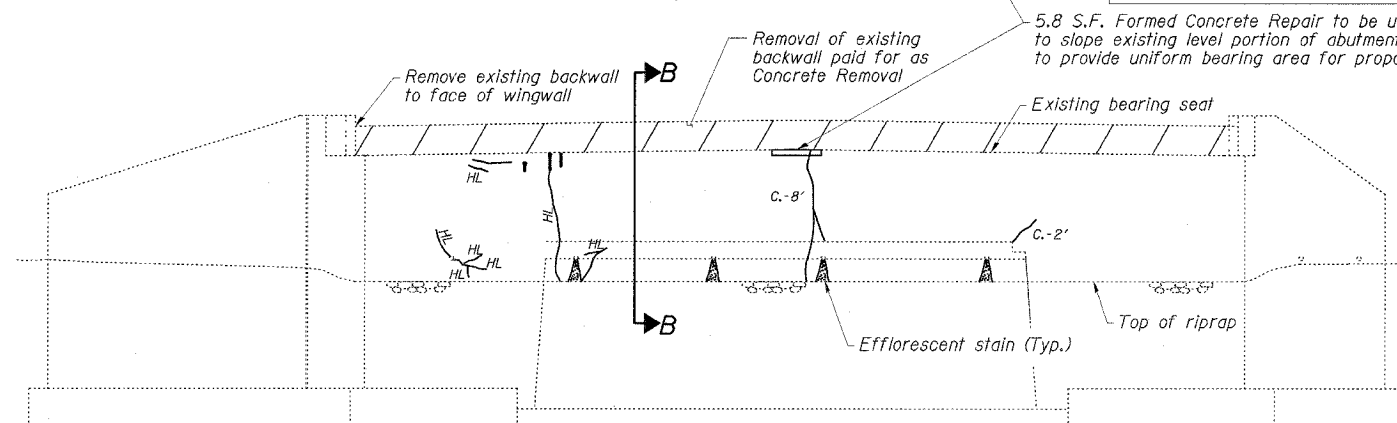

ELEVATION
Abutment and Wingwall Repairs

NOTE: ABUTMENT CRACK REPAIR LENGTHS AND FORMED CONCRETE REPAIR AREAS ARE ESTIMATED FROM 11-15-01 SURVEY WORK. ACTUAL LOCATIONS AND QUANTITIES OF REPAIRS SHALL BE SHOWN BY THE ENGINEER ON THE AS-BUILT PLANS FOR THIS SECTION.

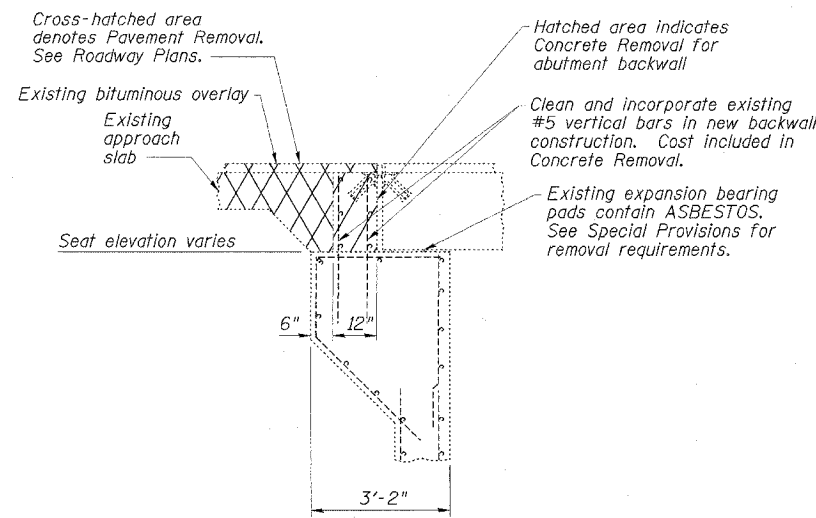

SECTION B-B
EXISTING

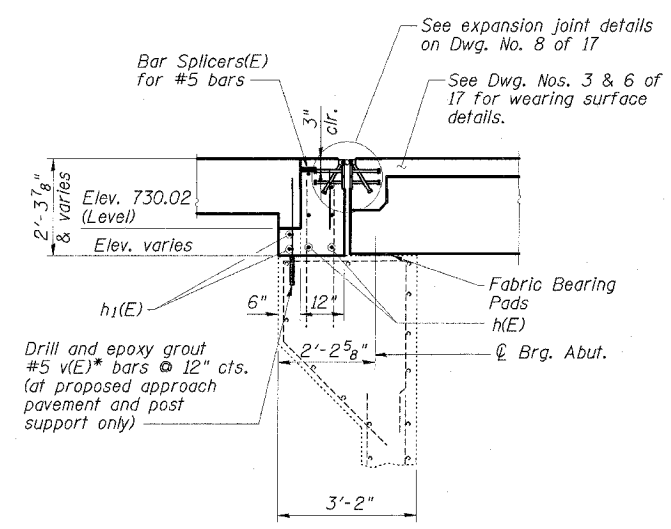

SECTION A-A
PROPOSED

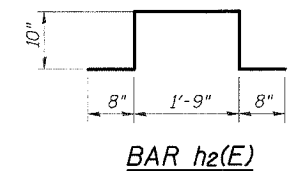

BAR h2(E)

WEST ABUTMENT
BILL OF MATERIAL

Bar	No.	Size	Length	Shape
h (E)	12	#6	27'-11"	—
h1(E)	2	#5	36'-6"	—
h2(E)	3	#5	4'-9"	┌
v (E)	40	#5	2'-6"	—
Concrete Removal			Cu. Yd.	3.6
Concrete Structures			Cu. Yd.	5.3
Reinforcement Bars, Epoxy Coated			Pound	700
Asbestos Bearing Pad Removal			Each	30
Bridge Seat Sealer			Sq. Ft.	21
Epoxy Crack Sealing			Foot	30
Formed Concrete Repair (Depth Equal to or Less Than 5")			Sq. Ft.	20.8
Bar Splicers			Each	32

REPAIR LEGEND

- Inspection Date: 11-15-01
- ▮ Rust Stained Area
 - (W/L) Moisture Stained or Leached Area
 - HL Hairline Crack - Not to be Sealed
 - c-6" Crack (> 1/16" Width) — EPOXY CRACK SEALING
 - L.c-6" Leached Crack (> 1/16" Width) — EPOXY CRACK SEALING
 - s.f. Delaminated Area — FORMED CONG. REPAIR
 - s.f. Spalled Area (Depth ≤ 5") — FORMED CONG. REPAIR

WEST ABUTMENT
US 136 OVER BRANCH OF SALT CREEK
FAP ROUTE 315 - SECTION 102X-BR-2
McLEAN COUNTY
STATION 616+99.00
STRUCTURE NO. 057-0185

ESCA
CONSULTANTS, INC.

DESIGNED BY:	ELH	6/05
DRAWN BY:	DWH	6/05
CHECKED BY:	ELH	10/05
APPROVED BY:	RDP	10/05