

FAP RTE	SECTION	COUNTY	TOTAL SHEETS	SHEET NO.
697	17BR	FORD	40	10
STA.		TO STA.		
FED. ROAD DIST. NO.		ILLINOIS FED. AID PROJECT		

LEGEND

- TYPE III BARRICADE WITH 2 FLASHING LIGHTS PER BARRICADE
- SIGNS ON PERMANENT SUPPORTS
- FLASHING LIGHT ABOVE SIGN
- 18"X18" ORANGE FLAG
- STANDARD 702001 "ROAD CLOSED TO ALL TRAFFIC" APPLICATION
- STANDARD 702001 "ROAD CLOSED TO THRU TRAFFIC" APPLICATION

SIGN MOUNTING LOCATIONS

- ⓐ 500' IN ADVANCE OF ⓐ OR ⓑ
- ⓑ 500' IN ADVANCE OF ⓐ AND AS SHOWN
- ⓒ 1000' IN ADVANCE OF ⓑ
- ⓓ 500' IN ADVANCE OF "ROAD CLOSED TO THRU TRAFFIC"

GENERAL NOTES

1. ALL TRAFFIC CONTROL DEVICES SHALL BE FURNISHED, ERECTED AND MAINTAINED BY THE CONTRACTOR, UNLESS NOTED OTHERWISE.
2. ALL SIGNS NOT ATTACHED TO BARRICADES SHALL BE POST MOUNTED.
3. LOCATIONS OF TRAFFIC CONTROL DEVICES MAY BE ADJUSTED BY THE ENGINEER.
4. ALL TRAFFIC CONTROL SHOWN ON THIS SHEET SHALL BE PAID FOR PER LUMP SUM FOR TRAFFIC CONTROL AND PROTECTION FOR TEMPORARY DETOUR. OTHER ITEMS REQUIRED BY THE ENGINEER AND NOT SHOWN ON THIS DRAWING SHALL BE INCLUDED IN THE PAY ITEM AND NO ADDITIONAL COMPENSATION WILL BE ALLOWED.
5. THE ILLINOIS DEPARTMENT OF TRANSPORTATION WILL FURNISH ALL IL 9 ROUTE SIGNS FOR THIS DETOUR. THE CONTRACTOR SHALL NOTIFY DISTRICT 3 BUREAU OF OPERATIONS 14 CALENDAR DAYS PRIOR TO PLACING THE DETOUR.

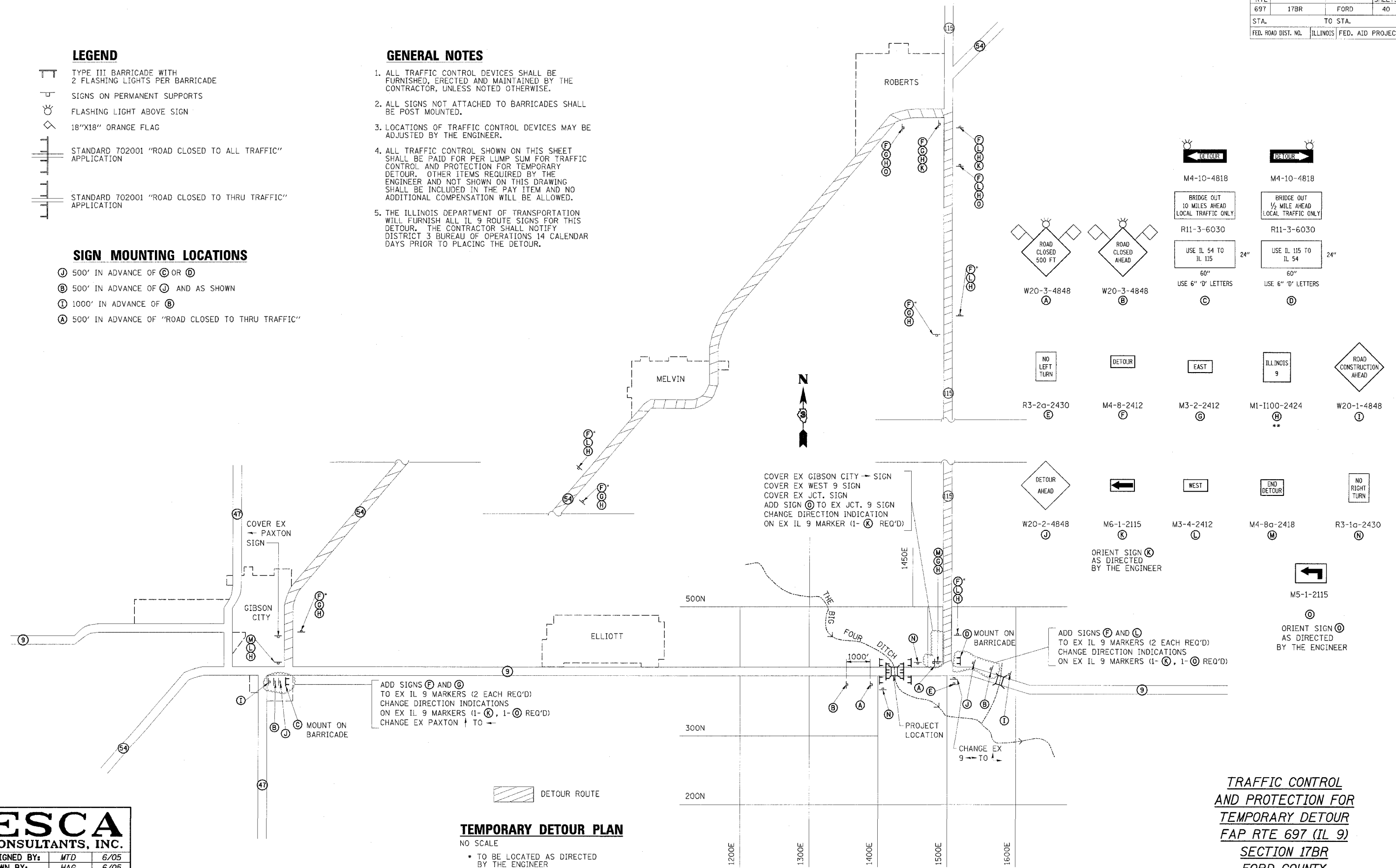

M4-10-4818	M4-10-4818
R11-3-6030	R11-3-6030
W20-3-4848	W20-3-4848
R3-2a-2430	M4-8-2412
M3-2-2412	M1-1100-2424
W20-2-4848	M6-1-2115
M3-4-2412	M4-8a-2418
R3-1a-2430	M5-1-2115

TEMPORARY DETOUR PLAN

- NO SCALE
- TO BE LOCATED AS DIRECTED BY THE ENGINEER
 - FURNISHED BY IDOT

ESCA
CONSULTANTS, INC.

DESIGNED BY:	MTD	6/05
DRAWN BY:	HAG	6/05
CHECKED BY:	MTD	6/05
APPROVED BY:	RDP	8/05

TRAFFIC CONTROL AND PROTECTION FOR TEMPORARY DETOUR
FAP RTE 697 (IL 9)
SECTION 17BR
FORD COUNTY