

ROUTE NO.	SECTION	COUNTY	TOTAL SHEETS	SHEET NO.
FAP 697	17BR	FORD	40	37
STA 923+00	TO STA 925+00			
FED. ROAD DIST. NO.	ILLINOIS	FED. AID PROJECT-		

DATE	BY

DATE	BY

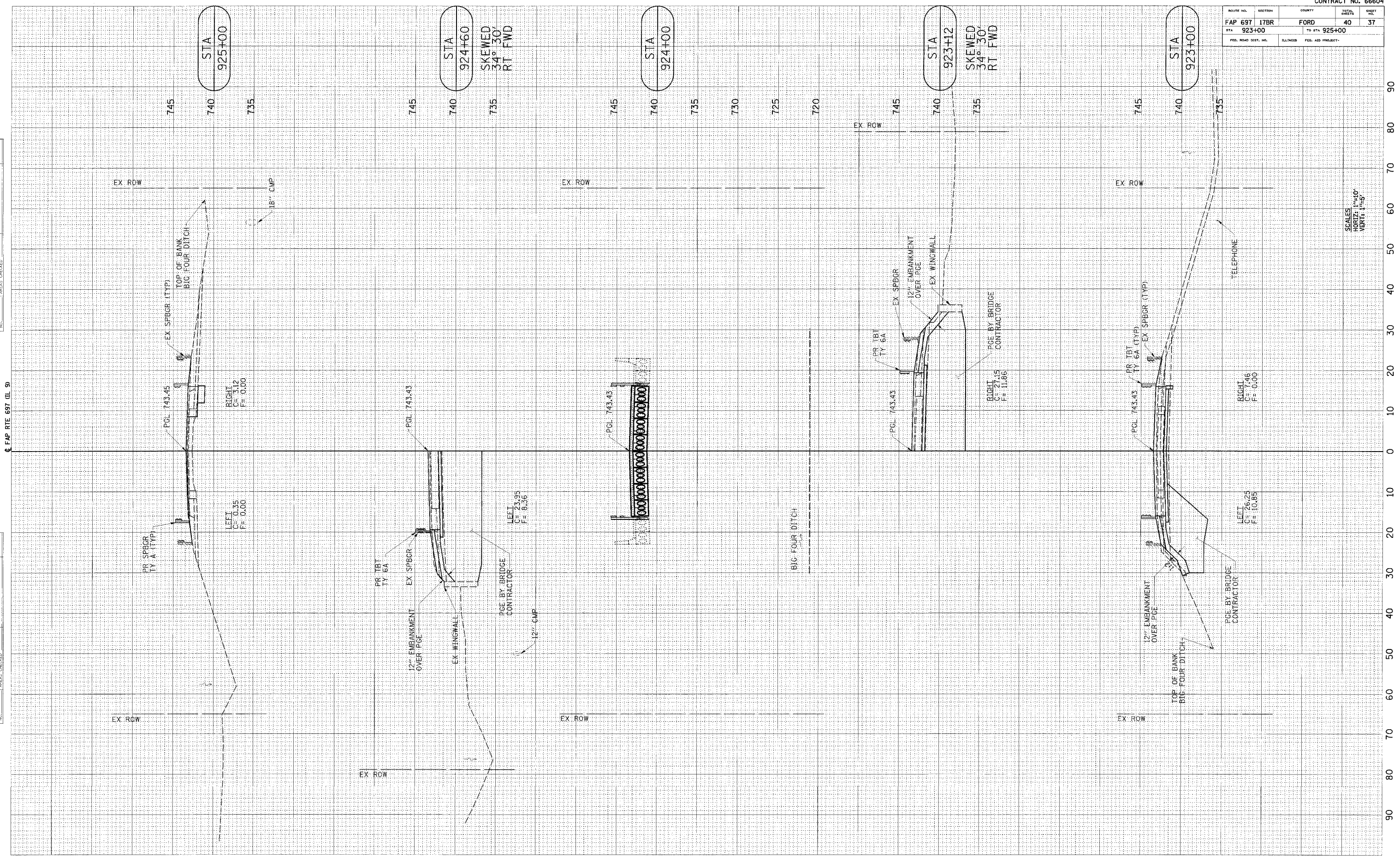

SCALES  
HORIZ. 1"=10'  
VERT. 1"=5'

FAP RTE 697 (IL 9) CROSS SECTIONS  
STA 923+00 TO STA 925+00