

FAP RTE.	SECTION	COUNTY	TOTAL SHEETS	SHEET NO.
68	(99, 100, 371)	LASALLE	9	1

**INDEX OF SHEETS**

1. COVER SHEET
2. GENERAL NOTES
3. SUMMARY OF QUANTITIES
4. GENERAL ROADWAY PLAN
5. TEMPORARY SHEET PILE DETAILS
6. SOIL BORING LOG
7. WINGWALL REMOVAL DETAILS
8. WINGWALL RECONSTRUCTION DETAILS
9. SIGHT SCREEN CHAIN LINK FENCE DETAILS

**STANDARDS**

- 606001-02 CONCRETE CURB TYPE B AND COMBINATION CONCRETE CURB AND GUTTER
- 701001-01 OFF-ROAD OPERATIONS 2L, 2W, MORE THAN 4.5 m (15') AWAY
- 701006-02 OFF-ROAD OPERATIONS 2L, 2W, 4.5 m (15') TO 600 mm (24") FROM PAVEMENT EDGE
- 701601-04 URBAN LANE CLOSURE, MULTILANE, 1W OR 2W WITH NONTRAVERSABLE MEDIAN
- 701801-03 LANE CLOSURE, MULTILANE 1W OR 2W CROSSWALK OR SIDEWALK CLOSURE
- 702001-05 TRAFFIC CONTROL DEVICES

**STATE OF ILLINOIS  
DEPARTMENT OF TRANSPORTATION  
DIVISION OF HIGHWAYS**

**PROPOSED  
HIGHWAY PLANS**

**FAP ROUTE 68 (IL ROUTE 23 ALT.)  
SECTION (99,100,371)**

**PROJECT  
LASALLE COUNTY  
C-93-018-06  
BOX CULVERT REPAIR**

**D-93-002-06**

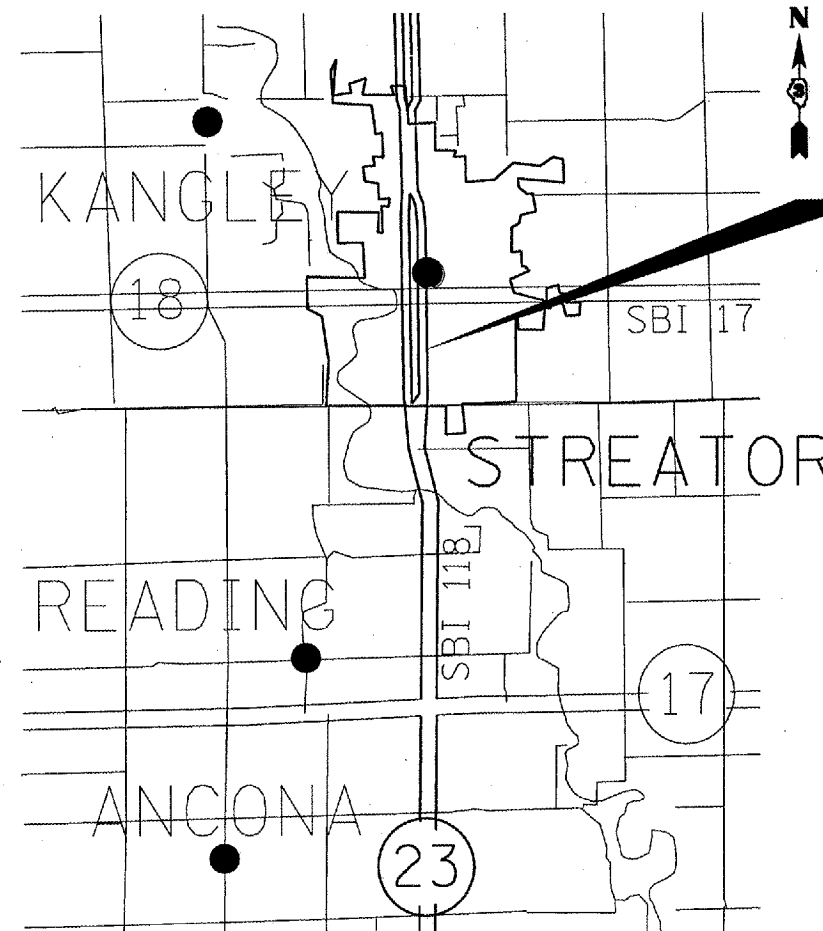

**PROJECT LOCATION**  
IL ROUTE 68  
(IL ROUTE 23 ALT.)  
SOUTH PARK STREET  
10' X 4' BOX CULVERT  
STA. 569 + 78.5  
APPROXIMATELY 0.58 MILES  
SOUTH OF BRIDGE STREET (IL ROUTE 18 EB)

J.U.L.I.E.  
JOINT UTILITY LOCATION INFORMATION FOR EXCAVATION  
1-800-892-0123

DISTRICT 3, BUREAU OF OPERATIONS  
PROJECT ENGINEER: TOM HUFFNAGEL (815) 434-8418  
UNIT CHIEF: RON WOODSHANK (815) 434-8419

STATE OF ILLINOIS  
DEPARTMENT OF TRANSPORTATION  
DIVISION OF HIGHWAYS

SUBMITTED 10/27/05  
*Gregory Mounts*  
DEPUTY DIRECTOR OF HIGHWAYS, REGION ENGINEER

December 9, 20 05  
*Mike Hens*  
ENGINEER OF DESIGN AND ENVIRONMENT

December 9, 20 05  
*Eric Harman*  
DEPUTY DIRECTOR, DIVISION OF HIGHWAYS

**PRINTED BY THE AUTHORITY  
OF THE STATE OF ILLINOIS**