

F.A.1 RTE.	SECTION	COUNTY	TOTAL SHEETS	SHEET NO.
74	*	CHAMPAIGN	115	98
STA. 247+50.00		TO STA. 248+50.00		
FED. ROAD DIST. NO. ILLINOIS FED. AID PROJECT				
*10:5-1-RS-1,14-1(R)RS&GRS-3)				

# LINCOLN AVE. EASTBOUND OFF-RAMP

## RAMP "C"

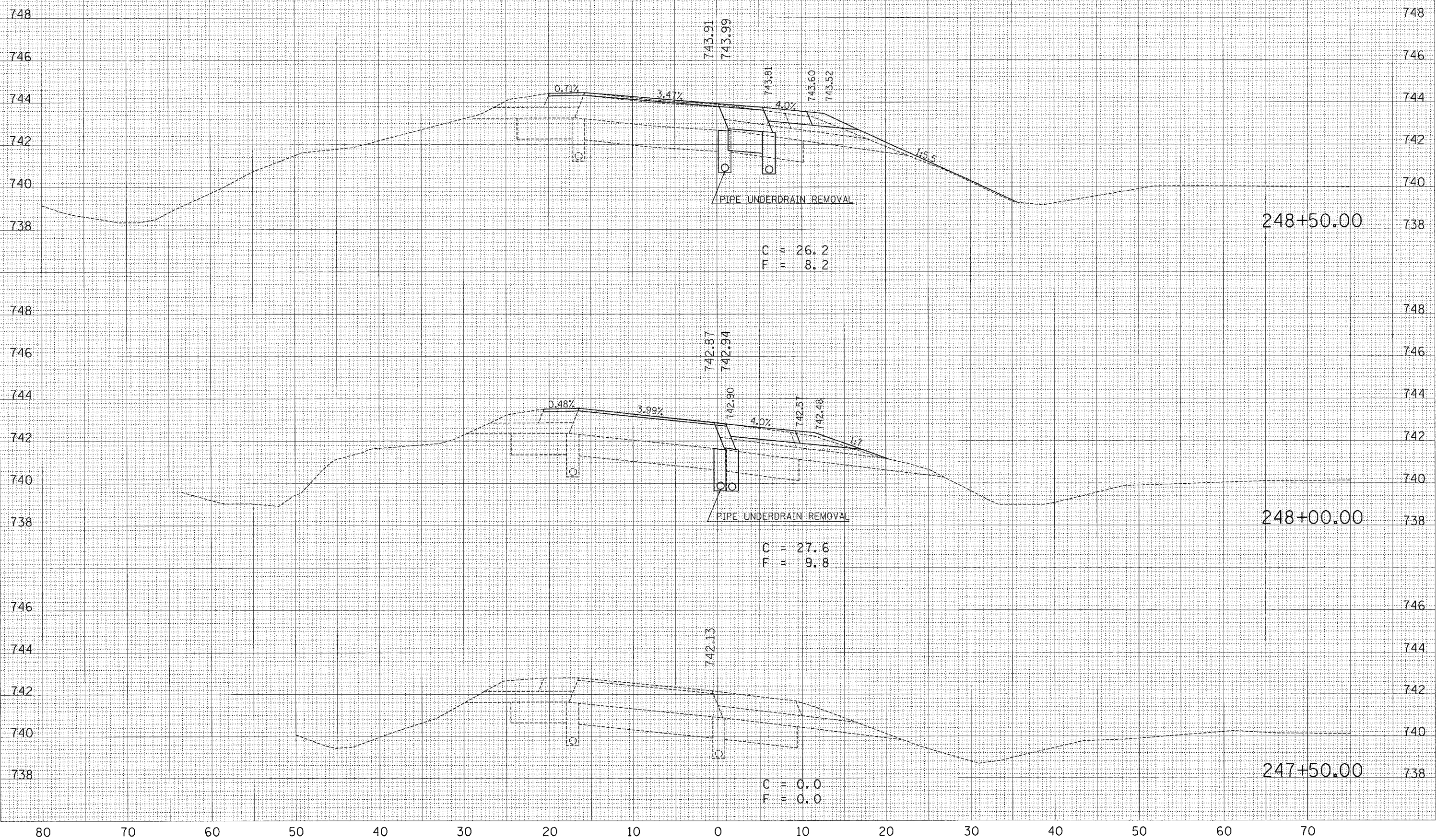

C = 26.2  
F = 8.2

C = 27.6  
F = 9.8

C = 0.0  
F = 0.0

DATE	
BY	
FINAL SURVEY	
NOTE BOOK	
AREAS CHECKED	
NO.	

DATE	
BY	
ORIGINAL SURVEY	
NOTE BOOK	
AREAS CHECKED	
NO.	

PLOT DATE = 10/29/2005  
FILE NAME = c:\p\projects\4507260 (v8)\Lincoln\app\app\1007260.dwg  
PLOT SCALE = 5/8" = 1' / IN.  
USER NAME = phillipj