

F.A.P. RTE.	SECTION	COUNTY	TOTAL SHEETS	SHEET NO.
836	118BR	CHAMPAIGN	29	18
FED. ROAD DIST. NO.		ILLINOIS	FED. AID PROJECT	

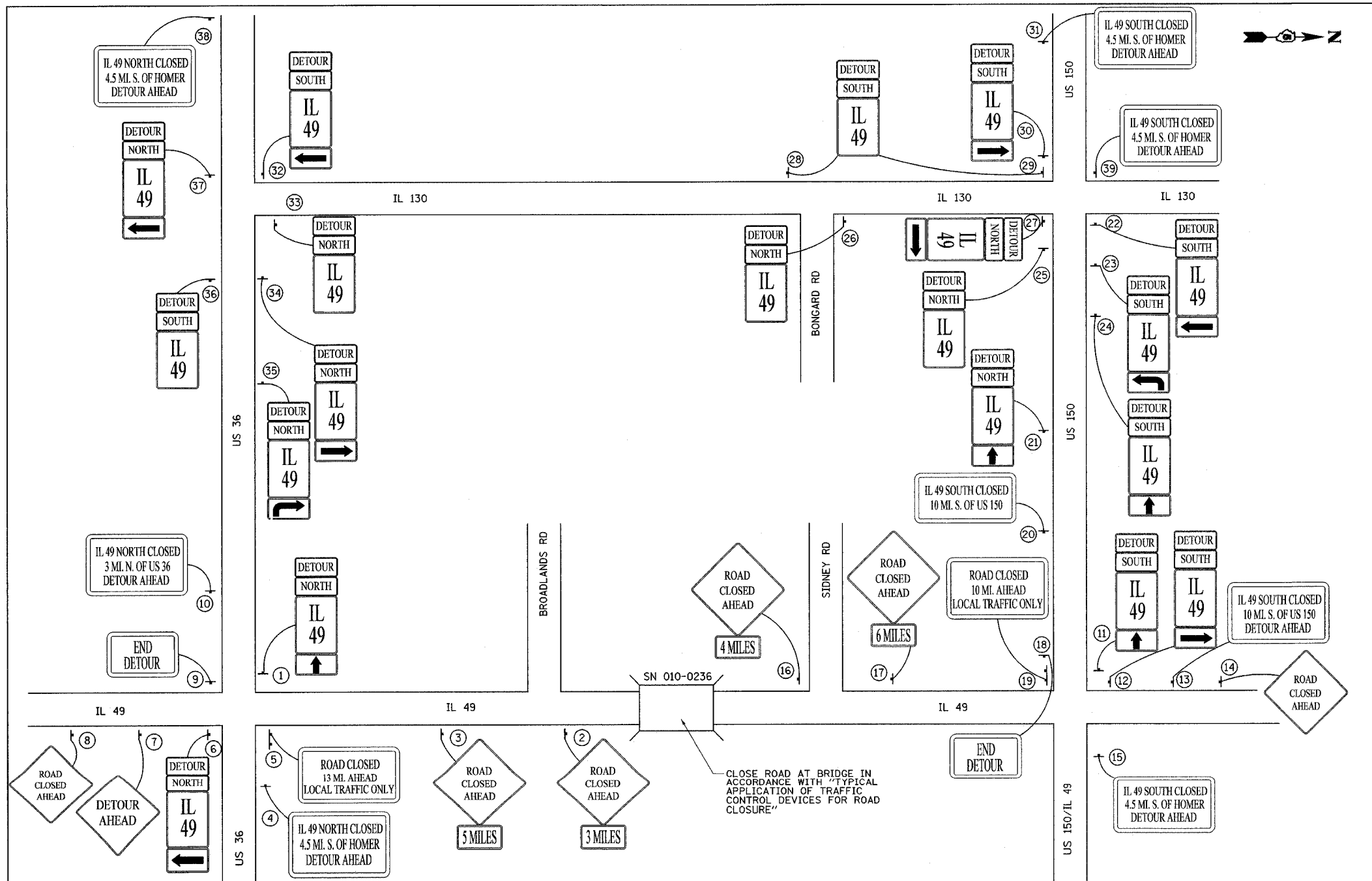

SIGN NO.	LOCATION
1	ERECT BESIDE "WEST US 36" SIGN
2	ERECT 50'± NORTH OF BROADLANDS ROAD
3	ERECT JUST WEST OF ALLERTON
4	ERECT 200'± EAST OF IL 49/US 36 INTERSECTION
5	ERECT JUST SOUTH OF "NORTH IL 49" SIGN
6	ERECT BESIDE "IL 49/US 36" SIGNS
7	ERECT BESIDE "DECATUR/INDIANAPOLIS" SIGN
8	ERECT 100'± NORTH OF "JCT 36" SIGN
9	ERECT UNDER "IL 49" SIGNS JUST WEST OF INTERSECTION
10	ERECT 300'± WEST OF IL 49/US 36 INTERSECTION
11	ERECT BESIDE "WEST US 150" SIGN
12	ERECT BESIDE "JCT IL 49/US 150" SIGNS
13	ERECT 300'± NORTH OF SIGN 12; JUST SOUTH OF RR TRACKS
14	ERECT 600'± NORTH OF SIGN 12; BETWEEN BROADWAY ST & RR TRACKS
15	ERECT 75'± EAST OF STOP SIGN
16	ERECT 50'± SOUTH OF SIDNEY ROAD
17	ERECT 2 MILES NORTH OF SIDNEY ROAD
18	ERECT UNDER IL 49, US 150 SIGNS JUST WEST OF INTERSECTION
19	ERECT ON TYPE III BARRICADES WITH LIGHTS 75'± SOUTH OF INTERSECTION
20	ERECT 300'± WEST OF US 150/IL 49 INTERSECTION
21	ERECT BESIDE EAST US 150 SIGN IN ST. JOSEPH
22	ERECT BESIDE IL 130/US 150 SIGNS, 50'± EAST OF INTERSECTION
23	ERECT 75'± WEST OF "JCT IL 130" SIGN
24	ERECT BESIDE "WEST US 150" SIGN IN ST. JOSEPH
25	ERECT 100'± EAST OF INTERSECTION
26	ERECT 100'± NORTH OF BONGARD STA. ROAD
27	ERECT BESIDE IL 130/US 150 SIGNS
28	ERECT 100'± SOUTH OF BONGARD STA. ROAD
29	ERECT BESIDE "SOUTH IL 130" SIGN
30	ERECT 50'± WEST OF US 150/IL 130 INTERSECTION
31	ERECT 300'± WEST OF US 150/IL 130 INTERSECTION
32	ERECT BESIDE US 36 ARROW SIGN
33	ERECT BESIDE "ADOPT A HIGHWAY, NORTH IL 130" SIGNS
34	ERECT BESIDE WEST US 36, IL 130 SIGNS
35	ERECT BESIDE "DECATUR/URBANA" SIGN
36	ERECT BESIDE EAST US 36 SIGN
37	ERECT 50'± WEST OF IL 130/US 36 INTERSECTION
38	ERECT 300'± WEST OF IL 130/US 36 INTERSECTION
39	ERECT 200'± NORTH OF IL 130/US 150 INTERSECTION
40	ERECT 500'± WEST OF IL 49 (EXIT #197)
41	ERECT 500'± EAST OF IL 49 (EXIT #197)

**NOTES**

- EXISTING SIGNS WHICH CONFLICT WITH THE MARKED DETOUR SHALL BE COVERED.
- SEE SPECIAL PROVISION "TRAFFIC CONTROL AND PROTECTION (SPECIAL)" FOR MORE DETAILS.

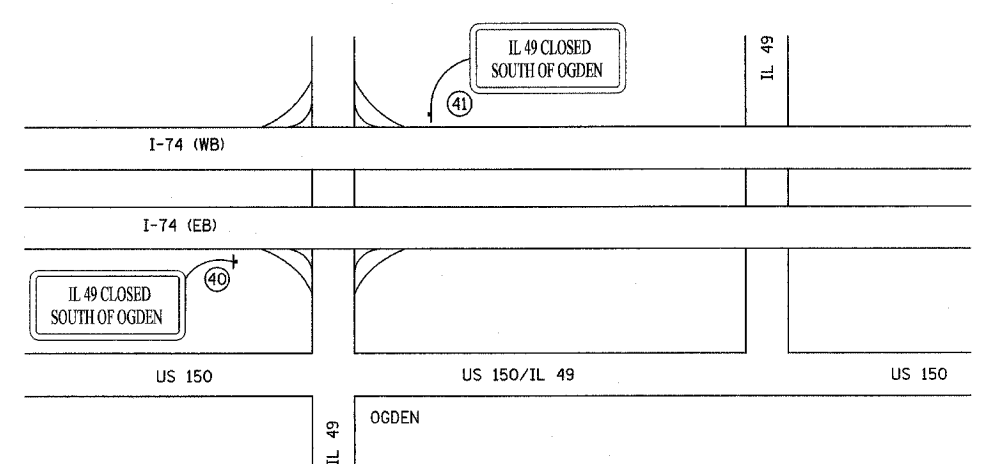

REVISIONS	
NAME	DATE

ILLINOIS DEPARTMENT OF TRANSPORTATION  
**DETOUR SIGNING DETAIL**  
 SCALE: NONE  
 DATE: 8/05  
 DRAWN BY: MLO  
 CHECKED BY: SJK

\*DGN-SPEC\*  
\*DATE\*