

F.A.P. RTE.	SECTION	COUNTY	TOTAL SHEETS	SHEET NO.
328	5R, Y, RS-1	CLAY	242	29
STA.		TO STA.		
FED. ROAD DIST. NO. 7		ILLINOIS	FED. AID PROJECT	
CONTRACT NO. 74078				

## STAGE 1-A (PHASE 1)

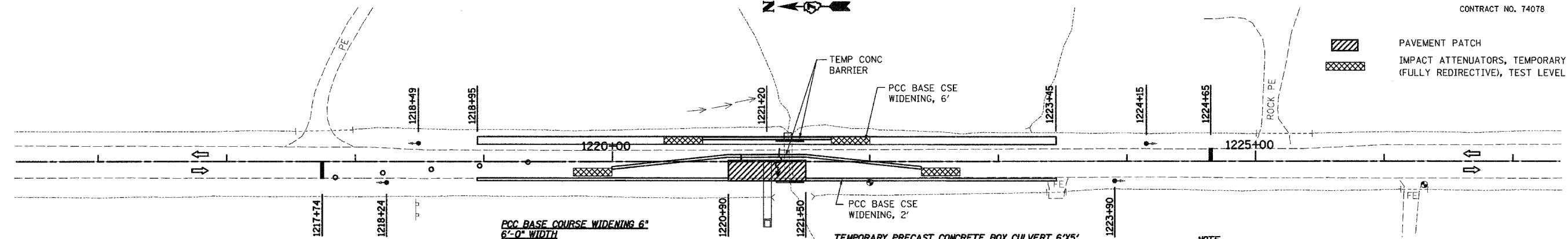

- PAVEMENT PATCH
- IMPACT ATTENUATORS, TEMPORARY (FULLY REDIRECTIVE), TEST LEVEL 3

**PCC BASE COURSE WIDENING 6" 6'-0" WIDTH**  
 LT 1218+95 TO LT 1223+45 300 SQ YD

**PCC BASE COURSE WIDENING 6" 2'-0" WIDTH**  
 RT 1218+95 TO RT 1220+90 43 SQ YD  
 RT 1221+50 TO RT 1223+45 43 SQ YD

**TEMPORARY PRECAST CONCRETE BOX CULVERT 6x5'**  
 LT 1221+37 6 FT

**PAVEMENT PATCHING, TYPE IV, 10 INCH**  
 RT 1220+90 TO RT 1221+50 93 SQ YD

**TEMPORARY CONCRETE BARRIER (STATE OWNED)**  
 CL 1220+00 TO 1222+40 240 FT  
 LT 1220+70 TO 1221+70 100 FT

**NOTE:**  
 ALL TRAFFIC CONTROL SHALL BE IN ACCORDANCE WITH STANDARD 701321.

**SUGGESTED SEQUENCE (MAJOR ITEMS NOTED)**  
 CONSTRUCT BOX CULVERT EXTENSION AND COLLATERAL EARTHWORK FOR SHOULDER WIDENING.  
 CONSTRUCT PCC BASE CSE WIDENING ALONG WEST EDGE OF SHOULDER AND REMOVE GUARDRAIL.  
 CONSTRUCT PCC BASE COURSE WIDENING ALONG EAST EDGE OF SHOULDER.  
 INSTALL TEMPORARY TRAFFIC SIGNALS.  
 SET TEMPORARY CONCRETE BARRIERS (STD 704001) FOR PHASE ONE.  
 CONSTRUCT NEW BOX CULVERT ON WEST SIDE TO 1'-0" WEST OF CENTERLINE.  
 CONSTRUCT GEOTEXTILE RETAINING WALL AND PAVEMENT ON WEST SIDE.  
 SWITCH TRAFFIC TO WEST SIDE.  
 REMOVE SHEET PILING IN PLACE FOR PHASE 1 (SEE PILING DETAIL SHEET).  
 CONSTRUCT REMAINDER OF NEW BOX CULVERT AND PAVEMENT ON EAST SIDE.  
 REMOVE REMAINING STAGING ITEMS.  
 ANY CHANGES TO STAGING SHALL BE APPROVED BY THE ENGINEER.

**TEMPORARY RUMBLE STRIPS**  
 RT 1200+74 1 EACH LT 1231+65 1 EACH  
 RT 1205+74 1 EACH LT 1236+65 1 EACH  
 RT 1210+74 1 EACH LT 1241+65 1 EACH

**WORK ZONE PAVEMENT MARKING REMOVAL**  
 CL 1220+23 TO 1222+18 65 SQ FT  
 LT 1218+95 TO 1223+45 150 SQ FT

**TEMPORARY PAVEMENT MARKING - LINE 4"**  
 CL 1220+23 TO 1222+18 195 FT  
 LT 1218+95 TO 1223+45 450 FT

**IMPACT ATTENUATORS, TEMPORARY (FULLY REDIRECTIVE), TEST LEVEL 3**  
 CL 1220+00 1 EACH  
 CL 1222+40 1 EACH  
 LT 1220+70 1 EACH  
 LT 1221+70 1 EACH

**TEMPORARY BRIDGE TRAFFIC SIGNAL**  
 1 EACH

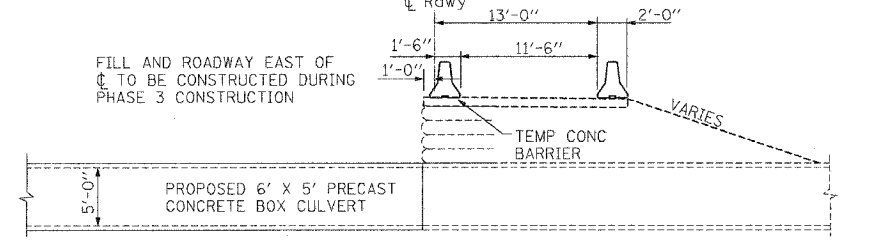
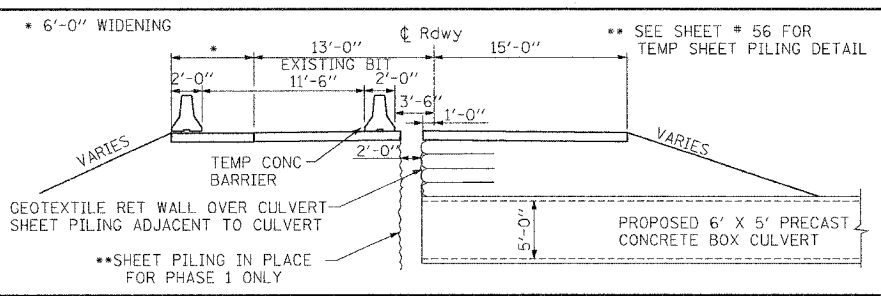

## STAGE 1-A (PHASE 2)

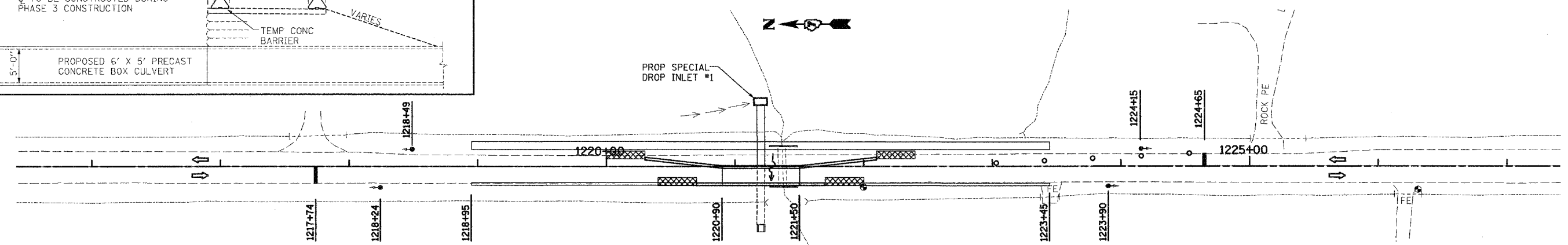

**IMPACT ATTENUATORS, RELOCATE (FULLY REDIRECTIVE), TEST LEVEL 3**  
 RT 1220+70 1 EACH  
 RT 1221+70 1 EACH  
 CL 1220+30 1 EACH  
 CL 1222+10 1 EACH

**RELOCATE TEMPORARY CONCRETE BARRIER (STATE OWNED)**  
 CL 1220+30 TO 1222+10 180 FT  
 RT 1220+70 TO 1221+70 100 FT

**TEMPORARY PAVEMENT MARKING - LINE 4"**  
 CL 1220+71 TO 1221+68 97 FT  
 RT 1218+95 TO 1223+45 450 FT

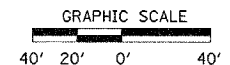
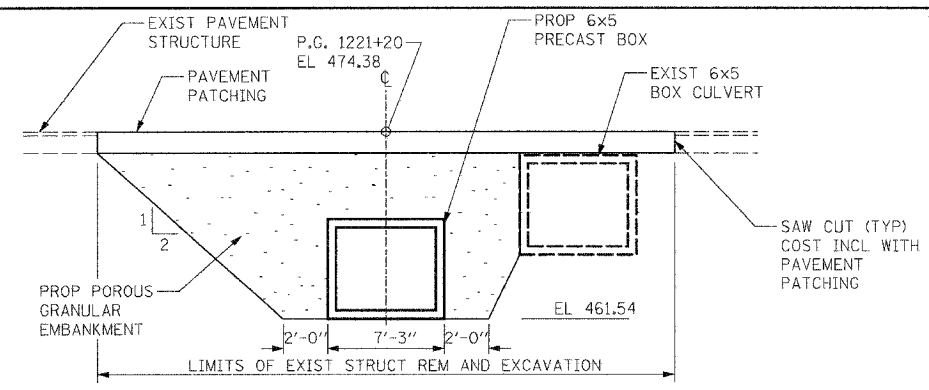

REVISIONS	
NAME	DATE

ILLINOIS DEPARTMENT OF TRANSPORTATION  
**STAGE 1 CONSTRUCTION BOX CULVERT STA 1221+20**

SCALE: VERT. HORIZ. DATE: 10-21-05 DRAWN BY: UJ CHECKED BY: MAR

Rev.