

F.A.P. RTE.	SECTION	COUNTY	TOTAL SHEETS	SHEET NO.
328	5R, Y, RS-1	CLAY	242	38
STA. 1215+00		TO STA. 1230+00		
FED. ROAD DIST. NO. 7 ILLINOIS FED. AID PROJECT				
CONTRACT NO. 74078				

DATE	BY
06/09	SLJ
SURVEYED	
ALIGNED	
CHECKED	
DRAWN	
FILE NAME	
NO.	
PLAN	
NOTE BOOK	
NO.	

DATE	BY
SURVEYED	
GRADES CHECKED	
NOTED	
NO.	
PROFILE	
NOTE BOOK	
NO.	

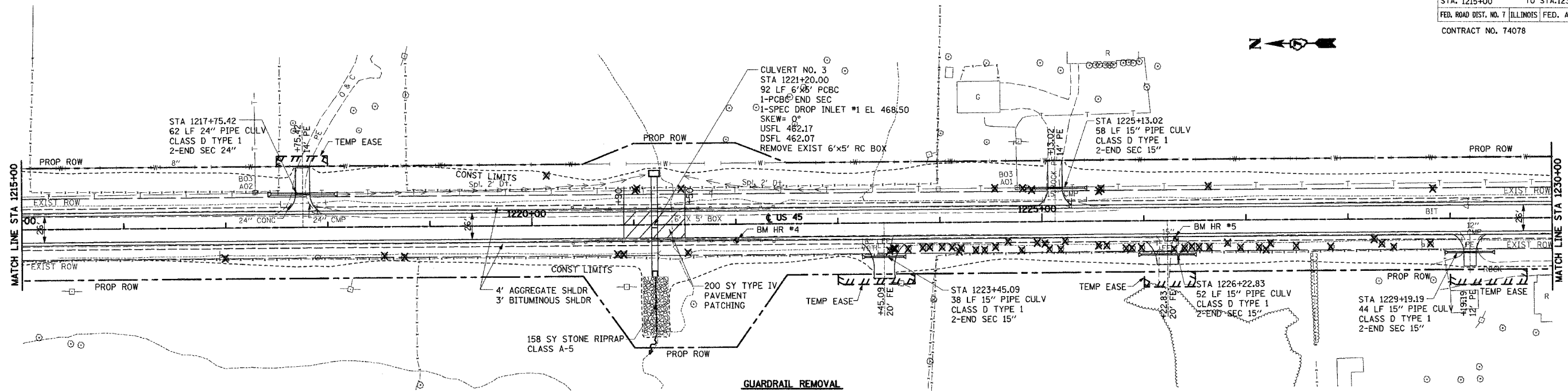

CULVERT No. 3 STA 1221+20 DR AREA = 68 AC
 LOW GRADE ELEV = 474.40 @ STA 1220+50

FLOOD	FREQ	Q	OPENING (SF)	HEADWATER EL		
YR	(CFS)	EXIST	PROP	EXIST	PROP	
DESIGN	50	179	30	30	472.46	470.90
BASE	100	208	30	30	473.08	471.16
OVERTOPPING	---	---	---	---	---	---
MAX CALC	500	279	30	30	474.47	471.73

LEGEND:
 - PAVEMENT REMOVAL

GUARDRAIL REMOVAL
 LT. STA. 1220+38.60 TO LT. 1222+38.40
 RT. STA. 1220+38.60 TO RT. 1222+38.40

BM HR #4 STA 1222+00.00, 16.00' RT.
 TOP OF GUARDRAIL POST
 EL 476.55

BM HR #5 STA 1226+31.00, 18.00' RT.
 S.E. CORNER, SOUTH HEADWALL
 PASTURE ENTRANCE EL 482.67

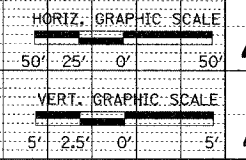
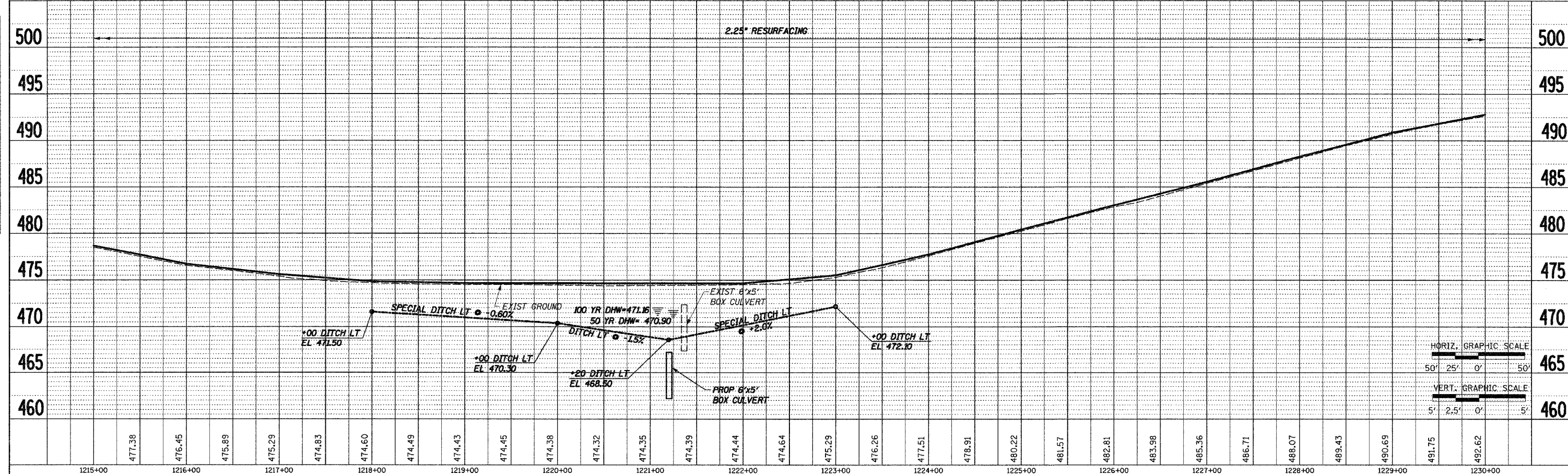
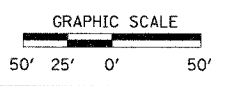

STA 1215+00 TO STA 1230+00