

F.A.P. RTE.	SECTION	COUNTY	TOTAL SHEETS	SHEET NO.
328	5R, Y, RS-1	CLAY	242	39

STA.	TO STA.
1230+00	1245+00

FED. ROAD DIST. NO.	ILLINOIS FED. AID PROJECT	CONTRACT NO.
7		74078

DETOUR 1
 PI STA. = 0+85.83
 $\Delta = 12^\circ 24' 02''$ (LT)
 $D = 7^\circ 15' 09''$
 $R = 790.00'$
 $T = 85.83'$
 $E = 170.98'$
 $P.C. STA. = 0+00.00$
 $P.T. STA. = 1+70.98$
 $SE RATE = N/A$

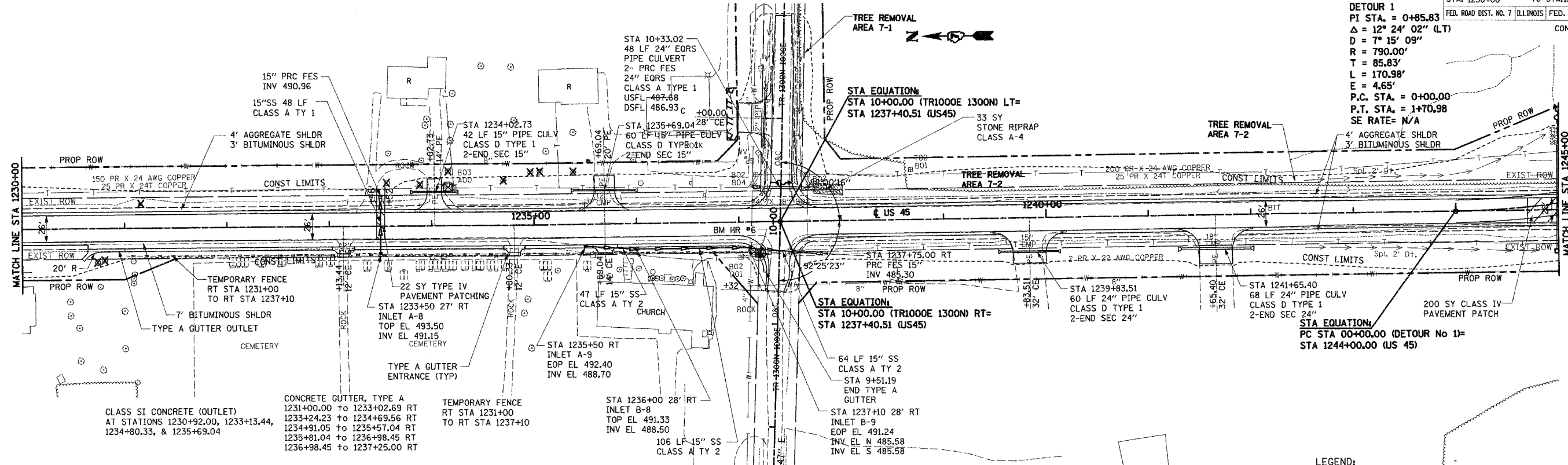

DATE: _____
 BY: _____
 SURVEYED: _____
 PLOTTED: _____
 CHECKED: _____
 NOTE BOOK NO.: _____
 ROAD FILE NAME: _____

DATE: _____
 BY: _____
 PROFILE: _____
 PLOTTED: _____
 CHECKED: _____
 NOTE BOOK NO.: _____
 STRUCTURE NOTATION: _____

BM HR #6 STA 1237+20.00, 32.00' RT.
 RR SPIKE IN POWER POLE N.W. QUAD.
 TWP RD 1000E/1300N EL 489.70

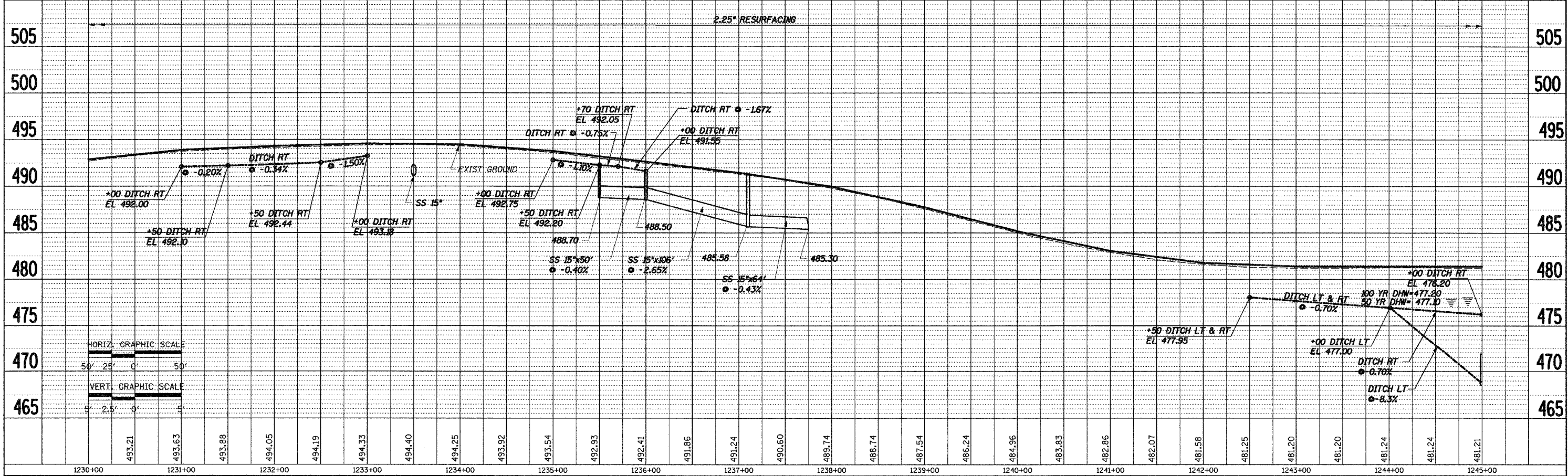
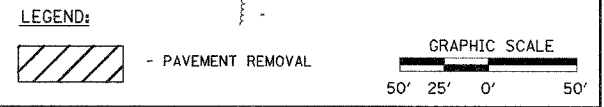

STA 1230+00 TO STA 1245+00