

F.A.P. RTE.	SECTION	COUNTY	TOTAL SHEETS	SHEET NO.
328	5R, Y, RS-1	CLAY	242	42
STA. 1275+00 TO STA. 1290+00				
FED. ROAD DIST. NO. 7 ILLINOIS		FED. AID PROJECT		
CONTRACT NO. 74078				

DATE	BY	DATE

DATE	BY	DATE

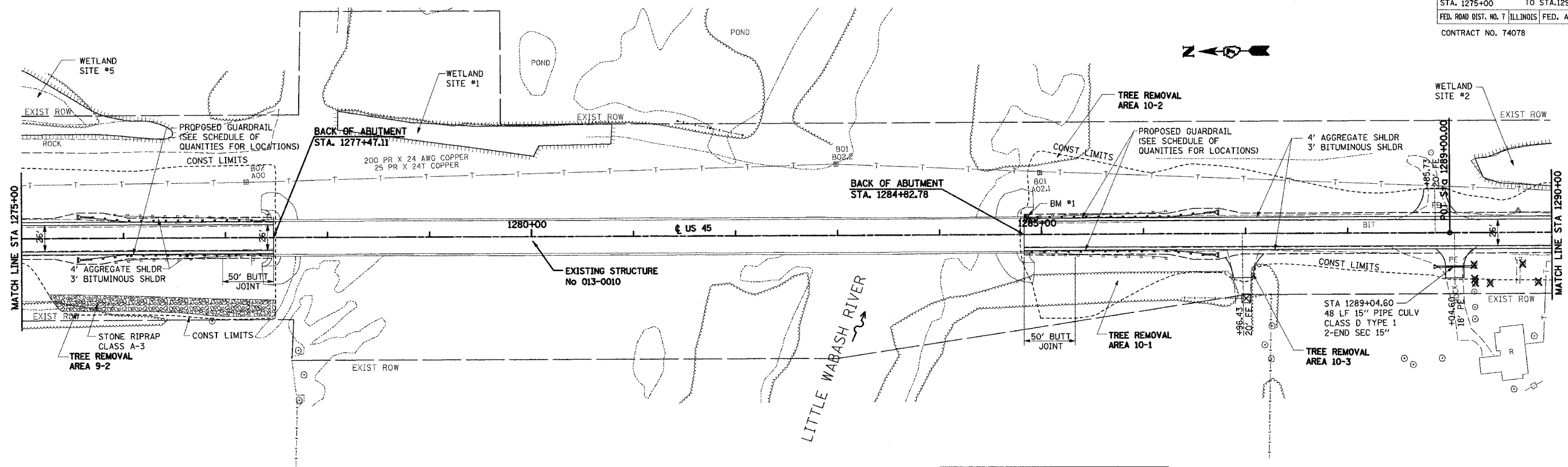

BM #1 STA 1284+85.00, 16.90' LT.
 CHISELED "SQ" S.E. WINGWALL
 LITTLE WABASH RIVER BRIDGE EL 464.50

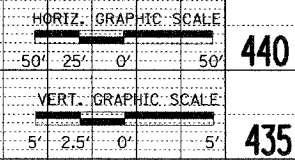
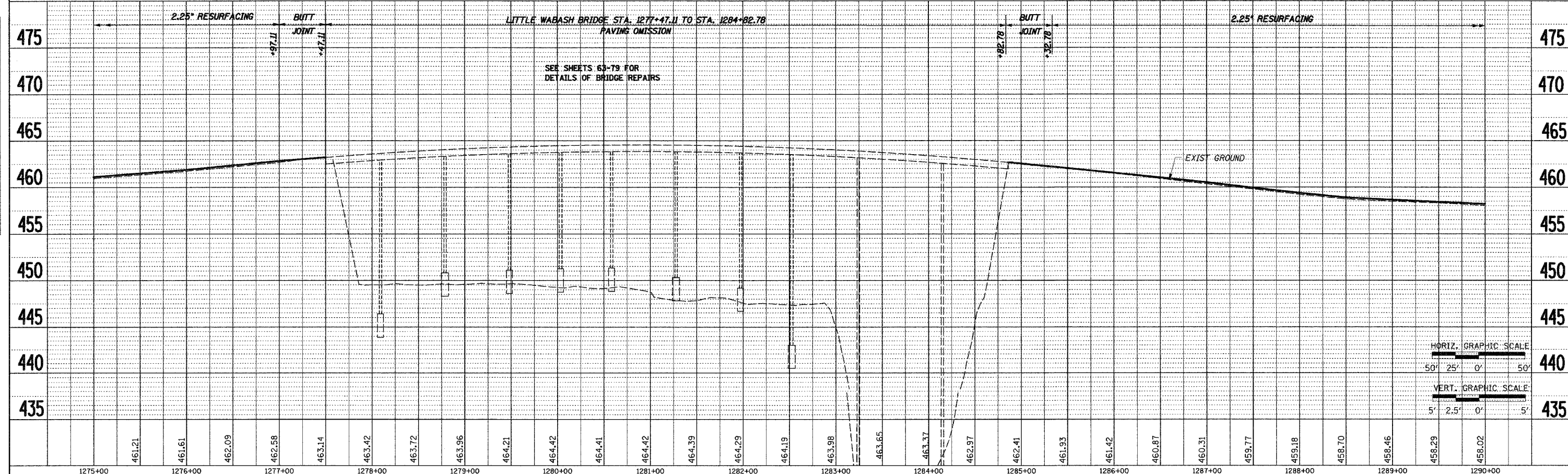
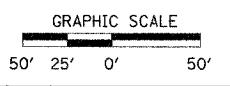

STA 1275+00 TO STA 1290+00