

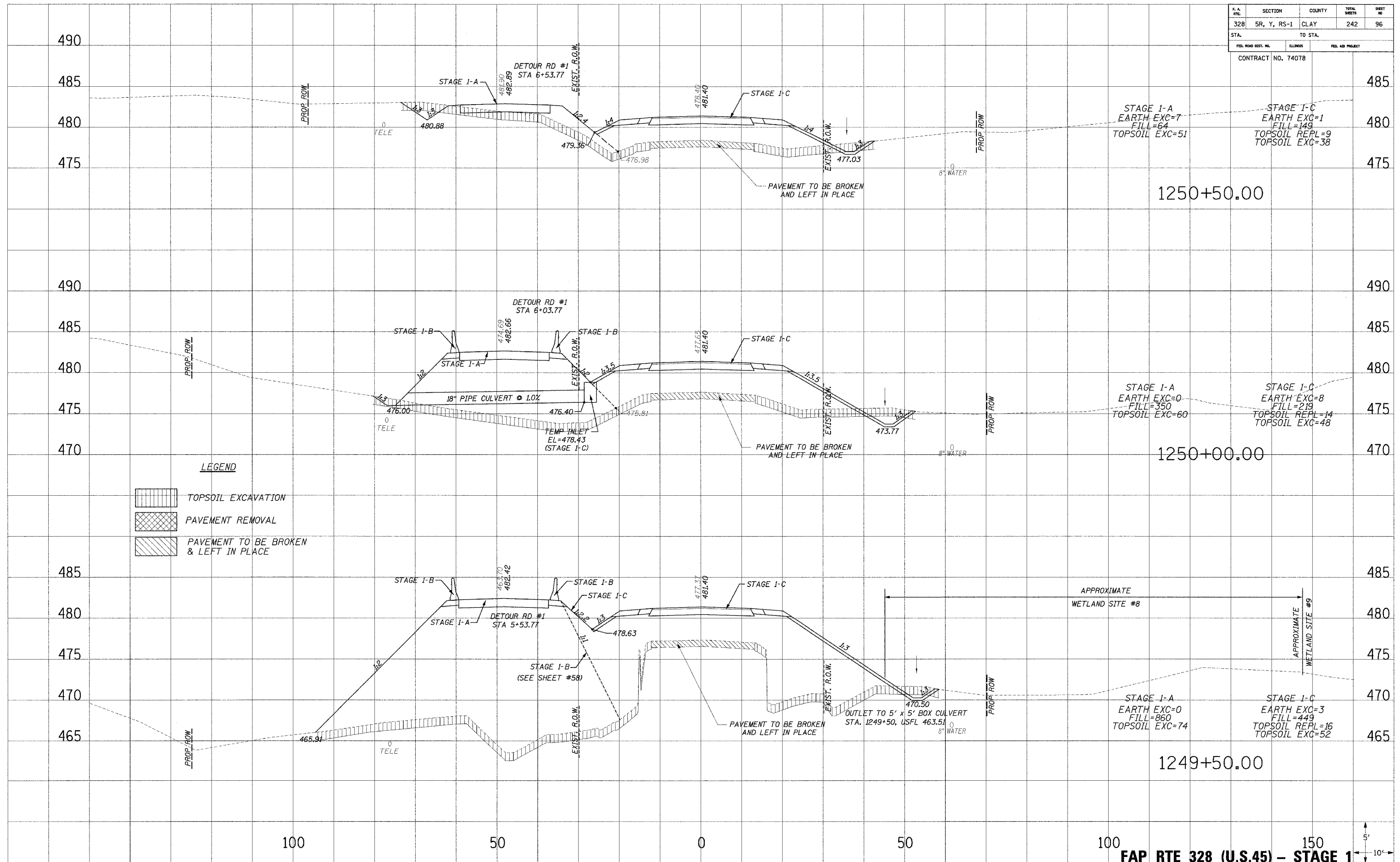



F.A. R/L	SECTION	COUNTY	TOTAL SHEETS	SHEET NO.
328	5R, Y, RS-1	CLAY	242	96
STA.		TO STA.		
FED. ROAD DIST. NO.	ILLINOIS	FED. AID PROJECT		
CONTRACT NO. 74078				



LEGEND

-  TOPSOIL EXCAVATION
-  PAVEMENT REMOVAL
-  PAVEMENT TO BE BROKEN & LEFT IN PLACE

PLATTED
 NOTE BOOK
 TEMPLATE
 AREAS
 CHECKED

PLATTED
 NOTE BOOK
 TEMPLATE
 AREAS
 CHECKED

FAP RTE 328 (U.S.45) - STAGE 1

