

F. A. SYL.	SECTION	COUNTY	TOTAL SHEETS	SHEET NO.
328	5R, Y, RS-1	CLAY	242	99
STA.		TO STA.		
FED. ROAD DIST. NO.	ILLINOIS	FED. AID PROJECT		
CONTRACT NO. 74078				

**LEGEND**

-  TOPSOIL EXCAVATION
-  PAVEMENT REMOVAL
-  PAVEMENT TO BE BROKEN & LEFT IN PLACE

REVISIONS  
 NO. DATE BY  
 1 10/24/00 POF B ES 00 AM

REVISIONS  
 NO. DATE BY  
 1 10/24/00 POF B ES 00 AM

REVISIONS  
 NO. DATE BY  
 1 10/24/00 POF B ES 00 AM

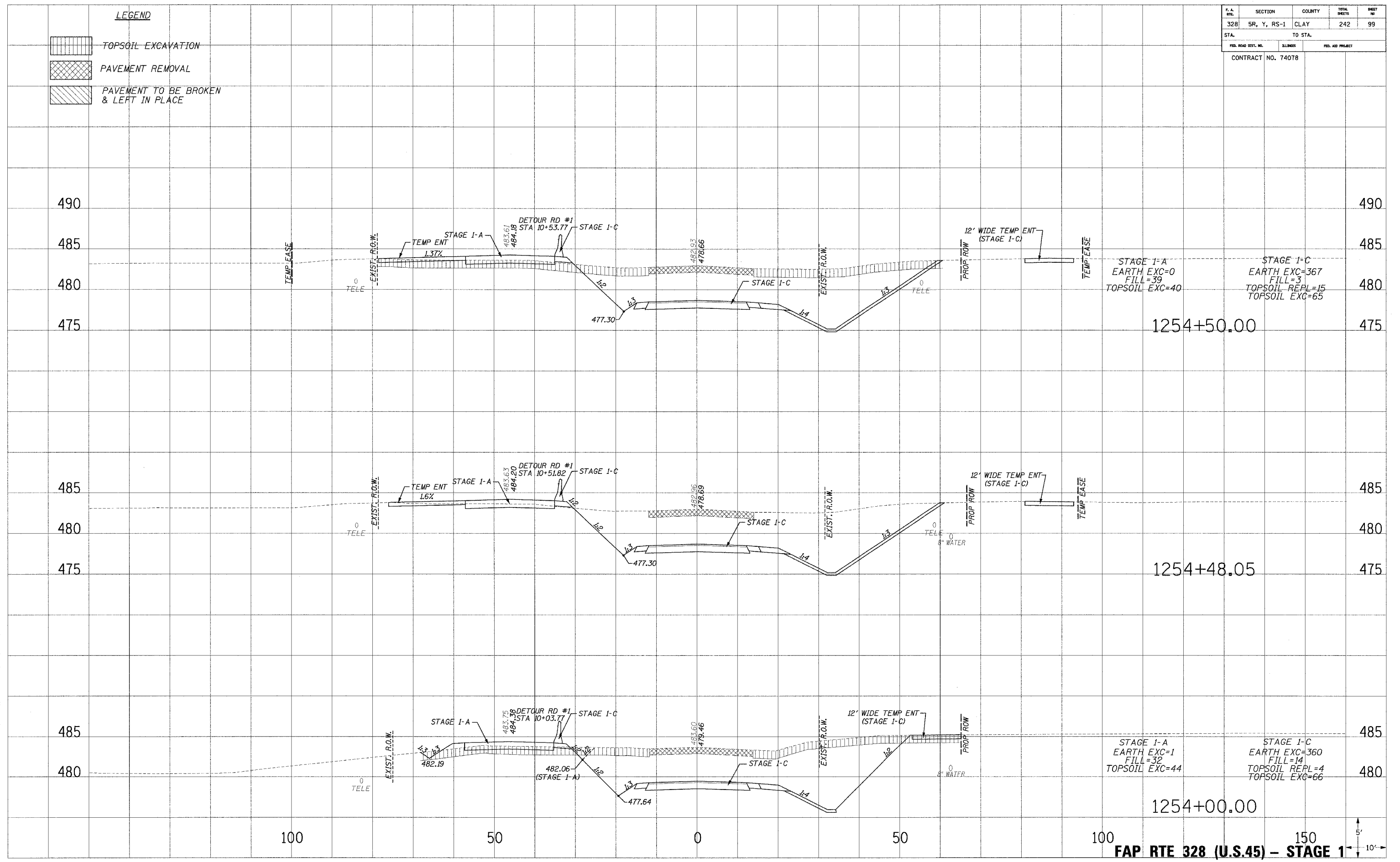

**FAP RTE 328 (U.S.45) - STAGE 1**

10/24/00 POF B ES 00 AM