



F. A. RTE.	SECTION	COUNTY	TOTAL SHEETS	SHEET NO.
328	5R, Y, RS-1	CLAY	242	105
STA. TO STA.				
FED. ROAD DIST. NO.		ILLINOIS	FED. AID PROJECT	
CONTRACT NO. 74078				

**LEGEND**

-  TOPSOIL EXCAVATION
-  PAVEMENT REMOVAL
-  PAVEMENT TO BE BROKEN & LEFT IN PLACE

PLOTTED FROM: PLATTER NOTE BOOK TEMPLATE AREAS CHECKED: NO.

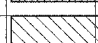
PLOTTED FROM: PLATTER NOTE BOOK TEMPLATE AREAS CHECKED: NO.

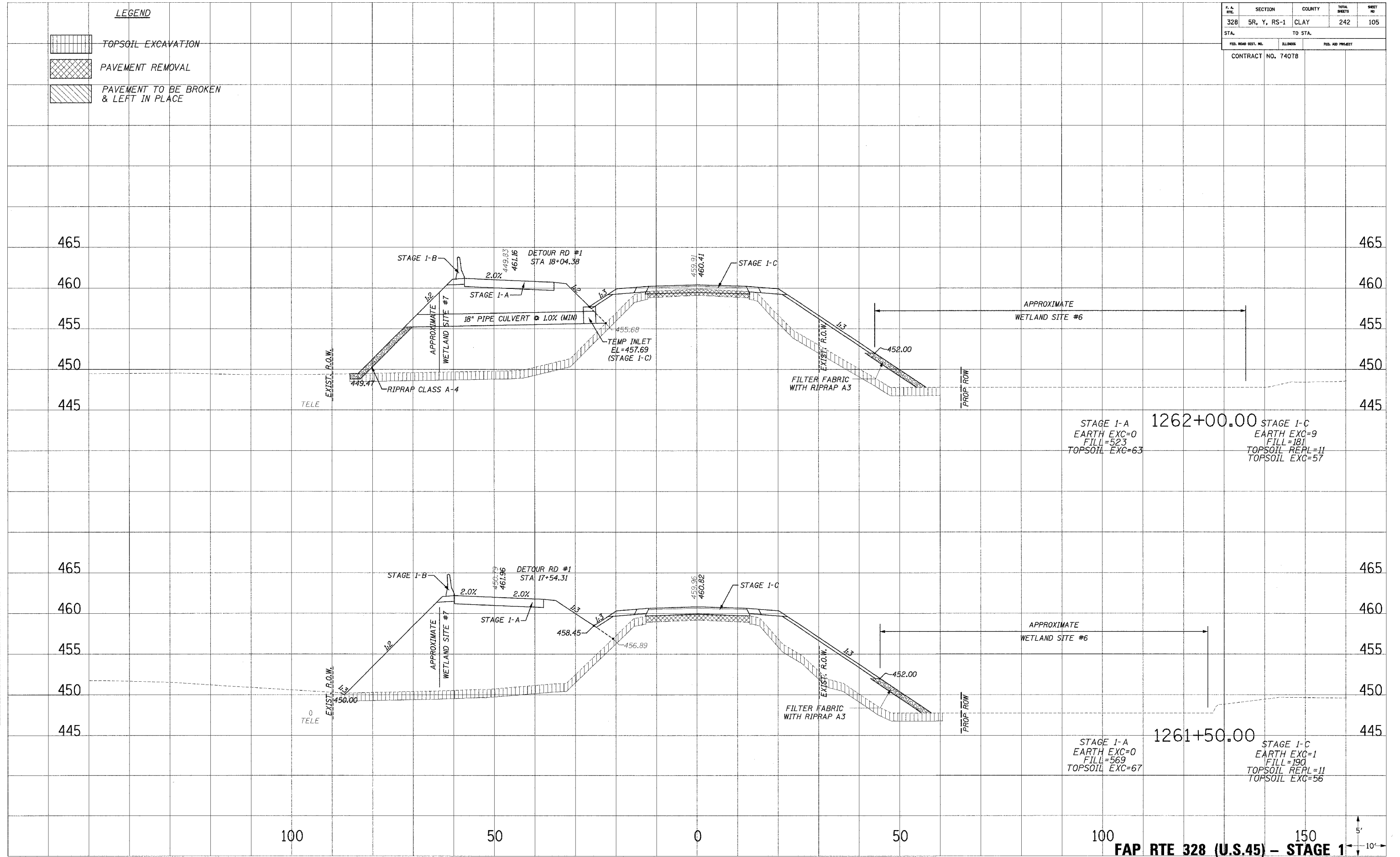

**FAP RTE 328 (U.S.45) - STAGE 1**



... 10/24/2008 8:53:01 AM