

F.A. RTE.	SECTION	COUNTY	TOTAL SHEETS	SHEET NO.
328	5R, Y, RS-1	CLAY	242	112
STA.		TO STA.		
FED. ROAD DIST. NO.		ILLINOIS	FED. AID PROJECT	
CONTRACT NO. 74078				

LEGEND

	TOPSOIL EXCAVATION
	PAVEMENT REMOVAL
	PAVEMENT TO BE BROKEN & LEFT IN PLACE

500
495

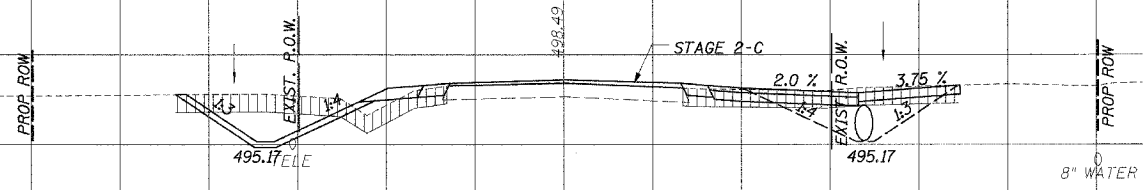

STAGE 2-C
EARTH EXC=18
FILL=22
TOPSOIL REPL=8
TOPSOIL EXC=61
1148+00.00

500
495

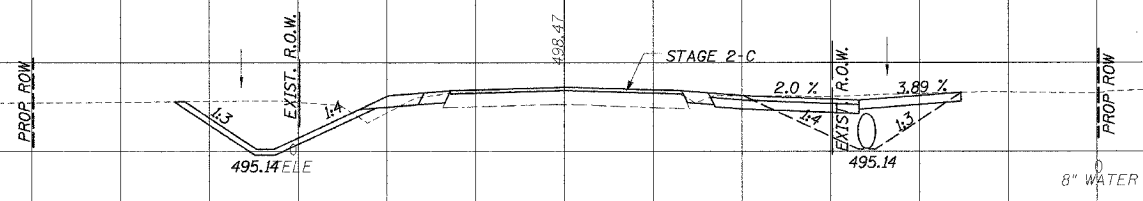

1147+95.84

500
495

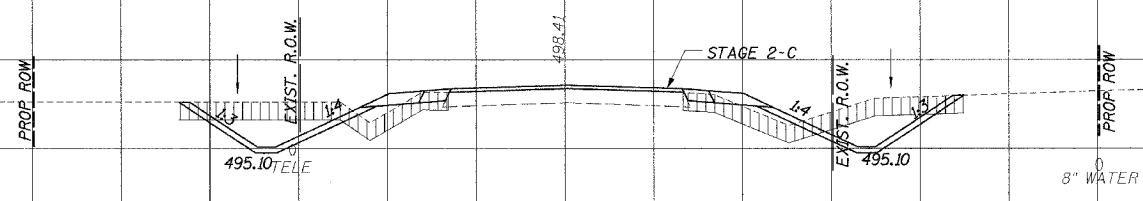

STAGE 2-C
EARTH EXC=33
FILL=27
TOPSOIL REPL=16
TOPSOIL EXC=62
1147+50.00

500
495

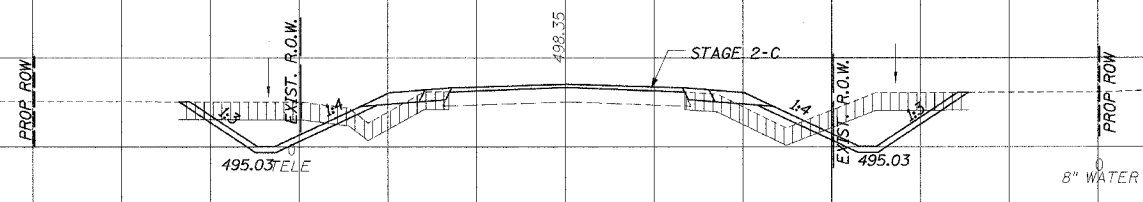

STAGE 2-C
EARTH EXC=34
FILL=29
TOPSOIL REPL=16
TOPSOIL EXC=62
1147+00.00

100

50

0

50

100

150

FAP RTE 328 (U.S.45) - STAGE 2

NOTED
TEMPLATE
AREAS CHECKED

NOTED
TEMPLATE
AREAS CHECKED