

| F.A.P. RTE. | SECTION | COUNTY | TOTAL SHEETS | SHEET NO. |
|---------------------|---------|---------------------------|--------------|-----------|
| 314 | 108BR-I | MADISON | 123 | 27 |
| STA. 260+50 | | TO STA. 266+50 | | |
| FED. ROAD DIST. NO. | | ILLINOIS FED. AID PROJECT | | |

STA 260+50 TO STA 261+57
STA 265+45 TO STA 266+50

STA 261+57 TO STA 265+45

THERMOPLASTIC PAVEMENT MARKING LINES
4" YELLOW 50 FT
4" WHITE 424 FT

POLYUREA PAVEMENT MARKING LINES
4" YELLOW 100 FT
4" WHITE 776 FT

RAISED REFLECTIVE PAVEMENT MARKERS
DOUBLE AMBER 3 EACH

RAISED REFLECTIVE PAVEMENT MARKERS (BRIDGE)
DOUBLE AMBER 5 EACH

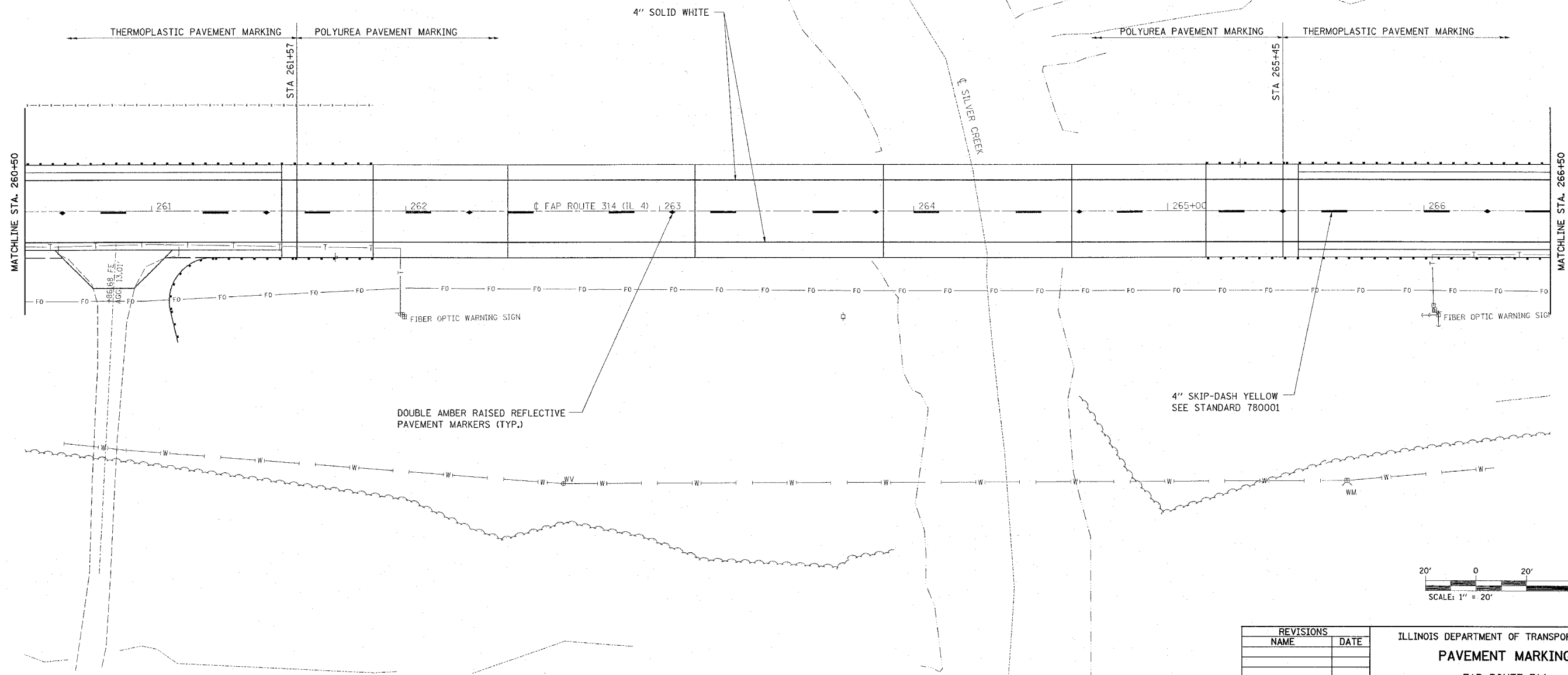

| REVISIONS | |
|-----------|------|
| NAME | DATE |
| | |
| | |
| | |
| | |
| | |
| | |
| | |
| | |
| | |
| | |

ILLINOIS DEPARTMENT OF TRANSPORTATION
PAVEMENT MARKING
FAP ROUTE 314
SECTION 108BR-I
MADISON COUNTY
SN 060-0106(E) 0334(P)

PLOT DATE = 10/25/2005
 FILE NAME = c:\projects\108br\plan\02701a65.dgn
 PLOT SCALE = 1" = 20'
 REFERENCE = #REF#