

F.A.P. RTE.	SECTION	COUNTY	TOTAL SHEETS	SHEET NO.
355	258-I	JERSEY	30	8
STA. 412+00		TO STA. 416+34		
FED. ROAD DIST. NO. ILLINOIS		FED. AID PROJECT		

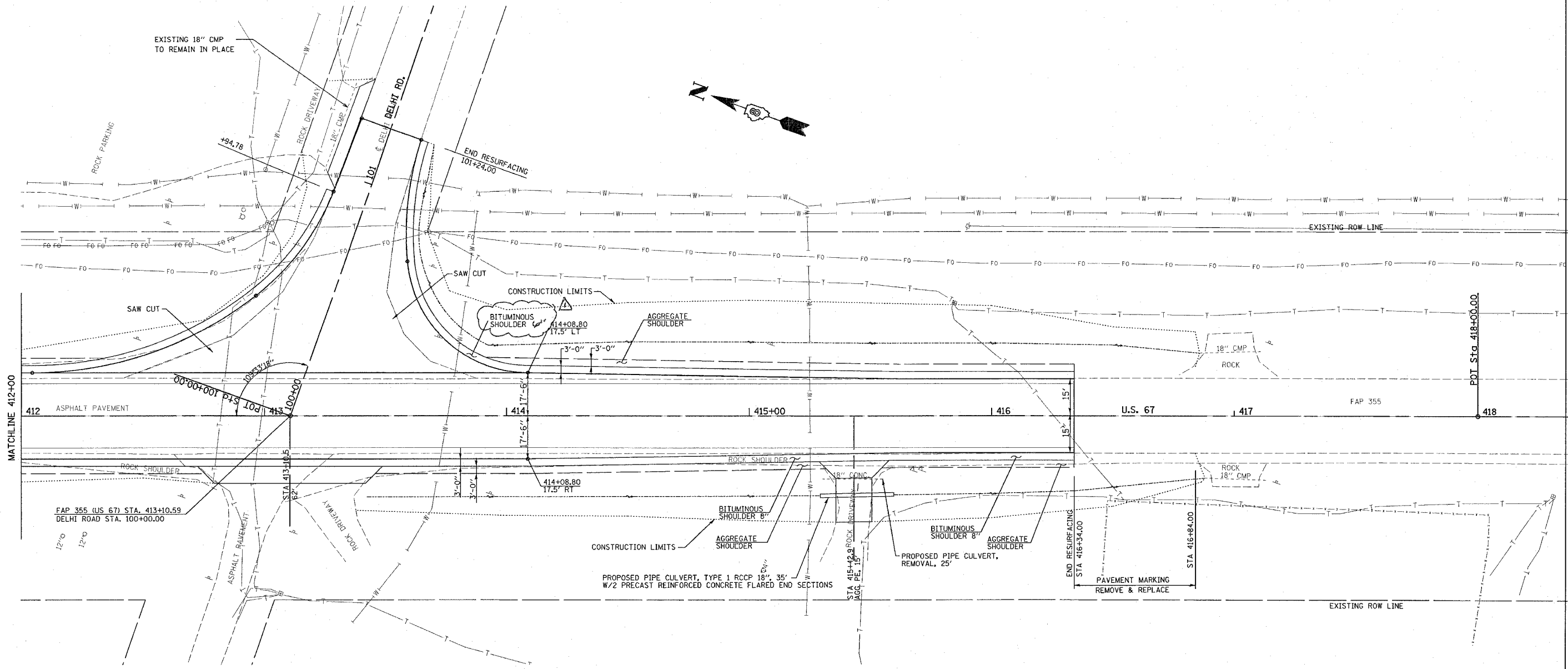

NOTE: SEE SHEET NO. xx FOR PROPOSED DITCH PROFILES

REVISIONS	
NAME	DATE

ILLINOIS DEPARTMENT OF TRANSPORTATION
PLAN SHEETS
 FAP ROUTE 355
 SECTION 258-I
 JERSEY COUNTY

SCALE: _____
 DATE _____

DRAWN BY _____
 CHECKED BY _____

PLOT DATE = 10/27/2005
 FILE NAME = c:\projects\258-I\view\ed01680\plan\p107605.dgn
 PLOT SCALE = 28.0000 / IN.
 REFERENCE = SHEET #

Rev. 1-10-06