

DATE	SECTION	COUNTY	TOTAL SHEETS	SHEET NO.
PARK ROADS	DIST. 8 WSC 2006-1	RANDOLPH	43	13
STA. 225+00		TO STA. 239+00		

CONTRACT NO. 76972

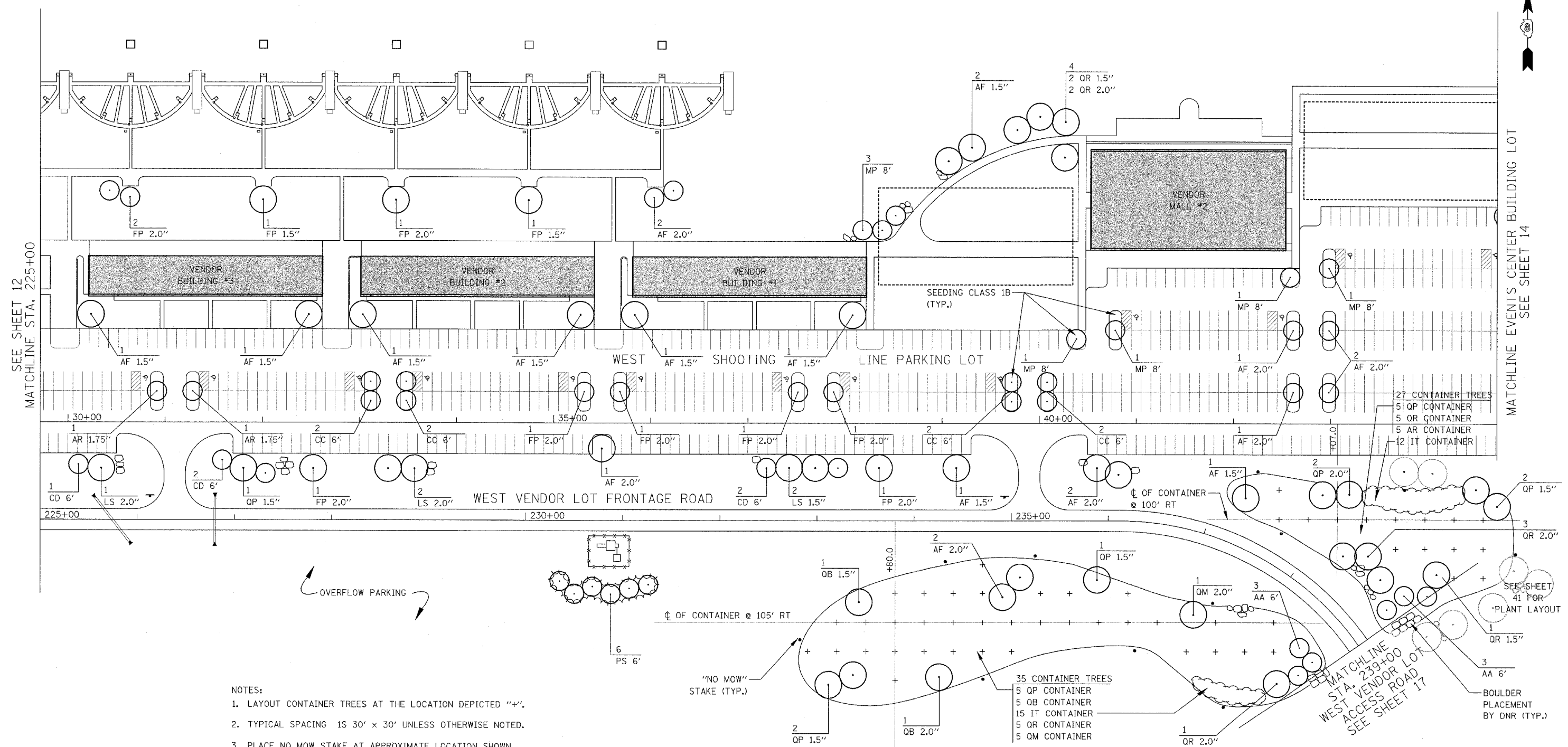

- NOTES:
- LAYOUT CONTAINER TREES AT THE LOCATION DEPICTED "+".
 - TYPICAL SPACING IS 30' x 30' UNLESS OTHERWISE NOTED.
 - PLACE NO MOW STAKE AT APPROXIMATE LOCATION SHOWN A MINIMUM OF 10' FROM ANY CONTAINER SHRUBS OR TREES

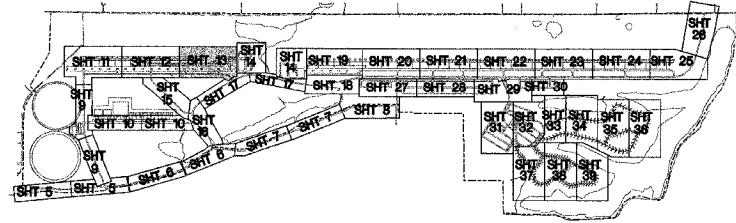

ILLINOIS DEPARTMENT OF TRANSPORTATION
PLAN VIEW
WEST VENDOR LOT FRONTAGE ROAD & WEST SHOOTING LINE PARKING LOT LANDSCAPING
 PARK ROADS
 SECTION DIST. 8 WSC 2006-1
 RANDOLPH COUNTY

DRAWN BY: