

CONTRACT NO. 83560

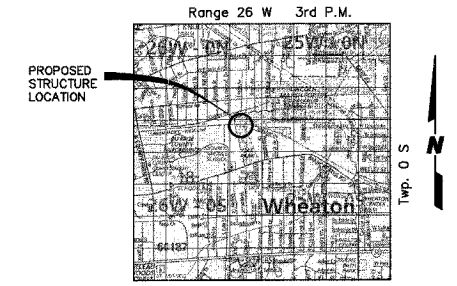

**LOCATION SKETCH**

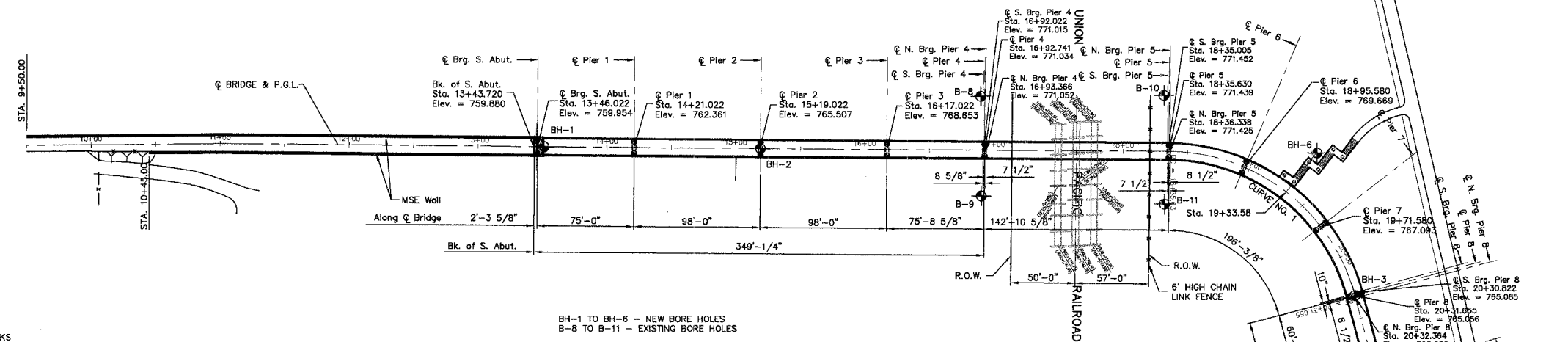

**PLAN**

**BENCHMARKS**

**ELEVATION REFERENCE MARKS**

DUPAGE COUNTY CONTROL, ALUMINUM DISC # 02943 0.3 MILES EAST OF THE INTERSECTION OF MANCHESTER ROAD AND COUNTY FARM ROAD, ±150' NORTH OF MANCHESTER ROAD.  
ELEVATION = 735.26

**PROJECT ELEVATION REFERENCE MARKS**

RM1-BOLT BETWEEN "MJE" & "LLER" ON THE FIRST FIRE HYDRANT EAST OF ERIE AVENUE ON THE SOUTH SIDE OF MANCHESTER ROAD.  
ELEVATION = 757.00

RM2-BOLT UNDER THE LAST "9" IN "1969" ON THE FIRE HYDRANT LOCATED AT THE NORTHWEST CORNER OF MONROE SCHOOL.  
ELEVATION = 755.82

BH-1 TO BH-6 - NEW BORE HOLES  
B-8 TO B-11 - EXISTING BORE HOLES

**DESIGN SPECIFICATIONS**

- AASHTO Standard Specifications for Highway Bridges - 2002
- AASHTO Guide Specifications for Design of Pedestrian Bridges - 1997
- AASHTO Guide Specifications for Horizontally Curved Steel Girder Highway Bridges - 2003

**CONSTRUCTION SPECIFICATIONS**

- IDOT - Standard Specifications for Road and Bridge Construction Adopted January 1, 2002
- IDOT - Supplemental Specifications and Recurring Special Provisions Adopted January 1, 2004
- IDOT - Guide Bridge Special Provision

**LOADING**

H10 Truck or Pedestrian Live Load of 85 psf.

**DESIGN STRESSES**

**(FIELD UNITS)**

- $f_c = 3,500$  psi
- $f_y = 60,000$  psi (Rein.)
- $f_y = 50,000$  psi (Structural Steel)
- M-270, Grade 50W

**SEISMIC DATA**

Seismic Performance Category (SPC) = A  
Bedrock Acceleration Coefficient (A) = 0.04g  
Site Coefficient(s) = 1.0

**NOTES:**

- THE ELEVATION OF THE EXISTING TOP-OF-RAIL PROFILE SHALL BE VERIFIED PRIOR TO BEGINNING CONSTRUCTION.
- SEE SHEET S3 OF S29 FOR UNION PACIFIC RR MILE POST LOCATION.
- FOR CENTER LINE ALIGNMENT SEE SHEET 10 OF 54.

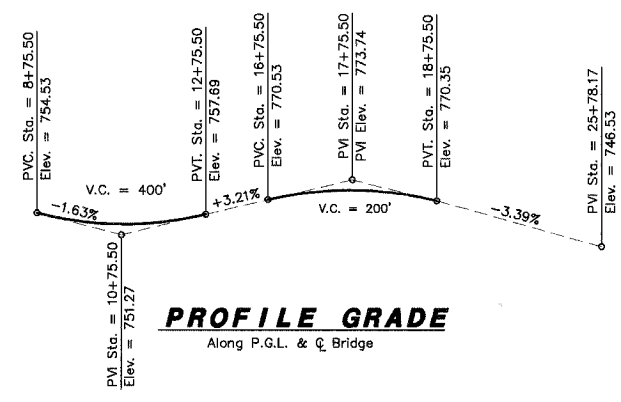

**PROFILE GRADE**  
Along P.G.L. &  $\phi$  Bridge

**CURVE 1 DATA**

$\Delta = 74' 52' 34"$   
 $D = 38' 11' 50"$   
 $T = 114.84'$   
 $L = 196.025'$   
 $E = 38.91'$   
 $R = 150.00'$   
P.C. = 18+35.63  
P.T. = 20+31.655  
P.L. = 19+50.47

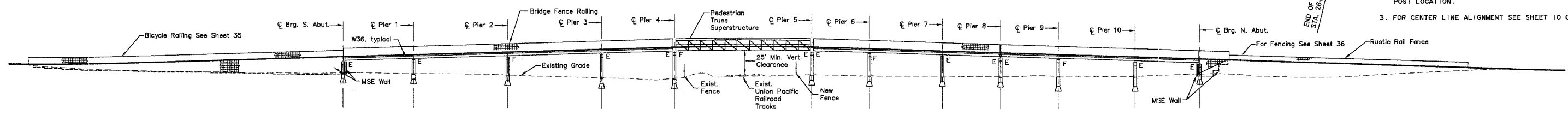

**ELEVATION**

PREPARED FOR:  
WHEATON PARK DISTRICT  
666 S. MAIN STREET  
WHEATON, ILLINOIS 60187

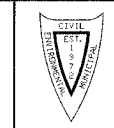

PREPARED BY:  
**CEMCON, Ltd.**  
Consulting Engineers, Land Surveyors & Planners  
2280 White Oak Circle, Suite 100  
Aurora, Illinois 60504-9675  
Ph: 630.862.2100 Fax: 630.862.2199  
E-Mail: cadd@cemcon.com Website: www.cemcon.com

NO.		DATE		DESCRIPTION	

**GENERAL PLAN & ELEVATION - BICYCLE PATH BRIDGE**  
**PEDESTRIAN/BICYCLE PATH BRIDGE OVER UNION PACIFIC RAILROAD**

FILE NAME: PLAN_50	DSGN. BY: MMH	JOB NO.: 551.007	FLD. BK./PG.: -----
DISC. NUMBER: 551007	DRN. BY: KMS	DATE: 12-21-04	SCALE: 1" = -----

SHEET NO. 14 of 54

INDEX OF BRIDGE SHEETS  
SHEET S1 OF S29  
XREF: OVER\_50.DWG  
Copyright © 2003 Cemcon, Ltd. All rights reserved.