

ROUTE NO.	SECTION	COUNTY	TOTAL SHEETS	SHEET NO.
S.R.L. No. 3762	01-00139-02-BR	WILL	35	23
FED. ROAD DIST. NO. 1	ILLINOIS	FED. AID PROJECT-		

SHEET NO. S-09
S-13 SHEETS

CONTRACT # 83802

NOTES:

1. Removal of Existing Concrete shall conform to Article 501.03 of the Standard Specifications.
2. Existing reinforcement extending into removal areas shall be cleaned, straightened, and incorporated into the new construction.
3. Preserve and incorporate existing u Bar's located in the Back Wall.
4. Work this sheet with S-12.

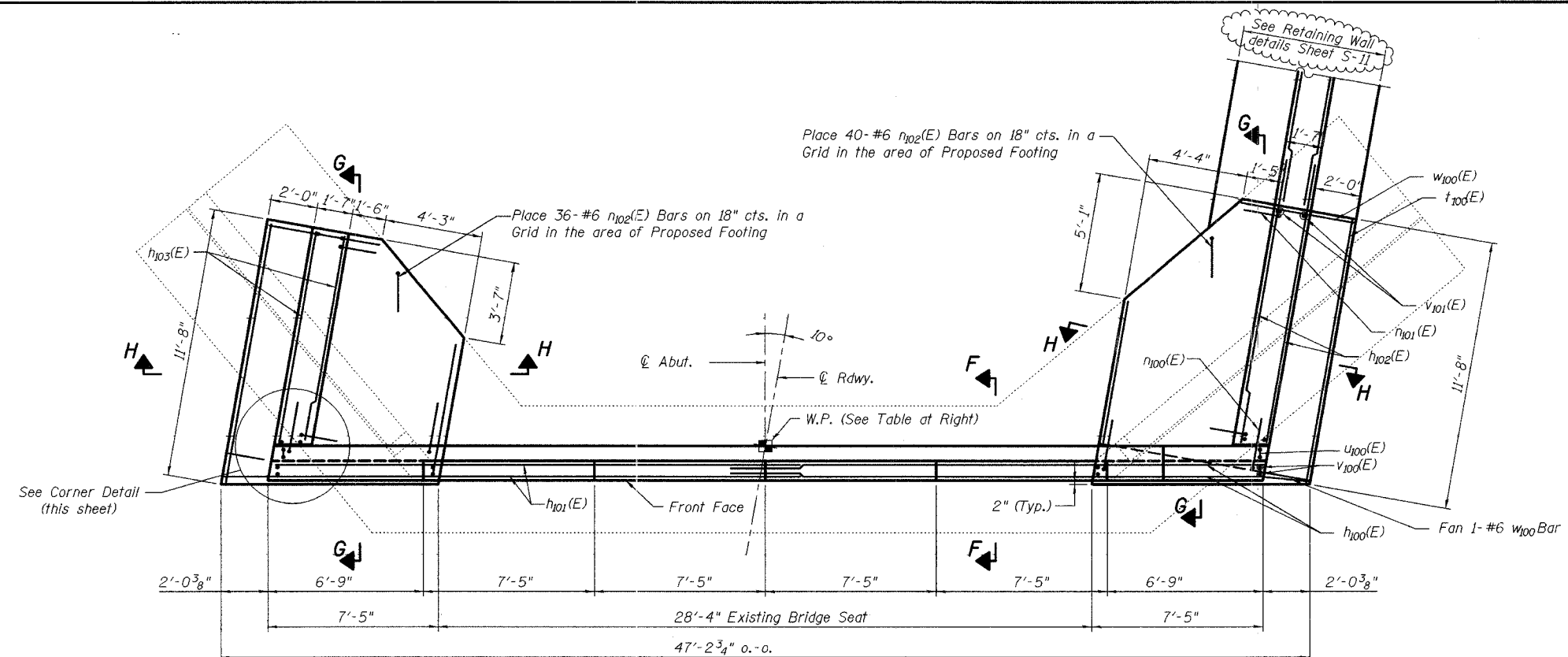

PLAN

Not to Scale

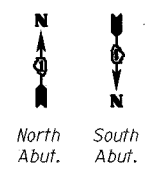

WORK POINT TABLE

Work Point	Harlem Ave Station	Offset
1	106+76.00	0' R
2	107+24.70	0' R

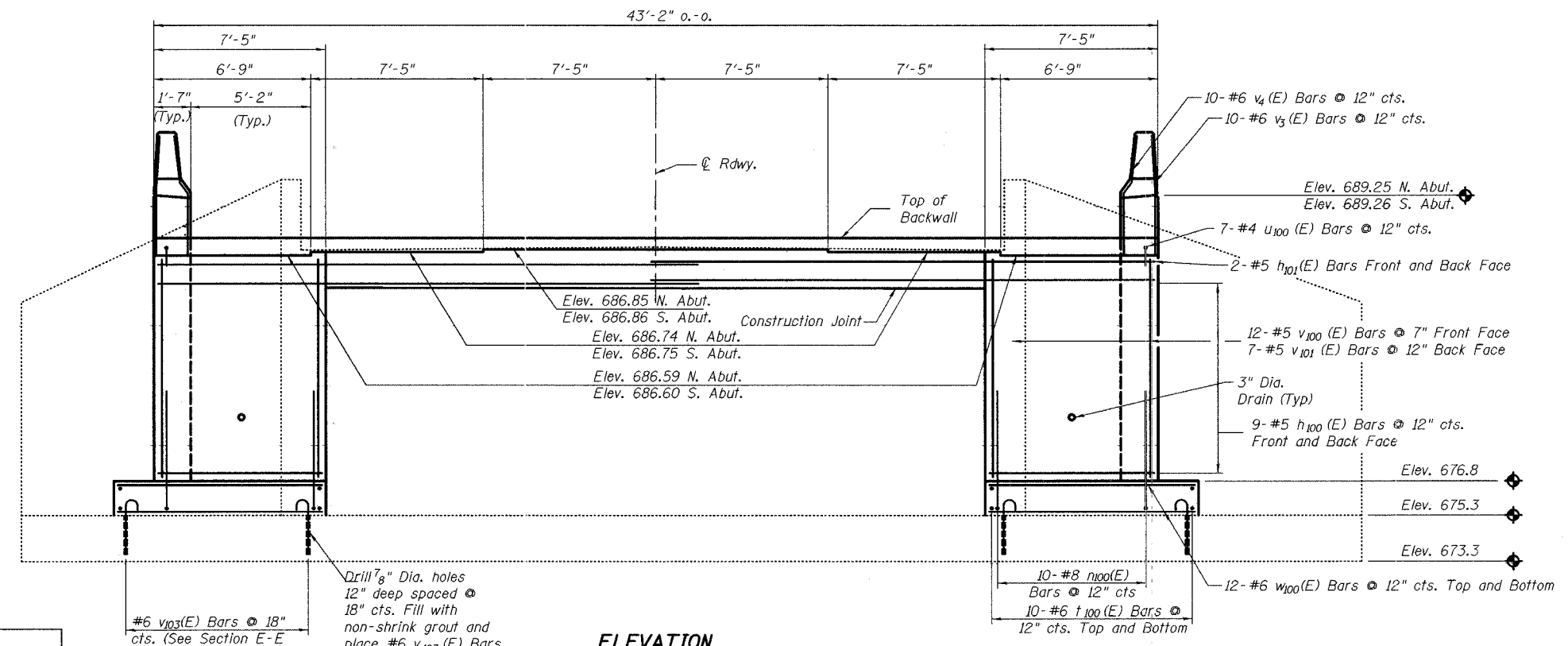

ELEVATION

Not to Scale

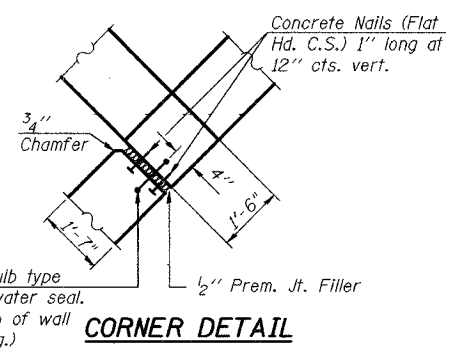

CORNER DETAIL

DESIGNED	MGH
CHECKED	RGD
DRAWN	WJH
CHECKED	NRF

SMITH ENGINEERING CONSULTANTS, INC. CIVIL/STRUCTURAL ENGINEERS	
REVISIONS	
NAME	DATE
WJH	1-11-06

ILLINOIS DEPARTMENT OF TRANSPORTATION
Abutment Plan and Elevation
Harlem Avenue/Drecksler Road
Over Black Walnut Creek
Will County
Section 01-00139-02-BR
SN. 099-3091
DATE 5-26-2005