

| | | | | |
|---------------------|----------|------------------|--------------|-----------|
| F.A. RTE. | SECTION | COUNTY | TOTAL SHEETS | SHEET NO. |
| DO-00236-00 BR | COOK | 18 | 11 | |
| STA. | TO STA. | | | |
| FED. ROAD DIST. NO. | ILLINOIS | FED. AID PROJECT | | |

CONTRACT NO. 83817

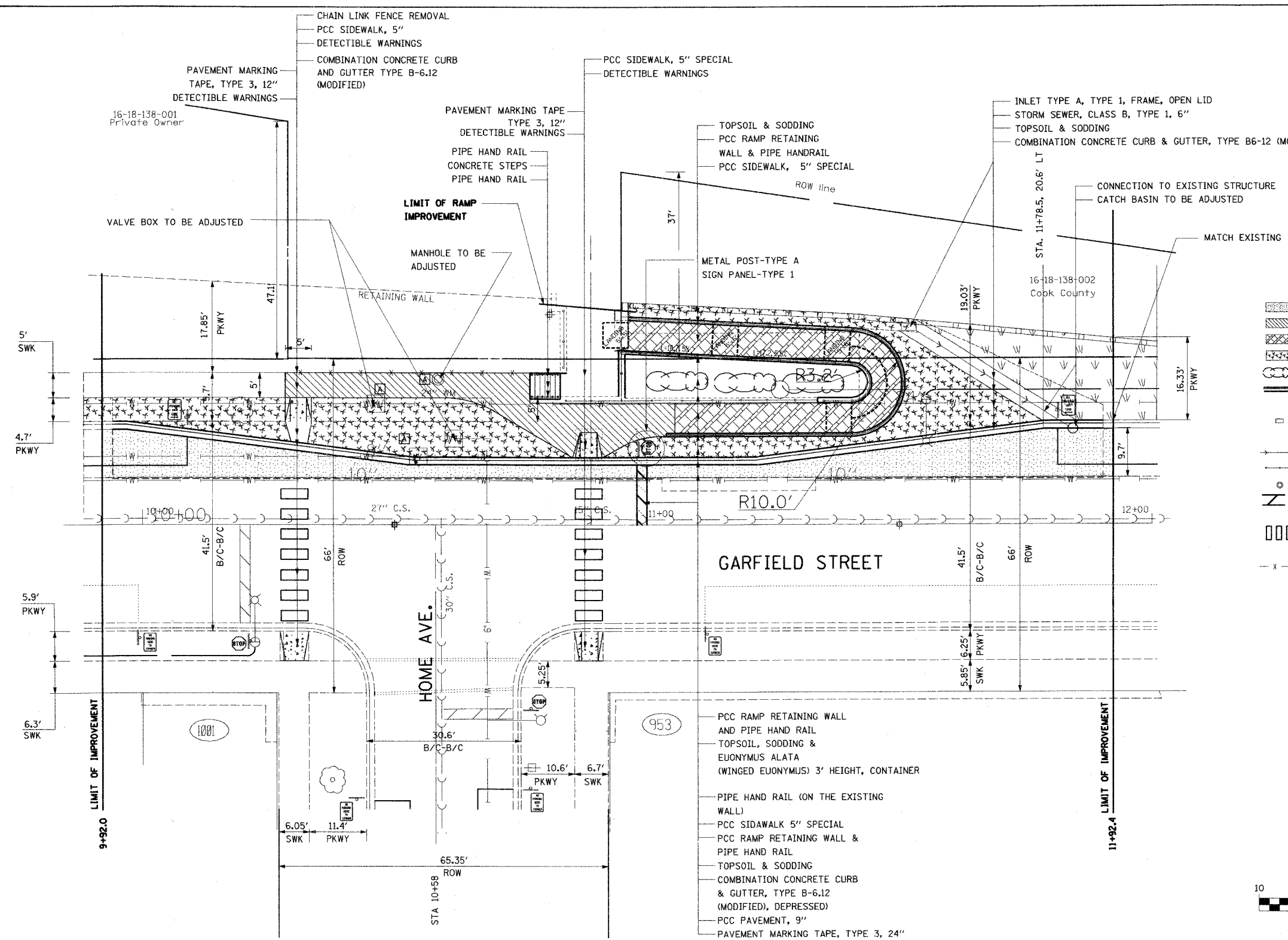

LEGEND

- PCC PAVEMENT, 9"
- PCC SIDEWALK, 5"
- PCC SIDEWALK, 5" SPECIAL
- TOPSOIL AND SODDING
- TOPSOIL, SHRUBS AND SODDING
- COMBINATION CONCRETE CURB AND GUTTER TYPE B6.12 (MODIFIED)
- INLET TYPE A, TYPE 1, FRAME OPEN LID
- OPEN LID
- STORM SEWER, CLASS B, TYPE 1, 6"
- PIPE HAND RAIL
- MANHOLE TO BE ADJUSTED
- PAVEMENT MARKING TAPE, TYPE 3, 24"
- PAVEMENT MARKING TAPE, TYPE 3, 12"
- CHAIN LINK FENCE REMOVAL

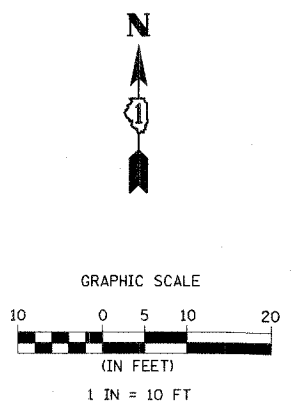

- PCC RAMP RETAINING WALL AND PIPE HAND RAIL
- TOPSOIL, SODDING & EUONYMUS ALATA (WINGED EUONYMUS) 3' HEIGHT, CONTAINER
- PIPE HAND RAIL (ON THE EXISTING WALL)
- PCC SIDEWALK 5" SPECIAL
- PCC RAMP RETAINING WALL & PIPE HAND RAIL
- TOPSOIL & SODDING
- COMBINATION CONCRETE CURB & GUTTER, TYPE B-6.12 (MODIFIED), DEPRESSED
- PCC PAVEMENT, 9"
- PAVEMENT MARKING TAPE, TYPE 3, 24"

* BENCH MARK: FH @ S.E. CORNER OF GARFIELD ST. AND HOME AVE.
1ST BOLT POST ARROW HEAD: 41.25

| REVISIONS | |
|-----------|------|
| NAME | DATE |
| | |
| | |
| | |
| | |
| | |
| | |
| | |
| | |
| | |
| | |

ILLINOIS DEPARTMENT OF TRANSPORTATION
HOME AVE PEDESTRAIN BRIDGE IMPROVEMENT
HOME AVE AND GARFIELD AVENUE.
PROPOSED CONDITIONS

SCALE: 1" = 10'
DATE: 9/15/2005

DRAWN BY FG
CHECKED BY SC

PLOT DATE = 08/15/05
PLOT SCALE = 1" = 10'
REFERENCE = REF