

F.A. RTE.	SECTION	COUNTY	TOTAL SHEETS	SHEET NO.
01-00236-00-BR	COOK	18	1	1

CONTRACT NO. 83817 +1 = 19

STATE OF ILLINOIS
DEPARTMENT OF TRANSPORTATION
DIVISION OF HIGHWAYS

**PROPOSED PLANS FOR FEDERAL AID
HIGHWAY**

HOME AVE PEDESTRIAN BRIDGE RAMP IMPROVEMENTS
AT GARFIELD AND HARRISON STREETS

ROUTE OFF-SYSTEM
SECTION 01-00236-00-BR
PROJECT TE-00D1 (583)
VILLAGE OF OAK PARK
COOK COUNTY
C-91-073-01

FOR INDEX OF SHEETS, SEE SHEET NO. 2



LOCATION OF SECTION INDICATED THIS: -

STATE OF ILLINOIS
DEPARTMENT OF TRANSPORTATION
DIVISION OF HIGHWAYS

APPROVED Sept 15 2005
Jamil Bou-Saab
VILLAGE ENGINEER

APPROVED Sept. 19 2005
Chang
BUREAU OF LOCAL
ROADS AND STREETS

APPROVED September 19, 2005
Dina O'Keefe
DEPUTY DIRECTOR OF HIGHWAY, REGION ENGINEER

SIGNATURE: *Jamil Bou-Saab*

DATE SIGNED: 9/14/05

LICENSE EXP. DATE: 11/30/05

PROJECT MANAGER: JAMIL BOU-SAAB P.E.
TEL: 312-467-0123

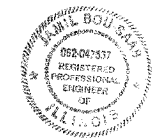

PRINTED BY AUTHORITY OF THE STATE OF ILLINOIS

HOME AVENUE AND HARRISON STREET IMPROVEMENT BEGINS STATION 13+12.00

HOME AVENUE AND HARRISON STREET IMPROVEMENT ENDS STATION 14+55.00

HOME AVENUE AND GARFIELD STREET IMPROVEMENT BEGINS STATION 9+92.00

HOME AVENUE AND GARFIELD STREET IMPROVEMENT ENDS STATION 11+92.40

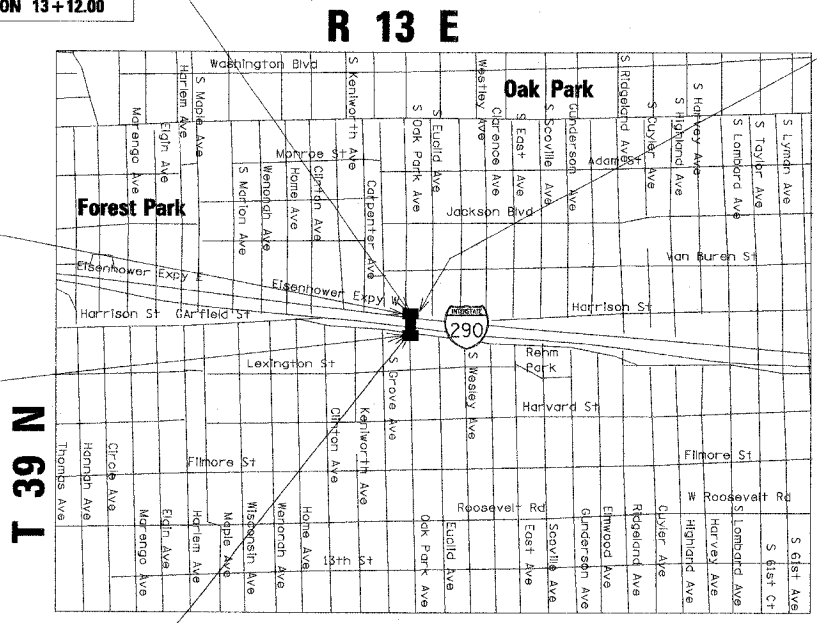

LOCATION MAP

PROJECT LENGTH 310.54 FT. (NOT TO SCALE)

VILLAGE OF OAK PARK
123 Madison Street
Oak Park, Illinois 60302

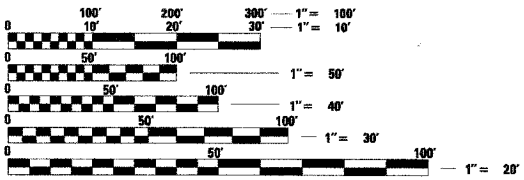

FULL SIZE PLANS HAVE BEEN PREPARED USING STANDARD ENGINEERING SCALES. REDUCED SIZED PLANS WILL NOT CONFORM TO STANDARD SCALES. IN MAKING MEASUREMENTS ON REDUCED PLANS, THE ABOVE SCALES MAY BE USED.

J.U.L.I.E.
JOINT UTILITY LOCATION INFORMATION FOR EXCAVATION
1-800-892-0123

CONTRACT NO. 83817

TERRA ENGINEERING LTD (312) 467-0123

FEDERAL AID DESIGN ENGINEER: JESSICA MILLER (1-847-705-4487)

GENERAL NOTES

Before starting any excavation, the contractor shall call "J.U.L.I.E." at 800-892-0123 for field locations of buried utilities and gas facilities. (48 hours notification is required).

The locations of existing utilities as shown on the plans are based on the best existing information available, but they are not guaranteed. It shall be the contractor's responsibility to ascertain their exact location from the utility companies and by field inspection. The contractor shall coordinate construction activities with utility companies.

The contractor will not be allowed to set up a yard or field office on state property without written permission from the Department.

It shall be the contractor's responsibility to verify all dimensions and conditions existing in the field prior to construction and ordering materials. Village water and sewer mains may be located in the landscape areas. The contractor will not be allowed to proceed with any planting work until all utility owners field locate their facilities which may interfere with construction operations. The actual location of proposed landscaping will be adjusted in the field to avoid utilities.

Where section or sub-section monuments are encountered, the engineer shall be notified before such monuments are removed. The contractor shall protect and carefully preserve all property markers and monuments until the owner, an authorized surveyor, or agent has witnessed their location.

The contractor shall use care in grading or excavating near any and all existing items which will not be removed. Any damage done to existing items by the contractor shall be repaired by the contractor at the contractor's own expense, or replaced with new item if the engineer deems necessary.

Abandoned underground utilities that may conflict with construction shall be disposed of outside the limits of the right of way according to article 202.03 of the standard specifications and as directed by the Engineer. This work will not be paid for separately but shall be included in the cost of Earth Excavation and no additional compensation will be allowed.

Any damage to underground facilities, caused by the contractor shall be repaired to the satisfaction of the Engineer at the contractor's expense, including temporary repairs which may be required to keep the facility operational while materials being obtained to make permanent repair.

The contractor shall protect underground utility structures in accordance with Article 107.20 of The Standard Specifications for Road and Bridge Construction during construction of the related items of the project. This work will not be paid for separately but shall be included in the pay items associated with the construction of the project.

Sign locations may vary from the stations shown on the plans in accordance with directions from the Engineer at the time of construction. Sign locations may be adjusted in the field to avoid existing utilities. Vertical holes shall be constructed at locations shown on the plans 4 inches. The holes shall be 24 inches in diameter or 24 inches square and shall be free of any obstruction, except earth, for a depth of 5 feet at the locations shown on the plans or as directed by the Engineer.

Any holes not used for the placement of signs shall be filled and compacted flush with top of the sidewalk. The top 3 inches of said compacted fill shall consist of a bituminous concrete mixture. This work, including any required removal necessary to construct the sign post holes, will not be paid for separately but shall be included in the contract unit price of the pay items provided.

The contractor should coordinate any contract tree removal activities with the utility companies to eliminate conflicts.

Earth excavation and backfill for proposed curb and gutters shall be included in the unit cost of the various contract items.

The contractor shall consult with the Engineer in regard to the exact length of the drainage items prior to ordering these items. Existing drainage pipes connected to new structures in accordance with section 602 of the Standard Specifications, the connecting of existing pipes or storm sewers to the proposed drainage system structures will not be paid for separately but shall be considered as included in the pay items provided.

The field personnel should be wearing attire that meets codes and requirements.

F.A. - RTE.	SECTION	COUNTY	TOTAL SHEETS	SHEET NO.
OFF	01-00236-00-BR	COOK	18	2
STA.	TO STA.			
FED. ROAD DIST. NO.	ILLINOIS	FED. AID PROJECT		
CONTRACT NO: 83817				

INDEX OF SHEETS

1	COVER SHEET
2	INDEX OF SHEETS / GENERAL NOTES / HWYS STANDARDS
3	SUMMARY OF QUANTITIES
4	TYPICAL SECTIONS-EXISTING GARFIELD STREET
5	TYPICAL SECTIONS EXISTING HARRISON STREET
6	TYPICAL SECTIONS- PROPOSED HARRISON ST.
7	TYPICAL SECTIONS- PROPOSED GARRFIELD ST.
8-9	SCHEDULE OF QUANTITIES
10-11	ROADWAY PLANS - GARFIELD STREET
12	GARFIELD STREET RAMP DETAILS
13-14	ROADWAY PLANS - HARRISON STREET
14A	R.O.W. PLAN
15-17	PROPOSED LIGHTING PLANS
18	PROPOSED STRUCTURAL DETAILS
19-45	HIGHWAY STANDARDS

HIGHWAY STANDARDS

00001-04	STANDARD SYMBOLS, ABBREVIATIONS AND PATTERNS
001001	AREAS OF REINFORCEMENT REBARS
442201-01	CLASS C AND D PATCHES
424001-03	CURB RAMPS FOR SIDEWALKS
602301	INLET - TYPE A
606001-02	CONCRETE CURB TYPE B AND COMBINATION CURB AND GUTTER
664001-01	CHAIN LINK FENCE
701301-02	LANE CLOSURE, 2L, 2W, SHORT TIME OPERATIONS
701501-03	URBAN LANE CLOSURE, 2L, 2W, UNDIVIDED
701801-03	LANE CLOSURE MULTILANE 1W OR 2W CROSSWALK OR SIDEWALK CLOSURE
702001-05	TRAFFIC CONTROL DEVICES
780001-01	TYPICAL PAVEMENT MARKINGS
878001-03	CONCRETE FOUNDATION DETAILS

REVISIONS	NAME	DATE	

ILLINOIS DEPARTMENT OF TRANSPORTATION

HOME AVE PEDESTRAIN BRIDGE IMPROVEMENT

INDEX OF SHEETS & GENERAL NOTES

SCALE: NOT TO SCALE DRAWN BY: CC

DATE: 11/23/2005 CHECKED BY: SC

F.A. RTE.	SECTION	COUNTY	TOTAL SHEETS	SHEET NO.
	01-00836-00 BR	COOK	18	3
STA.	TO STA.			
FED. ROAD DIST. NO.	ILLINOIS	FED. AID PROJECT		
CONTRACT NO. 83817				

BILL OF MATERIALS			TOTAL QUANTITY	Y047	
Code NO.	ITEM	UNIT		South End	North End
20100110	TREE REMOVAL (6 TO 15 UNITS DIAMETER)	UNIT	12		12
* 20101400	NITROGEN FERTILIZER NUTRIENT	POUND	10	8	2
* 20101500	PHOSPHORUS FERTILIZER NUTRIENT	POUND	10	8	2
* 20101600	POTASSIUM FERTILIZER NUTRIENT	POUND	10	8	2
20200100	EARTH EXCAVATION	CU YD	40	25	15
20201500	SUB-BASE GRANULAR MATERIAL, TYPE B	TON	460	340	120
20800150	TRENCH BACKFILL	CU YD	25	25	
21101615	TOP SOIL FURNISH AND PLACE, 4"	SQ YD	145	130	15
* 25200100	SODDING	SQ YD	221	200	21
25200200	SUPPLEMENTAL WATERING	UNIT	13	11	2
35300100	PORTLAND CEMENT CONC. BASE COURSE, 6"	SQ YD	4		4
42000400	PORTLAND CEMENT CONCRETE PAVEMENT, 9"	SQ YD	228	216	12
42001300	PROTECTIVE COAT	SQ YD	442	300	142
42400200	PORTLAND CEMENT CONCRETE SIDEWALK 5 INCH	SQ FT	1643	843	800
42400430	PORTLAND CEMENT CONCRETE SIDEWALK 5 INCH SPECIAL	SQ FT	946	793	153
44000100	PAVEMENT REMOVAL	SQ YD	228	216	12
44000500	COMBINATION CURB AND GUTTER REMOVAL	FOOT	332	200	132
42400800	DETECTABLE WARNINGS	SQ FT	300	200	100
44000600	SIDEWALK REMOVAL	SQ FT	1410	520	890
51000105	PIPE HANDRAIL	FOOT	305	280	25
550B0020	STORM SEWERS, CLASS B, TYPE 1 6"	FOOT	36	36	
60234200	INLET, TYPE A, TYPE 1 FRAME, OPEN LID	EACH	1	1	
60250200	CATCH BASIN TO BE ADJUSTED	EACH	1	1	
60255500	MANHOLE TO BE ADJUSTED	EACH	1	1	
60265700	VALVE VAULTS TO BE ADJUSTED	EACH	2	2	
60266600	VALVE BOXES TO BE ADJUSTED	EACH	1	1	
60600605	CONCRETE CURB, TYPE B	FOOT	50.5	50.5	
60604100	COMBINATION CONCRETE CURB AND GUTTER, TYPE B-6.12 (MODIFIED)	FOOT	315	210	105
63200310	GUARDRAIL REMOVAL	FOOT	100	100	
66400105	CHAIN LINK FENCE, 4'	FOOT	87	37	50
66410300	CHAIN LINK FENCE REMOVAL	FOOT	87	37	50
67100100	MOBILIZATION	L SUM	1		
70102620	TRAFFIC CONTROL AND PROTECTION, STANDARD 701501	L SUM	1	0.5	0.5
70102640	TRAFFIC CONTROL AND PROTECTION, STANDARD 701801	L SUM	1	0.5	0.5
70300510	PAVEMENT MARKING, TYPE 3, LETTERS AND SYMBOLS	SQ FT	60		60

BILL OF MATERIALS			TOTAL QUANTITY	Y047	
Code NO.	ITEM	UNIT		South End	North End
70300560	PAVEMENT MARKING TAPE, TYPE 3, 12"	FOOT	144	108	36
70300570	PAVEMENT MARKING TAPE, TYPE 3, 24"	FOOT	66	30	36
72000100	SIGN PANEL - TYPE 1	SQ FT	2	2	
72400900	REMOVE SIGN PANEL	EACH	1	1	
72900100	METAL POST - TYPE A	FOOT	10	10	
78300100	PAVEMENT MARKING REMOVAL	SQ FT	70	40	30
* 80500300	SERVICE INSTALLTION TYPE C	EACH	1		1
* 81000400	CONDUIT IN TRENCH, 1 1/4" DIA., GALVANIZED STEEL	FOOT	15		15
* 81030000	CLEANING EXISTING CONDUIT	FOOT	123		123
* 81030100	CONDUIT SPLICE	EACH	1		1
* 81400115	HANDHOLE TO BE ADJUSTED	EACH	1		1
* 81500200	TRENCH AND BACKFILL FOR ELECTRICAL WORK	FOOT	50		50
* 81600210	UNIT DUCT, 2#8XLP, 1#8 BARE GROUND 3/4" POLYETHYLENE	FOOT	300		300
* 81701115	ELECTRIC CABLE IN CONDUIT, 600V (EPR-TYPE USE) 1/C NO. 2	FOOT	360		360
* 82500530	LIGHTING CONTROLLER TYPE CB-RCS 100AMP - 240VOLT	EACH	1		1
* 84400105	RELOCATE EXISTING LIGHTING UNIT	EACH	1		1
* 84500110	REMOVAL OF LIGHTING CONTROLLER	EACH	1		1
* 84500130	REMOVAL OF LIGHTING CONTROLLER FOUNDATION	EACH	1		1
* 87800100	CONCRETE FOUNDATION, TYPE A	FOOT	1		1
* 89501510	RELOCATE EXISTING FLASHING BEACON	EACH	1		1
* 89502300	REMOVE ELECTRIC CABLE FROM CONDUIT	FOOT	123		123
* C2C02536	SHRUB, EUONYMUS ALATA (WINGED EUONYMUS), 3' HEIGHT, CONTAINER	EACH	26	26	
* X0322951	CABLE SPLICE SPECIAL	EACH	9		9
* X5010205	REMOVAL OF EXISTING STRUCTURES, SPECIAL	EACH	1	1	
* XX003303	CONCRETE LIGHT POLE	EACH	1		1
XX004067	EXPANSION TIE ANCHORS, 3/4"	EACH	353	300	53
XX004242	ORNAMENTAL HANDRAIL	FOOT	300	250	50
* XX004803	CONDUIT IN TRENCH	FOOT	134		134
* XX000876	LUMINAIRE, METAL HALIDE HORIZONTAL MOUNT 250 WATT	EACH	1		1
Z0012450	CONCRETE STEPS	CU YD	2.8	2.8	
Z0013798	CONSTRUCTION LAYOUT	L SUM	1	0.5	0.5
Z0019600	DUST CONTROL WATERING	UNIT	20	10	10
Z0076500	TRAFFIC CHANNELIZING POSTS	EACH	10		10
* XX006422	REMOVAL OF PHOTOCCELL, SALVAGE	EACH	1		1
XX006423	PORTLAND CEMENT CONCRETE RAMP RETAINING WALLS	CU YD	35	35	
Z0048605	RAILROAD PROTECTIVE LIABILITY INSURANCE	L SUM	1	1	

* SPECIALTY ITEMS

PLT DATE = 9/20/2005
 FILE NAME = 090505 SOQ.dgn
 PLOT SCALE = AS SHOWN
 REFERENCE = #REF*

REVISIONS		ILLINOIS DEPARTMENT OF TRANSPORTATION
NAME	DATE	
		HOME AVE PEDESTRAIN BRIDGE IMPROVEMENT SUMMARY OF QUANTITIES SCALE: NOT TO SCALE DATE 09-06-05

F.A. RTE.	SECTION	COUNTY	TOTAL SHEETS	SHEET NO.
00-00236-00 BR	COOK	18	4	
STA.	TO STA.			
FED. ROAD DIST. NO.	ILLINOIS FED. AID PROJECT			

CONTRACT NO. 83817

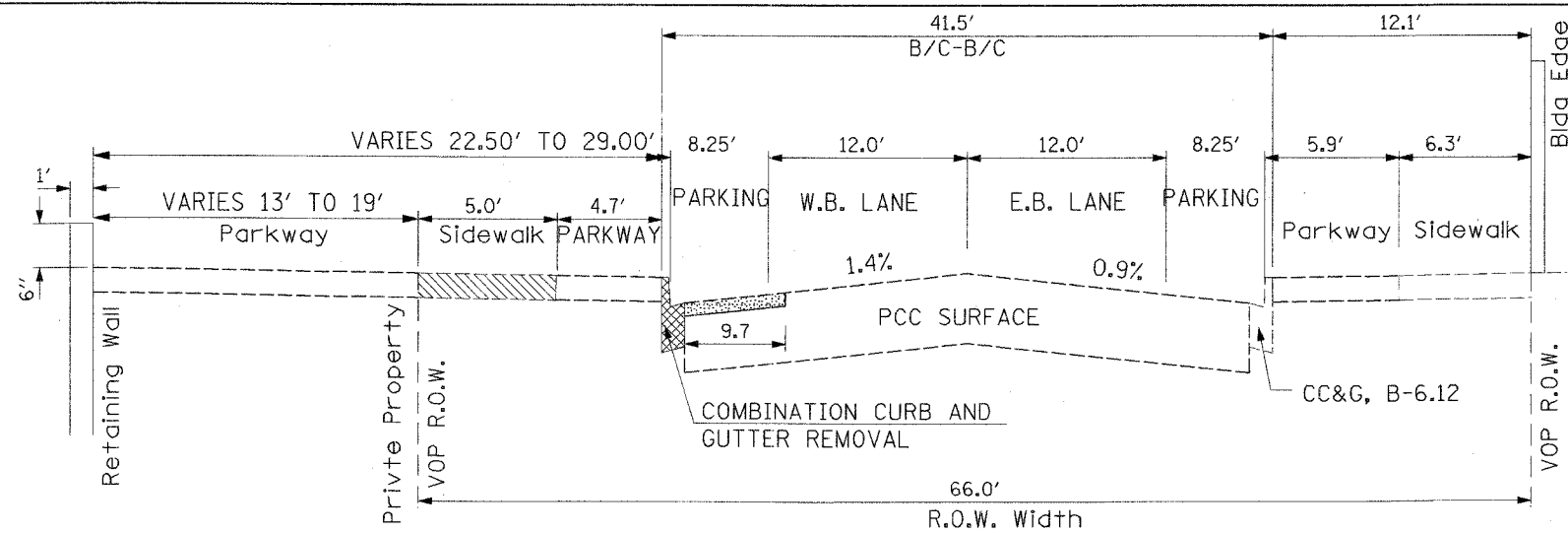

EXISTING STA. 9+92 TO STA 10+79

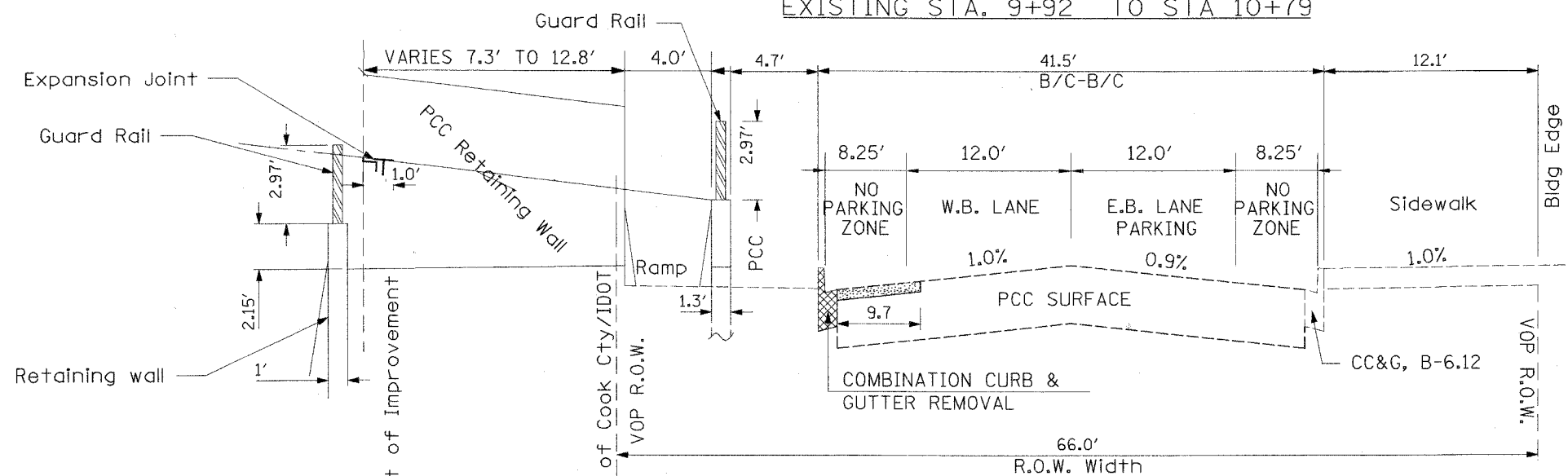

EXISTING STA 10+79.00 TO STA 11+33.00

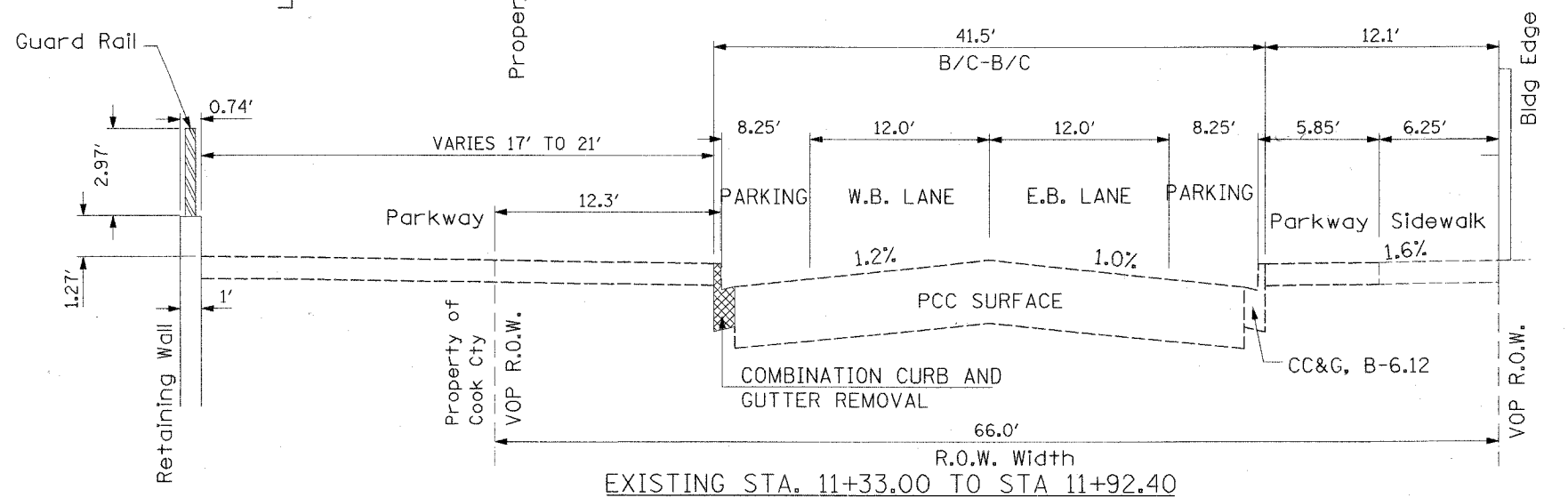

EXISTING STA. 11+33.00 TO STA 11+92.40

LEGEND

- COMBINATION CURB AND GUTTER REMOVAL
- PAVEMENT REMOVAL
- SIDEWALK REMOVAL

BITUMINOUS MIXTURE REQUIREMENT

ITEM	AC TYPE	VOIDS	RAP %
SUPERPAVE MIX C, NSO SURF.	PG 64-22	4 % @ 50 GYR	15 %

LIMIT WEIGHT: 112#/SQ. YD. / IN.

REVISIONS	
NAME	DATE

ILLINOIS DEPARTMENT OF TRANSPORTATION
 HOME AVE PEDESTRAIN BRIDGE IMPROVEMENT
 EXISTING TYPICAL SECTIONS
 GARFIELD STREET

SCALE: NOT TO SCALE
 DATE: 9/15/2005

DRAWN BY FG
 CHECKED BY SC

PLOT DATE = 09/15/05
 FILE NAME = #REF!
 PLOT SCALE = #REF!
 REFERENCE = #REF!

F.A. RTE.	SECTION	COUNTY	TOTAL SHEETS	SHEET NO.
00-00236-00 BR	COOK		18	5
STA.	TO STA.			
FED. ROAD DIST. NO.	ILLINOIS	FED. AID PROJECT		
CONTRACT NO. 83817				

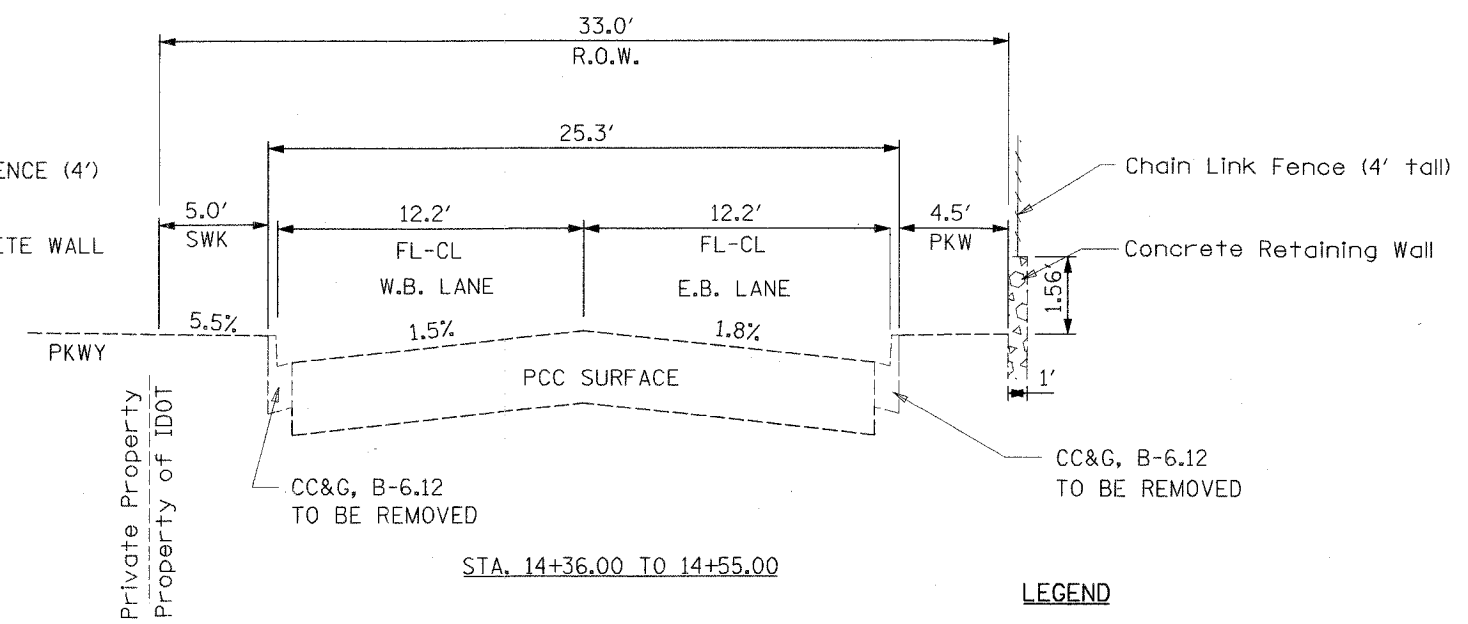
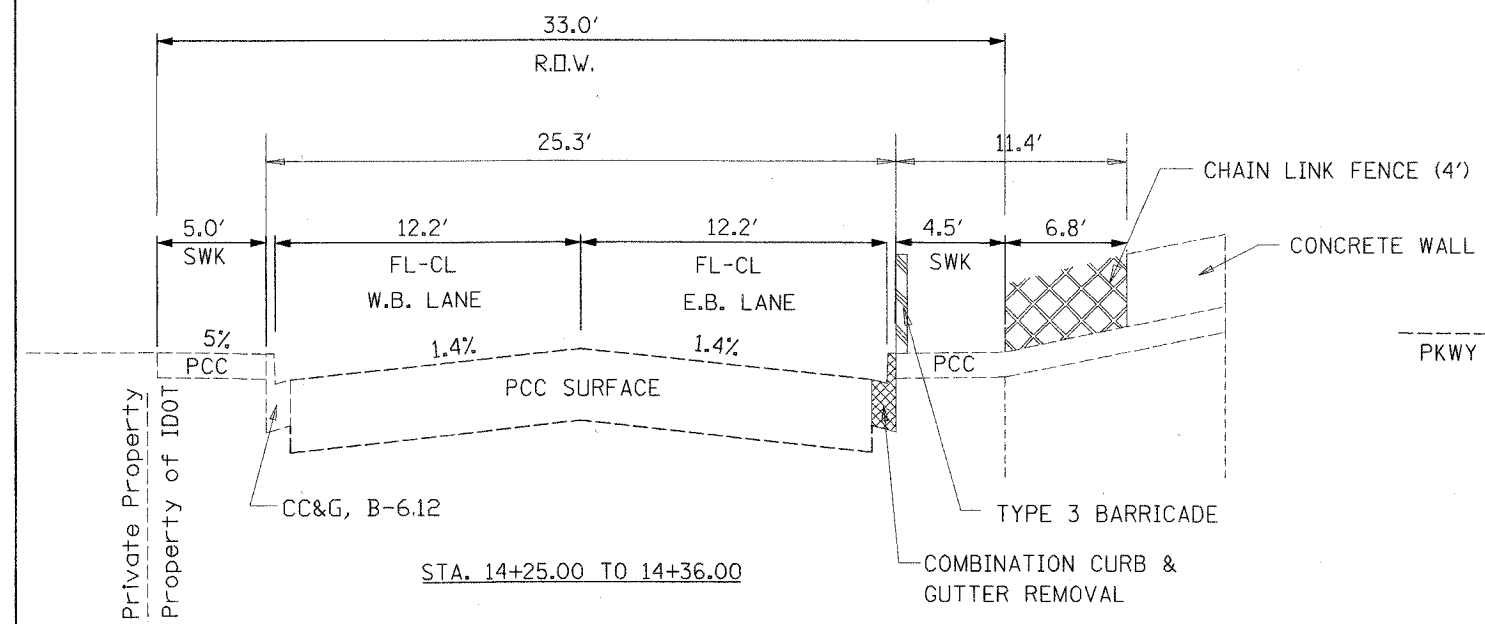
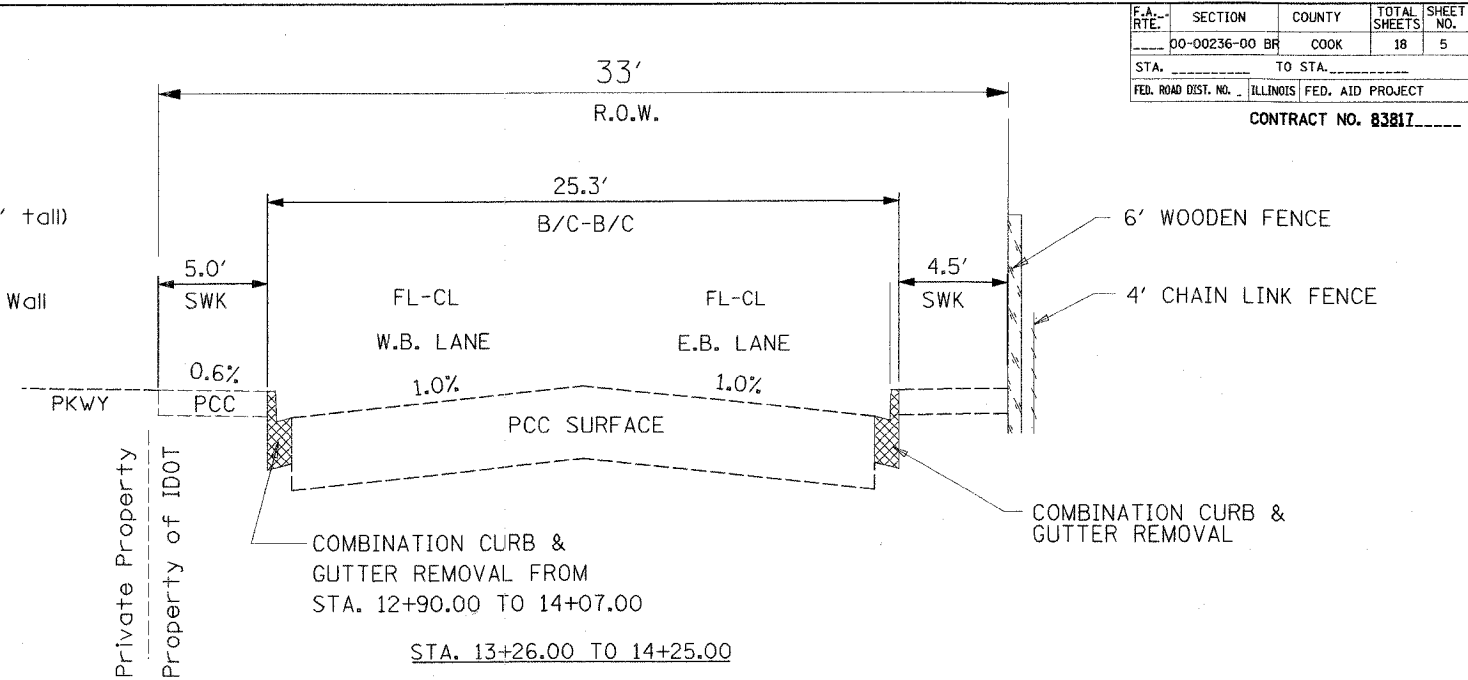
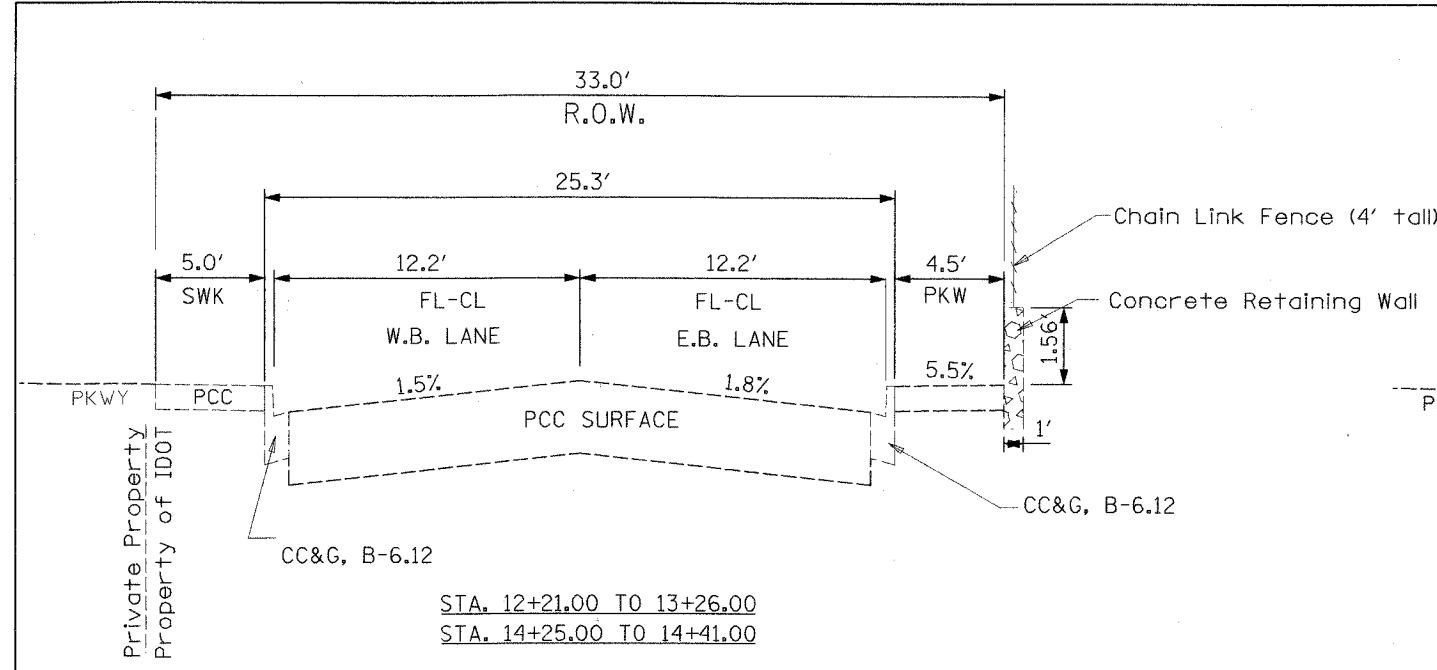

LEGEND

COMBINATION CURB & GUTTER REMOVAL

REVISIONS	
NAME	DATE

ILLINOIS DEPARTMENT OF TRANSPORTATION

HOME AVE PEDESTRAIN BRIDGE IMPROVEMENT

EXISTING TYPICAL SECTIONS

HARRISON AVENUE

SCALE: NOT TO SCALE

DATE: 9/15/2005

DRAWN BY FG

CHECKED BY SC

PLOT DATE = 04/28/05
 FILE NAME = 04/28/05
 PLOT SCALE = 1/8"=1'-0"
 REFERENCE = WEP4

F.A. RT.	SECTION	COUNTY	TOTAL SHEETS	SHEET NO.
	00-00236-00 BR	COOK	18	6
STA.	TO STA.			
FED. ROAD DIST. NO.	ILLINOIS	FED. AID PROJECT		

CONTRACT NO. 83817

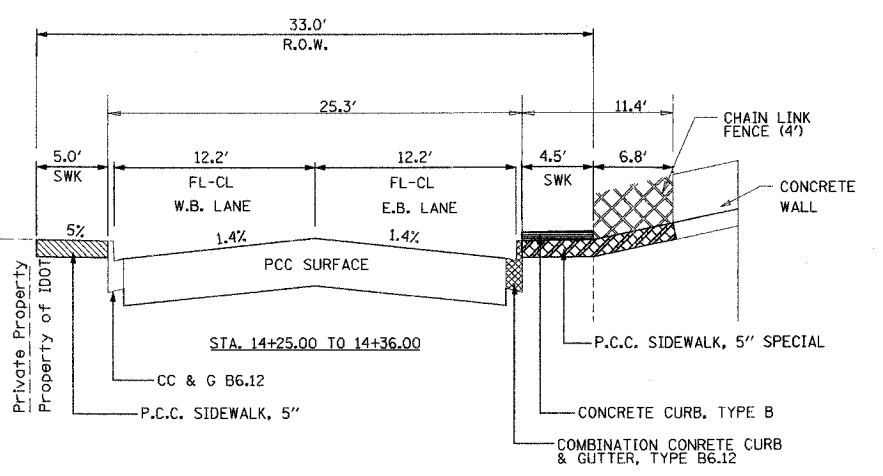
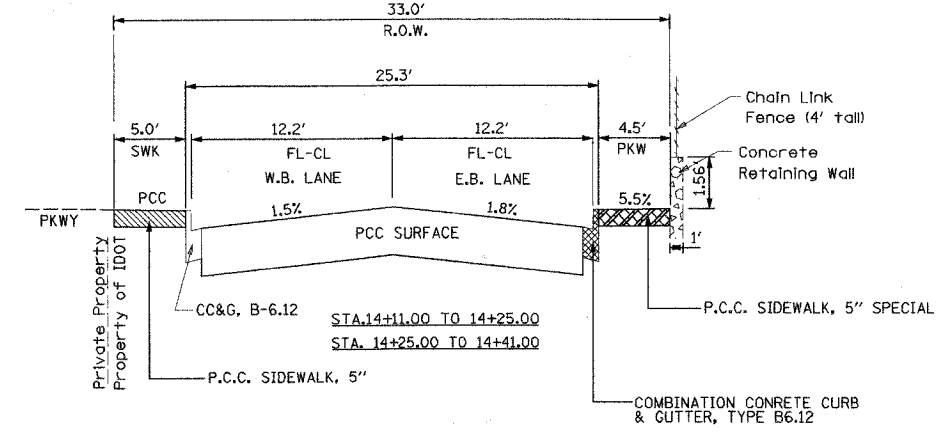
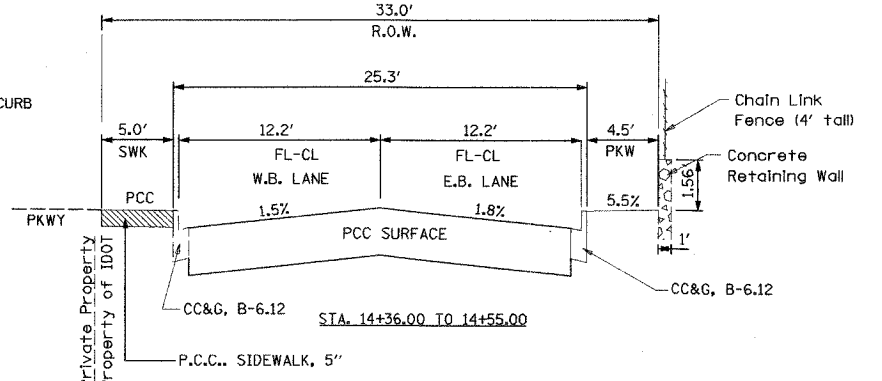
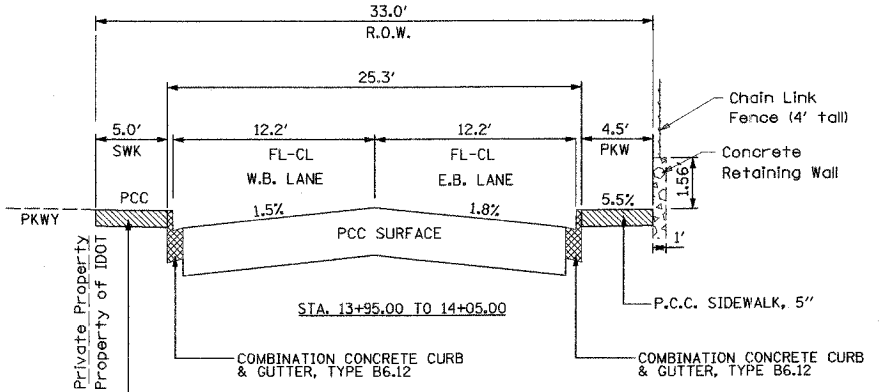
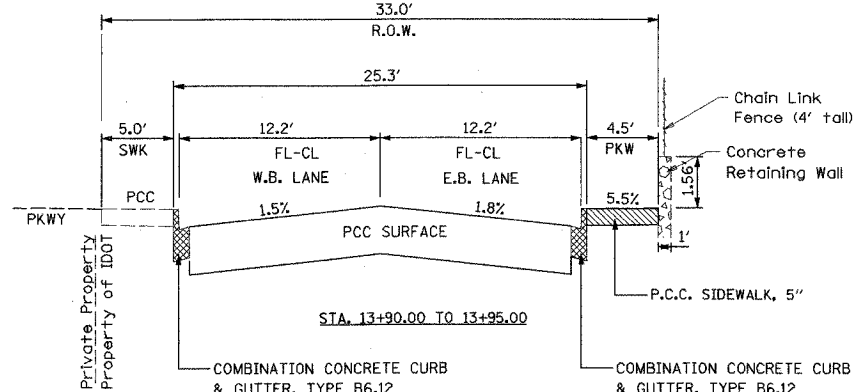
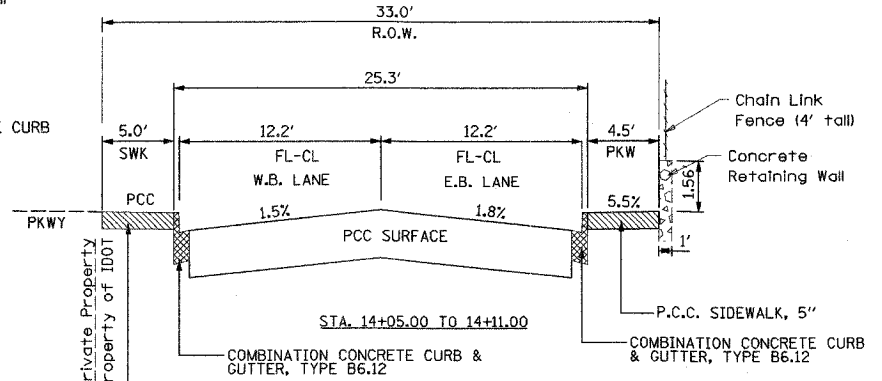
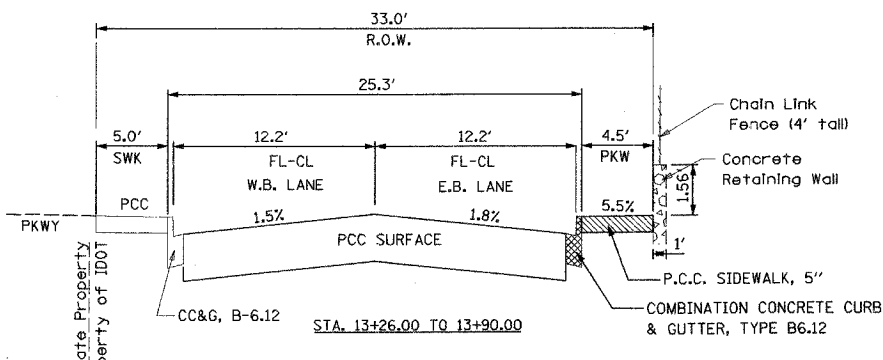
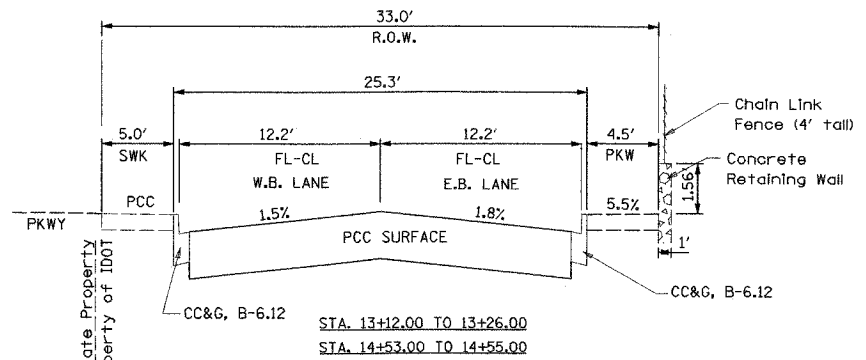

LEGEND

	PORTLAND CEMENT CONCRETE SIDEWALK, 5"
	PORTLAND CEMENT CONCRETE SIDEWALK, 5" SPECIAL
	CONCRETE CURB, TYPE B
	COMBINATION CONCRETE GUTTER & GUTTER, TYPE B6.12

REVISIONS	
NAME	DATE

ILLINOIS DEPARTMENT OF TRANSPORTATION
 HOME AVE PEDESTRAIN BRIDGE IMPROVEMENT
 PROPOSED TYPICAL SECTIONS
 HARRISON AVENUE
 SCALE: NOT TO SCALE
 DATE: 9/15/2005
 DRAWN BY FG
 CHECKED BY SC

DATE = 08/15/05
 FILE NAME = 081505
 PLOT SCALE = 1/8"=1'-0"
 REFERENCE = SHEET

F.A. RTE.	SECTION	COUNTY	TOTAL SHEETS	SHEET NO.
DO-00236-00 BR	COOK	18	7	
STA.		TO STA.		
FED. ROAD DIST. NO.		ILLINOIS FED. AID PROJECT		

CONTRACT NO. 83817

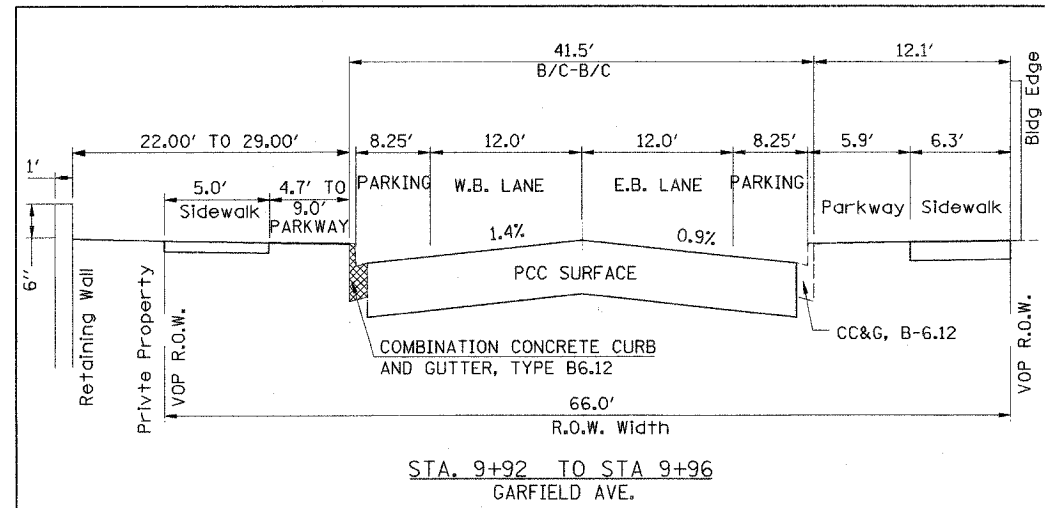

STA. 9+92 TO STA 9+96
GARFIELD AVE.

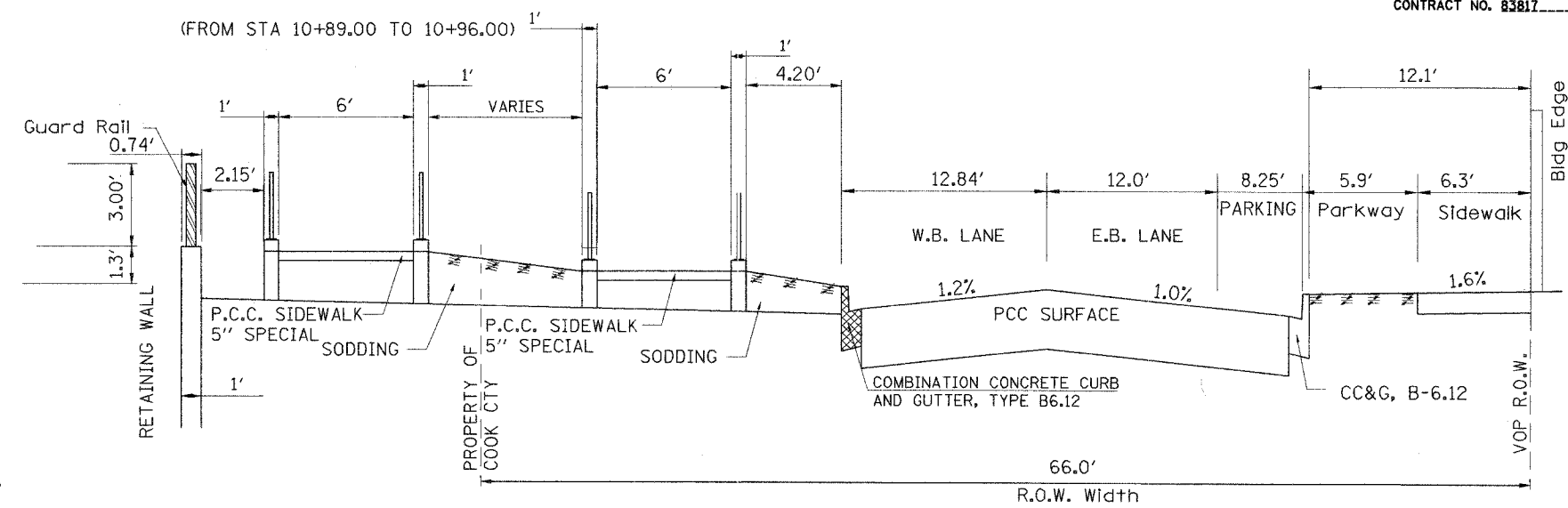

STA 10+95 TO 11+51
GARFIELD AVE.

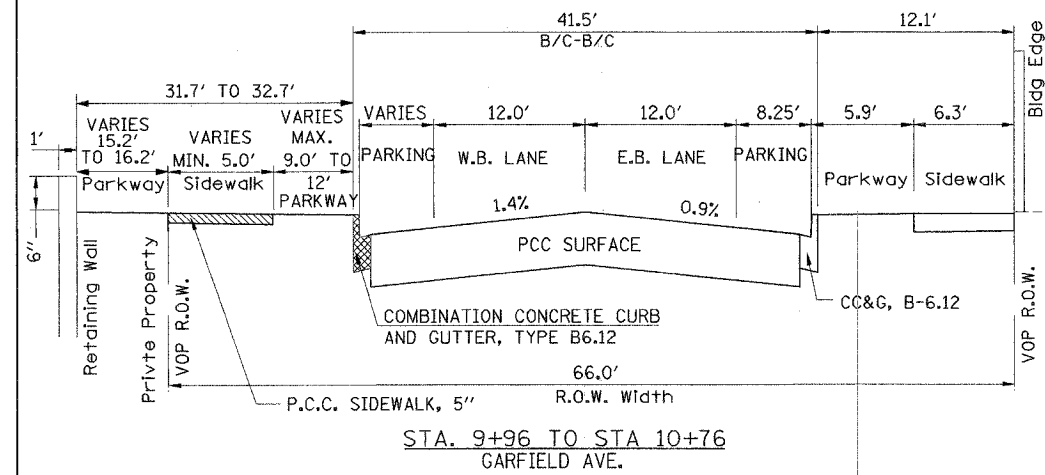

STA. 9+96 TO STA 10+76
GARFIELD AVE.

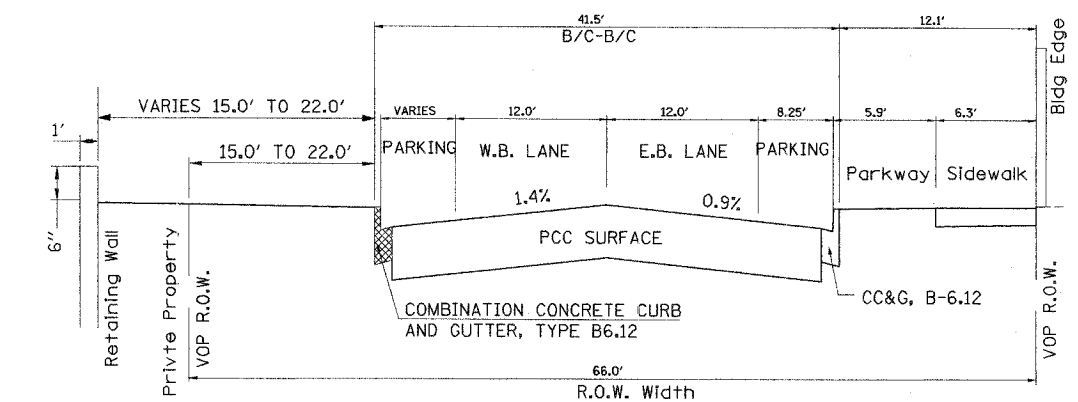

STA. 11+51 TO STA 11+92
GARFIELD AVE.

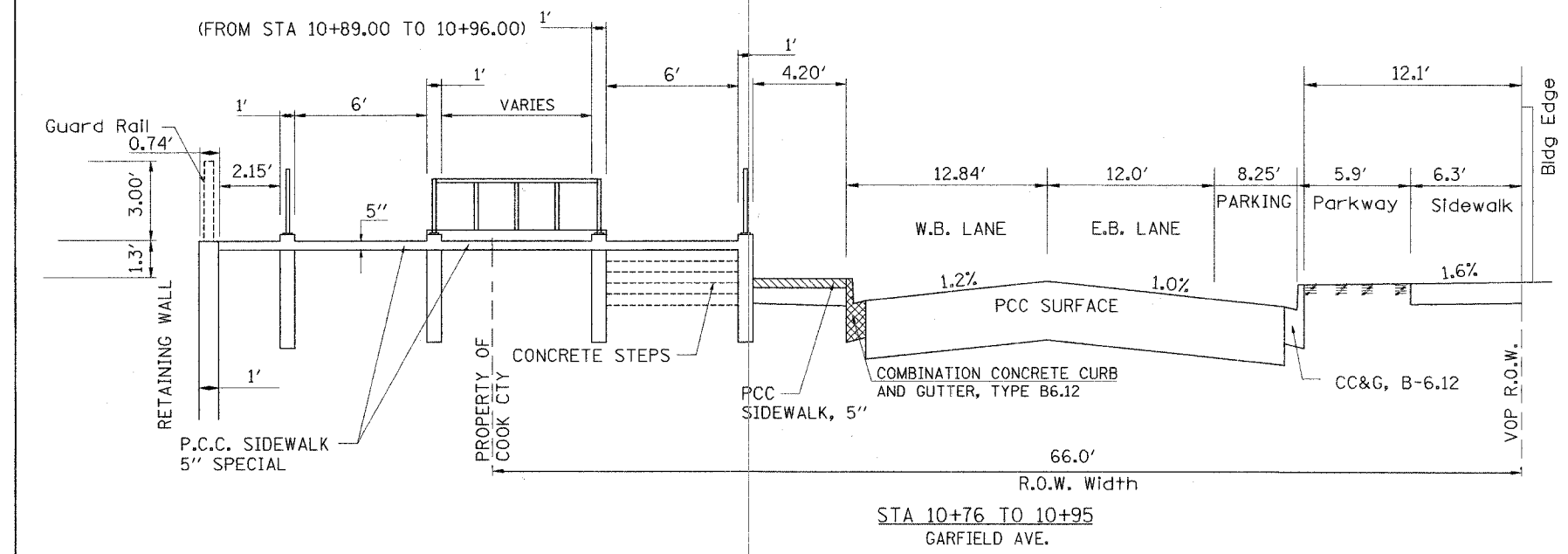

STA 10+76 TO 10+95
GARFIELD AVE.

REVISIONS	
NAME	DATE

ILLINOIS DEPARTMENT OF TRANSPORTATION
HOME AVE PEDESTRAIN BRIDGE IMPROVEMENT
PROPOSED TYPICAL SECTIONS
GARFIELD STREET
SCALE: NOT TO SCALE
DATE: 9/15/2005
DRAWN BY FG
CHECKED BY SC

PLOT DATE = 9/20/2005
FILE NAME = #FILE#
PLOT SCALE = #SCALE#
REFERENCE = #REF#

F.A. RTE.	SECTION	COUNTY	TOTAL SHEETS	SHEET NO.
	01-00236-00 BR	COOK	18	8
STA.		TO STA.		
FED. ROAD DIST. NO.		ILLINOIS	FED. AID PROJECT	
CONTRACT NO. 83817				

SCHEDULE OF REMOVAL				
LOCATION	SIDEWALK SQ. FT.	CC&B FOOT	CHAIN LINK FENCE FOOT	PAVEMENT REMOVAL SQ YD
GARFIELD STREET				
STA 10+29 TO STA 11+33	520			
STA 10+29 TO STA 10+79			50	
STA 9+92 TO STA 11+92		200		
STA 9+92 TO STA 11+92				216
HARRISON STREET				
STA 13+21 TO STA 14+41		115		
STA 13+90 TO STA 14+07		17		
STA 13+26 TO STA 14+41	575			
STA 13+90 TO STA 14+53	315			
STA 14+37 TO STA 14+55			18	
STA 14+06 TO STA 14+25			19	
STA 14+44 TO STA 14+49				12
TOTAL	1410	332	87	228

TREE REMOVAL SCHEDULE			
20100110			
LOCATION CENTERLINE	OFFSET	OFFSET DISTANCE (FT)	TREE REMOVAL (6 TO 15 UNITS DIAMETER)
HARRISON AVE.			
13+63	RT	15	12
TOTAL			12

EARTHWORK REMOVAL SCHEDULE	
20200100	
LOCATION	EARTH EXCAVATION (CY)
GARFIELD AVE.	
STA. 10+86.67 TO STA. 11+42.22	25
HARRISON AVE.	
STA. 14+00 TO STA. 14+47	11
STA. 14+44 TO STA. 14+47	4
TOTAL	40

PLOT DATE = 08/20/05
 PLOT NAME = 08/20/05
 PLOT SCALE = AS SHOWN
 REFERENCE = 08/20/05

REVISIONS		ILLINOIS DEPARTMENT OF TRANSPORTATION
NAME	DATE	
		HOME AVE PEDESTRAIN BRIDGE IMPROVEMENT SCHEDULE OF QUANTITIES 1 OF 2
SCALE: NOT TO SCALE		DRAWN BY FG
DATE: 09/06/05		CHECKED BY SC

CONTRACT NO. 83817

PIPE HANDRAIL SCHEDULE

LOCATION	OFFSET	SIDE	LENGTH (FT)
GARFIELD STREET			
10+74 To 11+44	24	N	69
11+04 TO 11+51	18	N	55
10+49 TO 11+44	33	N	50
10+96 TO 11+51	41	N	65
10+71 TO 10+84	29	N	13
10+96	24	N	10
HARRISON STREET			
14+05 TO 14+25	18	S	25
14+23 TO 14+37	13	S	18
TOTAL			305

DRAINAGE ITEMS SCHEDULE

LOCATION	MANHOLE TO BE ADJUSTED (EACH)	CATCH BASIN TO BE ADJUSTED (EACH)	VALVE VAULT TO BE ADJUSTED (EACH)	VALVE BOX TO BE ADJUSTED (EACH)	HAND HOLE TO BE ADJUSTED (EACH)
GARFIELD STREET					
11+84					
10+45		1			
10+58					
10+62	1				
10+54				1	
			1		
			1		1
TOTAL	1	1	2	1	1

SIDEWALK SCHEDULE

LOCATION	PCC SIDEWALK 5" (SQ. FT.)	PCC SIDEWALK 5" SPECIAL (SQ. FT.)
GARFIELD STREET		
9+92 TO 11+06	800	
10+84 TO 11+51		793
HARRISON STREET		
13+32 TO 14+15	568	
14+15 TO 14+37		153
13+96 TO 14+37	275	
TOTAL	1643	946

SEEDING AND SODDING SCHEDULE

LOCATION	SODDING (SQ. YD.)	EUONYMUS ALATA COMPACTA(EACH)	NITROGEN FERILIZER NUTRIENT(POUND)	PHOSPHORUS FERILIZER NUTRIENT(POUND)	POTASSIUM FERILIZER NUTRIENT(POUND)
GARFIELD STREET					
9+92 TO 11+92	200		9	9	9
10+94 TO 11+53		26			
HARRISON STREET					
14+38 TO 14+55	21		1	1	1
TOTAL	221	26	10	10	10

CONCRETE CURB AND GUTTER SCHEDULE

LOCATION	CONCRETE CURB TYPE B. (FT)	CCC & G TYPE B6.12(MODIFIED)(FT.)
GARFIELD STREET		
9+92 TO 11+89		210
HARRISON STREET		
13+32 TO 14+22		90
13+90 TO 14+05		15
14+05 TO 14+37	50.5	
TOTAL	50.5	315

REVISIONS	
NAME	DATE

ILLINOIS DEPARTMENT OF TRANSPORTATION
HOME AVE PEDESTRIAN BRIDGE IMPROVEMENT
SCHEDULE OF QUANTITIES 2 OF 2
SCALE: NOT TO SCALE
DATE: 09/06/05
DRAWN BY FG
CHECKED BY SC

PLAT DATE = 03/05/05
FILE NAME = MTRILEA
PLOT SCALE = AS CALLED
REFERENCE = RHEP

F.A. RTE.	SECTION	COUNTY	TOTAL SHEETS	SHEET NO.
00-00236-00 BR	COOK	18	10	
STA.	TO STA.			
FED. ROAD DIST. NO.		ILLINOIS	FED. AID PROJECT	
CONTRACT NO. 83817				

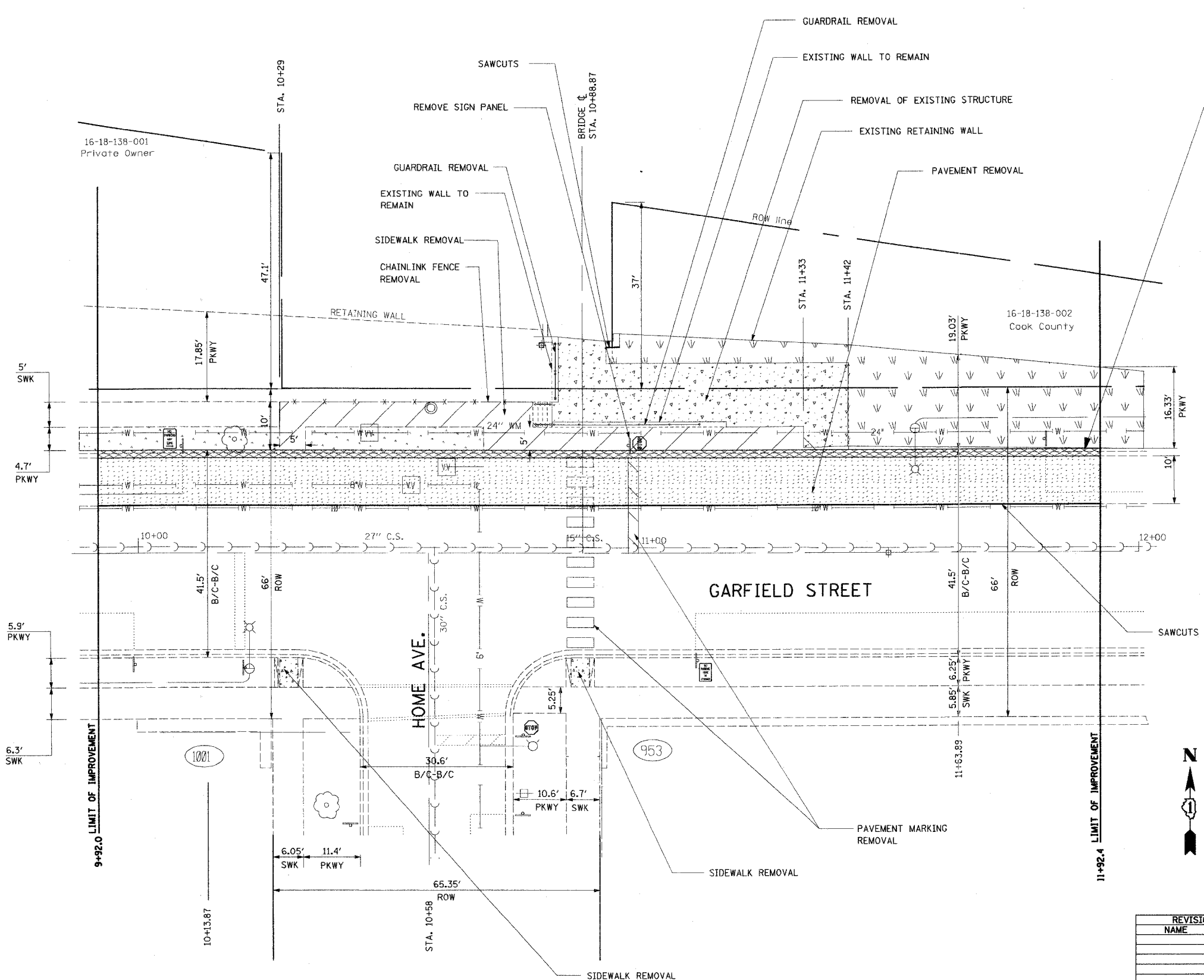

- EXISTING LEGEND**
- TREE
 - WATER MAIN
 - R. O. W.
 - VALVE VAULT
 - STRUCTURE
 - COMBINED STORM SEWER
 - EXISTING STOP SIGN
 - LANDSCAPE
 - EXISTING CURB AND GUTTER
 - STREET CENTER LINE
 - BUILDING ADDRESS
 - EXISTING FIRE HYDRANT

- REMOVAL LEGEND**
- SIDEWALK REMOVAL
 - CURB AND GUTTER REMOVAL
 - PAVEMENT REMOVAL
 - REMOVAL OF EXISTING STRUCTURE
 - GUARDRAIL REMOVAL
 - CHAIN LINK FENCE REMOVAL

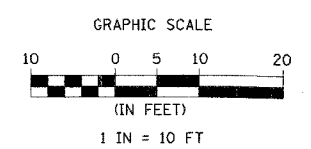

REVISIONS	
NAME	DATE

ILLINOIS DEPARTMENT OF TRANSPORTATION

HOME AVE PEDESTRAIN BRIDGE IMPROVEMENT
HOME AVE AND GARFIELD STREET
EXISTING CONDITIONS

SCALE: 1" = 10'
DATE: 9/15/2005

DRAWN BY FG
CHECKED BY SC

PLOT DATE = 09/15/05
FILE NAME = #FILE#
REFERENCE = #REF#

F.A. RTE.	SECTION	COUNTY	TOTAL SHEETS	SHEET NO.
DO-00236-00 BR	COOK	18	11	
STA.	TO STA.			
FED. ROAD DIST. NO.	ILLINOIS	FED. AID PROJECT		

CONTRACT NO. 83817

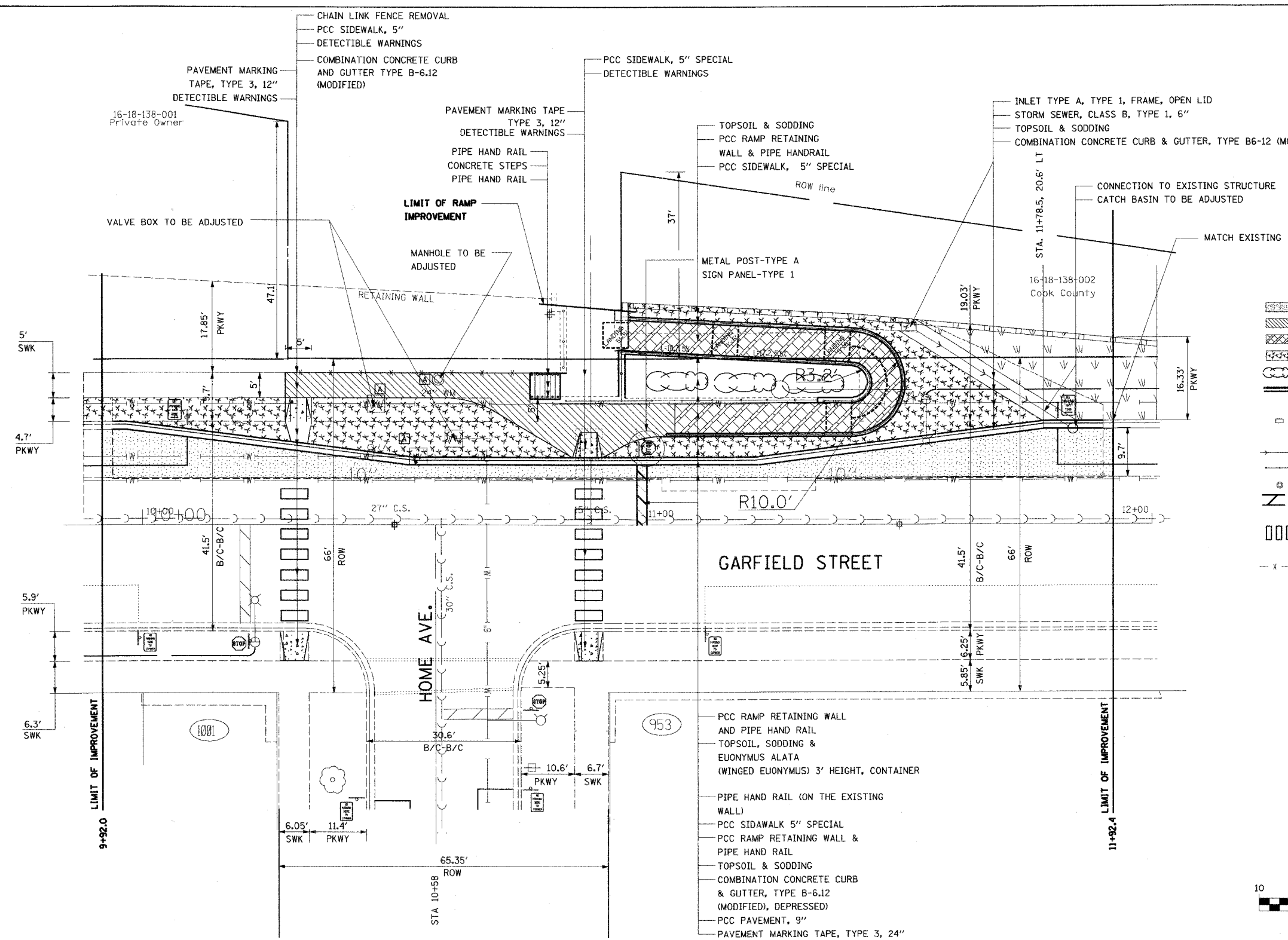

LEGEND

- PCC PAVEMENT, 9"
- PCC SIDEWALK, 5"
- PCC SIDEWALK, 5" SPECIAL
- TOPSOIL AND SODDING
- TOPSOIL, SHRUBS AND SODDING
- COMBINATION CONCRETE CURB AND GUTTER TYPE B6.12 (MODIFIED)
- INLET TYPE A, TYPE 1, FRAME OPEN LID
- OPEN LID
- STORM SEWER, CLASS B, TYPE 1, 6"
- PIPE HAND RAIL
- MANHOLE TO BE ADJUSTED
- PAVEMENT MARKING TAPE, TYPE 3, 24"
- PAVEMENT MARKING TAPE, TYPE 3, 12"
- CHAIN LINK FENCE REMOVAL

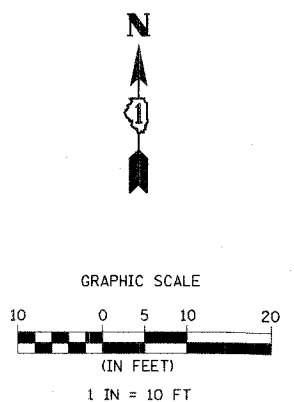

PCC RAMP RETAINING WALL AND PIPE HAND RAIL
 TOPSOIL, SODDING & EUONYMUS ALATA (WINGED EUONYMUS) 3' HEIGHT, CONTAINER

PIPE HAND RAIL (ON THE EXISTING WALL)
 PCC SIDEWALK 5" SPECIAL
 PCC RAMP RETAINING WALL & PIPE HAND RAIL
 TOPSOIL & SODDING
 COMBINATION CONCRETE CURB & GUTTER, TYPE B-6.12 (MODIFIED), DEPRESSED
 PCC PAVEMENT, 9"
 PAVEMENT MARKING TAPE, TYPE 3, 24"

* BENCH MARK: FH @ S.E. CORNER OF GARFIELD ST. AND HOME AVE.
 1ST BOLT POST ARROW HEAD: 41.25

REVISIONS	
NAME	DATE

ILLINOIS DEPARTMENT OF TRANSPORTATION

HOME AVE PEDESTRAIN BRIDGE IMPROVEMENT
 HOME AVE AND GARFIELD AVENUE.
 PROPOSED CONDITIONS



SCALE: 1" = 10'
 DATE: 9/15/2005

DRAWN BY FG
 CHECKED BY SC

PLOT DATE = 08/15/05
 PLOT SCALE = 1" = 10'
 PLOT SCALE = 1" = 10'
 REFERENCE = REF

F.A. RTE.	SECTION	COUNTY	TOTAL SHEETS	SHEET NO.
00-00236-00 BR	COOK	18	13	
STA.	TO STA.			
FED. ROAD DIST. NO. ILLINOIS FED. AID PROJECT				
CONTRACT NO. 83817				

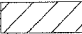

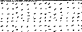
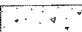
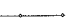
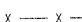



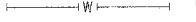

REMOVAL LEGEND

-  SIDEWALK REMOVAL
-  CURB AND GUTTER REMOVAL
-  PAVEMENT REMOVAL
-  REMOVAL OF EXISTING STRUCTURE
-  GUARDRAIL REMOVAL
-  CHAIN LINK FENCE REMOVAL

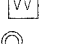
NOTE:
1. ELECTRICAL DETAILS, SEE PROPOSED LIGHTING PLANS 16, 17 AND 18.

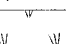
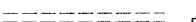
REFER TO ELECTRICAL DRAWINGS

EXISTING LEGEND

-  TREE
-  WATER MAIN
-  R. O. W.
-  VALVE VAULT
-  STRUCTURE
-  COMBINED STORM SEWER
-  EXISTING STOP SIGN
-  LANDSCAPE
-  EX CURB AND GUTTER
-  STREET CENTER LINE
-  BUILDING ADDRESS
-  EXISTING FIRE HYDRANT

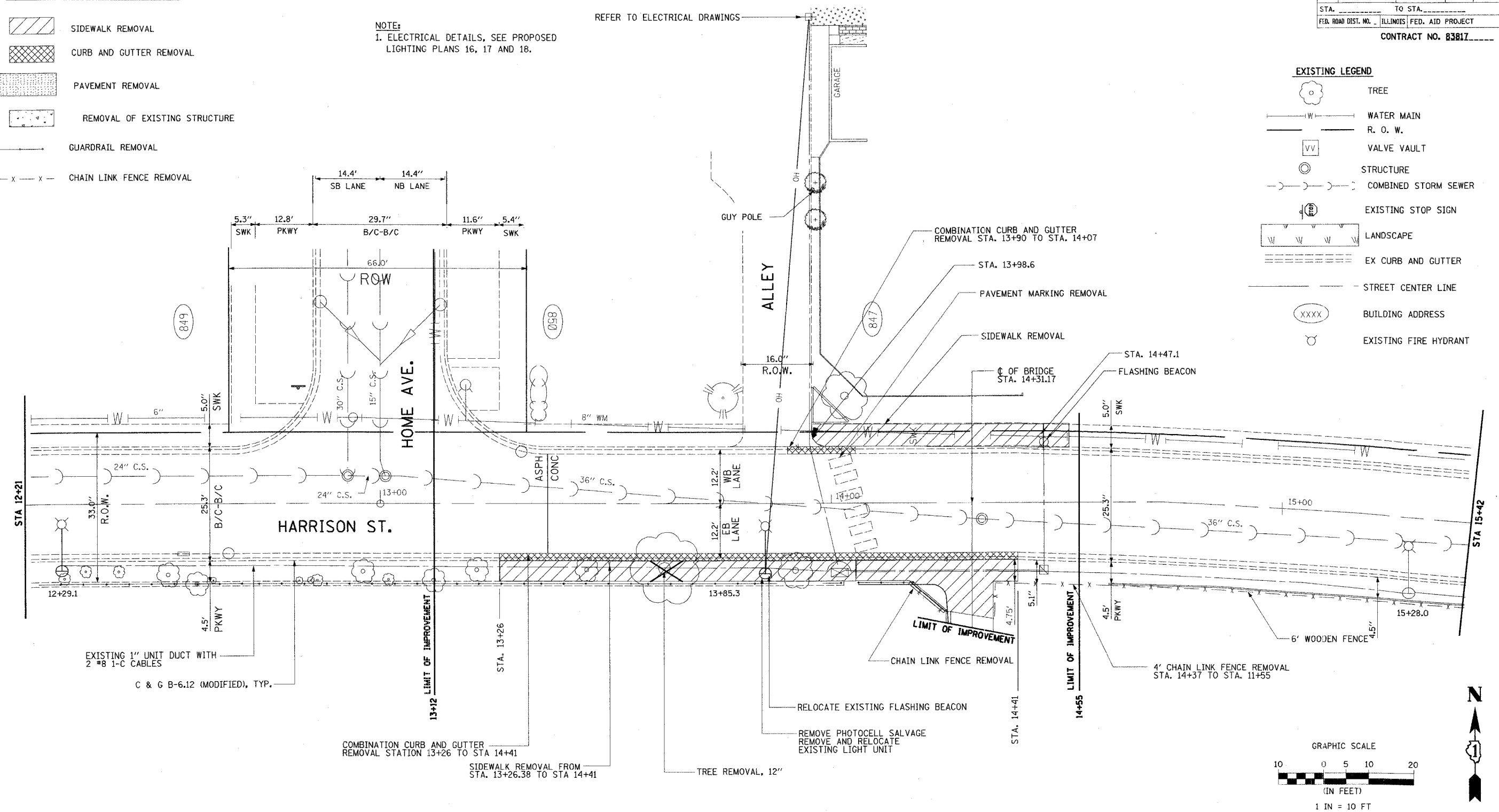







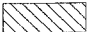

PLOT DATE: # DATE
FILE NAME: # FILE#
PLOT SCALE: # SCALE
REFERENCE: # REF#

REVISIONS	
NAME	DATE

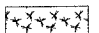
ILLINOIS DEPARTMENT OF TRANSPORTATION
HOME AVE PEDESTRAIN BRIDGE IMPROVEMENT
HOME AVE AND HARRISON STREET
EXISTING CONDITIONS
SCALE: 1" = 10'
DATE: 9/15/2005
DRAWN BY FG
CHECKED BY SC

F.A. RTE.	SECTION	COUNTY	TOTAL SHEETS	SHEET NO.
00-00236-00 BR	COOK		18	14
STA.	TO STA.			
FED. ROAD DIST. NO.	ILLINOIS FED. AID PROJECT			
CONTRACT NO. 83817				

LEGEND

-  PCC PAVEMENT, 9"
-  PCC SIDEWALK, 5"
-  PCC SIDEWALK, 5" SPECIAL
-  TOPSOIL AND SODDING
-  COMBINATION CONCRETE CURB AND GUTTER TYPE B6.12 (MODIFIED)
-  PIPE HAND RAIL
-  DETECTIBLE WARNINGS
-  PAVEMENT MARKING TAPE, TYPE 3, 24"
-  PAVEMENT MARKING TAPE, TYPE 3, 12"
-  CHAIN LINK FENCE REMOVAL

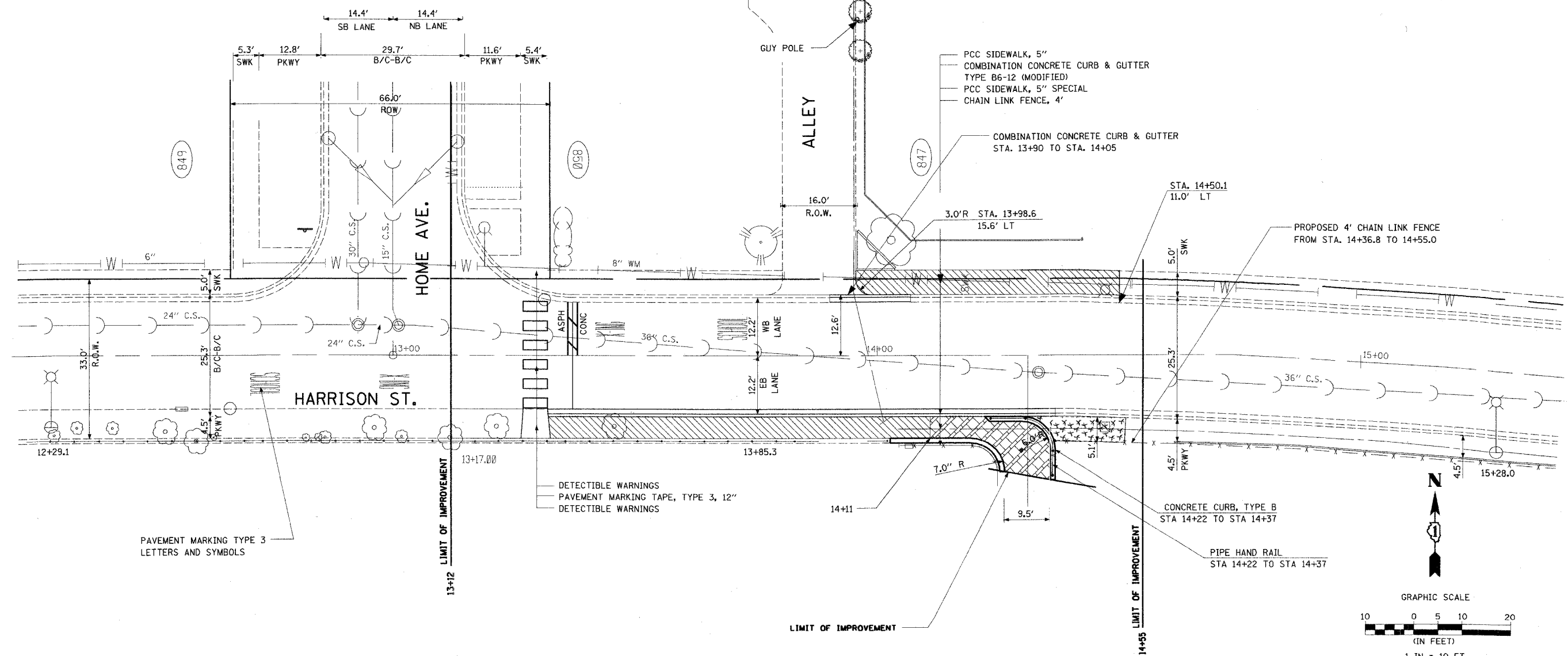

PAVEMENT MARKING TYPE 3 LETTERS AND SYMBOLS

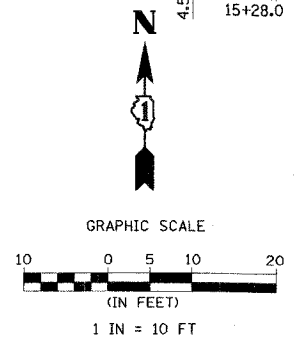

BENCH MARK: FH @ N.E. CORNER OF HARRISON ST. AND HOME AVE. NW BOLT TAGGED: 40.78

REVISIONS	
NAME	DATE

ILLINOIS DEPARTMENT OF TRANSPORTATION
HOME AVE PEDESTRAIN BRIDGE IMPROVEMENT
HOME AVE AND HARRISON STREET
PROPOSED CONDITIONS
SCALE: 1" = 10'
DATE: 9/15/2005
DRAWN BY FG
CHECKED BY SC

PLANT DATE = 08/05
FILE NAME = 811E1
PLOT SCALE = 8SCALE
REFERENCE = 8REF

F.A. RTE.	SECTION	COUNTY	TOTAL SHEETS	SHEET NO.
	01-00236-00 BR	COOK	18	14A
STA.	TO STA.			
FED. ROAD DIST. NO.	ILLINOIS	FED. AID PROJECT		
CONTRACT NO. 82817				

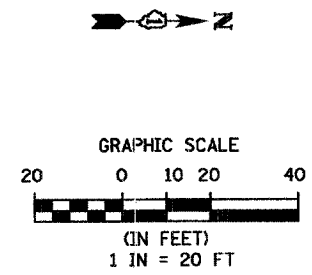
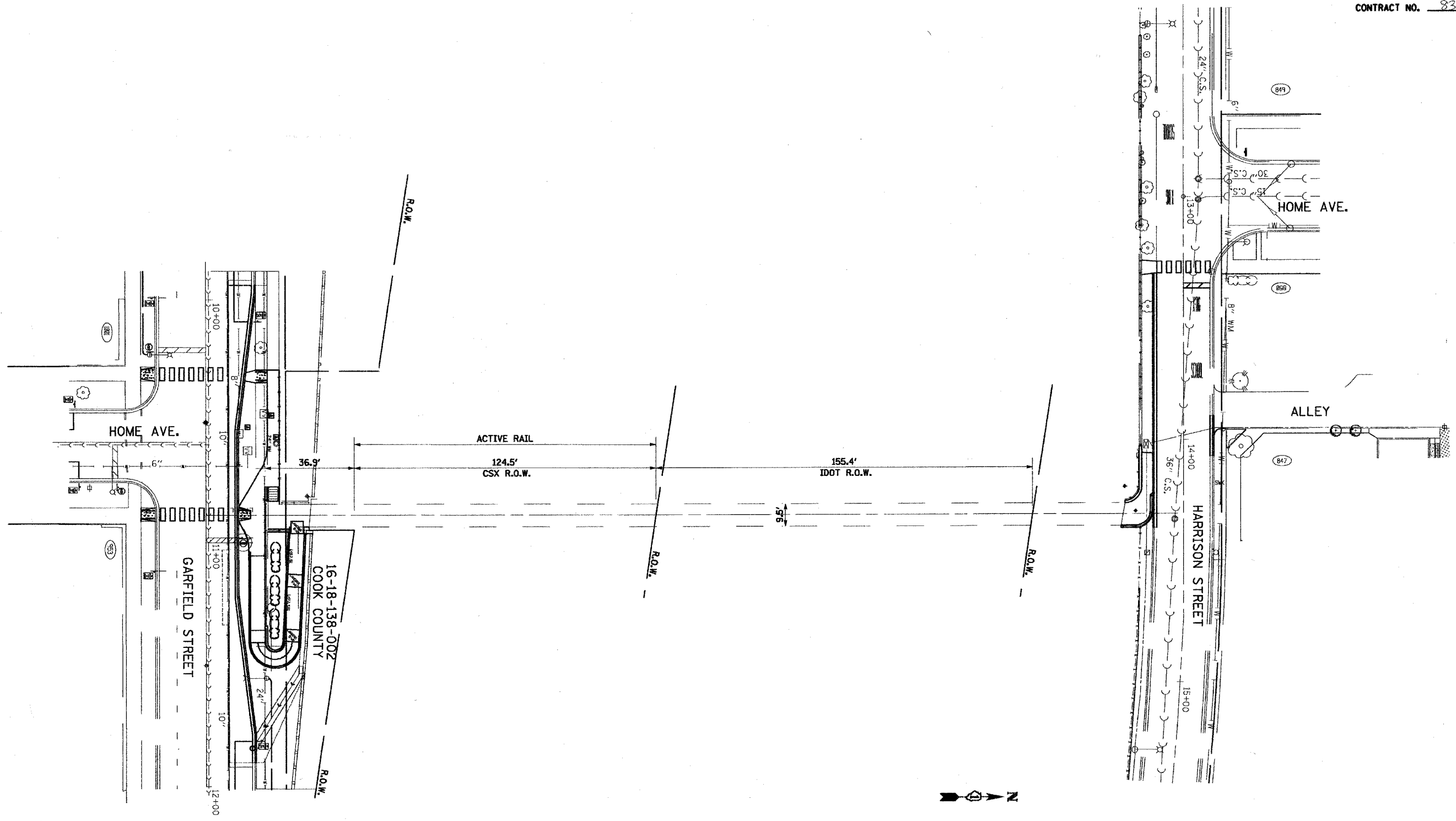

REVISIONS	
NAME	DATE

ILLINOIS DEPARTMENT OF TRANSPORTATION
 HOME AVE. PEDESTRAIN BRIDGE IMPROVEMENTS
 R.O.W. PLAN
 SCALE: 1"=40'
 DATE: 11/23/2005
 DRAWN BY: CC
 CHECKED BY: SC

F.A. RTE.	SECTION	COUNTY	TOTAL SHEETS	SHEET NO.
01-00236-00-BR	COOK	18	15	
STA. 01-00236-00-BR		TO STA. _____		
FED. ROAD DIST. NO. ILLINOIS FED. AID PROJECT				

CONTRACT 83817

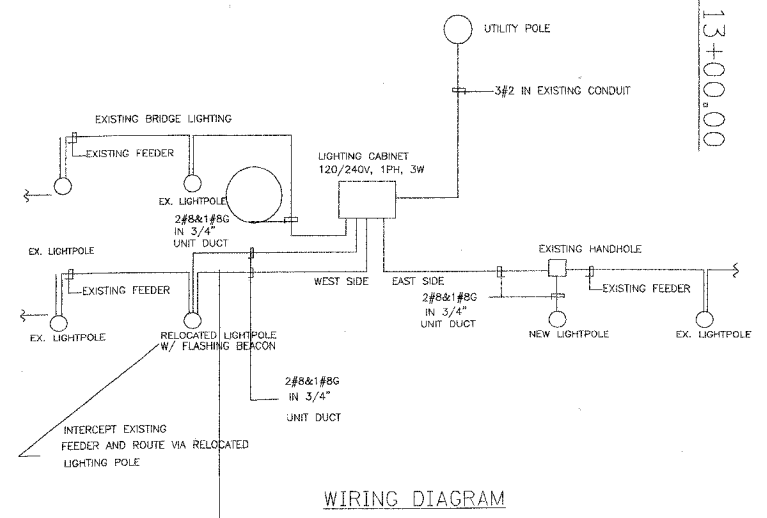
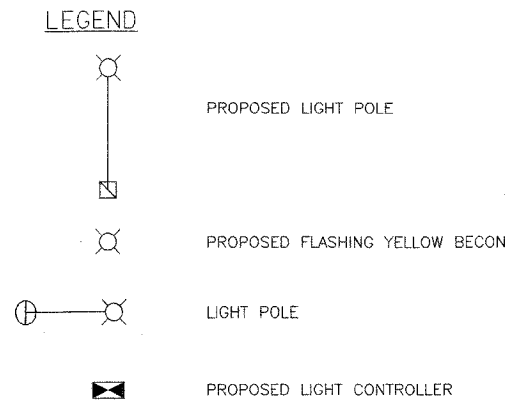
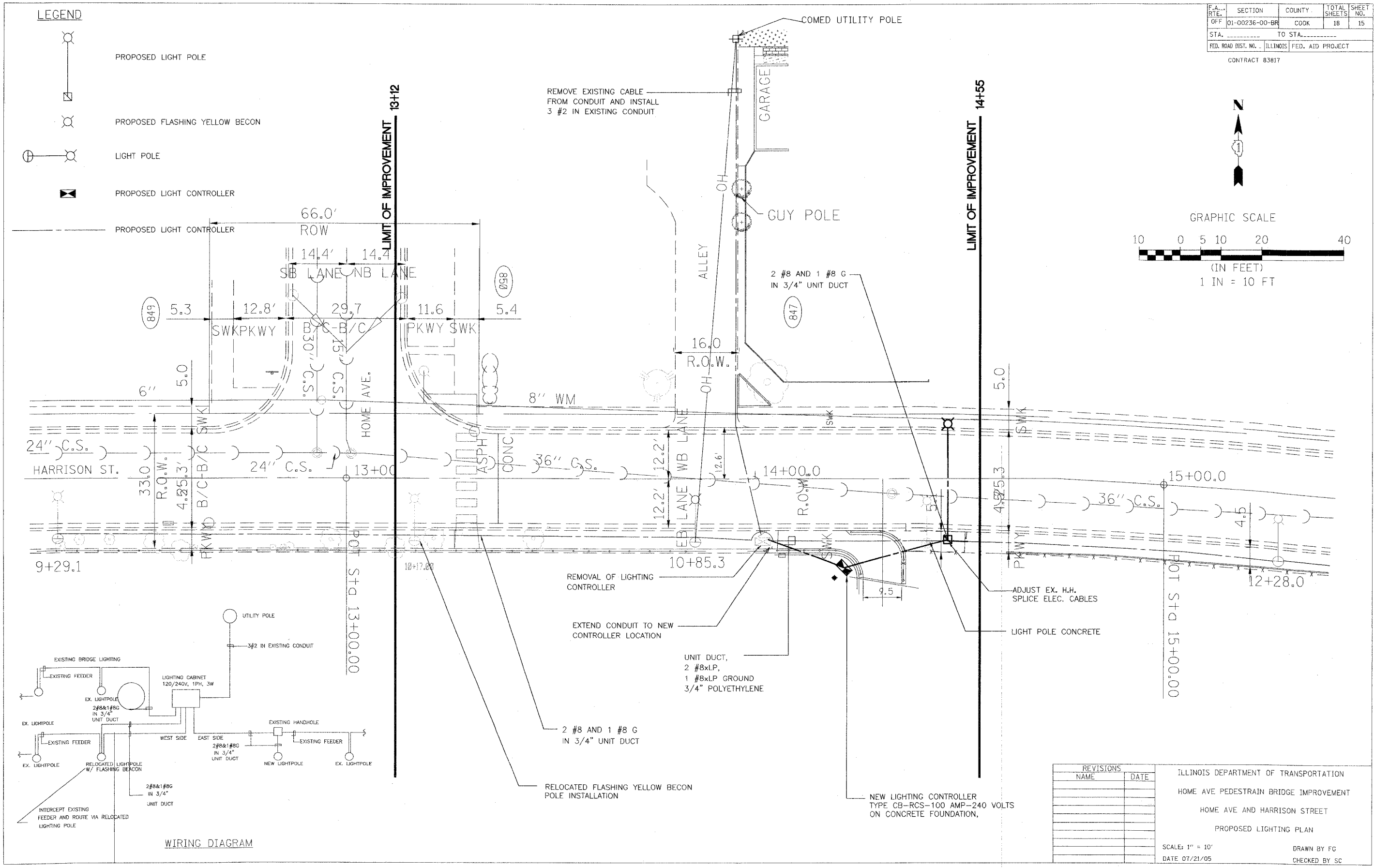
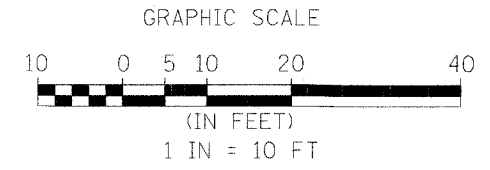
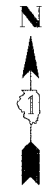

REVISIONS	
NAME	DATE

ILLINOIS DEPARTMENT OF TRANSPORTATION
 HOME AVE PEDESTRAIN BRIDGE IMPROVEMENT
 HOME AVE AND HARRISON STREET
 PROPOSED LIGHTING PLAN

SCALE: 1" = 10'
 DATE 07/21/05

DRAWN BY FG
 CHECKED BY SC

F.A. OFF	SECTION	COUNTY	TOTAL SHEETS	SHEET NO.
01-00236-00-BR	COOK	18	16	
STA.	TO STA.			
FED. ROAD DIST. NO.	ILLINOIS	FED. AID PROJECT		

CONTRACT 83817

CABINET/LOCATION	VOLTAGE	BRANCH BREAKER	CONTROLLED BY
C1	120/240V, 1PH, 3W	(2) 30A/2P LIGHTING (E&W) 240V	TORK 1100 SERIES
		(1) 20A/1P OUTLETS 120V	ON ALWAYS
		(1) 20A/1P FLASHING BEACON	ON ALWAYS
		(1) 30A/2P LIGHTING BRIDGE 240V	TORK 1100 SERIES

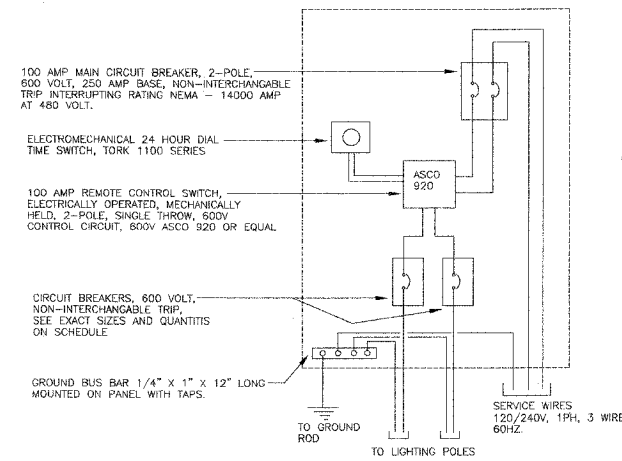

2 CONTROLLER WIRING DIAGRAM
N.T.S.

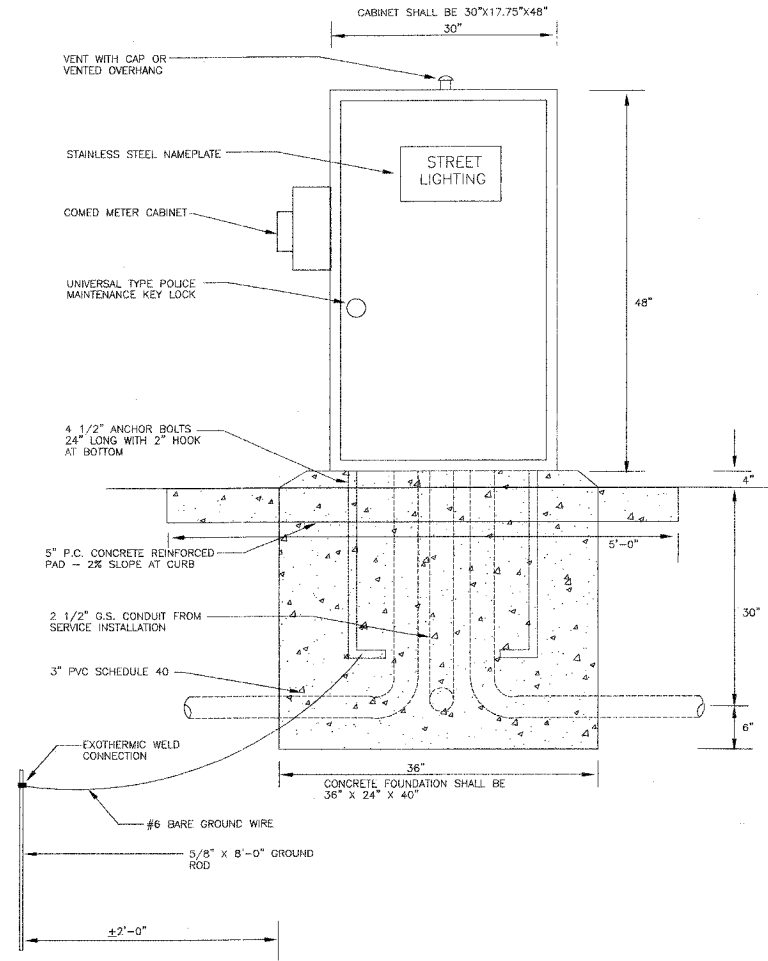

1 STREET LIGHTING CONTROL CABINET
N.T.S.

PLOT DATE = #DATE
PLOT SCALE = #SCALE
REFERENCE = #REF

REVISIONS		ILLINOIS DEPARTMENT OF TRANSPORTATION HOME AVE PEDESTRAIN BRIDGE IMPROVEMENT HOME AVE AND HARRISON STREET PROPOSED LIGHTING PLAN
NAME	DATE	

SCALE: VERT. DRAWN BY FG
 HORIZ. CHECKED BY SC
DATE 07/21/05

F.A. RTE.	SECTION	COUNTY	TOTAL SHEETS	SHEET NO.
01-00836-00 BR	COOK		18	17
STA.	TO STA.			
FED. ROAD DIST. NO.	ILLINOIS	FED. AID PROJECT		
CONTRACT NO. 83817				

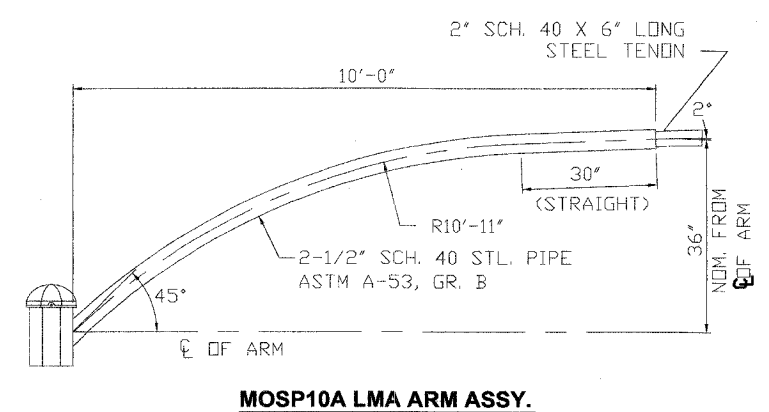
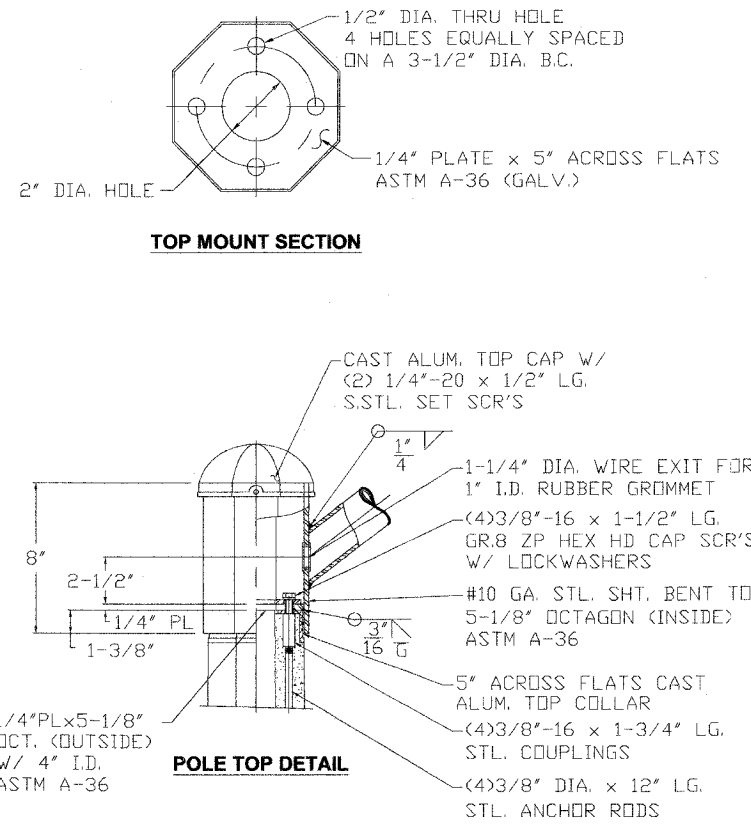
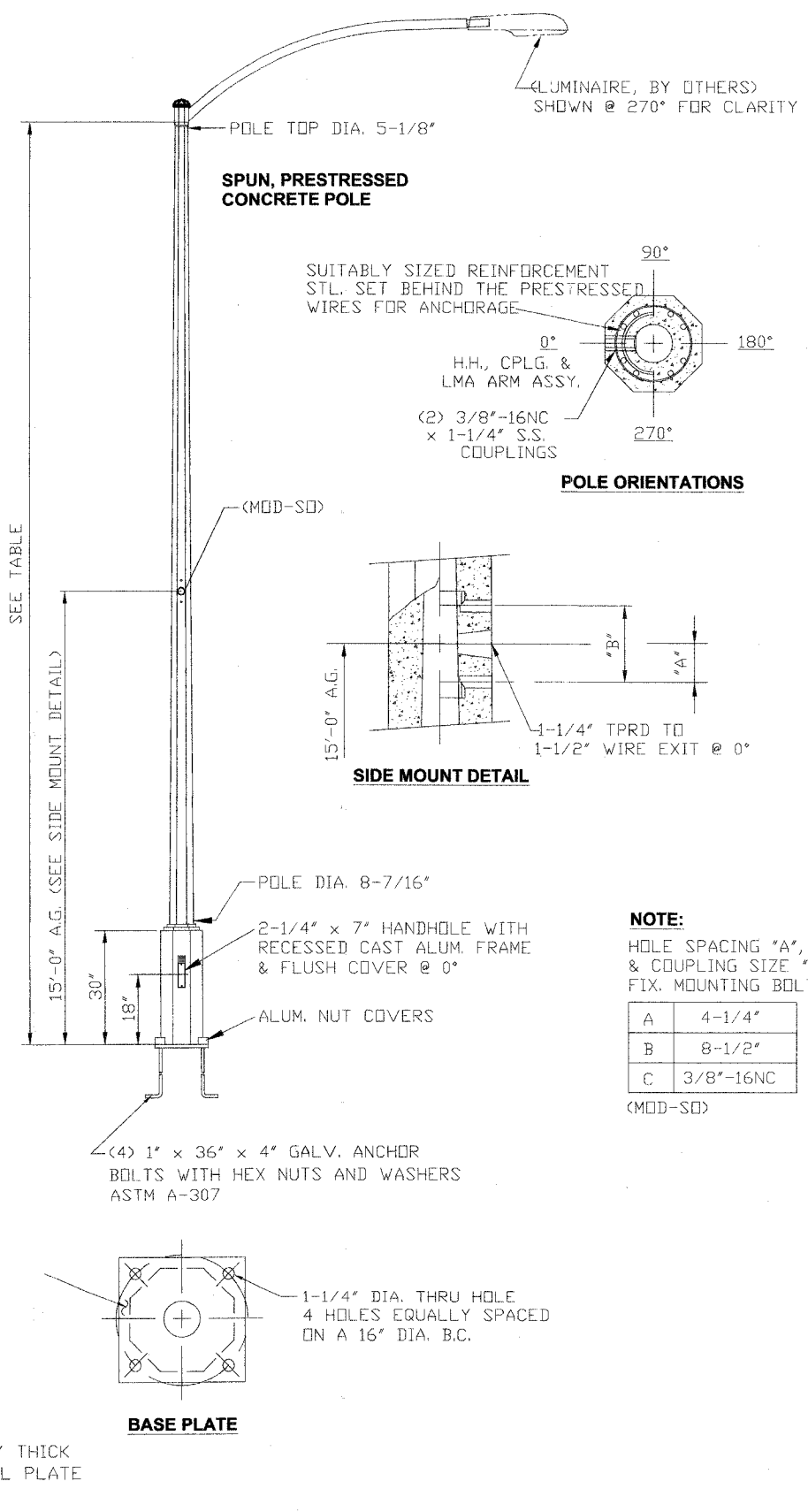

MBI- MEDIUM BASEPLATE OCTAGONAL POLE

POLE DESIGNATION	POLE HEIGHT ABOVE GROUND	BUTT DIA.	BOLT CIRCLE	ULTIMATE G.L. MOMENT (ft.-lbs.)	WEIGHT (lbs.)
MBI-9	30'-6"	12-3/16"	16"	22,540	1,200

(6) POLES REQ'D. W/MOSP10A LMA ASSY. @ 0°.

- NOTES:**
- MIX (114S): GRAY, NATURAL, LIGHTLY POLISHED AGGREGATE FINISH WITH FLAT WATER SEALER.
 - ASTM C-150 TYPE III GRAY CEMENT.
 - f'c @ 28 DAYS=7,000 PSI, USING SPUN CYLINDER TEST.
 - f'c @ 28 DAYS=5,000 PSI, USING ASTM C-31 CYLINDER TEST.
 - POLES MANUFACTURED TO ASTM C-1089-97 SPECIFICATIONS.
 - PROTECTIVE COAT EXPOSED P.C. WIRES AT POLE ENDS.
 - MOD SD: SNGL 3/8" 1X2 @ 0° WITH WIRE EXIT.

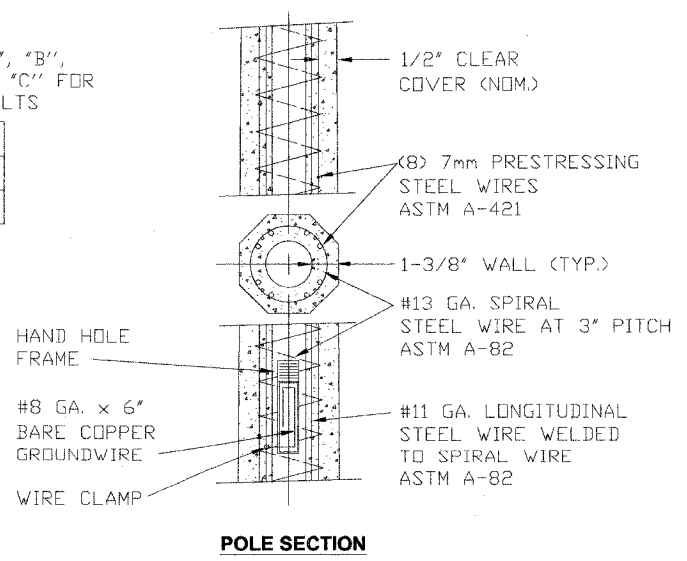

REVISIONS	
NAME	DATE

ILLINOIS DEPARTMENT OF TRANSPORTATION

CITY OF OAK-PARK, IL

CONCRETE LIGHT POLE DETAILS

SCALE: AS SHOWN

DATE: 07/21/05

DRAWN BY: T.J.

CHECKED BY: S.C.

PLOT DATE = 07/21/05
FILE NAME = BRIDGE RENOVATION
PLOT SCALE = AS SHOWN

F.A. SHEETS	SECTION	COUNTY	TOTAL SHEETS	SHEET NO.
DO-00236-00 BR	COOK	18	18	
STA.	TO STA.			
FED. ROAD DIST. NO.	ILLINOIS FED. AID PROJECT			
CONTRACT NO. 83817				

NOTE:
 MINIMUM SOIL BEARING CAPACITY = 2,500 PSF
 F'c = 4,000 PSI
 Fa = 60,000 PSI
 e = 3"

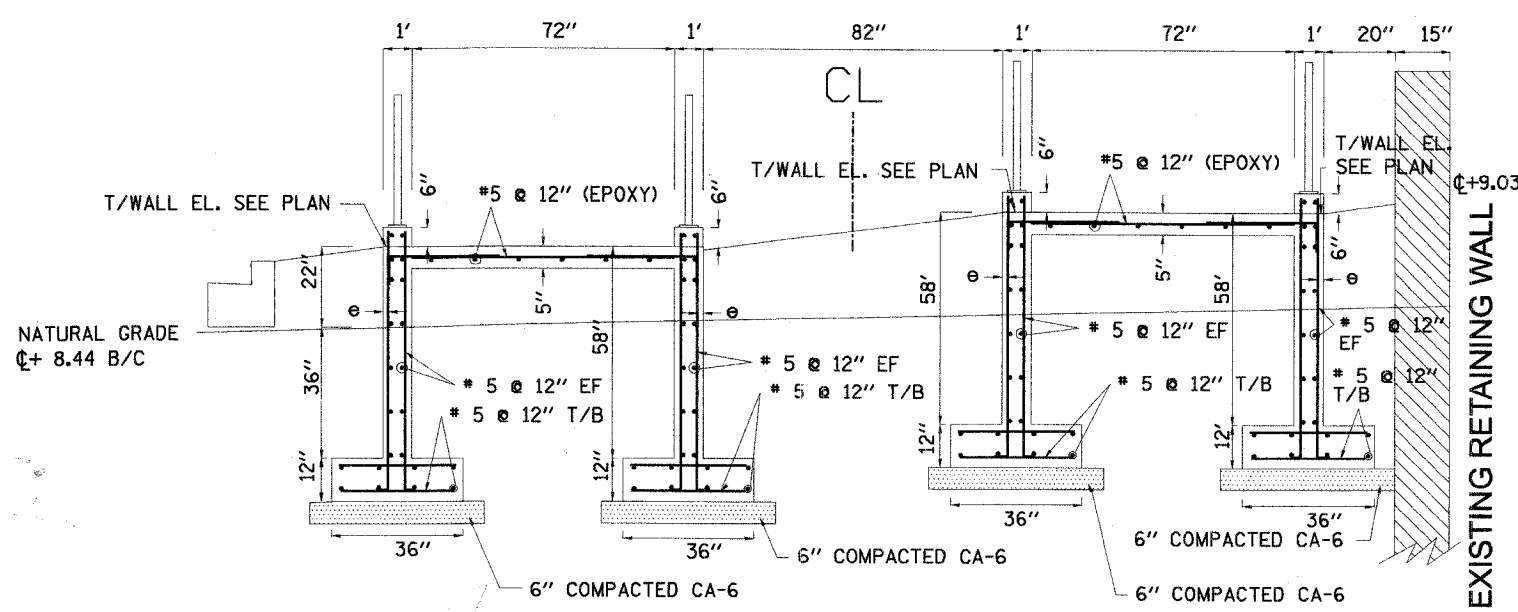

① SECTION A-A
N.T.S.

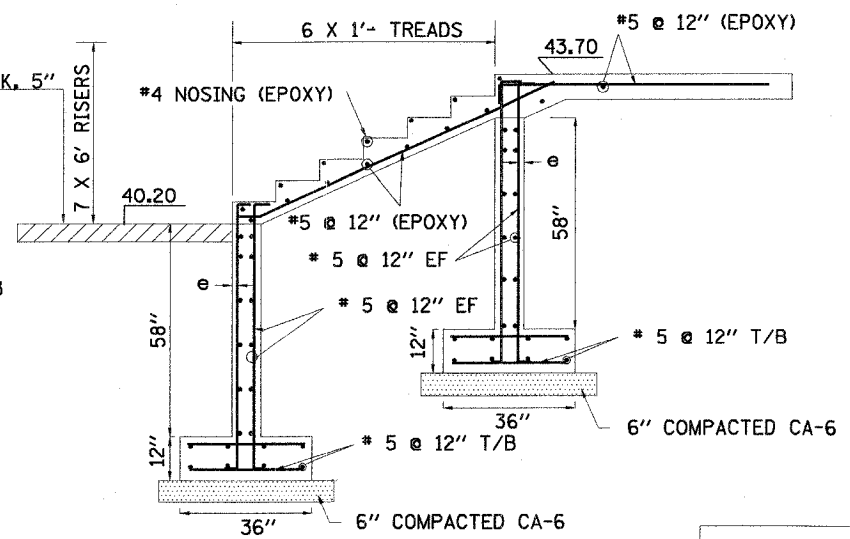

③ SECTION C-C
N.T.S.

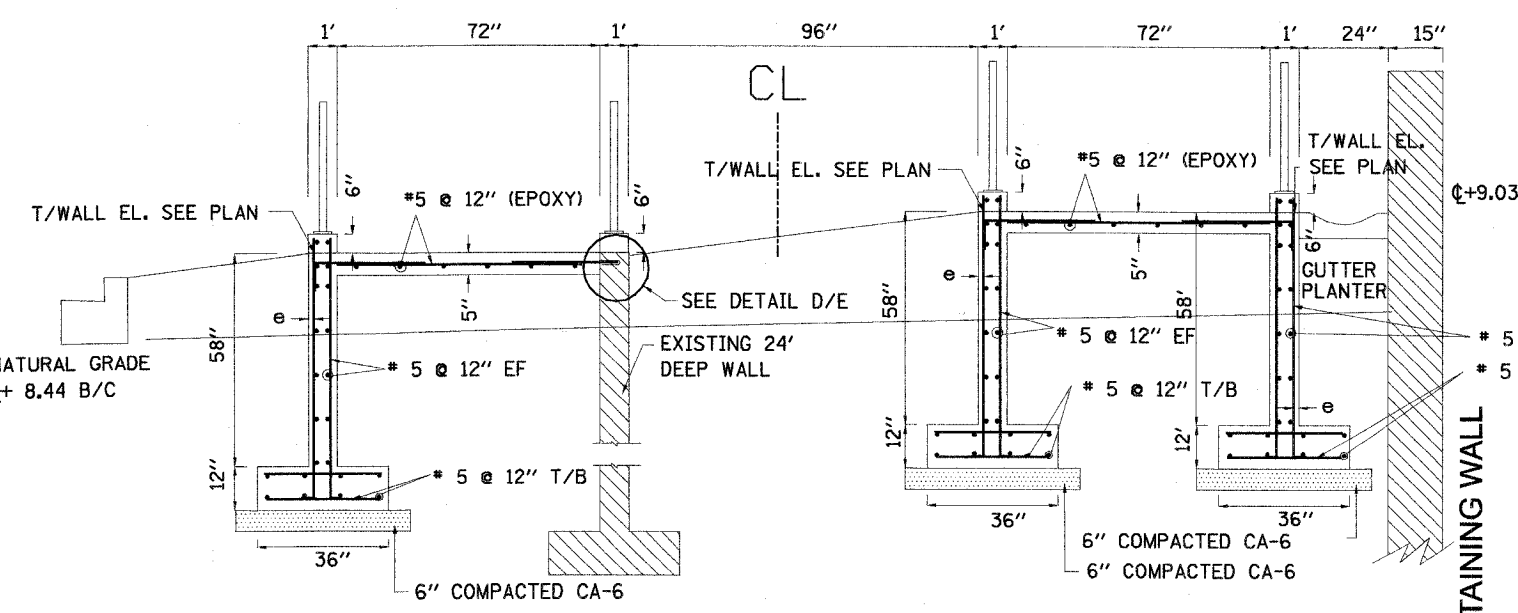

② SECTION B-B
N.T.S.

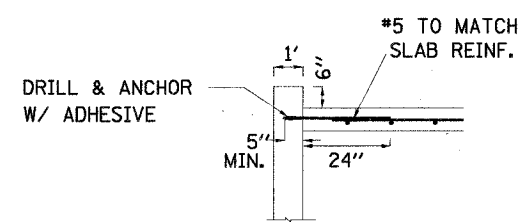

④ DETAIL-D
N.T.S.

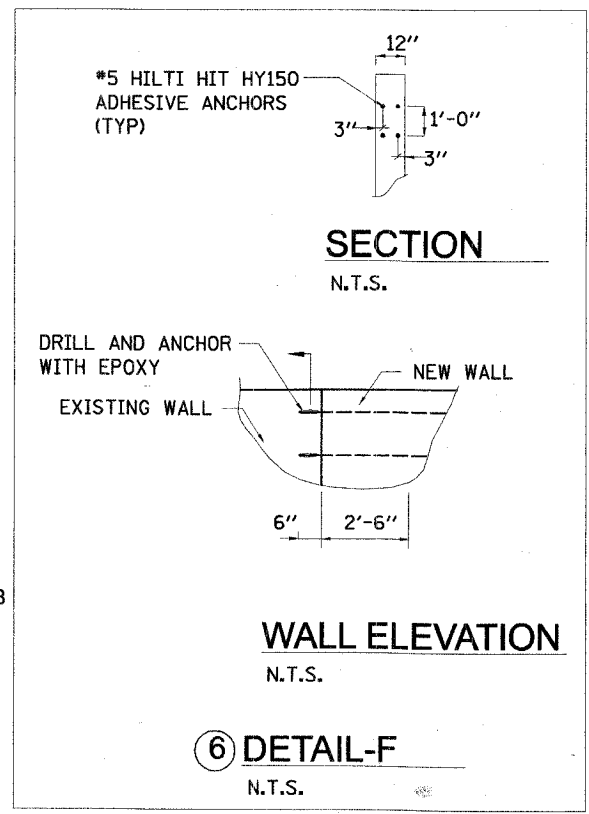

⑥ DETAIL-F
N.T.S.

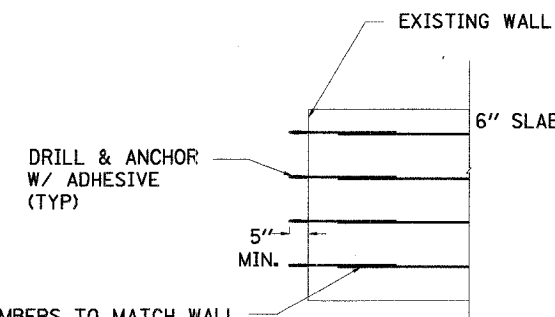

⑤ DETAIL-E
N.T.S.

NUMBERS TO MATCH WALL REINF. (TYP) @ CENTER OF NEW WALL (1 TOTAL)



REVISIONS	
NAME	DATE

ILLINOIS DEPARTMENT OF TRANSPORTATION
 RAMP AND STAIRS
 REINFORCEMENT DETAILS

SCALE: NOT TO SCALE
 DATE: 9/15/2005
 DRAWN BY FG
 CHECKED BY SC

PLT DATE = 09/15/05
 FILE NAME = #RAMP
 PLOT SCALE = AS SHOWN
 REFERENCE = #REF#

NOTE: SEE SHEET NUMBER 14 FOR SECTIONS AND DETAILS