

F.A. RTE.	SECTION	COUNTY	TOTAL SHEET SHEETS	NO.
-	05-00052-00-R5	DUPAGE	20	14
STA. 300+00	TO STA. 327+29.80			
FED. ROAD DIST. NO.	ILLINOIS	FED. AID PROJECT		
CONTRACT NO. 88821				

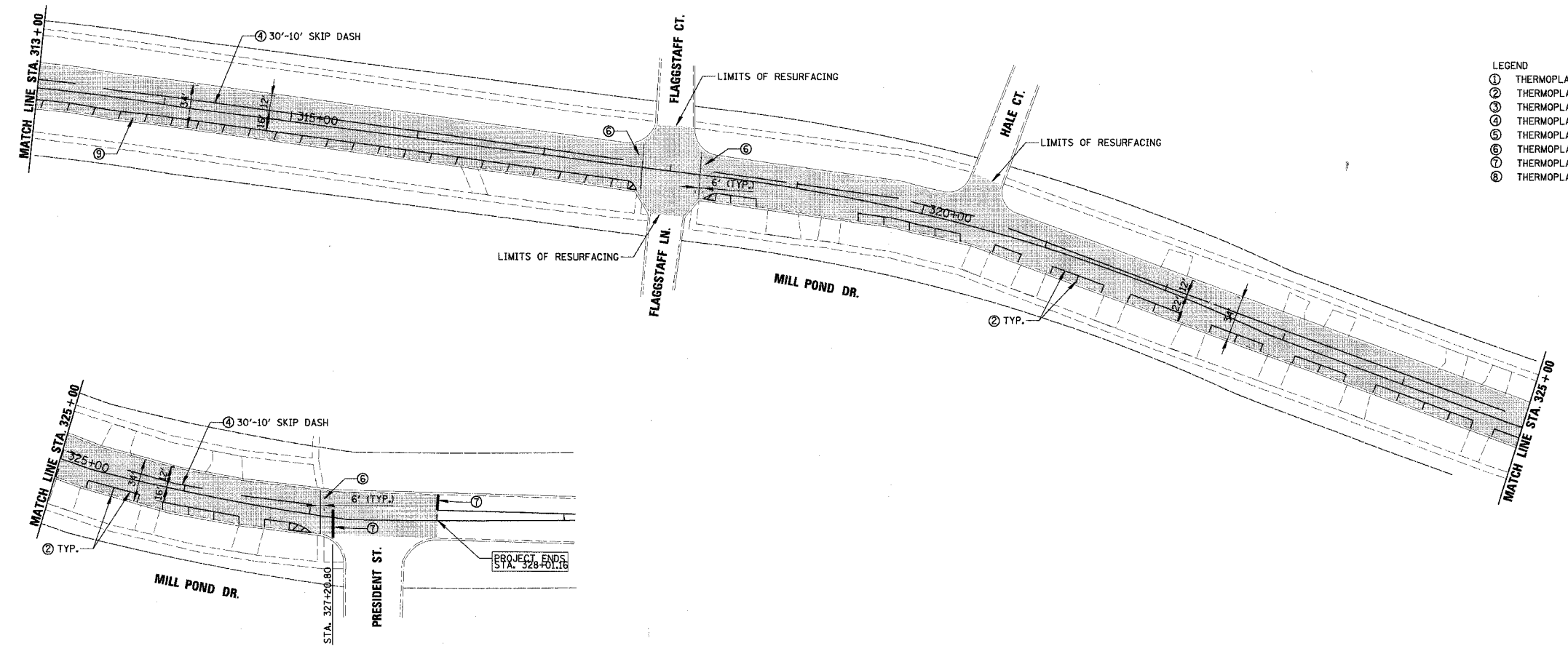
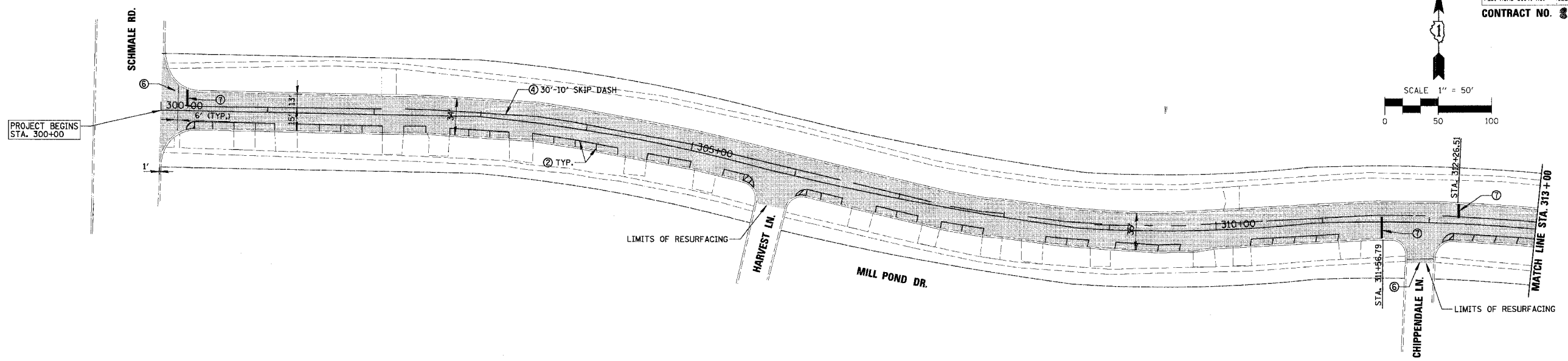
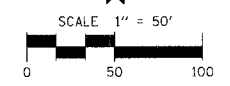

- LEGEND
- ① THERMOPLASTIC PAVEMENT MARKING - LETTERS AND SYMBOLS
 - ② THERMOPLASTIC PAVEMENT MARKINGS - LINE 4" (WHITE)
 - ③ THERMOPLASTIC PAVEMENT MARKINGS - LINE 6" (WHITE)
 - ④ THERMOPLASTIC PAVEMENT MARKINGS - LINE 4" (YELLOW)
 - ⑤ THERMOPLASTIC PAVEMENT MARKINGS - LINE 8" (WHITE)
 - ⑥ THERMOPLASTIC PAVEMENT MARKINGS - LINE 12" (WHITE)
 - ⑦ THERMOPLASTIC PAVEMENT MARKINGS - LINE 24" (WHITE)
 - ⑧ THERMOPLASTIC PAVEMENT MARKINGS - LINE 12" (YELLOW)

- LEGEND
- POLYMERIZED LEVELING BINDER (MACHINE METHOD), SUPERPAVE, IL-4.75, N50 - 3/4"
 - BITUMINOUS CONCRETE SURFACE COURSE, SUPERPAVE, MIX "C", N50 - 2 1/2"

REVISIONS	
NAME	DATE

ILLINOIS DEPARTMENT OF TRANSPORTATION
MILL POND DRIVE
PROPOSED PLAN

SCALE 1"=50'
DATE 10/21/2005

DRAWN BY MYG
CHECKED BY LMF