

NOTE:  
SEE SHEET NO. 11  
FOR PRAIRIE AVENUE  
IMPROVEMENTS

**EXISTING TOPOGRAPHY**

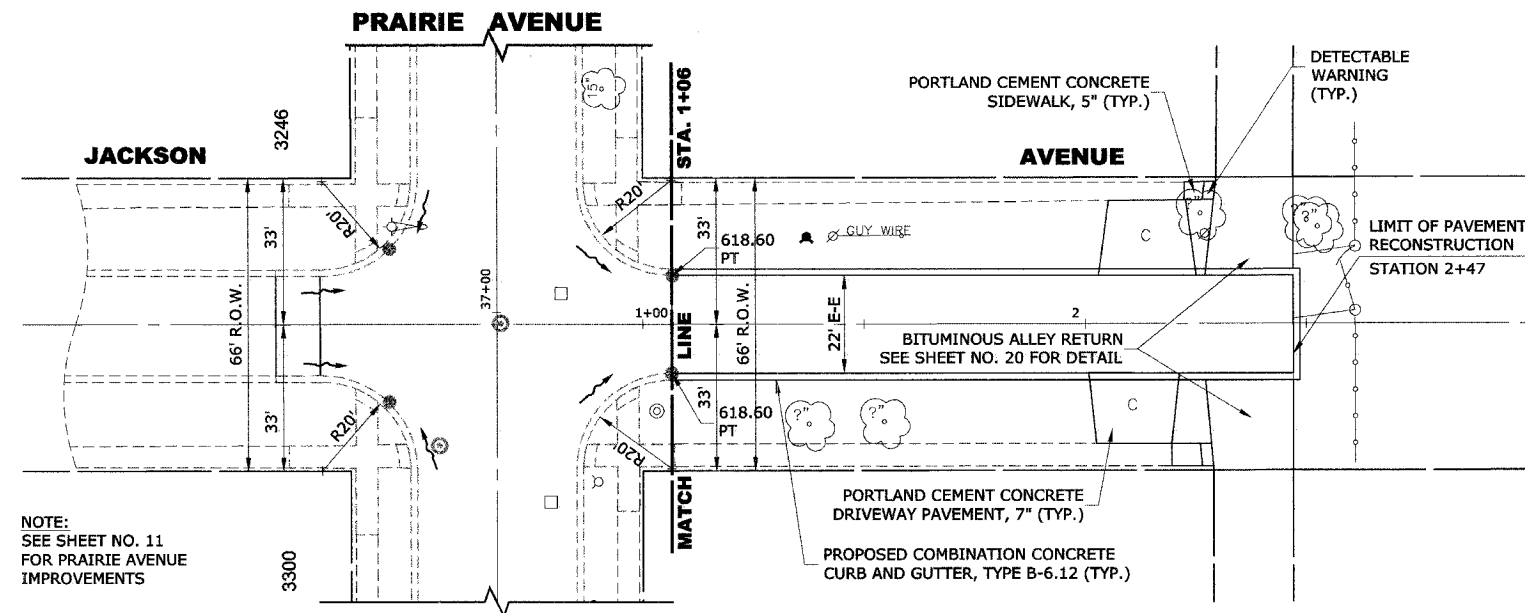

NOTE:  
SEE SHEET NO. 11  
FOR PRAIRIE AVENUE  
IMPROVEMENTS

**PROPOSED IMPROVEMENTS**

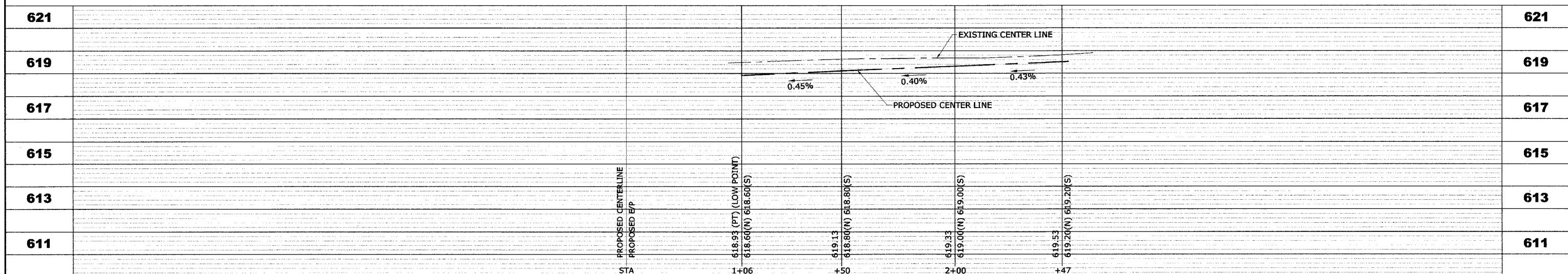

◆ Civil Engineers  
◆ Municipal Consultants  
◆ Established 1911

9933 Roosevelt Road  
Westchester, Illinois 60154-2780  
Phone: 708/865-8300  
Fax: 708/865-1212

**PRAIRIE AVENUE IMPROVEMENTS  
PHASE I  
VILLAGE OF BROOKFIELD, ILLINOIS**

**EXISTING AND PROPOSED  
PAVING PLAN AND PROFILE**

SCALE: H: 1"=20', V: 1"=2'	SHEET <b>18</b> / 49
DRAWN BY: MK/LEV	
BOOK NO.: #1475, #1504	
DATE: 11-04-05	
REVISION:	E.H.E. NO.: 125-04-26301