

TREE REPLACEMENT			
COMMON NAME	SCIENTIFIC NAME	SIZE	QUANTITY*
EMERALD QUEEN NORWAY MAPLE	ACER PLATANOIDES EMERALD QUEEN	3" CALIPER	10
RED MAPLE	ACER RUBRUM	3" CALIPER	9
SWAMP WHITE OAK	QUECUS BICOLOR	2 1/2" CALIPER	10
ARISTOCRAT CALLERY PEAR	PYRUS CALLERYANA ARISTOCRAT	2 1/2" CALIPER TREE FORM	9

* TYPE OF TREE TO BE PLACED AT EACH LOCATION TO BE DETERMINED IN THE FIELD BY THE ENGINEER
 NOTE: ALL TREES BALLED AND BURLAPPED

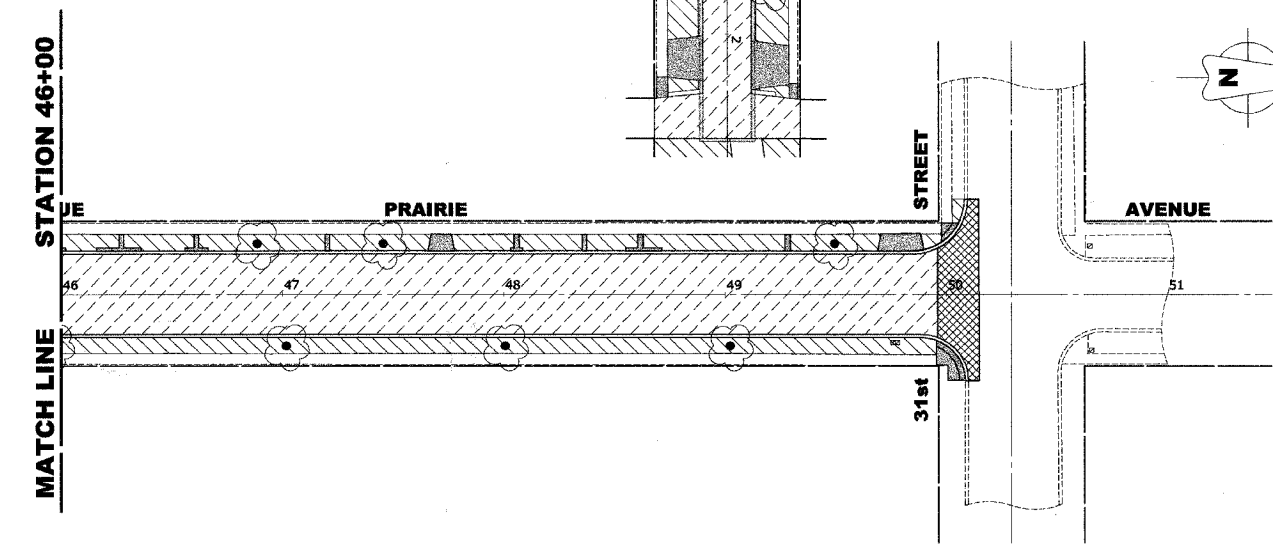
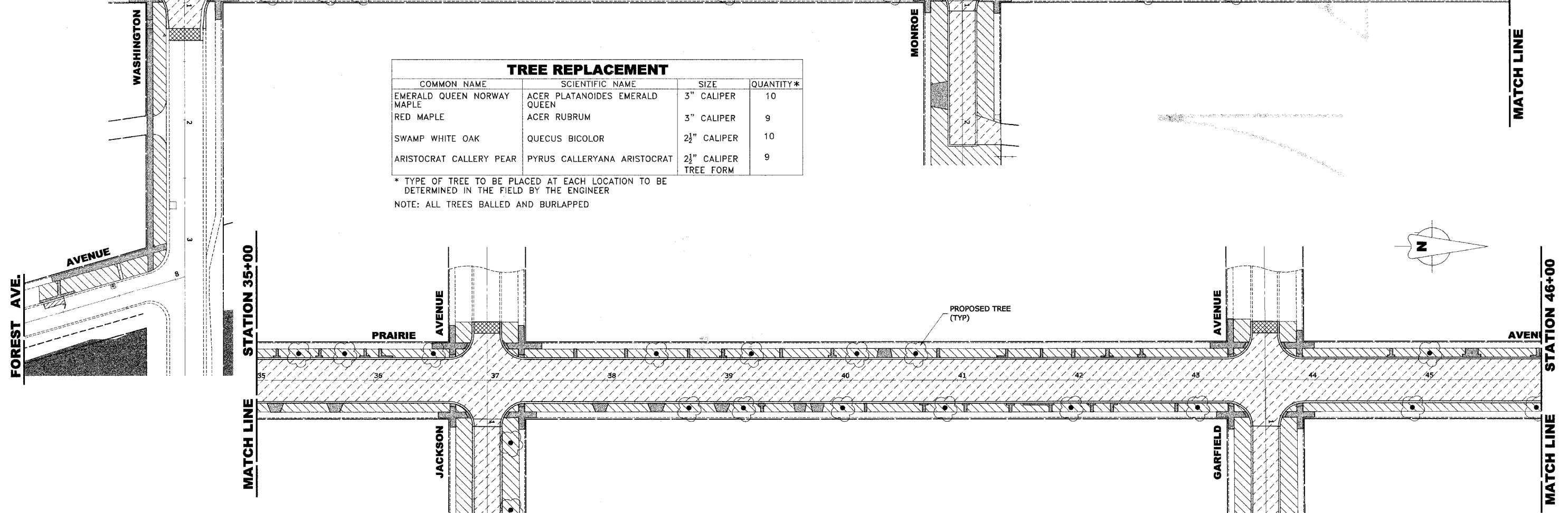

LANDSCAPING NOTES

SODDING:
 ALL DISTURBED AREAS INDICATED ON CROSS SECTION OR LANDSCAPING PLANS TO BE SODDED, INCLUDING FERTILIZER NUTRIENTS* AND SUPPLEMENTAL WATERING WHICH IS TO BE USED AFTER THE INITIAL WATERING (AS SPECIFIED AND AS DIRECTED BY THE ENGINEER) AT THE RATE OF 10 GALLONS PER SQUARE YARD SODDING. SODDED SLOPES WHICH ARE 2:1 OR STEEPER SHALL BE STAKED. (PROVIDE A 3" STRIP AROUND CATCH BASINS IN SEEDED AREAS).

FERTILIZER NUTRIENTS* FOR SODDING:
 USE A FERTILIZER WITH A 1:1:1 RATIO PER ACRE:
 60 LBS. NITROGEN FERTILIZER NUTRIENT
 60 LBS. PHOSPHORUS FERTILIZER NUTRIENT
 60 LBS. POTASSIUM FERTILIZER NUTRIENT
 TOTAL: 180 LBS. PER ACRE

TREE REPLACEMENT:
 TREE TYPE & LOCATION TO BE DETERMINED IN THE FIELD BY THE ENGINEER.

4" TOP SOIL LAYER:
 SOIL SHALL BE SPREAD AS INDICATED ON THE TYPICAL CROSS SECTIONS.
 A MINIMUM OF GRADING TO BE PERMITTED WITHIN AN APPROXIMATE RADIUS OF 6' FROM ALL TREES TO BE SAVED AS DETERMINED BY THE ENGINEER.

LEGEND OF SYMBOLS

SYMBOL	DESCRIPTION
	PROPOSED CONCRETE AREA
	PROPOSED BITUMINOUS CONCRETE AREA
	PROPOSED SODDED PARKWAY
	PROPOSED BUTT JOINT AREA
	PROPOSED TREE