

F.A.U. RTE.	SECTION	COUNTY	TOTAL SHEETS	SHEET NO.
807	00-00374-00-PV	CHAMPAIGN	149	95
STA.	TO STA.			
FED. ROAD DIST. NO. 7		ILLINOIS	F.A. PROJECT M-5181(38)	

CONTRACT NO. 91308

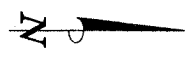

115+50 | 116+00 | 116+50

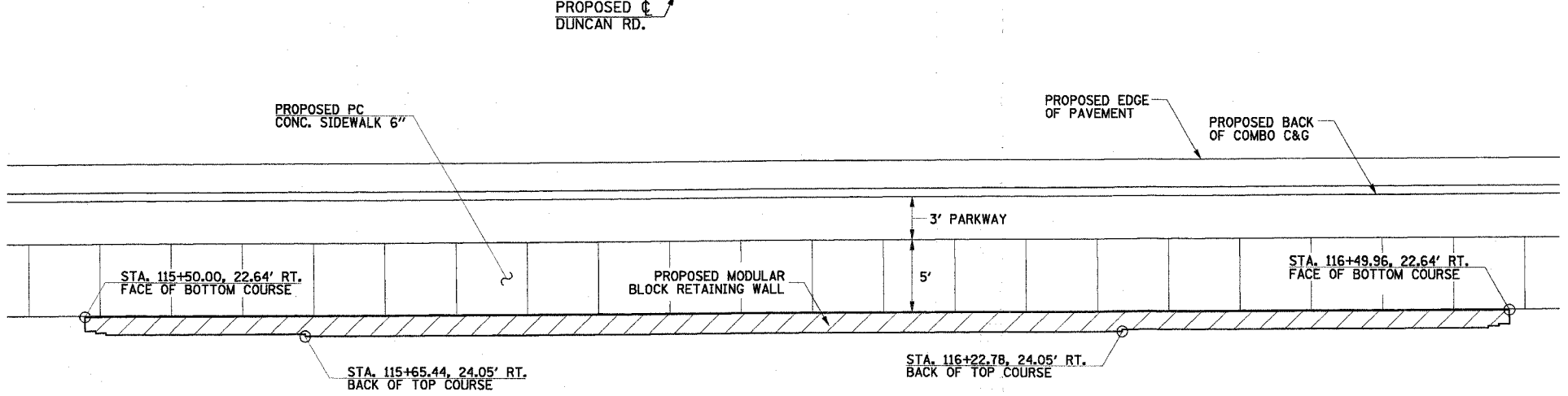

**PLAN**  
SCALE: 1" = 20'

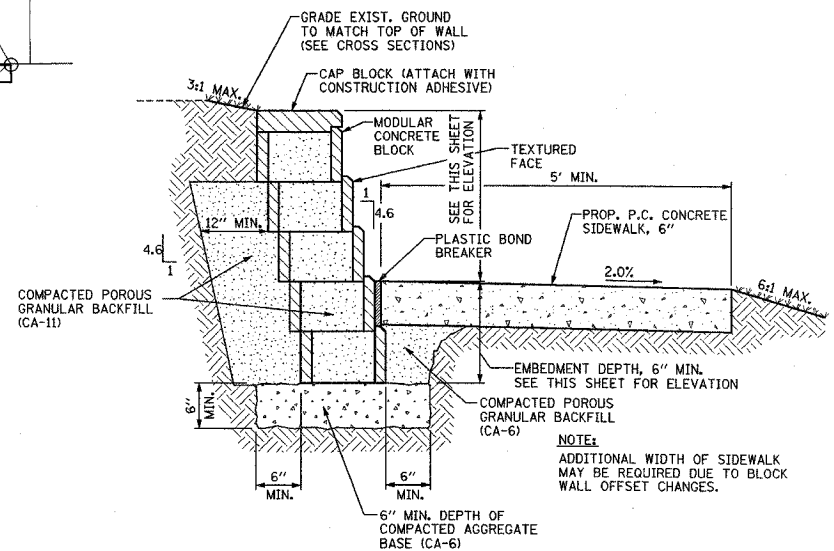

**MODULAR BLOCK RETAINING WALL DETAIL**  
NO SCALE

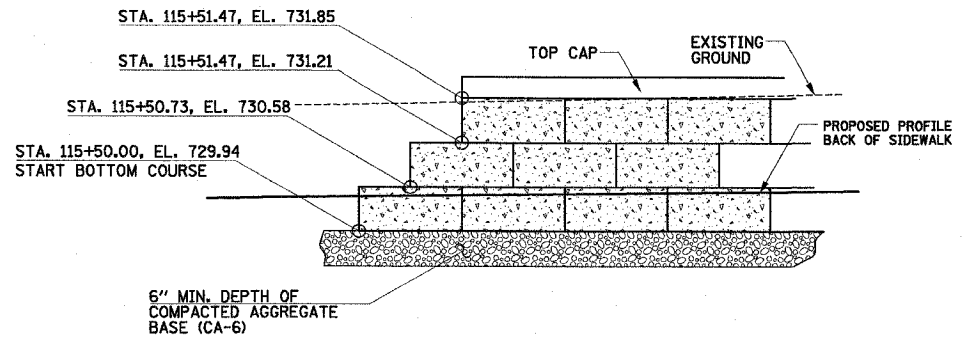

**END DETAIL A**  
NO SCALE

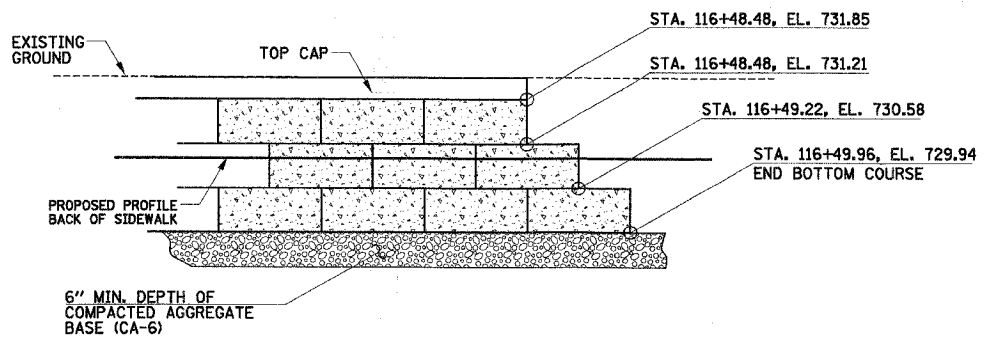

**END DETAIL B**  
NO SCALE

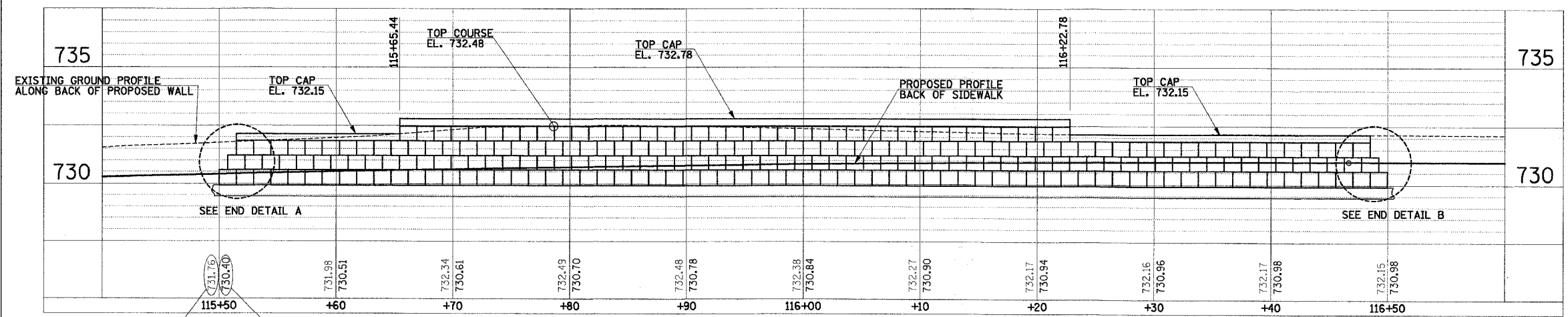

**ELEVATION**

SCALE:  
HORIZ. 1" = 20'  
VERT. 1" = 5'

- NOTES:**
- THE STATIONS, OFFSETS AND ELEVATIONS AS SHOWN IN THE DETAIL ARE BASED ON BLOCKS WITH THE FOLLOWING DIMENSIONS:  
STANDARD BLOCK:  
FRONT FACE WIDTH 17-5/8"  
BACK FACE HEIGHT 7-5/8"  
FRONT TO BACK DEPTH 12"  
SET BACK: 1-5/8" PER BLOCK  
(12" WALL BATTER FROM VERTICAL)  
THE ACTUAL STATIONS, OFFSETS AND ELEVATIONS MAY VARY FROM THE DETAIL AT THE APPROVAL OF THE ENGINEER.
  - EXCAVATION, BACKFILL, COMPACTED AGGREGATE BASE (CA-6), BOND BREAKER, AND COMPACTED POROUS GRANULAR BACKFILL (CA-11) SHALL BE CONSIDERED INCLUDED IN THE COST PER SQUARE FOOT FOR MODULAR BLOCK RETAINING WALL.
  - COLOR OF MODULAR CONCRETE BLOCK SHALL BE "NATURAL GRAY".
  - THE SURFACE AREA OF THE MODULAR BLOCK RETAINING WALL = 254 SQ.FT.
  - THE FACE OF THE BLOCK WALL SHALL BE COVERED WITH PLASTIC OR OTHER MATERIAL DURING THE SIDEWALK CONSTRUCTION TO PREVENT SPLATTERING OF CONCRETE ON THE BLOCKS.

ILLINOIS DEPARTMENT OF TRANSPORTATION  
**RETAINING WALL DETAIL**  
DATE : 8-05  
DRAWN BY : S.M.W.  
CHECKED BY : R.L.H.  
SCALE : 1"=20'