

F.A.S. RTE.	SECTION	COUNTY	TOTAL SHEETS	SHEET NO.
642	99-00124-02-PV	COLES	229	5
STA.		TO STA.		
FED. ROAD DIST. NO.		ILLINOIS FED. AID PROJECT		

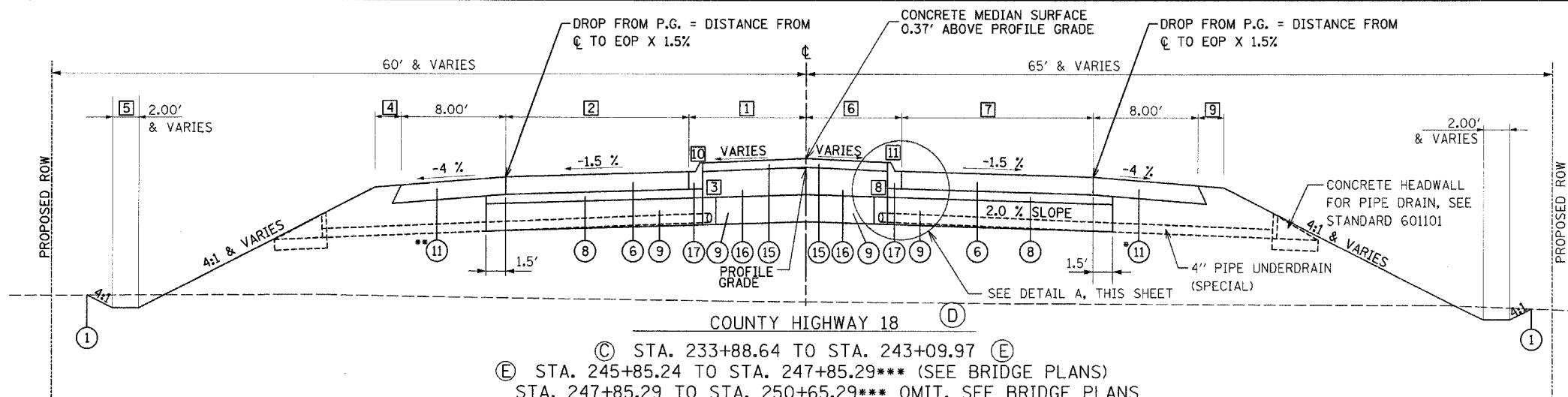

(C) STA. 233+88.64 TO STA. 243+09.97 (E)
 (E) STA. 245+85.24 TO STA. 247+85.29*** (SEE BRIDGE PLANS)
 STA. 247+85.29 TO STA. 250+65.29*** OMIT, SEE BRIDGE PLANS
 (SEE BRIDGE PLANS) STA. 250+65.29 TO STA. 252+65.24 (F)
 (F) STA. 255+40.37 TO STA. 264+61.71 (C)

- 1 STA. 233+88.64 TO STA. 236+02.79 = SEE MEDIAN DETAILS, SHEET NO. 71, DETAIL 1
 STA. 236+02.79 TO STA. 238+33.52 = TRANSITION FROM 7.65' TO 9.00'
 STA. 238+33.52 TO STA. 239+74.69 = 9.00'
 STA. 239+74.69 TO STA. 243+09.97 = SEE INTERSECTION DETAIL RAMPS A & B, SHEET NO. 68
- 2 STA. 233+88.64 TO STA. 236+02.79 = SEE MEDIAN DETAILS, SHEET NO. 71, DETAIL 1
 STA. 236+02.79 TO STA. 239+74.69 = 14.00'
 STA. 239+74.69 TO STA. 243+09.97 = SEE INTERSECTION DETAIL RAMPS A & B, SHEET NO. 68
- 3 STA. 235+19.64 TO STA. 240+96.07 = SEE DETAIL A, THIS SHEET
 STA. 246+22.50 TO STA. 248+15.51 = SEE DETAIL A, THIS SHEET
 STA. 248+15.51 TO STA. 250+36.41 = OMIT AT BRIDGE
 STA. 250+36.41 TO STA. 252+65.24 = SEE DETAIL A, THIS SHEET
 STA. 255+40.37 TO STA. 256+15.24 = SEE DETAIL A, THIS SHEET
 STA. 257+07.55 TO STA. 262+41.12 = SEE DETAIL A, THIS SHEET
- 4 STA. 233+88.64 TO STA. 243+09.97 = 0.00'
- 5 STA. 258+30.00 TO STA. 264+61.71 = 4.00'
- 6 STA. 233+88.64 TO STA. 236+02.79 = SEE MEDIAN DETAILS, SHEET NO. 71, DETAIL 1
 STA. 236+02.79 TO STA. 239+74.69 = TRANSITION FROM 1.32' TO 9.00'
 STA. 239+74.69 TO STA. 243+09.97 = SEE INTERSECTION DETAIL RAMPS A & B, SHEET NO. 68
- 7 STA. 233+88.64 TO STA. 236+02.79 = SEE MEDIAN DETAILS, SHEET NO. 71, DETAIL 1
 STA. 236+02.79 TO STA. 239+74.69 = TRANSITION FROM 17.00' TO 14.00'
 STA. 239+74.69 TO STA. 243+09.97 = SEE INTERSECTION DETAIL RAMPS A & B, SHEET NO. 68
- 8 STA. 236+09.23 TO STA. 241+42.80 = SEE DETAIL A, THIS SHEET
 STA. 242+35.24 TO STA. 243+09.97 = SEE DETAIL A, THIS SHEET
 STA. 245+85.24 TO STA. 248+14.17 = SEE DETAIL A, THIS SHEET
 STA. 248+14.17 TO STA. 250+35.07 = OMIT AT BRIDGE
 STA. 250+35.07 TO STA. 252+28.27 = SEE DETAIL A, THIS SHEET
 STA. 257+54.28 TO STA. 263+30.71 = SEE DETAIL A, THIS SHEET
- 9 STA. 233+88.64 TO STA. 243+09.97 = 0.00'
- 10 STA. 245+85.24 TO STA. 246+78.44 = 0.00'
 STA. 246+78.44 TO STA. 247+02.44 = TRANSITION FROM 0.00' TO 4.00'
 STA. 247+02.44 TO STA. 247+37.44 = 4.00'
 STA. 247+37.44 TO STA. 247+62.44 = TRANSITION FROM 4.00' TO 3.26'
 STA. 247+62.44 TO STA. 248+18.09 = 3.26'
 STA. 248+18.09 TO STA. 250+38.09 = SEE BRIDGE PLANS, SHEETS 119 TO 134
 STA. 250+38.09 TO STA. 252+65.24 = 3.26'
- 11 STA. 252+15.24 TO STA. 252+65.24 = TRANSITION GUTTER SLOPE FROM -1.50% TO 6.00%
- 12 STA. 245+85.24 TO STA. 247+85.29 = 9.00'
 STA. 247+85.29 TO STA. 250+65.29 = SEE BRIDGE PLANS, SHEETS 119 TO 134
 STA. 250+65.29 TO STA. 252+65.24 = TRANSITION FROM 8.57' TO 0.00'
- 13 STA. 255+40.37 TO STA. 258+75.66 = SEE INTERSECTION DETAIL RAMPS C & D, SHEET NO. 69
 STA. 258+75.66 TO STA. 260+16.84 = 9.00'
 STA. 260+16.84 TO STA. 262+47.56 = TRANSITION FROM 9.00' TO 7.65'
 STA. 262+47.56 TO STA. 264+61.71 = SEE MEDIAN DETAILS, SHEET NO. 71, DETAIL 2
- 14 STA. 255+40.37 TO STA. 258+75.66 = SEE INTERSECTION DETAIL RAMPS C & D, SHEET NO. 69
 STA. 258+75.66 TO STA. 262+47.56 = 14.00'
 STA. 262+47.56 TO STA. 264+61.71 = SEE MEDIAN DETAILS, SHEET NO. 71, DETAIL 2

- *USE BITUMINOUS SHOULDERS SUPERPAVE 10" FROM STA. 241+79.97 TO STA. 243+09.97. SEE INTERSECTION DETAIL RAMPS A & B, SHEET NO. 68.
- **USE BITUMINOUS SHOULDERS SUPERPAVE 10" FROM STA. 255+40.37 TO STA. 256+70.37. SEE INTERSECTION DETAIL RAMPS C & D, SHEET NO. 69.
- ***BRIDGE APPROACH PAVEMENT CONNECTOR (PCC) - STA. 247+79.29 TO STA. 247+85.29 AND STA. 250+65.29 TO STA. 250+71.29 (SEE STANDARD 420401).

1	EXISTING GROUND
2	BITUMINOUS CONCRETE PAVEMENT (FULL-DEPTH), SUPERPAVE, 11"
3	BITUMINOUS CONCRETE PAVEMENT (FULL-DEPTH), SUPERPAVE, 8"
4	BITUMINOUS CONCRETE SURFACE COURSE, SUPERPAVE, IL 9.5L (LOW ESAL)
5	AGGREGATE BASE COURSE, TYPE A 10"
6	PORTLAND CEMENT CONCRETE PAVEMENT 8" (JOINTED)
7	PORTLAND CEMENT CONCRETE PAVEMENT 9 1/2" (JOINTED)
8	AGGREGATE BASE COURSE, TYPE A 4"
9	PROCESSING LIME MODIFIED SOILS 12"
10	SUBBASE GRANULAR MATERIAL, TYPE C (COST INCLUDED IN 9)
11	BITUMINOUS SHOULDERS SUPERPAVE 8"
12	AGGREGATE SHOULDERS, TYPE A
13	AGGREGATE SHOULDERS, TYPE B 6"
14	PORTLAND CEMENT CONCRETE SHOULDERS 9 1/2"
15	CONCRETE MEDIAN SURFACE, 4"
16	AGGREGATE BASE COURSE, TYPE B
17	COMBINATION CONCRETE CURB AND GUTTER, TYPE M-4.06

- NOTES :
- SEE CROSS SECTIONS FOR DITCH ELEVATIONS
 - SEE CROSS SECTIONS FOR SIDE SLOPE TRANSITION LOCATIONS.
 - EARTH SHOULDER WIDENED FOR GUARDRAIL. SEE STANDARD 630301. SEE MISCELLANEOUS DETAIL SHEET, SHEET NO. 116, FOR BITUMINOUS SHOULDER CURB.

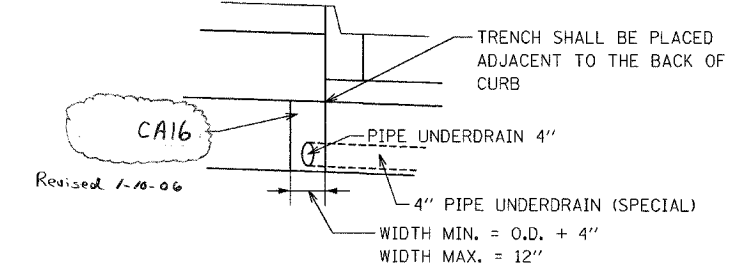

SEE STANDARD 601001 FOR MORE DETAILS
 SEE SHEET NO. 24 FOR LOCATIONS OF 4" PIPE UNDERDRAIN (SPECIAL)

REVISIONS	
NAME	DATE

ILLINOIS DEPARTMENT OF TRANSPORTATION
 PROPOSED TYPICAL SECTIONS
 C.H. 18
 FAI-57, FAS 642
 SEC NO. 15-23K, 99-00124-02-PV
 COLES COUNTY, ILLINOIS
 SCALE: NOT TO SCALE
 DATE 07/13/2005
 DRAWN BY SKM
 CHECKED BY JWM



LAYOUT: SKM 11/24/03
 DESIGN: DP/SM 11/24/03
 REVIEWED: SKM 10/29/04
 DT/13/2005
 F:\97\JOBS\97\201265\Civil\Sheet\G-502\typ.dgn

F.A.S. RTE.	SECTION	COUNTY	TOTAL SHEETS	SHEET NO.
642	99-00124-02-PV	COLES	229	6
STA.		TO STA.		
FED. ROAD DIST. NO.		ILLINOIS	FED. AID PROJECT	

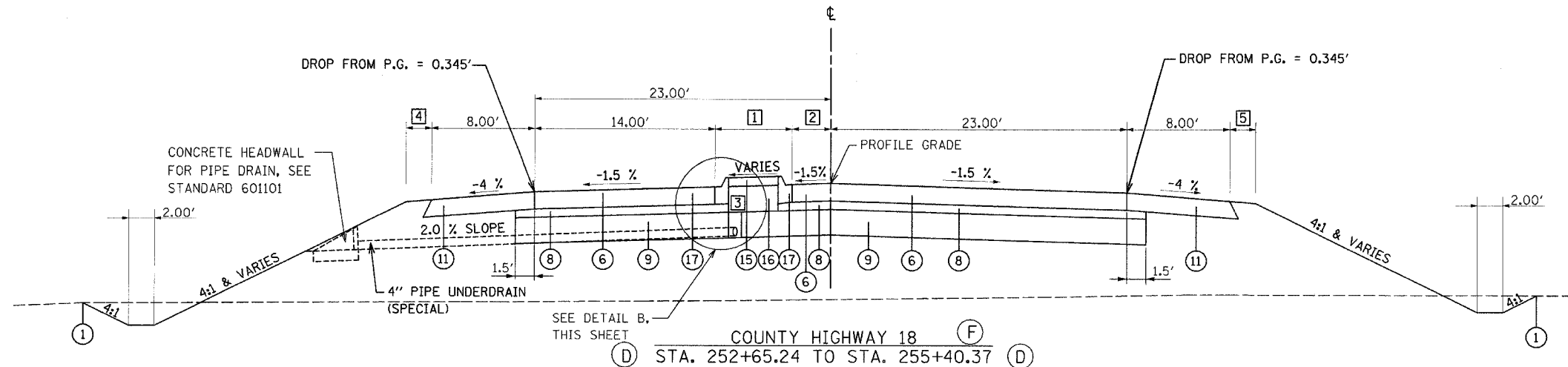

SEE DETAIL B, THIS SHEET
 COUNTY HIGHWAY 18 (F)
 STA. 252+65.24 TO STA. 255+40.37 (D)

- 1 STA. 252+65.24 TO STA. 253+35.24 = TRANSITION FROM 9.00' TO 6.00'
 STA. 253+35.24 TO STA. 255+40.37 = 6.00'
- 2 STA. 252+65.24 TO STA. 253+35.24 = TRANSITION FROM 0.00' TO 3.00'
 STA. 253+35.24 TO STA. 255+40.37 = 3.00'
- 3 STA. 252+65.24 TO STA. 255+40.37 = SEE DETAIL B, THIS SHEET
- 4 STA. 252+65.24 TO STA. 255+40.37 = 3.26'
- 5 STA. 252+65.24 TO STA. 252+88.14 = 3.26'
 STA. 252+88.14 TO STA. 253+13.14 = TRANSITION FROM 3.26' TO 4.00'
 STA. 253+13.14 TO STA. 253+48.14 = 4.00'
 STA. 253+48.14 TO STA. 253+72.14 = TRANSITION FROM 4.00' TO 0.00'
 STA. 253+72.14 TO STA. 255+40.37 = 0.00'

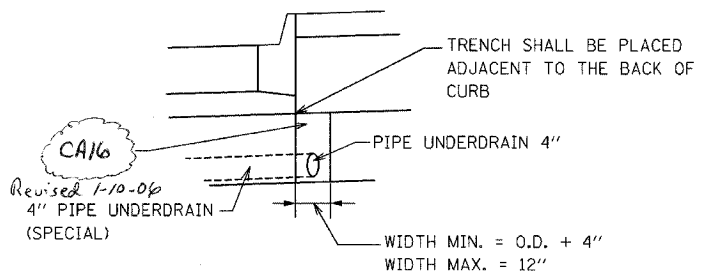

DETAIL B
 SEE STANDARD 601001 FOR MORE DETAILS
 SEE SHEET NO. 24 FOR LOCATIONS OF 4" PIPE UNDERDRAIN (SPECIAL)

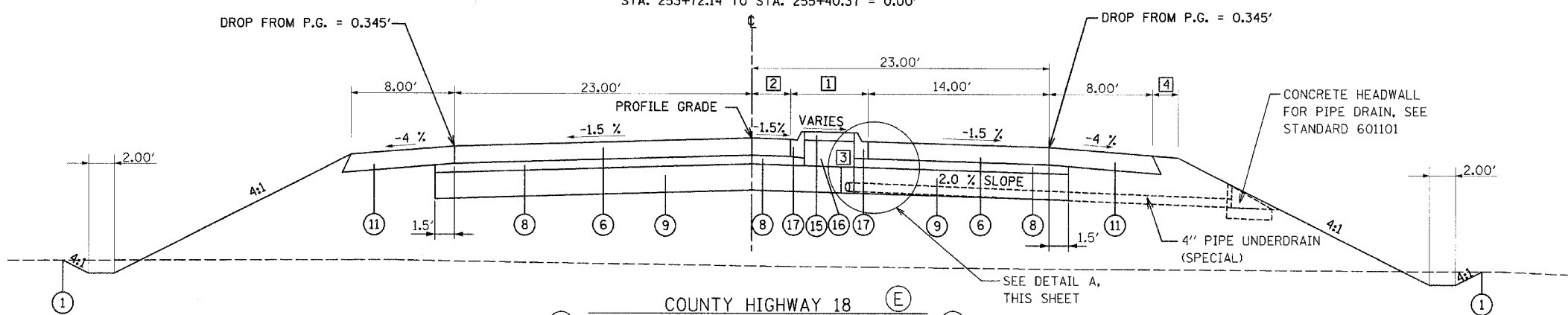

SEE DETAIL A, THIS SHEET
 COUNTY HIGHWAY 18 (E)
 STA. 243+09.97 TO STA. 245+85.24 (D)

- 1 STA. 243+09.97 TO STA. 245+15.24 = 6.00'
 STA. 245+15.24 TO STA. 245+85.24 = TRANSITION FROM 6.00' TO 9.00'
- 2 STA. 243+09.97 TO STA. 245+15.24 = 3.00'
 STA. 245+15.24 TO STA. 245+85.24 = TRANSITION FROM 3.00' TO 0.00'
- 3 STA. 243+09.97 TO STA. 245+85.24 = SEE DETAIL A THIS SHEET
- 4 STA. 243+09.97 TO STA. 243+72.84 = 0'
 STA. 243+72.84 TO STA. 243+96.84 = TRANSITION FROM 0.00' TO 4.00'
 STA. 243+96.84 TO STA. 244+31.84 = 4.00'
 STA. 244+31.84 TO STA. 244+56.84 = TRANSITION FROM 4.00' TO 3.26'
 STA. 244+56.84 TO STA. 245+85.24 = 3.26'

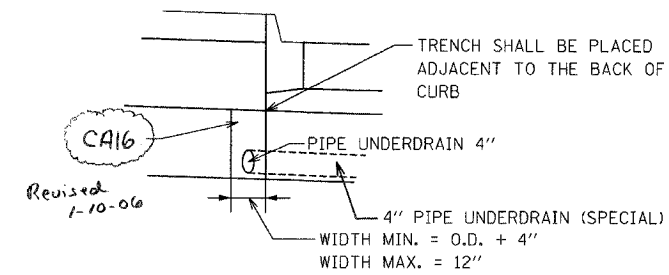

DETAIL A
 SEE STANDARD 601001 FOR MORE DETAILS
 SEE SHEET NO. 24 FOR LOCATIONS OF 4" PIPE UNDERDRAIN (SPECIAL)

- 1 EXISTING GROUND
- 2 BITUMINOUS CONCRETE PAVEMENT (FULL-DEPTH), SUPERPAVE, 11"
- 3 BITUMINOUS CONCRETE PAVEMENT (FULL-DEPTH), SUPERPAVE, 8"
- 4 BITUMINOUS CONCRETE SURFACE COURSE, SUPERPAVE, IL 9.5L (LOW ESAL)
- 5 AGGREGATE BASE COURSE, TYPE A 10"
- 6 PORTLAND CEMENT CONCRETE PAVEMENT 8" (JOINTED)
- 7 PORTLAND CEMENT CONCRETE PAVEMENT 9 1/2" (JOINTED)
- 8 AGGREGATE BASE COURSE, TYPE A 4"
- 9 PROCESSING LIME MODIFIED SOILS 12"
- 10 SUBBASE GRANULAR MATERIAL, TYPE C (COST INCLUDED IN 9)
- 11 BITUMINOUS SHOULDERS SUPERPAVE 8"
- 12 AGGREGATE SHOULDERS, TYPE A
- 13 AGGREGATE SHOULDERS, TYPE B 6"
- 14 PORTLAND CEMENT CONCRETE SHOULDERS 9 1/2"
- 15 CONCRETE MEDIAN SURFACE, 4"
- 16 AGGREGATE BASE COURSE, TYPE B
- 17 COMBINATION CONCRETE CURB AND GUTTER, TYPE M-4.06

- NOTES :
- 1 SEE CROSS SECTIONS FOR DITCH ELEVATIONS
 - 2 SEE CROSS SECTIONS FOR SIDE SLOPE TRANSITION LOCATIONS.
 - 3 EARTH SHOULDER WIDENED FOR GUARDRAIL. SEE STANDARD 630301. SEE MISCELLANEOUS DETAILS SHEET, SHEET NO. 116, FOR BITUMINOUS SHOULDER CURB.

REVISIONS	
NAME	DATE

ILLINOIS DEPARTMENT OF TRANSPORTATION
 PROPOSED TYPICAL SECTIONS
 C.H. 18
 FAI-57, FAS 642
 SEC NO. 15-23K, 99-00124-02-PV
 COLES COUNTY, ILLINOIS

SCALE: NOT TO SCALE
 DATE 07/13/2005
 DRAWN BY SKM
 CHECKED BY JWM



07/13/2005
 SKM 12/26/03
 SKM 07/23/03
 SKM 07/05/04
 1:07 JUES BT sc:0286/Civil/Sheet/5037p.dgn

F.A.S. RTE.	SECTION	COUNTY	TOTAL SHEETS	SHEET NO.
642	99-00124-02-PV	COLES	229	7
STA.	TO STA.			
FED. ROAD DIST. NO.	ILLINOIS	FED. AID PROJECT		

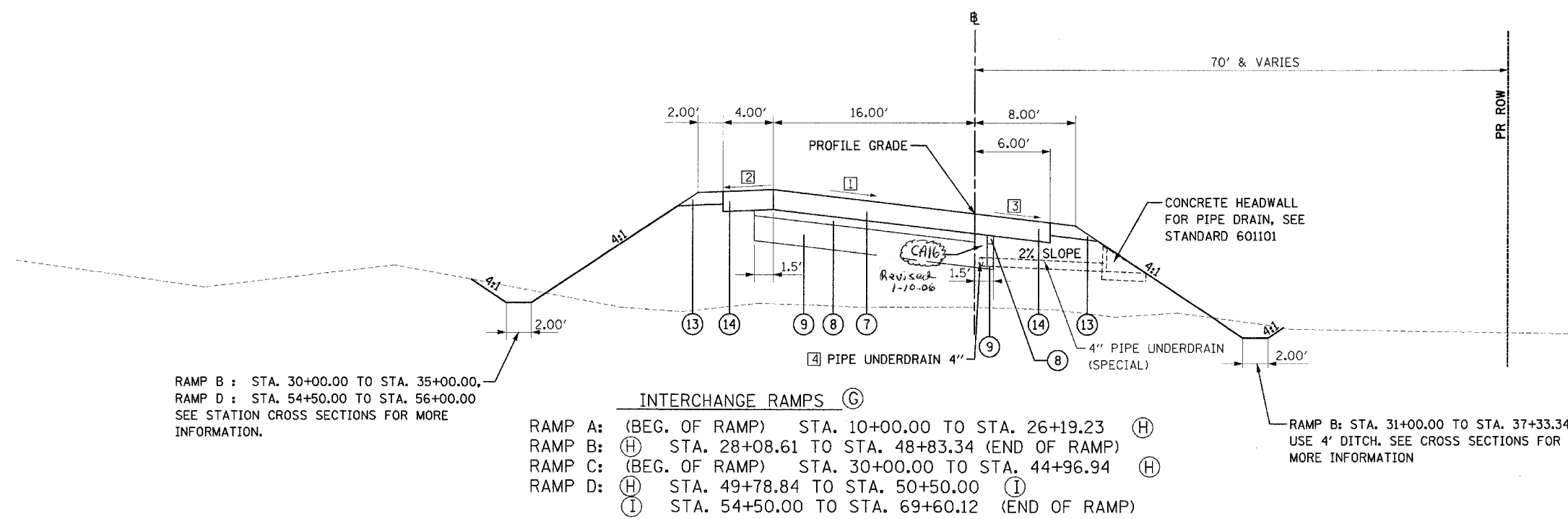

PAVEMENT DESIGN INFORMATION
 INTERCHANGE RAMP:
 DESIGN PERIOD = 20 YRS.
 DESIGN YEAR TRAFFIC = 1800 (YEAR 2025)
 P.V. = 1710, S.U. = 54, M.U. = 36
 SUBGRADE SUPPORT RATING = POOR

RAMP B : STA. 30+00.00 TO STA. 35+00.00,
 RAMP D : STA. 54+50.00 TO STA. 56+00.00
 SEE STATION CROSS SECTIONS FOR MORE INFORMATION.

- INTERCHANGE RAMP (C)**
- RAMP A: (BEG. OF RAMP) STA. 10+00.00 TO STA. 26+19.23 (H)
 - RAMP B: (H) STA. 28+08.61 TO STA. 48+83.34 (END OF RAMP)
 - RAMP C: (BEG. OF RAMP) STA. 30+00.00 TO STA. 44+96.94 (H)
 - RAMP D: (H) STA. 49+78.84 TO STA. 50+50.00 (I)
 - (I) STA. 54+50.00 TO STA. 69+60.12 (END OF RAMP)

- (1) EXISTING GROUND
- (2) BITUMINOUS CONCRETE PAVEMENT (FULL-DEPTH), SUPERPAVE, 11"
- (3) BITUMINOUS CONCRETE PAVEMENT (FULL-DEPTH), SUPERPAVE, 8"
- (4) BITUMINOUS CONCRETE SURFACE COURSE, SUPERPAVE, IL 9.5L (LOW ESAL)
- (5) AGGREGATE BASE COURSE, TYPE A 10"
- (6) PORTLAND CEMENT CONCRETE PAVEMENT 8" (JOINTED)
- (7) PORTLAND CEMENT CONCRETE PAVEMENT 9 1/2" (JOINTED)
- (8) AGGREGATE BASE COURSE, TYPE A 4"
- (9) PROCESSING LIME MODIFIED SOILS 12"
- (10) SUBBASE GRANULAR MATERIAL, TYPE C (COST INCLUDED IN (9))
- (11) BITUMINOUS SHOULDERS SUPERPAVE 8"
- (12) AGGREGATE SHOULDERS, TYPE A
- (13) AGGREGATE SHOULDERS, TYPE B 6"
- (14) PORTLAND CEMENT CONCRETE SHOULDERS 9 1/2"
- (15) CONCRETE MEDIAN SURFACE, 4"
- (16) AGGREGATE BASE COURSE, TYPE B
- (17) COMBINATION CONCRETE CURB AND GUTTER, TYPE M-4.06

- (1) RAMP A: STA. 10+00.00 TO STA. 18+70.09 = SEE RAMP A TERMINAL DETAIL, SHEETS 58 AND 59
 STA. 18+70.09 TO STA. 23+89.21 = 6%
 STA. 23+89.21 TO STA. 26+19.23 = TRANSITION FROM 6% TO 0%
- RAMP B: STA. 28+08.61 TO STA. 29+99.48 = TRANSITION FROM 0% TO 6%
 STA. 29+99.48 TO STA. 36+03.34 = 6%
 STA. 36+03.34 TO STA. 48+83.34 = SEE RAMP B TERMINAL DETAIL, SHEET 60 AND 61
- RAMP C: STA. 30+00.00 TO STA. 38+70.96 = SEE RAMP C TERMINAL DETAIL, SHEETS 62 AND 63
 STA. 38+70.96 TO STA. 42+67.22 = 6%
 STA. 42+67.22 TO STA. 44+96.94 = TRANSITION FROM 6% TO 0%
- RAMP D: STA. 49+78.84 TO STA. 50+50.00 = TRANSITION FROM 0% TO 2%
 STA. 54+50.00 TO STA. 56+80.12 = 6%
 STA. 56+80.12 TO STA. 69+60.12 = SEE RAMP D TERMINAL DETAIL, SHEETS 64 AND 65
- (2) RAMP A: STA. 10+00.00 TO STA. 18+70.09 = SEE RAMP A TERMINAL DETAIL, SHEETS 58 AND 59
 STA. 18+70.09 TO STA. 23+89.21 = -2%
 STA. 23+89.21 TO STA. 26+19.23 = TRANSITION FROM -2% TO -4%
- RAMP B: STA. 28+08.61 TO STA. 29+99.48 = TRANSITION FROM -4% TO -2%
 STA. 29+99.48 TO STA. 36+03.34 = -2%
 STA. 36+03.34 TO STA. 48+83.34 = SEE RAMP B TERMINAL DETAIL, SHEETS 60 AND 61
- RAMP C: STA. 30+00.00 TO STA. 38+70.96 = SEE RAMP C TERMINAL DETAIL, SHEETS 62 AND 63
 STA. 38+70.96 TO STA. 42+67.22 = -2%
 STA. 42+67.22 TO STA. 44+96.94 = TRANSITION FROM -2% TO -4%
- RAMP D: STA. 49+78.84 TO STA. 50+50.00 = TRANSITION FROM -4% TO -3.33%
 STA. 54+50.00 TO STA. 56+80.12 = -2%
 STA. 56+80.12 TO STA. 69+60.12 = SEE RAMP D TERMINAL DETAIL, SHEETS 64 AND 65

- (3) RAMP A: STA. 10+00.00 TO STA. 18+70.09 = SEE RAMP A TERMINAL DETAIL, SHEETS 58 AND 59
 STA. 18+70.09 TO STA. 23+89.21 = -6%
 STA. 23+89.21 TO STA. 26+19.23 = TRANSITION FROM -6% TO -4%
- RAMP B: STA. 28+08.61 TO STA. 29+35.86 = -4%
 STA. 29+35.86 TO STA. 29+99.48 = TRANSITION FROM -4% TO -6%
 STA. 29+99.48 TO STA. 36+03.34 = -6%
 STA. 36+03.34 TO STA. 48+83.34 = SEE RAMP B TERMINAL DETAIL, SHEETS 60 AND 61
- RAMP C: STA. 30+00.00 TO STA. 38+70.96 = SEE RAMP C TERMINAL DETAIL, SHEETS 62 AND 63
 STA. 38+70.96 TO STA. 42+67.22 = -6%
 STA. 42+67.22 TO STA. 44+96.94 = TRANSITION FROM -6% TO -4%
- RAMP D: STA. 49+78.84 TO STA. 50+50.00 = -4%
 STA. 54+50.00 TO STA. 56+80.12 = -6%
 STA. 56+80.12 TO STA. 69+60.12 = SEE RAMP D TERMINAL DETAIL, SHEET 64 AND 65
- (4) RAMP A: STA. 10+00.00 TO STA. 26+19.23 = SEE STANDARD 601001
- RAMP B: STA. 28+08.61 TO STA. 48+83.34 = SEE STANDARD 601001
- RAMP C: STA. 30+00.00 TO STA. 44+96.94 = SEE STANDARD 601001
- RAMP D: STA. 49+78.84 TO STA. 50+50.00 = SEE STANDARD 601001
 STA. 54+50.00 TO STA. 69+60.12 = SEE STANDARD 601001

NOTES : 1 SEE CROSS SECTIONS FOR DITCH ELEVATIONS
 2 SEE HIGHWAY STANDARDS 420206, 420306 AND 601001 FOR MORE INFORMATION.

REVISIONS	
NAME	DATE

ILLINOIS DEPARTMENT OF TRANSPORTATION
 PROPOSED TYPICAL SECTIONS
 INTERCHANGE RAMP
 FAI-57, FAS 642
 SEC NO. 15-23K, 99-00124-02-PV
 COLES COUNTY, ILLINOIS

SCALE: NOT TO SCALE
 DATE 07/13/2005

DRAWN BY SKM
 CHECKED BY JWM



07/13/2005
 P:\ST\JOBS\97-2028\B\Civil\Sheet\g-511ty.dgn
 LAYOUT SKM 12/26/03
 DRAWN SKM 12/26/03
 RECHECKED JMW 01/05/04

F.A.S. RTE.	SECTION	COUNTY	TOTAL SHEETS	SHEET NO.
642	99-00124-02-PV	COLES	228	8
STA.		TO STA.		
FED. ROAD DIST. NO.	ILLINOIS	FED. AID PROJECT		

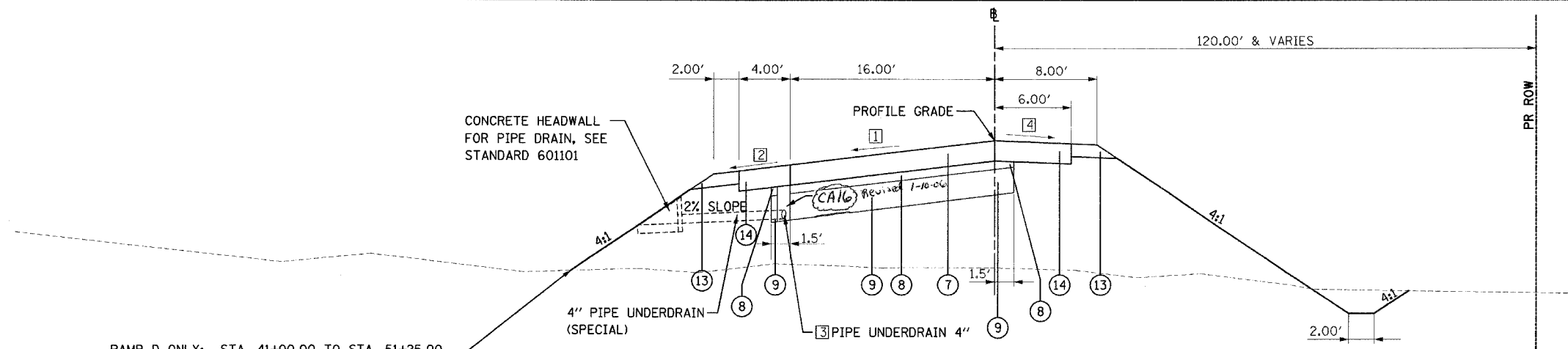

RAMP D ONLY: STA. 41+00.00 TO STA. 51+25.00, SEE STATION CROSS SECTIONS AND WETLAND PLAN FOR MORE INFORMATION.

INTERCHANGE RAMPS (H)

- RAMP A: (C) STA. 26+19.23 TO STA. 35+91.10 (END OF RAMP)
- RAMP B: (BEG. OF RAMP) STA. 20+00.00 TO STA. 28+08.61 (C)
- RAMP C: (C) STA. 44+96.94 TO STA. 56+13.93 (END OF RAMP)
- RAMP D: (BEG. OF RAMP) STA. 40+00.00 TO STA. 49+78.84 (C)

- (1) EXISTING GROUND
- (2) BITUMINOUS CONCRETE PAVEMENT (FULL-DEPTH), SUPERPAVE, 11"
- (3) BITUMINOUS CONCRETE PAVEMENT (FULL-DEPTH), SUPERPAVE, 8"
- (4) BITUMINOUS CONCRETE SURFACE COURSE, SUPERPAVE, IL 9.5L (LOW ESAL)
- (5) AGGREGATE BASE COURSE, TYPE A 10"
- (6) PORTLAND CEMENT CONCRETE PAVEMENT 8" (JOINTED)
- (7) PORTLAND CEMENT CONCRETE PAVEMENT 9 1/2" (JOINTED)
- (8) AGGREGATE BASE COURSE, TYPE A 4"
- (9) PROCESSING LIME MODIFIED SOILS 12"
- (10) SUBBASE GRANULAR MATERIAL, TYPE C (COST INCLUDED IN (9))
- (11) BITUMINOUS SHOULDERS SUPERPAVE 8"
- (12) AGGREGATE SHOULDERS, TYPE A
- (13) AGGREGATE SHOULDERS, TYPE B 6"
- (14) PORTLAND CEMENT CONCRETE SHOULDERS 9 1/2"
- (15) CONCRETE MEDIAN SURFACE, 4"
- (16) AGGREGATE BASE COURSE, TYPE B
- (17) COMBINATION CONCRETE CURB AND GUTTER, TYPE M-4.06

(1) RAMP A: STA. 26+19.23 TO STA. 28+49.25 = TRANSITION FROM 0% TO -6%
 STA. 28+49.25 TO STA. 32+72.55 = -6%
 STA. 32+72.55 TO STA. 34+52.55 = TRANSITION FROM -6% TO -1.5%
 STA. 34+52.55 TO STA. 34+68.10 = -1.5%
 STA. 34+68.10 TO STA. 35+91.10 = SEE RAMP A&B INTERSECTION DETAIL, SHEET NO. 68

RAMP B: STA. 20+00.00 TO STA. 21+81.79 = SEE RAMP A&B INTERSECTION DETAIL, SHEET NO. 68
 STA. 21+81.79 TO STA. 21+83.73 = -1.5%
 STA. 21+83.73 TO STA. 23+63.73 = TRANSITION FROM -1.5% TO -6%
 STA. 23+63.73 TO STA. 26+17.73 = -6%
 STA. 26+17.73 TO STA. 28+08.61 = TRANSITION FROM -6% TO 0%

RAMP C: STA. 44+96.94 TO STA. 47+19.65 = TRANSITION FROM 0% TO -6%
 STA. 47+19.65 TO STA. 52+95.97 = -6%
 STA. 52+95.97 TO STA. 54+75.97 = TRANSITION FROM -6% TO -1.5%
 STA. 54+75.97 TO STA. 54+91.05 = -1.5%
 STA. 54+91.05 TO STA. 56+13.93 = SEE RAMP C&D INTERSECTION DETAIL, SHEET NO. 69

RAMP D: STA. 40+00.00 TO STA. 41+82.00 = SEE RAMP C&D INTERSECTION DETAIL, SHEET NO. 69
 STA. 41+82.00 TO STA. 43+53.15 = TRANSITION FROM -1.72% TO -6%
 STA. 43+53.15 TO STA. 47+65.68 = -6%
 STA. 47+65.68 TO STA. 49+78.84 = TRANSITION FROM -6% TO 0%

(2) RAMP A: STA. 26+19.23 TO STA. 28+49.25 = TRANSITION FROM -4% TO -6%
 STA. 28+49.25 TO STA. 32+72.55 = -6%
 STA. 32+72.55 TO STA. 33+52.55 = TRANSITION FROM -6% TO -4%
 STA. 33+52.55 TO STA. 34+68.10 = -4%
 STA. 34+68.10 TO STA. 35+91.10 = SEE RAMP A&B INTERSECTION DETAIL, SHEET NO. 68

RAMP B: STA. 20+00.00 TO STA. 21+81.79 = SEE RAMP A&B INTERSECTION DETAIL, SHEET NO. 68
 STA. 21+81.79 TO STA. 22+83.73 = -4%
 STA. 22+83.73 TO STA. 23+63.73 = TRANSITION FROM -4% TO -6%
 STA. 23+63.73 TO STA. 26+17.73 = -6%
 STA. 26+17.73 TO STA. 26+81.36 = TRANSITION FROM -6% TO -4%
 STA. 26+81.36 TO STA. 28+08.61 = -4%

RAMP C: STA. 44+96.94 TO STA. 47+19.65 = TRANSITION FROM -4% TO -6%
 STA. 47+19.65 TO STA. 52+95.97 = -6%
 STA. 52+95.97 TO STA. 53+75.97 = TRANSITION FROM -6% TO -4%
 STA. 53+75.97 TO STA. 54+91.05 = -4%
 STA. 54+91.05 TO STA. 56+13.93 = SEE RAMP C&D INTERSECTION DETAIL, SHEET NO. 69

RAMP D: STA. 40+00.00 TO STA. 41+82.00 = SEE RAMP C&D INTERSECTION DETAIL, SHEET NO. 69
 STA. 41+82.00 TO STA. 42+73.15 = -4%
 STA. 42+73.15 TO STA. 43+53.15 = TRANSITION FROM -4% TO -6%
 STA. 43+53.15 TO STA. 47+65.68 = -6%
 STA. 47+65.68 TO STA. 48+36.73 = TRANSITION FROM -6% TO -4%
 STA. 48+36.73 TO STA. 49+78.84 = -4%

(3) RAMP A: STA. 26+19.23 TO STA. 35+00.10 = SEE STANDARD 601001
 RAMP B: STA. 20+99.36 TO STA. 28+08.61 = SEE STANDARD 601001
 RAMP C: STA. 44+96.94 TO STA. 55+22.93 = SEE STANDARD 601001
 RAMP D: STA. 40+99.24 TO STA. 49+78.84 = SEE STANDARD 601001

(4) RAMP A: STA. 26+19.23 TO STA. 28+49.25 = TRANSITION FROM -4% TO -2%
 STA. 28+49.25 TO STA. 32+72.55 = -2%
 STA. 32+72.55 TO STA. 33+52.55 = TRANSITION FROM -2% TO -4%
 STA. 33+52.55 TO STA. 34+68.10 = -4%
 STA. 34+68.10 TO STA. 35+91.10 = SEE RAMP A&B INTERSECTION DETAIL, SHEET NO. 68
 RAMP B: STA. 20+00.00 TO STA. 21+81.79 = SEE RAMP A&B INTERSECTION DETAIL, SHEET NO. 68
 STA. 21+81.79 TO STA. 22+83.73 = -4%
 STA. 22+83.73 TO STA. 23+63.73 = TRANSITION FROM -4% TO -2%
 STA. 23+63.73 TO STA. 26+17.73 = -2%
 STA. 26+17.73 TO STA. 28+08.61 = TRANSITION FROM -2% TO -4%

RAMP C: STA. 44+96.94 TO STA. 47+19.65 = TRANSITION FROM -4% TO -2%
 STA. 47+19.65 TO STA. 52+95.97 = -2%
 STA. 52+95.97 TO STA. 53+75.97 = TRANSITION FROM -2% TO -4%
 STA. 53+75.97 TO STA. 54+91.05 = -4%
 STA. 54+91.05 TO STA. 56+13.93 = SEE RAMP C&D INTERSECTION DETAIL, SHEET NO. 69

RAMP D: STA. 40+00.00 TO STA. 41+82.00 = SEE RAMP C&D INTERSECTION DETAIL, SHEET NO. 69
 STA. 41+82.00 TO STA. 42+73.15 = -4%
 STA. 42+73.15 TO STA. 43+53.15 = TRANSITION FROM -4% TO -2%
 STA. 43+53.15 TO STA. 47+65.68 = -2%
 STA. 47+65.68 TO STA. 49+78.84 = TRANSITION FROM -2% TO -4%

NOTES : 1 SEE CROSS SECTIONS FOR DITCH ELEVATIONS
 2 SEE HIGHWAY STANDARDS 420206, 420306 AND 601001 FOR MORE INFORMATION.

REVISIONS	
NAME	DATE

ILLINOIS DEPARTMENT OF TRANSPORTATION
 PROPOSED TYPICAL SECTIONS
 INTERCHANGE RAMPS
 FAI-57, FAS 642
 SEC NO. 15-23K, 99-00124-02-PV
 COLES COUNTY, ILLINOIS
 SCALE: NOT TO SCALE
 DATE 07/13/2005
 DRAWN BY SKM
 CHECKED BY JWM



07/13/2005
 SKM 12/25/03
 SKM 12/25/03
 JWM 01/26/05
 JWM 01/26/05

F.A.S. RTE.	SECTION	COUNTY	TOTAL SHEETS	SHEET NO.
642	99-00124-02-PV	COLES	229	9
STA.	TO STA.			
FED. ROAD DIST. NO.	ILLINOIS	FED. AID PROJECT		

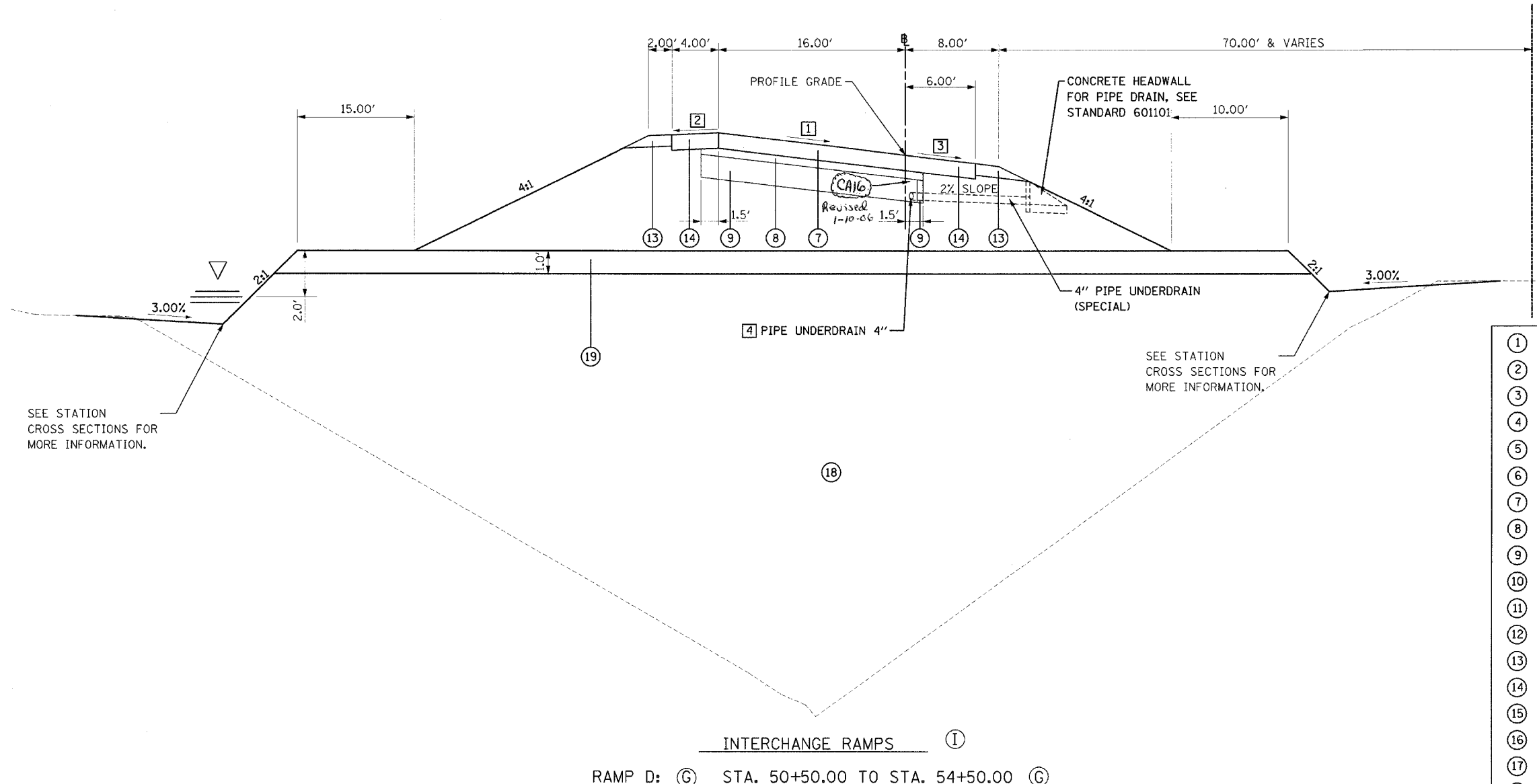

PAVEMENT DESIGN INFORMATION
 INTERCHANGE RAMPS:
 DESIGN PERIOD = 20 YRS.
 DESIGN YEAR TRAFFIC = 1800 (YEAR 2025)
 P.V. = 1710, S.U. = 54, M.U. = 36
 SUBGRADE SUPPORT RATING = POOR

- ① EXISTING GROUND
- ② BITUMINOUS CONCRETE PAVEMENT (FULL-DEPTH), SUPERPAVE, 11"
- ③ BITUMINOUS CONCRETE PAVEMENT (FULL-DEPTH), SUPERPAVE, 8"
- ④ BITUMINOUS CONCRETE SURFACE COURSE, SUPERPAVE, IL 9.5L (LOW ESAL)
- ⑤ AGGREGATE BASE COURSE, TYPE A 10"
- ⑥ PORTLAND CEMENT CONCRETE PAVEMENT 8" (JOINTED)
- ⑦ PORTLAND CEMENT CONCRETE PAVEMENT 9 1/2" (JOINTED)
- ⑧ AGGREGATE BASE COURSE, TYPE A 4"
- ⑨ PROCESSING LIME MODIFIED SOILS 12"
- ⑩ SUBBASE GRANULAR MATERIAL, TYPE C (COST INCLUDED IN ⑨)
- ⑪ BITUMINOUS SHOULDERS SUPERPAVE 8"
- ⑫ AGGREGATE SHOULDERS, TYPE A
- ⑬ AGGREGATE SHOULDERS, TYPE B 6"
- ⑭ PORTLAND CEMENT CONCRETE SHOULDERS 9 1/2"
- ⑮ CONCRETE MEDIAN SURFACE, 4"
- ⑯ AGGREGATE BASE COURSE, TYPE B
- ⑰ COMBINATION CONCRETE CURB AND GUTTER, TYPE M-4.06
- ⑱ ROCK FILL CORE
- ⑲ ROCK FILL CAP

- ① RAMP D - STA. 50+50.00 TO STA. 51+91.99 = TRANSITION FROM 2% TO 6%
 STA. 51+91.99 TO STA. 54+50.00 = 6%
- ② RAMP D - STA. 50+50.00 TO STA. 51+91.99 = TRANSITION FROM -3.33% TO -2%
 STA. 51+91.99 TO STA. 54+50.00 = -2%
- ③ RAMP D - STA. 50+50.00 TO STA. 51+20.94 = -4%
 STA. 51+20.94 TO STA. 51+91.99 = TRANSITION FROM -4% TO -6%
 STA. 51+91.99 TO STA. 54+50.00 = -6%
- ④ RAMP D - STA. 50+50.00 TO STA. 54+50.00 = SEE STANDARD 601001

NOTES : 1 SEE CROSS SECTIONS FOR ROCKFILL ELEVATIONS, AND MORE DETAILED INFORMATION.
 2 SEE HIGHWAY STANDARDS 420206 AND 420306 FOR MORE INFORMATION.
 3 LOCATE TOP OF ROCKFILL CAP 2' ABOVE WATER LINE.

REVISIONS	
NAME	DATE

ILLINOIS DEPARTMENT OF TRANSPORTATION
 PROPOSED TYPICAL SECTIONS
 INTERCHANGE RAMPS
 FAI-57, FAS 642
 SEC NO. 15-23K, 99-00124-02-PV
 COLES COUNTY, ILLINOIS
 SCALE: NOT TO SCALE
 DATE 07/13/2005
 DRAWN BY SKM
 CHECKED BY JWM



07/13/2005
 1:07 JOBS 97:20288\Civil\Sheet\c-512hy.pdgn
 LAYOUT SKM 12/26/03
 DRAWN SKM 12/26/03
 REVIEWED JWM 07/05/04

