



# Illinois Department of Transportation

2300 South Dirksen Parkway / Springfield, Illinois / 62764

January 13, 2006

SUBJECT: FAS 642 (CH 18)  
Project HPD-1073(003)  
Section 99-00124-02-PV  
Coles County  
Contract No. 91353  
Item 96  
January 20, 2006 Letting  
Addendum (C)

TO PROSPECTIVE BIDDERS:

Due to clarify information necessary to revise the following:

**Proposal – Added Special Provision “TRAFFIC CONTROL AND PROTECTION FOR TEMPORARY DETOUR F.A.I. RTE. 57”**

**PLANS – Revised sheet, 14, 14A, 15, 15A, 16, 16A**

Prime contractors must utilize the enclosed material when preparing their bid and must include any Schedule of Prices changes in their bidding proposal. Bidders using computer-generated bids are cautioned to reflect any and all Schedule of Prices changes, if involved, into their computer programs.

Since the proposal sheets are displayed back to back, bidders are cautioned to exercise care when inserting revised and/or added special provisions into their proposals.

Please call 217-782-7806 if any of the above-described material is not included in this transmittal.

Very truly yours,

Michael L. Hine  
Engineer of Design and Environment

A handwritten signature in black ink, appearing to read 'Ted B. Walschleger', followed by the letters 'P.E.' in a smaller font.

By: Ted B. Walschleger  
Engineer of Project Development  
and Implementation

**INDEX OF SPECIAL PROVISIONS (CONTINUED)**

	PAGE #
Impact Attenuators	18
Inspection Wells	18
Permanent Bench Marks	18
Light Pole, Fiberglass, Anchor Base, 45 Ft. M.H., Tenon Mount	19
Light Pole, Fiberglass, Anchor Base, 45 Ft. M.H., Tenon Mount, Twin	20
Precast Concrete Box Culvert End Sections 8' x 4' and 6' x 3'	21
Status of Utilities to be Adjusted	21
Existing Signs	22
Wetland Compensation	22
Commitments	26
40A Permit	27
SWPP	32

Treatment of Existing Field Tile Systems 178 Added 1-11-06  
Traffic Control and Protection for 180 Added 1-13-06  
Temporary Detour F.A.I. 57

# INTERSTATE CLOSURE USING EXIT RAMP

TYPE III BARRICADES WITH FLASHING LIGHTS AND ROAD CLOSED SIGNS

CHANGEABLE MESSAGE SIGNS SHALL BE USED IN ADVANCE OF SIGNING TO WARN OF CLOSURE

CMS	ROAD CLOSED	2 MILES AHEAD	FOLLOW DETOUR SIGNS

EXIT RAMP:  
 IL 133 @ ARCOLA  
 IL 16 @ MATTOON  
 DRUMS OR DIRECTIONAL BARRICADES WITH STEADY BURNING LIGHTS AT 50 CTS. IN TAPER. DRUMS WITH STEADY BURNING LIGHTS IN TANGENT (BETWEEN TAPERS) AT 100' CTS.

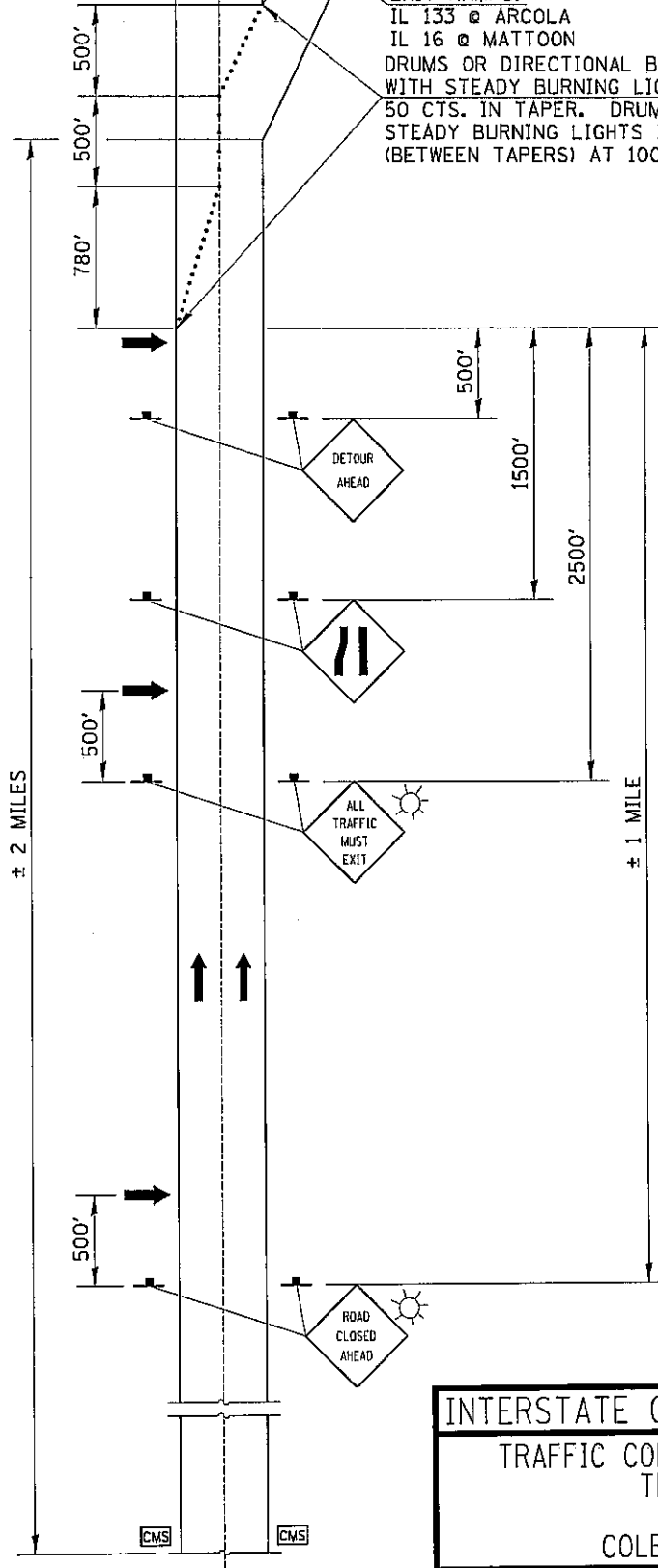

### LEGEND

- SIGN
- CHANGEABLE MESSAGE SIGN
- DRUM W/ STEADY BURNING LIGHT
- TYPE III BARRICADE
- ARROW BOARD
- SIGN W/ HIGH INTENSITY FLASHING LIGHT

0 500 1000 1500  
 VERTICAL SCALE 1 = 500  
 HORIZONTAL SCALE 1 = 20

## INTERSTATE CLOSURE USING EXIT RAMP

TRAFFIC CONTROL AND PROTECTION FOR  
 TEMPORARY DETOUR  
 F.A.I. RTE 57  
 COLES COUNTY, ILLINOIS

FIGURE

97S2028B

01/13/2006 08:09:51 AM

SF/LES