

F.A.S. RTE.	SECTION	COUNTY	TOTAL SHEETS	SHEET NO.
642	99-00124-02-PV	COLES	229	5
STA.		TO STA.		
FED. ROAD DIST. NO.		ILLINOIS FED. AID PROJECT		

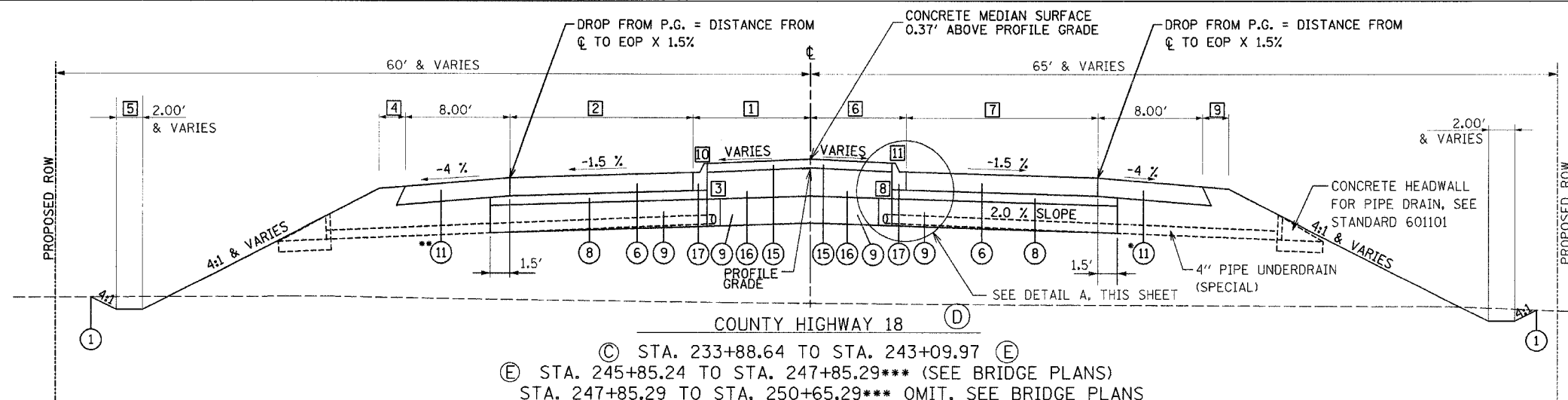

(C) STA. 233+88.64 TO STA. 243+09.97 (E)  
 (E) STA. 245+85.24 TO STA. 247+85.29\*\*\* (SEE BRIDGE PLANS)  
 STA. 247+85.29 TO STA. 250+65.29\*\*\* OMIT, SEE BRIDGE PLANS  
 (SEE BRIDGE PLANS) STA. 250+65.29 TO STA. 252+65.24 (F)  
 (F) STA. 255+40.37 TO STA. 264+61.71 (C)

- 1 STA. 233+88.64 TO STA. 236+02.79 = SEE MEDIAN DETAILS, SHEET NO. 71, DETAIL 1  
 STA. 236+02.79 TO STA. 238+33.52 = TRANSITION FROM 7.65' TO 9.00'  
 STA. 238+33.52 TO STA. 239+74.69 = 9.00'  
 STA. 239+74.69 TO STA. 243+09.97 = SEE INTERSECTION DETAIL RAMPS A & B, SHEET NO. 68
- 2 STA. 233+88.64 TO STA. 236+02.79 = SEE MEDIAN DETAILS, SHEET NO. 71, DETAIL 1  
 STA. 236+02.79 TO STA. 239+74.69 = 14.00'  
 STA. 239+74.69 TO STA. 243+09.97 = SEE INTERSECTION DETAIL RAMPS A & B, SHEET NO. 68
- 3 STA. 235+19.64 TO STA. 240+96.07 = SEE DETAIL A, THIS SHEET  
 STA. 246+22.50 TO STA. 248+15.51 = SEE DETAIL A, THIS SHEET  
 STA. 248+15.51 TO STA. 250+36.41 = OMIT AT BRIDGE  
 STA. 250+36.41 TO STA. 252+65.24 = SEE DETAIL A, THIS SHEET  
 STA. 255+40.37 TO STA. 256+15.24 = SEE DETAIL A, THIS SHEET  
 STA. 257+07.55 TO STA. 262+41.12 = SEE DETAIL A, THIS SHEET
- 4 STA. 233+88.64 TO STA. 243+09.97 = 0.00'  
 STA. 245+85.24 TO STA. 246+78.44 = 0.00'  
 STA. 246+78.44 TO STA. 247+02.44 = TRANSITION FROM 0.00' TO 4.00'  
 STA. 247+02.44 TO STA. 247+37.44 = 4.00'  
 STA. 247+37.44 TO STA. 247+62.44 = TRANSITION FROM 4.00' TO 3.26'  
 STA. 247+62.44 TO STA. 248+18.09 = 3.26'  
 STA. 248+18.09 TO STA. 250+38.09 = SEE BRIDGE PLANS, SHEETS 119 TO 134  
 STA. 250+38.09 TO STA. 252+65.24 = 3.26'  
 STA. 255+40.37 TO STA. 258+75.66 = SEE INTERSECTION DETAIL RAMPS C & D, SHEET NO. 69  
 STA. 258+75.66 TO STA. 264+61.71 = 0.00'
- 5 STA. 258+30.00 TO STA. 264+61.71 = 4.00'
- 6 STA. 233+88.64 TO STA. 236+02.79 = SEE MEDIAN DETAILS, SHEET NO. 71, DETAIL 1  
 STA. 236+02.79 TO STA. 239+74.69 = TRANSITION FROM 1.32' TO 9.00'  
 STA. 239+74.69 TO STA. 243+09.97 = SEE INTERSECTION DETAIL RAMPS A & B, SHEET NO. 68
- 7 STA. 233+88.64 TO STA. 236+02.79 = SEE MEDIAN DETAILS, SHEET NO. 71, DETAIL 1  
 STA. 236+02.79 TO STA. 239+74.69 = TRANSITION FROM 17.00' TO 14.00'  
 STA. 239+74.69 TO STA. 243+09.97 = SEE INTERSECTION DETAIL RAMPS A & B, SHEET NO. 68
- 8 STA. 236+09.23 TO STA. 241+42.80 = SEE DETAIL A, THIS SHEET  
 STA. 242+35.24 TO STA. 243+09.97 = SEE DETAIL A, THIS SHEET  
 STA. 245+85.24 TO STA. 248+14.17 = SEE DETAIL A, THIS SHEET  
 STA. 248+14.17 TO STA. 250+35.07 = OMIT AT BRIDGE  
 STA. 250+35.07 TO STA. 252+28.27 = SEE DETAIL A, THIS SHEET  
 STA. 257+54.28 TO STA. 263+30.71 = SEE DETAIL A, THIS SHEET
- 9 STA. 233+88.64 TO STA. 243+09.97 = 0.00'  
 STA. 245+85.24 TO STA. 248+12.49 = 3.26'  
 STA. 248+12.49 TO STA. 250+32.49 = SEE BRIDGE PLANS, SHEETS 119 TO 134  
 STA. 250+32.49 TO STA. 252+65.24 = 3.26'  
 STA. 255+40.37 TO STA. 258+75.66 = SEE INTERSECTION DETAIL RAMPS C & D, SHEET NO. 69  
 STA. 258+75.66 TO STA. 264+61.71 = 0.00'
- 10 STA. 245+85.24 TO STA. 246+35.24 = TRANSITION GUTTER SLOPE FROM 6.00% TO -1.5%
- 11 STA. 252+15.24 TO STA. 252+65.24 = TRANSITION GUTTER SLOPE FROM -1.50% TO 6.00%

\*USE BITUMINOUS SHOULDERS SUPERPAVE 10" FROM STA. 241+79.97 TO STA. 243+09.97. SEE INTERSECTION DETAIL RAMPS A & B, SHEET NO. 68.  
 \*\*USE BITUMINOUS SHOULDERS SUPERPAVE 10" FROM STA. 255+40.37 TO STA. 256+70.37. SEE INTERSECTION DETAIL RAMPS C & D, SHEET NO. 69.  
 \*\*\*BRIDGE APPROACH PAVEMENT CONNECTOR (PCC) - STA. 247+79.29 TO STA. 247+85.29 AND STA. 250+65.29 TO STA. 250+71.29 (SEE STANDARD 420401).

- 1 EXISTING GROUND
- 2 BITUMINOUS CONCRETE PAVEMENT (FULL-DEPTH), SUPERPAVE, 11"
- 3 BITUMINOUS CONCRETE PAVEMENT (FULL-DEPTH), SUPERPAVE, 8"
- 4 BITUMINOUS CONCRETE SURFACE COURSE, SUPERPAVE, IL 9.5L (LOW ESAL)
- 5 AGGREGATE BASE COURSE, TYPE A 10"
- 6 PORTLAND CEMENT CONCRETE PAVEMENT 8" (JOINTED)
- 7 PORTLAND CEMENT CONCRETE PAVEMENT 9 1/2" (JOINTED)
- 8 AGGREGATE BASE COURSE, TYPE A 4"
- 9 PROCESSING LIME MODIFIED SOILS 12"
- 10 SUBBASE GRANULAR MATERIAL, TYPE C (COST INCLUDED IN 9)
- 11 BITUMINOUS SHOULDERS SUPERPAVE 8"
- 12 AGGREGATE SHOULDERS, TYPE A
- 13 AGGREGATE SHOULDERS, TYPE B 6"
- 14 PORTLAND CEMENT CONCRETE SHOULDERS 9 1/2"
- 15 CONCRETE MEDIAN SURFACE, 4"
- 16 AGGREGATE BASE COURSE, TYPE B
- 17 COMBINATION CONCRETE CURB AND GUTTER, TYPE M-4.06

NOTES : 1 SEE CROSS SECTIONS FOR DITCH ELEVATIONS  
 2 SEE CROSS SECTIONS FOR SIDE SLOPE TRANSITION LOCATIONS.  
 3 EARTH SHOULDER WIDENED FOR GUARDRAIL. SEE STANDARD 630301. SEE MISCELLANEOUS DETAIL SHEET, SHEET NO. 116, FOR BITUMINOUS SHOULDER CURB.

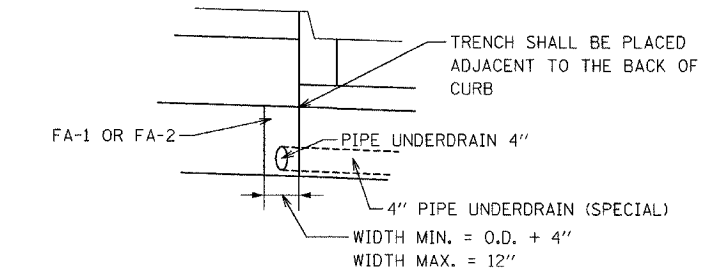

SEE STANDARD 601001 FOR MORE DETAILS  
 SEE SHEET NO. 24 FOR LOCATIONS OF 4" PIPE UNDERDRAIN (SPECIAL)

REVISIONS		ILLINOIS DEPARTMENT OF TRANSPORTATION PROPOSED TYPICAL SECTIONS C.H. 18 FAI-57, FAS 642 SEC NO. 15-23K, 99-00124-02-PV COLES COUNTY, ILLINOIS
NAME	DATE	

SCALE: NOT TO SCALE  
 DATE 07/13/2005  
 DRAWN BY SKM  
 CHECKED BY JWM



© Copyright Hanson Professional Services Inc. 2005

07/13/2005  
 1:57:40:51:97:20228b/Civil/Sheet/502ty.pdgn  
 LAYOUT SKM 12/26/03  
 DRAWN DF/SK 12/26/03  
 REVIEWED SKM 01/05/04