

F.A.S. RTE.	SECTION	COUNTY	TOTAL SHEETS	SHEET NO.
642	99-00124-02-PV	COLES	229	6
STA.		TO STA.		
FED. ROAD DIST. NO.		ILLINOIS	FED. AID PROJECT	

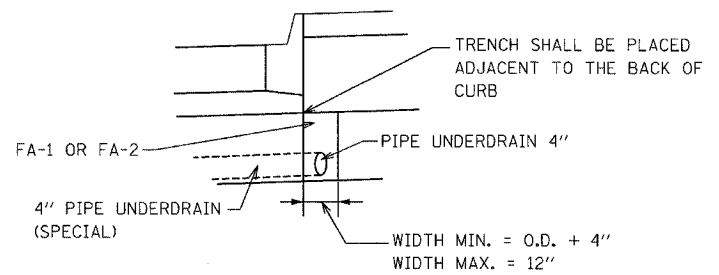
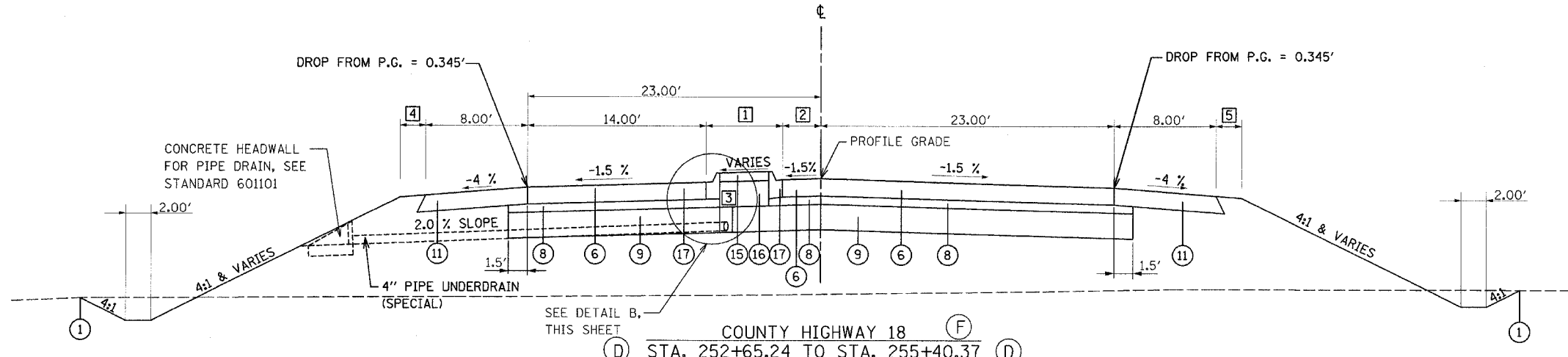

DETAIL B
SEE STANDARD 601001 FOR MORE DETAILS
SEE SHEET NO. 24 FOR LOCATIONS OF 4" PIPE UNDERDRAIN (SPECIAL)

- ① STA. 252+65.24 TO STA. 253+35.24 = TRANSITION FROM 9.00' TO 6.00'
STA. 253+35.24 TO STA. 255+40.37 = 6.00'
- ② STA. 252+65.24 TO STA. 253+35.24 = TRANSITION FROM 0.00' TO 3.00'
STA. 253+35.24 TO STA. 255+40.37 = 3.00'
- ③ STA. 252+65.24 TO STA. 255+40.37 = SEE DETAIL B, THIS SHEET
- ④ STA. 252+65.24 TO STA. 255+40.37 = 3.26'
- ⑤ STA. 252+65.24 TO STA. 252+88.14 = 3.26'
STA. 252+88.14 TO STA. 253+13.14 = TRANSITION FROM 3.26' TO 4.00'
STA. 253+13.14 TO STA. 253+48.14 = 4.00'
STA. 253+48.14 TO STA. 253+72.14 = TRANSITION FROM 4.00' TO 0.00'
STA. 253+72.14 TO STA. 255+40.37 = 0.00'

- ① EXISTING GROUND
- ② BITUMINOUS CONCRETE PAVEMENT (FULL-DEPTH), SUPERPAVE, 11"
- ③ BITUMINOUS CONCRETE PAVEMENT (FULL-DEPTH), SUPERPAVE, 8"
- ④ BITUMINOUS CONCRETE SURFACE COURSE, SUPERPAVE, IL 9.5L (LOW ESAL)
- ⑤ AGGREGATE BASE COURSE, TYPE A 10"
- ⑥ PORTLAND CEMENT CONCRETE PAVEMENT 8" (JOINTED)
- ⑦ PORTLAND CEMENT CONCRETE PAVEMENT 9 1/2" (JOINTED)
- ⑧ AGGREGATE BASE COURSE, TYPE A 4"
- ⑨ PROCESSING LIME MODIFIED SOILS 12"
- ⑩ SUBBASE GRANULAR MATERIAL, TYPE C (COST INCLUDED IN ⑨)
- ⑪ BITUMINOUS SHOULDERS SUPERPAVE 8"
- ⑫ AGGREGATE SHOULDERS, TYPE A
- ⑬ AGGREGATE SHOULDERS, TYPE B 6"
- ⑭ PORTLAND CEMENT CONCRETE SHOULDERS 9 1/2"
- ⑮ CONCRETE MEDIAN SURFACE, 4"
- ⑯ AGGREGATE BASE COURSE, TYPE B
- ⑰ COMBINATION CONCRETE CURB AND GUTTER, TYPE M-4.06

NOTES : 1 SEE CROSS SECTIONS FOR DITCH ELEVATIONS
2 SEE CROSS SECTIONS FOR SIDE SLOPE TRANSITION LOCATIONS.
3 EARTH SHOULDER WIDENED FOR GUARDRAIL. SEE STANDARD 630301. SEE MISCELLANEOUS DETAILS SHEET, SHEET NO. 116, FOR BITUMINOUS SHOULDER CURB.

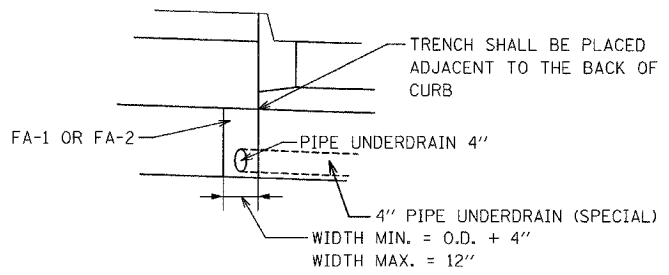
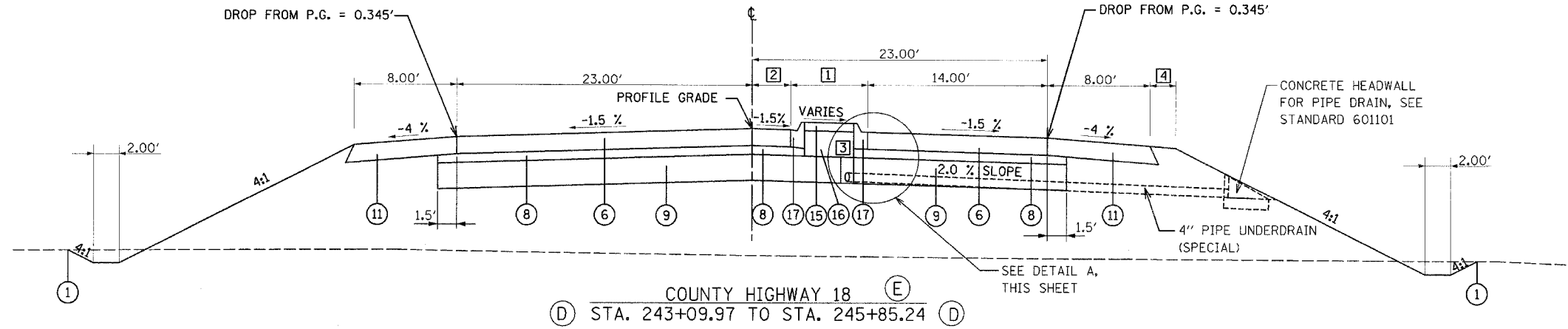

DETAIL A
SEE STANDARD 601001 FOR MORE DETAILS
SEE SHEET NO. 24 FOR LOCATIONS OF 4" PIPE UNDERDRAIN (SPECIAL)

- ① STA. 243+09.97 TO STA. 245+15.24 = 6.00'
STA. 245+15.24 TO STA. 245+85.24 = TRANSITION FROM 6.00' TO 9.00'
- ② STA. 243+09.97 TO STA. 245+15.24 = 3.00'
STA. 245+15.24 TO STA. 245+85.24 = TRANSITION FROM 3.00' TO 0.00'
- ③ STA. 243+09.97 TO STA. 245+85.24 = SEE DETAIL A THIS SHEET
- ④ STA. 243+09.97 TO STA. 243+72.84 = 0'
STA. 243+72.84 TO STA. 243+96.84 = TRANSITION FROM 0.00' TO 4.00'
STA. 243+96.84 TO STA. 244+31.84 = 4.00'
STA. 244+31.84 TO STA. 244+56.84 = TRANSITION FROM 4.00' TO 3.26'
STA. 244+56.84 TO STA. 245+85.24 = 3.26'

REVISIONS	
NAME	DATE

ILLINOIS DEPARTMENT OF TRANSPORTATION
PROPOSED TYPICAL SECTIONS
C.H. 18
FAI-57, FAS 642
SEC NO. 15-23K, 99-00124-02-PV
COLES COUNTY, ILLINOIS
SCALE: NOT TO SCALE
DATE 07/13/2005
DRAWN BY SKM
CHECKED BY JWM



07/13/2005
 I:\971055\97a2028b\c\h\1\Sheet\c-50.3fyp.dgn
 LAYOUT SKM 12/26/03
 DRAWN DP/SM 12/26/03
 REVIEWED SKM 01/05/04