

F.A.S. RTE.	SECTION	COUNTY	TOTAL SHEETS	SHEET NO.
642	99-00124-02-PV	COLES	229	45
STA. 69+50.00		TO STA. 76+78.64		
FED. ROAD DIST. NO.		ILLINOIS		FED. AID PROJECT

DATE	BY	REVISIONS
		1. CHECKED
		2. PLOTTED
		3. ALIGNED
		4. CHECKED
		5. FILED



DATE	BY	REVISIONS
		1. CHECKED
		2. PLOTTED
		3. ALIGNED
		4. CHECKED
		5. FILED

LAYOUT	D.P./S.M.	03/28/03
DRAWN	D.P.	04/28/03
REVIEWED	S.M.	05/07/03

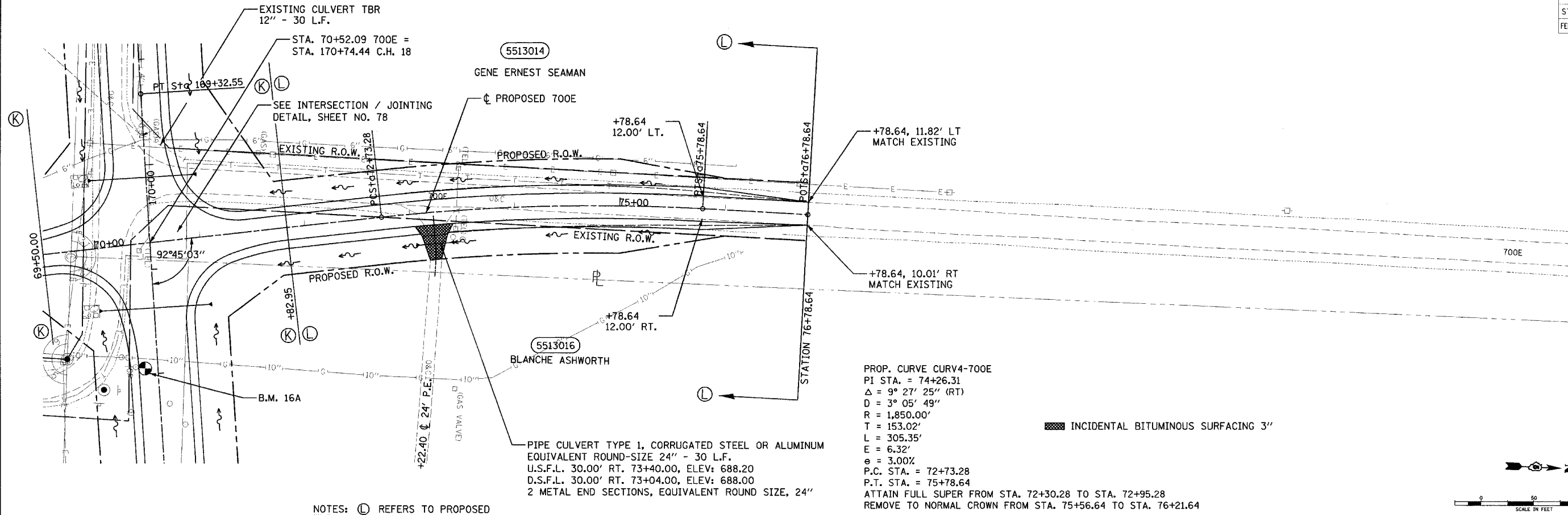

PROP. CURVE CURV4-700E
 PI STA. = 74+26.31
 Δ = 9° 27' 25'' (RT)
 D = 3° 05' 49''
 R = 1,850.00'
 T = 153.02'
 L = 305.35'
 E = 6.32'
 e = 3.00%
 P.C. STA. = 72+73.28
 P.T. STA. = 75+78.64
 ATTAIN FULL SUPER FROM STA. 72+30.28 TO STA. 72+95.28
 REMOVE TO NORMAL CROWN FROM STA. 75+56.64 TO STA. 76+21.64

NOTES: (L) REFERS TO PROPOSED TYPICAL SECTIONS.

